



9LEDW4 Work Light Kit

5-light flat LED lights

The contents of this envelope are the property of the owner.
Be sure to leave with the owner when installation is complete.

APPROXIMATE INSTALLATION TIME: 1 HOUR

ASSEMBLING & INSTALLING THE WORK LIGHTS

- A. Drill two (2) 7/16" holes in the desired mounting location on the roof if there are none present.
- B. Install each work light assembly as shown below. **IMPORTANT: orient the light with the wire on the underside so that any condensation that forms in the light can drain correctly.**

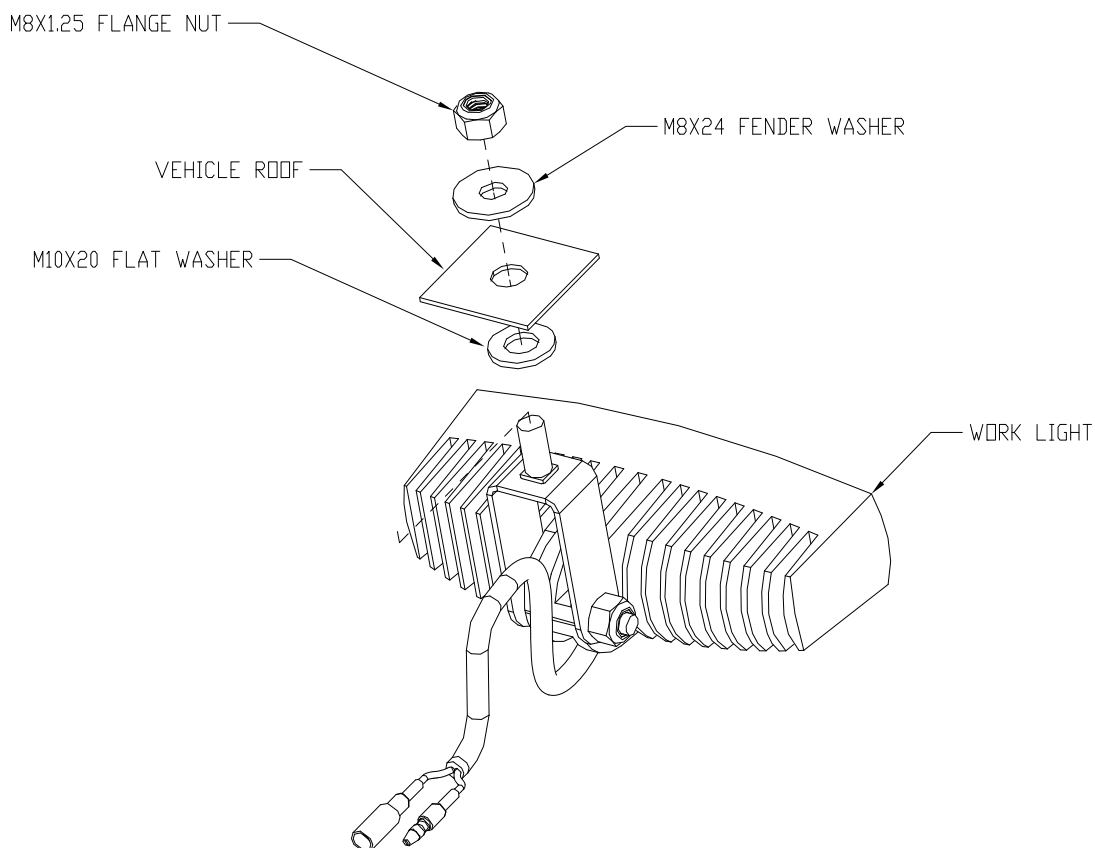

Service parts:

Light: **9LEDFWL** 5-light flat
LED work light
Wiring Kit: **9LEDW4-WK**

Rev. C
5/22/2018

WIRING THE WORK LIGHTS

- A. If no hole is available for the wires for the light, drill a 7/16" hole at least 1-1/4 inches from the light. Install grommets and feed the wire through. Silicone sealant is recommended for wiring holes drilled through the roof.
- B. Install the Toggle Switch at an appropriate location by drilling a 1/2" hole, or install the supplied mounting bracket with the included screws. CAUTION: Check for proper clearance before drilling.
- C. Connect the wire harnesses to each light, RED (positive) to RED and BLACK (negative) to BLACK. NOTE: The light will not function if polarity is reversed.
- D. Route the wires from the first light harness to the second and trim each to length. Crimp double butt connectors onto the cut and stripped ends of both red wires and both black wires and connect these to another length red & black wire, respectively.
NOTE: Use leftover wire from original harnesses for the remaining lengths of red & black wire.
- E. Route the red wire to the toggle switch, cut to length, crimp a push-on terminal to the end of the wire and connect it to one of the male terminals on the toggle switch.
- F. Crimp a second push-on terminal onto an additional length of red wire & connect it to the other male terminal on the toggle switch. Crimp a butt connector to the supplied fuse holder and the red wire and connect to a 12 volt positive power source. Install the supplied 5 amp fuse into the fuse holder.
- G. Connect the additional length of black wire to the negative battery terminal or to a grounded screw on the vehicle.
- H. Turn on the toggle switch and the 12V power supply if applicable and verify that both lights turn on.
- I. Cover the wires with split loom and secure with wire ties as desired.

