

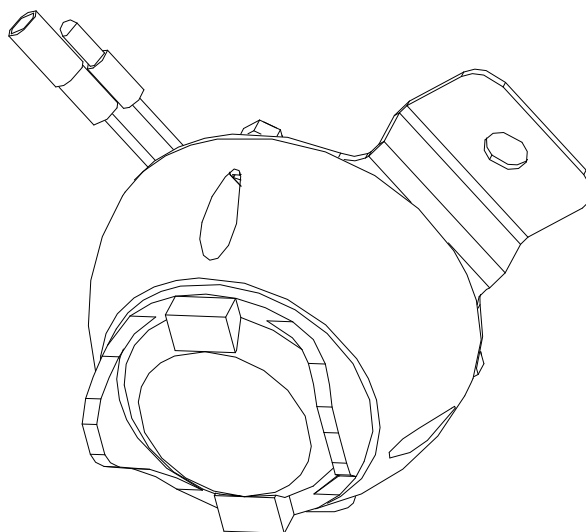

## DOME LIGHT KIT

P/N: 9LEDD10 (10 ft. harness) and 9LEDD14 (14 ft. harness)



The contents of this manual are the property of the owner.  
Be sure to leave with the owner when installation is complete.

### BEFORE YOU START

#### HELPFUL REMINDERS:

Read and understand all instructions before beginning.  
Approximate installation time: 45 MINUTES

#### TOOLS REQUIRED:

1/2" SAE open end wrenches and/or sockets  
5/16" SAE open end wrenches or sockets  
10mm open end wrenches or sockets  
Drill with 3/8" drill bit (for some applications)  
5/8" Drill bit (for limited number of applications)  
7/32" Drill bit (for limited number of applications)  
#2 Phillips head screwdriver

### CARE AND MAINTENANCE

- Clean plastic lens and outer housing with mild soap and water.
- Avoid use of harsh chemicals on plastic, as they may damage the plastic.

## STEP 1: Dome Light Installation

1. Attach dome light to bracket using three #6-32 x 1/2" screws and nuts provided (See Figure 1.1).
2. Select a location for the dome light:
  - Evaluate the wire harness route and distance to the battery when selecting a location. Make sure the harness will reach to the desired location.  
NOTE: If the harness needs to pass through a panel drill a 5/8" hole and use the rubber grommet provided.
  - On Curtis cabs, you can use an existing roof bolt, including bolts that go into inserts on side frames.
  - If not installed on a Curtis cab or a location other than an existing roof bolt is desired, drill a 3/8" hole in the roof and mount with hardware as shown in figure 1.2.
  - TIP: A location that allows the light to illuminate the ignition is desirable.

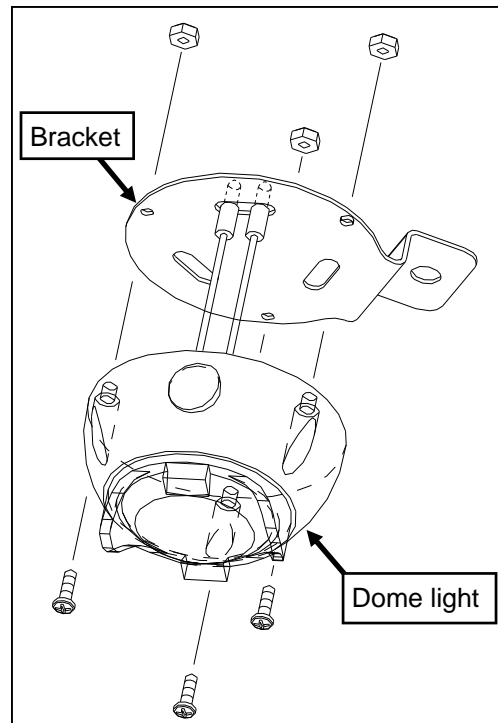

FIGURE 1.1

## STEP 2: Wiring

1. Starting at the battery, route the end of the wire harness with the bullet terminals to the dome light location. Connect the bullet terminals of the wire harness to the corresponding terminals on the dome light.
2. Disconnect the negative battery terminal. Connect the ring terminal at the end of the black harness wire to the negative battery terminal bolt. Leave terminal disconnected while connecting the ring terminal on the end of the red wire (with in-line fuse holder) to the positive battery terminal bolt. Reconnect the negative battery terminal.
3. Starting at the light, use provided zip-ties, or P clamps and self drilling screws (as appropriate for the application) to secure the wiring harness. Coil any extra harness in battery area or other convenient location and secure with remaining zip ties. CAUTION: Secure harness away from moving parts, pinch points, and hot components!
4. If necessary use a 10-32 screw, nylon washer, P clamp and nut to secure the harness against the roof. Drill a 7/32" hole in the desired location and install the hardware in the same order as the dome light bracket as shown in figure 1.2.

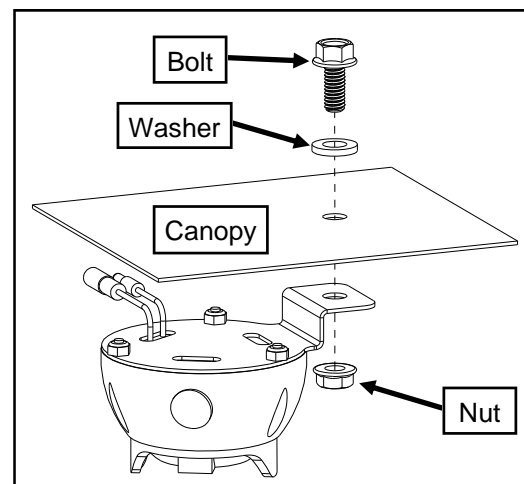

FIGURE 1.2

## DOME LIGHT SERVICE PARTS

P/N: 9LEDD10 and 9LEDD14

REF. NO.	CODE NO.	QTY/KIT	DESCRIPTION
1	8SV-LEDDL	1	Dome Light LED, Assembled
2	8SV-DLB01-B5	1	Dome Light Bracket
3	WH-DL-10	1	10 FT. Wire Harness Dome Light
3	WH-DL-14	1	14 FT. Wire Harness Dome Light

