



9LEDS2 LED Strobe Light Kit

The contents of this envelope are the property of the owner.
Be sure to leave with the owner when installation is complete.

APPROXIMATE INSTALLATION TIME: 1 HOUR

INSTALLING THE STROBE LIGHT KIT

- A. Mark for 3 (three) 7/16" mounting holes (marked as "A" on the template) and 1 (one) 7/16" hole (marked as "B" on the template) for the wire at the desired location using the Drill Template on page 3. Starting with smaller pilot holes is recommended to avoid damage to any headliner material. Install grommets into all four holes. Silicone sealant is recommended for holes drilled through a roof.
- B. Feed the wire from the strobe light through its grommet, and secure the strobe light to the roof using 1/4-20 by 1" long Button head screws through the grommets, and fender washers and lock nuts on the inside of the roof.
- C. Install the Toggle Switch at an appropriate location by drilling a 1/2" hole, or install the supplied mounting bracket with the included screws. CAUTION: Check for proper clearance before drilling.
- D. Crimp male bullet connectors onto the RED and BLUE wires from the light. Connect the BLUE wire from the strobe light to the BLACK (negative) wire on the supplied wire harness. Connect the RED wire from the strobe light to the RED (positive) wire on the supplied wire harness. NOTE: The light will not function if the connections are reversed.
- E. Route the red wire to the toggle switch, cut to length, crimp a spade terminal to the ends of both wires and connect them to the male terminals on the toggle switch.
- F. Connect the black wire to the negative battery terminal or to a grounded screw on the vehicle.
- G. Crimp a butt connector to the supplied fuse holder and the red wire and connect to a 12 volt positive power source. Install the supplied 8 amp fuse into the fuse holder.
- H. The LED Strobe Light is programmed with three flash patterns. The pattern can be changed by touching the GREEN wire from the Strobe Light to +12v while the light is on. Create a temporary jumper per the wiring diagram on page 2 and install into the RED wires at the strobe light. Touch the green wire to the un-terminated jumper wire until the strobe light is set to the desired pattern. NOTE: make sure the switch for the Strobe Light is OFF when installing and removing the jumper wire.
- I. Secure the green wire with electrical tape, cover the wires with split loom and secure with wire ties as desired.

Service parts:

Light: **9LEDS-A** Strobe light, LED, Amber

Wiring Kit: **9PWK-LACC**

Hardware Kit: **9LEDS2-HWK**

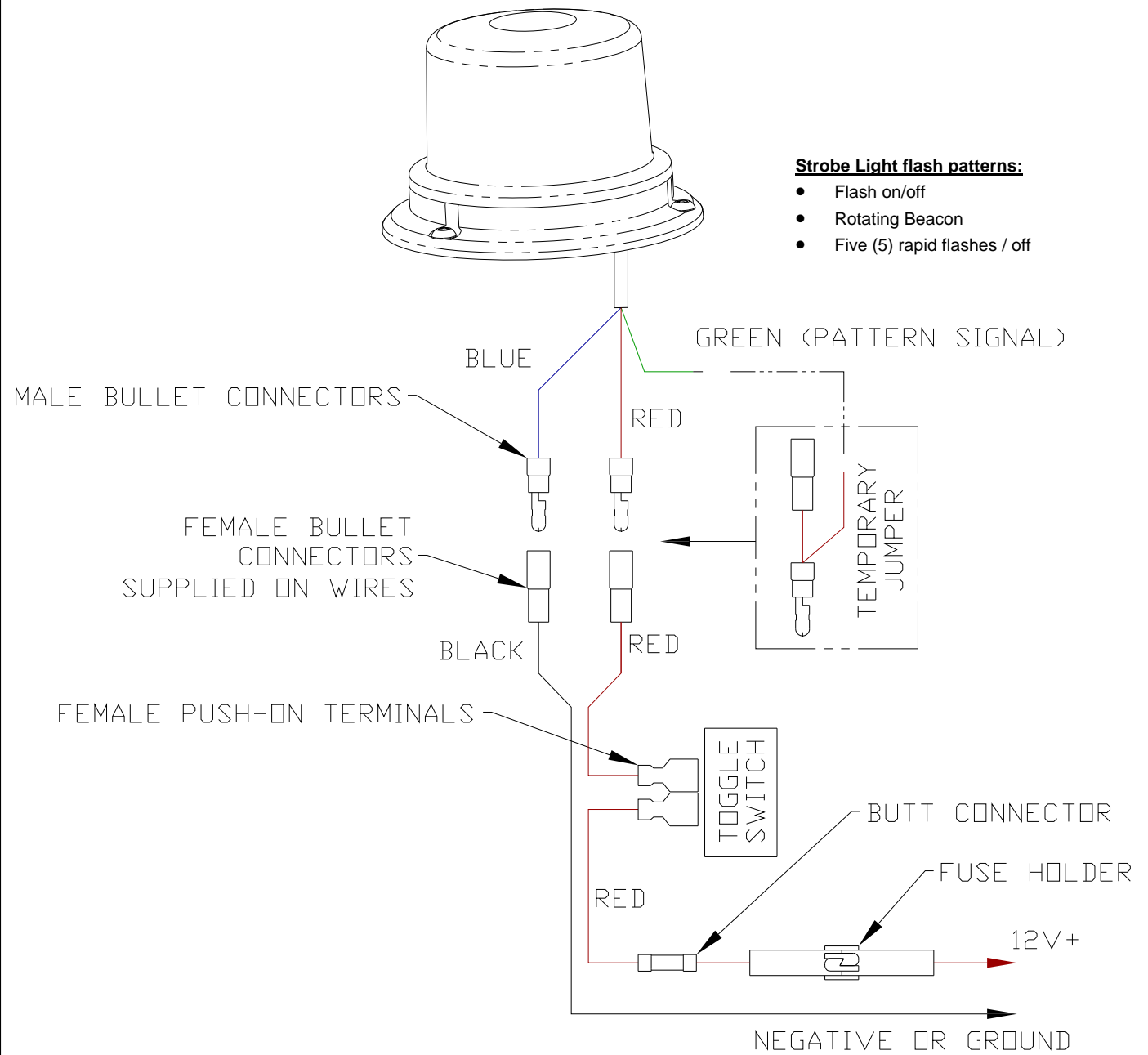

A: THREE (3) STROBE LIGHT MOUNTING HOLES
DRILL AT ALL THREE MARKS

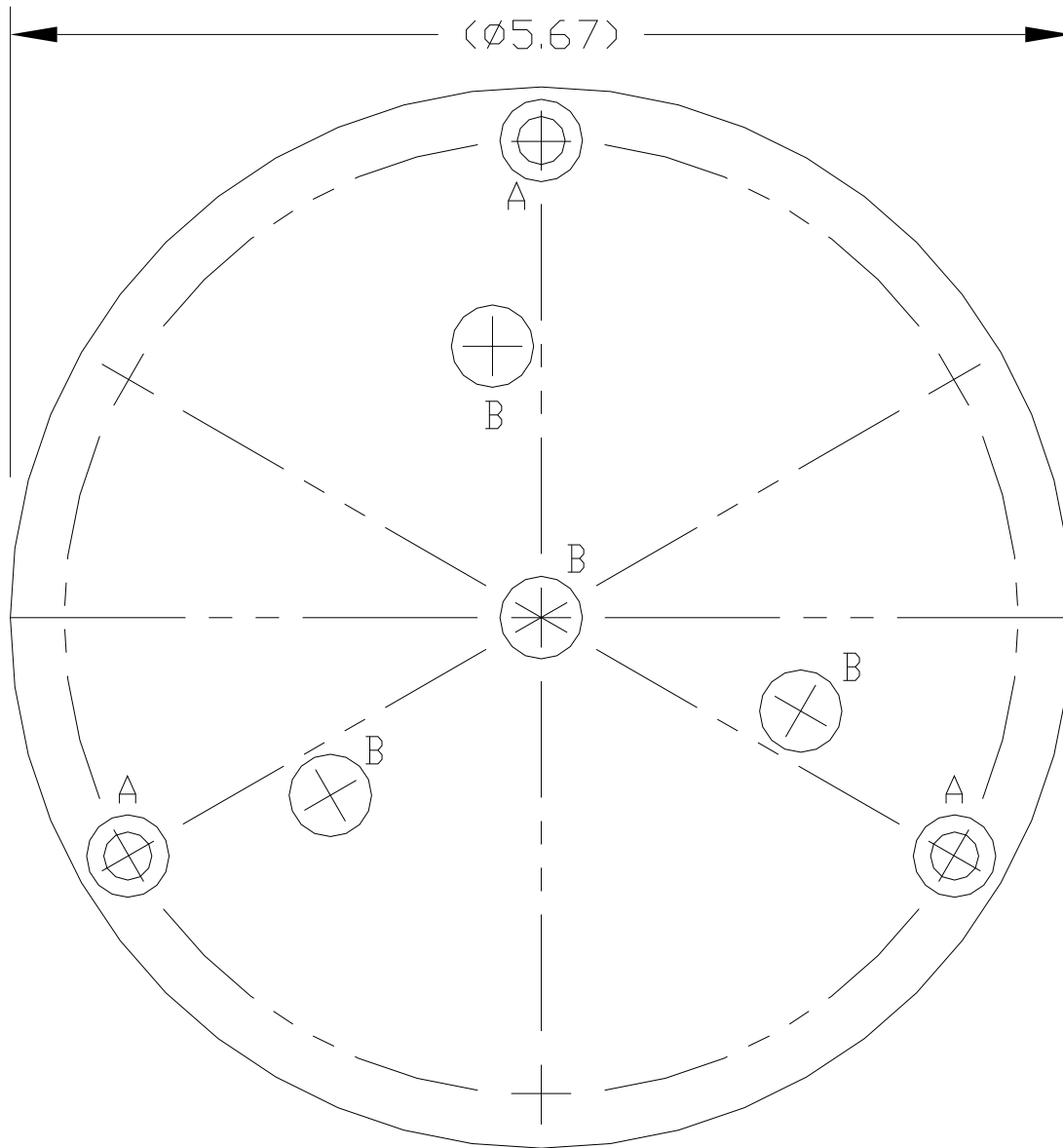

B: ONE (1) HOLE FOR STROBE LIGHT WIRE
DRILL AT ONE MARK FOR BEST FIT INSTALL

LED STROBE LIGHT INSTALLATION TEMPLATE

PRINT OR COPY AT 100% SCALE (FULL, 1:1, Actual Size) ONLY