

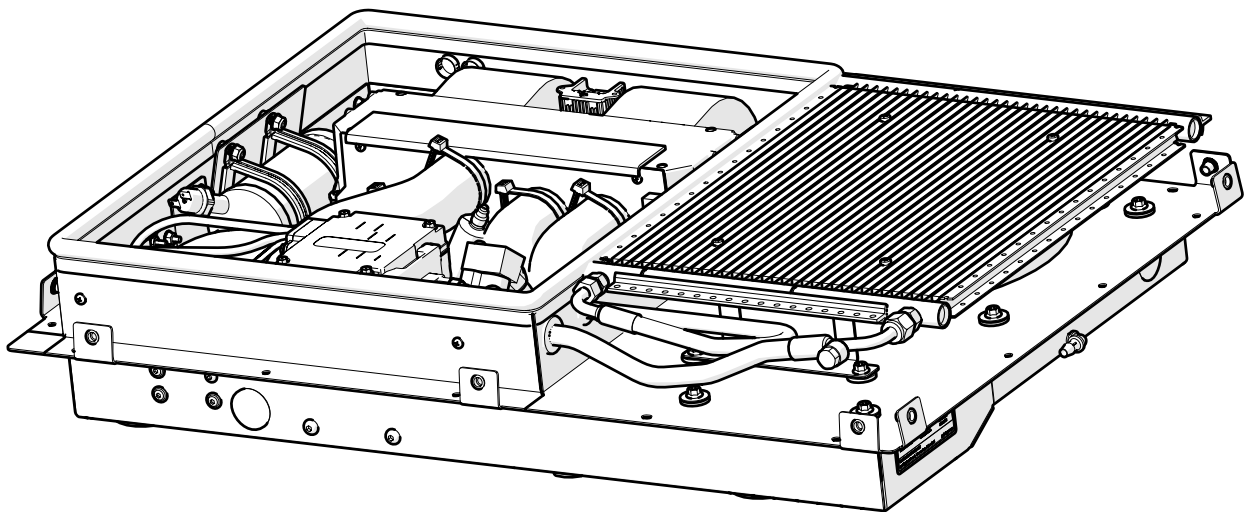

Air Conditioner

p/n: 1ACUNIT-G1

Fits with Curtis Roof Kit: Contact Curtis for Details.
Fits with Curtis Alternator Kit: Contact Curtis for Details.



Product Specifications

25" x 36" x 7"

Weight: 47 lbs.

Air Flow: 260 CFM

Cooling Capacity: 12,000 BTU / hr

Voltage: 12 VDC

Amp Draw: 68

Refrigerant: R134a, 2.1 lb. Charge

Approximate Installation Time *

Experienced Dealer Technician – 1 Hours

Average Dealer Technician – 1.5 Hours

Do-It-Yourself – 2 Hours

The contents of this envelope are the property of the owner. Leave with the owner when installation is complete.

Rev. B, 10/30/2017

p/n: IM-1ACUNIT-G1

TABLE OF CONTENTS

WARNINGS	3-4
FEATURES & OPERATION.....	5
CARE AND MAINTENANCE	5
REFRIGERANT FLOW DIAGRAM	6
TROUBLESHOOTING GUIDE	7
SERVICE PARTS	8-10

WARNINGS

Curtis air conditioners feature an assembly of parts designed for your vehicle which require adjustment and alignment of components to accommodate vehicle variations and provide proper weather protection. For accurate installation, proper operation, and years of satisfaction, please read and understand the Service & Owner's Manual fully prior to installing the air conditioner.



NOTICE

Curtis Cabs, blades and general accessories add additional weight to the base vehicle. All Curtis accessory weights are listed in product brochures. Deduct the accessory's total weight from the vehicle's rated capacity and never exceed the vehicle's rated capacity including driver and passenger.



Exposure to Carbon Monoxide can Cause illness, serious injury or death. Never operate vehicle if suspicious of Carbon Monoxide. Inspect exhaust system for leaks monthly. Leaks can result from loose connections, corrosion, cracks or other damage to the exhaust manifold. If leaks are found, repair or replace exhaust system. Do not use vehicle until repair or replacement is complete.

California Health and Safety Proposition 65 Warning: This product may contain chemicals known to the state of California to cause cancer and birth defects or other reproductive harm.

Shock Hazard: Always disconnect the negative lead of the battery before servicing.

Disclaimer: Always discharge air conditioner refrigerant in accordance with all federal, state, and local laws.

GENERAL INFORMATION BEFORE YOU START

HELPFUL HINTS:

- Read and understand all instructions before beginning.
- Apply a silicone sealant to seal any minor gaps that may occur due to vehicle variations.
- Use caution to avoid damaging installed threaded inserts or weld nuts. Begin the thread engagement by hand to avoid or correct potential cross threading.
- Plastic washers have been supplied to provide a weather seal under the heads of some exterior bolts. The plastic washer should be installed under each bolt head directly against the outside cab surface. Care should be taken not to over tighten the fasteners and damage the plastic washer.

WARNINGS

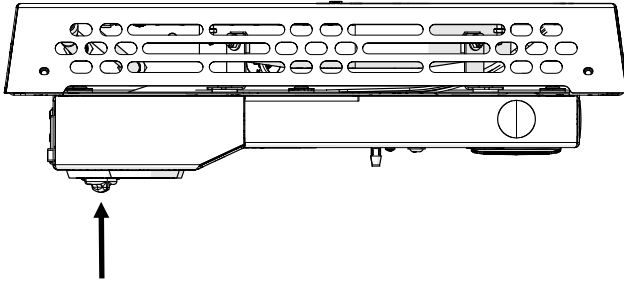

Your new air conditioner should arrive laying down flat.

Take care to protect the switches and louvers at the bottom of the unit when handling.

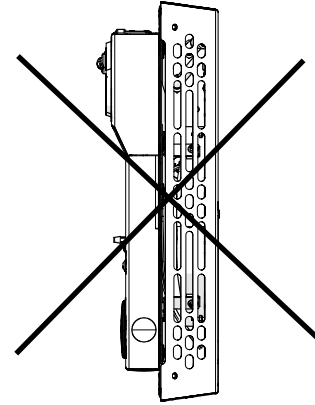

Do not receive the air conditioner from the shipping company if the air conditioner is standing up on end as shown.

Doing so will drain the oil from the compressor.

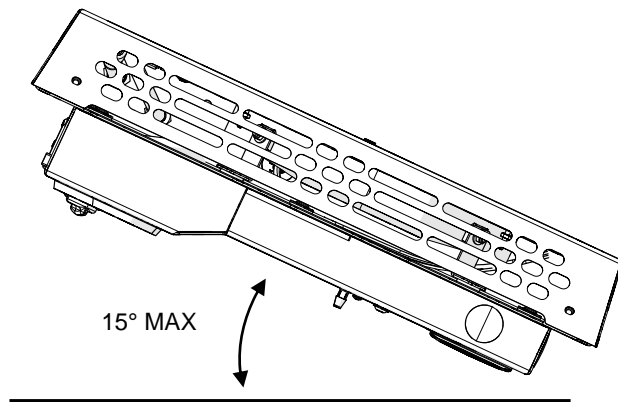

Do not tip the air conditioner more than 15° in the direction shown above during installation and service.

Doing so will drain the oil from the compressor.

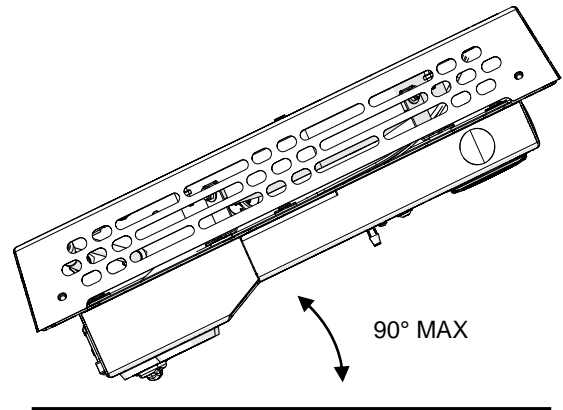

Do not tip the air conditioner more than 90° in the direction shown above during installation and service.

Doing so will drain the oil from the compressor.

FEATURES & OPERATION

Your new Curtis Air Conditioner is designed to make your driving experience more comfortable in hot weather.

Turn the 4 POSITION VENTILATION SWITCH to activate the blower. The air conditioner may be used as a fan in this manner.

Toggle the A/C ON-OFF SWITCH to activate the compressor for chilled air. The blower must be turned on before the compressor will activate.

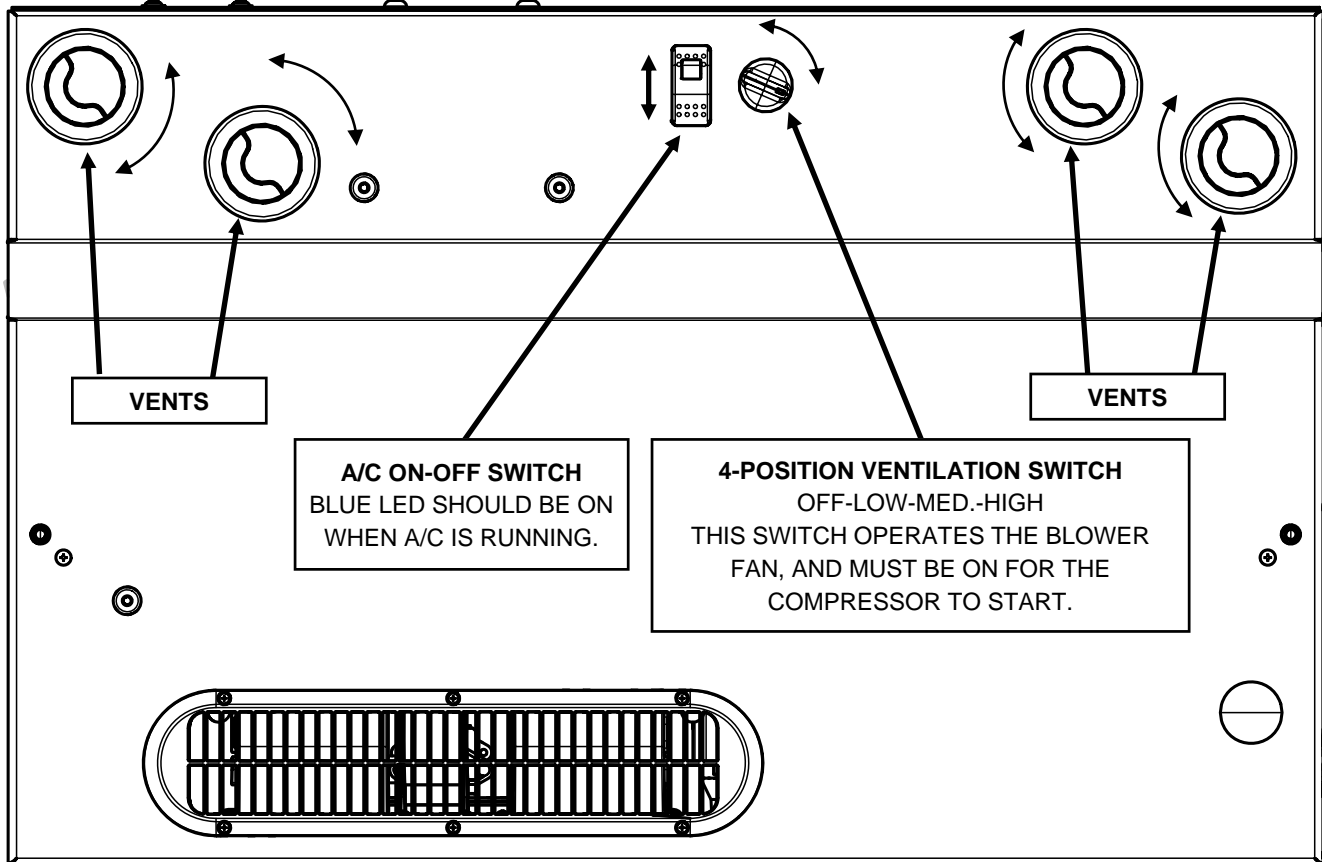

CARE AND MAINTENANCE

- Every 50 hours of operation, clean the exterior of the condenser.
- Periodically inspect and tighten hardware after every 40 hours of operation for the entire life of the air conditioner.
- This product is designed with the use of R134a as a refrigerant. Never substitute other refrigerants, use of any other refrigerant will void warranty.
- Charge unit with 2.1 lbs. of R134a refrigerant.
- Apply vacuum to for a minimum of 20 minutes prior to charging the air conditioner with R134a.
- Do not vent refrigerant to the atmosphere. If the unit has to be discharged for any reason, recover the refrigerant in compliance with federal, state and local laws.
- Replace the drier receiver (9SV-9AC-00003) when replacing a compressor (9SV-9AC-00006).
- Wash the painted surfaces of the air conditioner with commercial automotive cleaning products.

REFRIGERANT FLOW DIAGRAM

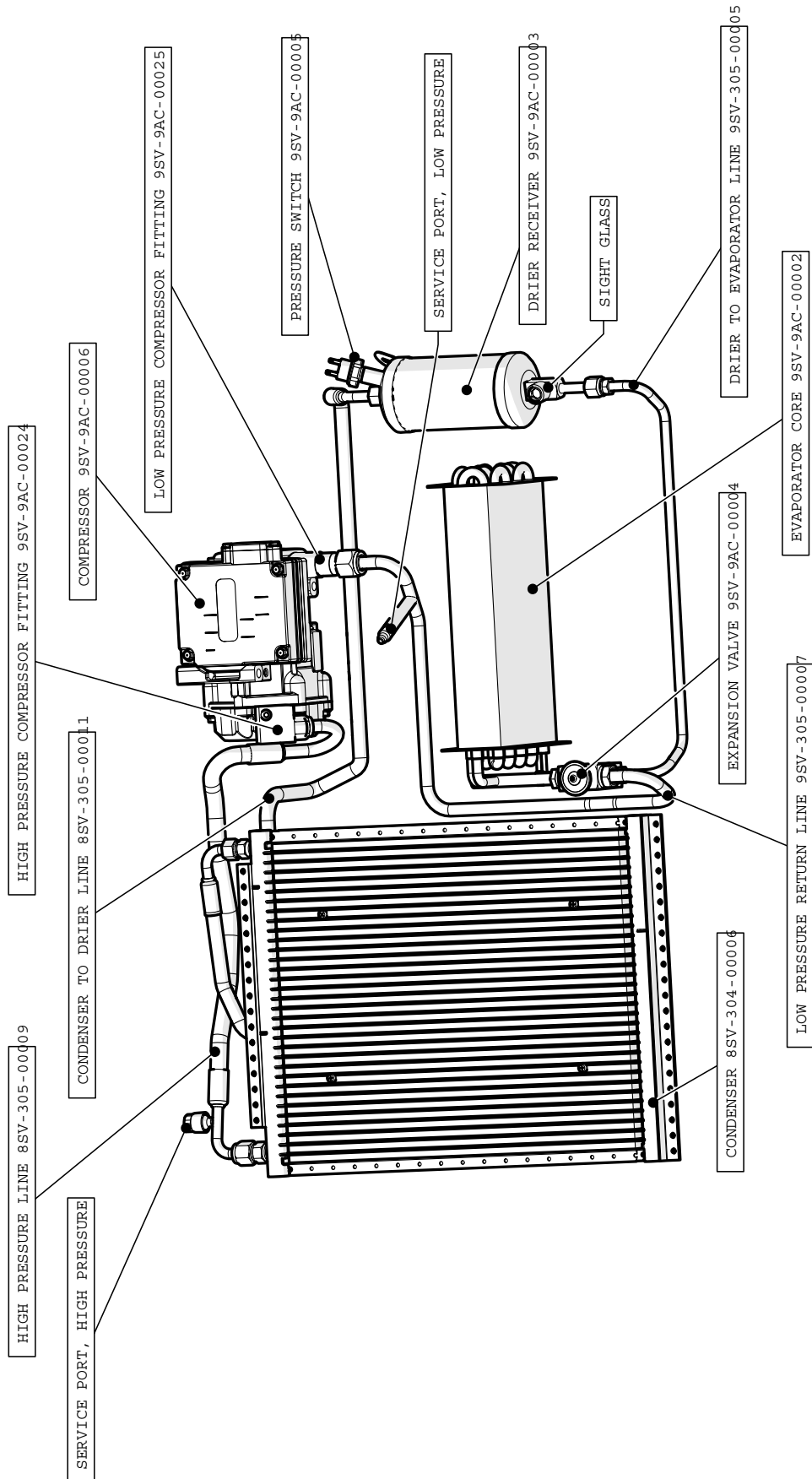

TROUBLESHOOTING GUIDE

- Some air conditioners have a time delayed start (5 seconds), to allow the vehicle's motor to get up to speed before engaging the auxiliary alternator.
- The air conditioner's compressor has a built in reset time between stopping and restarting in order to allow refrigerant pressure to equalize. This is done to prevent starting against high pressures, which will extend the life of the compressor.
- Check all fuses:
 - ◇ 5 amp ATC blade fuses, refer to alternator kit for details.
 - ◇ 15 amp ATC blade fuse located at Relay 4, located inside the air conditioner.
 - ◇ 25 amp ATC blade fuse located at Relay 3, located inside the air conditioner.
 - ◇ Two 100 amp fuses located along 2AWG red wire, and near the battery. Refer to alternator kit for details.
- Diodes 
 - ◇ There are two diodes in what look like mini blade fuse holders, located inside the A/C unit as part the wire harness.
 - ◇ Do not replace diodes with fuses. The unit will not turn off, draining the battery.
- Check all relays:
 - ◇ Relays, located under the cover of the A/C unit.
 - ◇ Timed relays, located under the cover of the A/C unit.
- Check alternator output. The alternator should put out 12-14 volts DC.
- Check the thermostat electrical connections. The air conditioner will not operate without a functional thermostat.
- Check the tension of the alternator belts.
- If the evaporator core is frozen solid:
 - ◇ Check the placement of the thermocouple. It should be nested in the evaporator housing and fit between the fins of the evaporator core.
- Check refrigerant pressure:
 - ◇ Compressor will not start if there is insufficient refrigerant pressure.

1ACUNIT-G1 SERVICE PARTS

CONDENSER FAN BRACKET
P/N: 8SV-110-00040

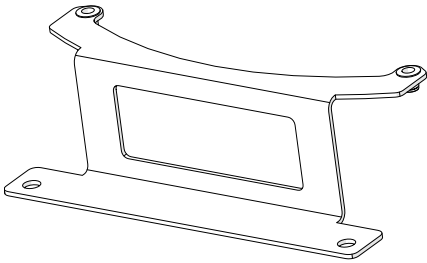

EVAPORATOR ASSEMBLY
P/N: 8SV-304-00001

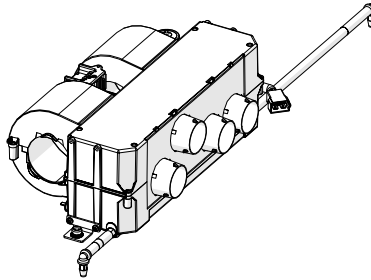

CONDENSER
P/N: 8SV-304-00006

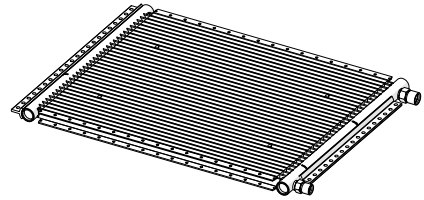

HIGH PRESSURE LINE
P/N: 8SV-305-00009

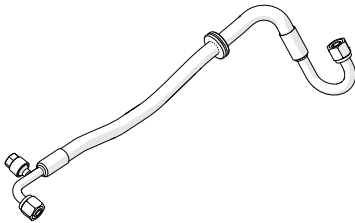

CONDENSER TO DRIER LINE
P/N: 8SV-305-00011

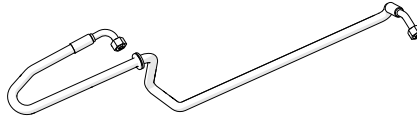

12V SOLENOID
P/N: 9SV-1TBP61A

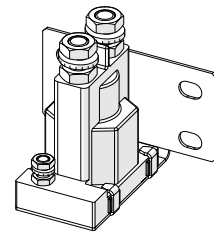

DRIER TO EVAPORATOR LINE
P/N: 9SV-305-00005

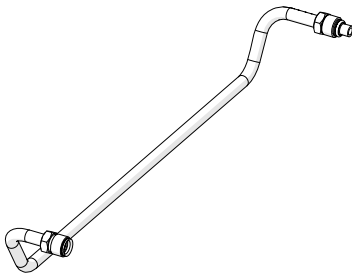

LOW PRESSURE RETURN LINE
P/N: 9SV-305-00007

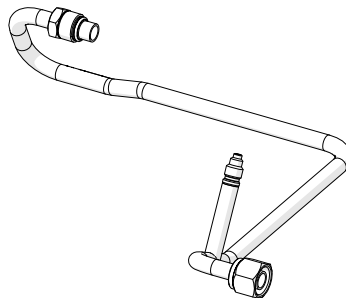

RELAY, 12V, 20/40A, SPDT, MINI ISO
P/N: 9SV-85-01-0022

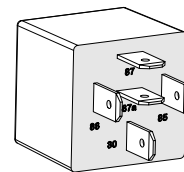

NOTE: SOME VEHICLES MAY REQUIRE DIFFERENT OR ADDITIONAL RELAYS. REFER TO THE ALTERNATOR KIT MANUAL SPECIFIC TO YOUR VEHICLE.

DIODE, 1 AMP, MINI
P/N: 9SV-85-10-0027

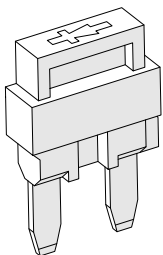

EVAPORATOR CORE
P/N: 9SV-9AC-00002

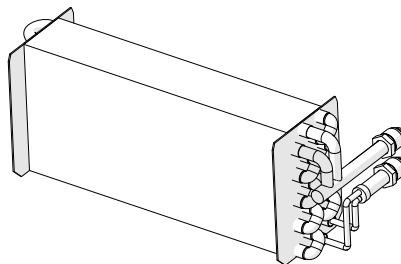

DRIER RECEIVER
P/N: 9SV-9AC-00003

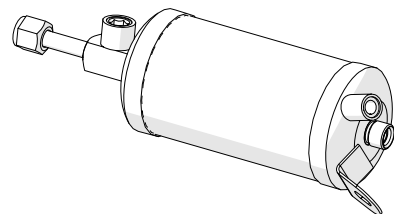

1ACUNIT-G1 SERVICE PARTS

EXPANSION VALVE
P/N: 9SV-9AC-00004

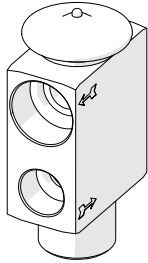

PRESSURE SWITCH, 2-28KG/CM2
P/N: 9SV-9AC-00005

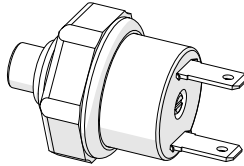

COMPRESSOR, 12 VDC
P/N: 9SV-9AC-00006

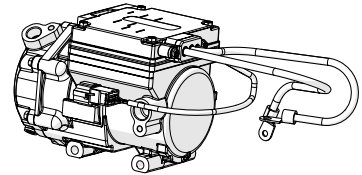

AXIAL FAN
P/N: 9SV-9AC-00007

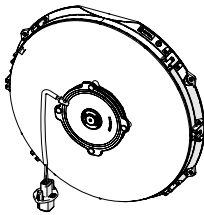

THERMOSTAT
P/N: 9SV-9AC-00008

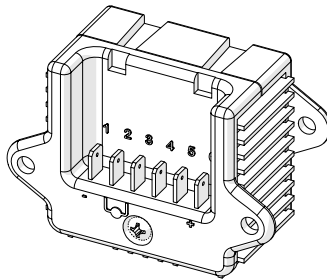

HIGH PRESSURE COMPRESSOR
FITTING W/ O-RING
P/N: 9SV-9AC-00024

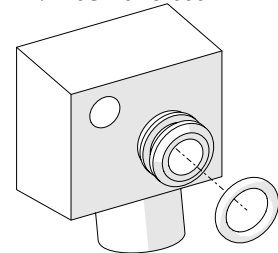

LOW PRESSURE COMPRESSOR
FITTING W/ O-RING
P/N: 9SV-9AC-00025

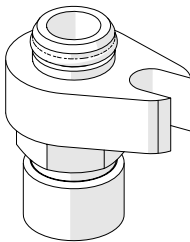

AIR INTAKE GRILL
P/N: 9SV-9HR-00017

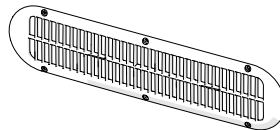

2.8" LOUVER KIT (1 SET)
P/N: 9SV-9HR-00019

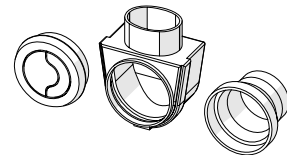

SWITCH, SPST
P/N: 9SV-OHC5

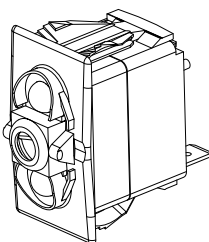

4-WAY ROTARY SWITCH W/ KNOB
P/N: 9SV-OHC-26

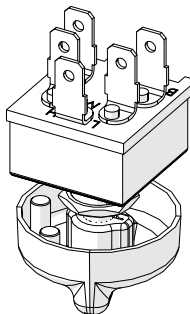

A/C UNIT O-RING KIT
P/N: 9SV-9OR-01

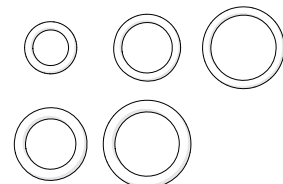

1ACUNIT-G1 SERVICE PARTS

CONSOLE ROCKER SWITCH
COVER, BLUE LENS
P/N: 9SV-9PCD1-P

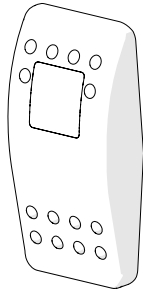

WIRE HARNESS, A/C ROOF UNIT
P/N: 9SV-WH-00049

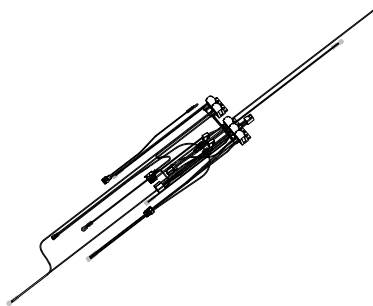

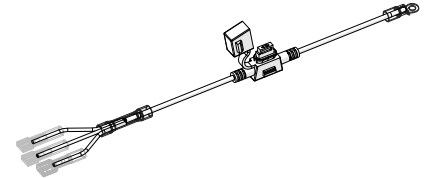

WIRE HARNESS, LEADS FOR SIGNAL
WIRE & CONTROLLER
P/N: 9SV-WH-00066

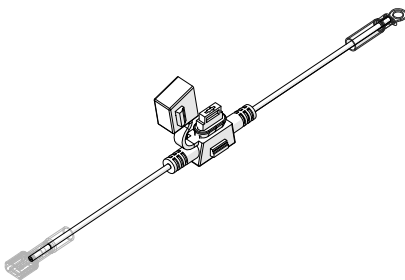

WIRE HARNESS, TIME DELAY OFF DIODE
P/N: 9SV-WH-00069

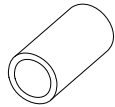

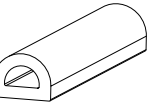
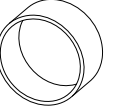
<p>3/8" PVC HOSE, BLACK, 1/2" OD</p>  <p>9SV-AC-00019-15</p>	<p>5/8" STD BULB, 1/16" GRIP</p>  <p>9SV-PRO2-15</p>	<p>ARCH PSA RUBBER .20WDX.15TALL</p>  <p>9SV-PR53-15</p>	<p>50MM I.D. AIR DUCT, PAPER</p>  <p>9SV-OHC-28-6</p>	<p>CORK TAPE</p> <p><NOT PICTURED></p> <p>9SV-9AC-00022-5</p>
-----------------------------------------------------------------------------------------------------------------------------------------------------	---------------------------------------------------------------------------------------------------------------------------------------------	-------------------------------------------------------------------------------------------------------------------------------------------------	-----------------------------------------------------------------------------------------------------------------------------------------------	---------------------------------------------------------------------