



**John Deere 1 Family**  
**Premium Cab p/n: 1JD1FPR**  
**Standard Cab p/n: 1JD1FST**  
**fits tractor models: 1023E, 1025R, and 1026R**  
**(fits years up thru 2017)**



Premium Cab Shown with Optional Front LED Work Lights.

**Available Options:**

1. Front LED Work Lights (p/n: 9LEDW4)
2. Rear LED Work Lights (p/n: 9LEDW3)
3. Rear Wiper (p/n: 9PWK65T)
4. Strobe Light (p/n: 9LEDS2)
5. Dome light (p/n: 9LEDD14)
6. Heater (p/n: 9PH20S59)
7. Switch Panel (p/n: 9PSF1)

Note: Front wiper (p/n: 9PWK110) comes standard with premium cab kit only.

APPROXIMATE INSTALLATION TIME: 3 HOURS (Not including accessories)

The contents of this envelope are the property of the owner. Leave with the owner when installation is complete.

# NOTICE

Prior to installing cab, verify which hood lifting system is on the tractor. See the illustrations below and proceed as instructed below the illustrations.

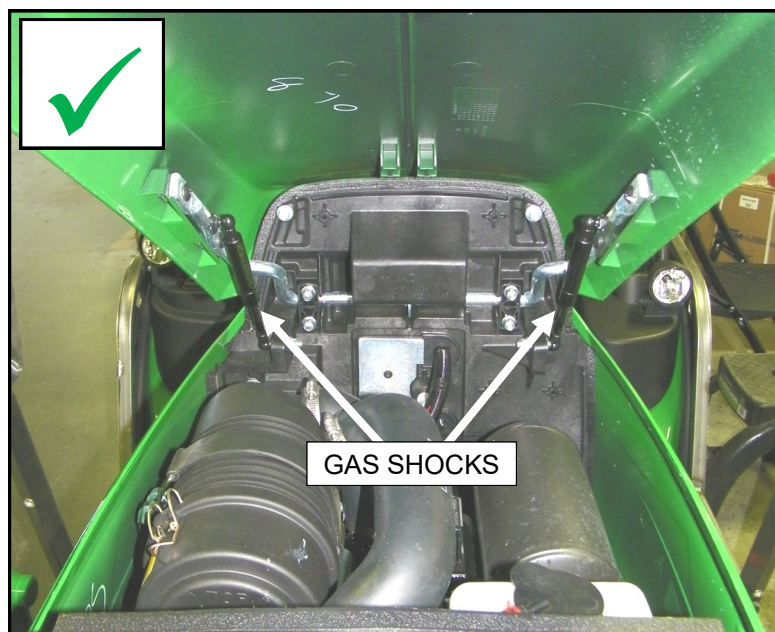

**JOHN DEERE 1 FAMILY HOOD WITH GAS SHOCKS.**  
IF THE TRACTOR HAS THIS STYLE HOOD, MOVE FORWARD WITH  
INSTALLING 1JD1FPR/1JD1FST CAB ONTO TRACTOR.

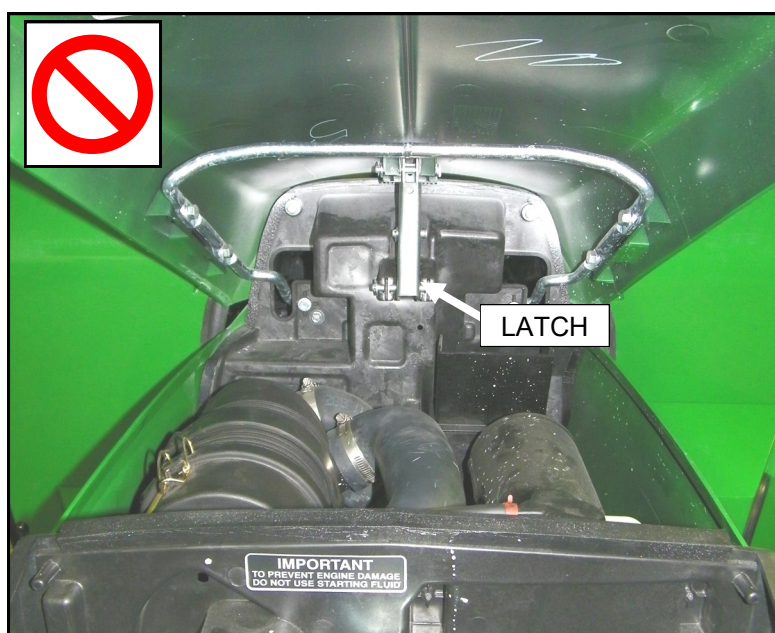





**JOHN DEERE 1 FAMILY HOOD WITH LATCH.**  
IF THE TRACTOR HAS THIS STYLE HOOD, YOU MUST INSTALL  
HOOD LATCH ADAPTER KIT (P/N 8SV-113-00016) BEFORE  
INSTALLING 1JD1FPR/1JD1FST CAB ONTO TRACTOR.

*Curtis cabs feature an assembly of parts designed for your vehicle which require adjustment and alignment of components to accommodate vehicle variations and provide proper weather protection. For accurate installation, proper operation, and years of satisfaction, please read and understand the installation and owner's manual fully prior to installing the cab.*

*From all of us at Curtis, we thank you for choosing our product.*

 <b>NOTICE</b>
<p>Curtis Cabs, blades and general accessories add additional weight to the base vehicle. All Curtis accessory weights are listed in product brochures. Deduct the accessory's total weight from the vehicle's rated capacity and never exceed the vehicle's rated capacity including driver and passenger.</p>

 <b>WARNING</b>	<p><b>Exposure to Carbon Monoxide can Cause illness, serious injury or death.</b> Never operate vehicle if suspicious of Carbon Monoxide. Inspect exhaust system for leaks monthly. Leaks can result from loose connections, corrosion, cracks or other damage to the exhaust manifold. If leaks are found, repair or replace exhaust system. Do not use vehicle until repair or</p>
--	--

 <b>WARNING</b>	
S e r i o u s   I n j u r y   o r   D e a t h	
	This cab enclosure does not provide protection from rollover or other accidents.
	This cab enclosure does not provide protection from flying objects including golf balls.
	This cab enclosure does not provide protection from lightning. When lightning threatens take cover and do not operate vehicle.

## ***GENERAL INFORMATION BEFORE YOU START***

### **HELPFUL HINTS:**

- Refer to parts diagram at the back of this manual to help identify parts during the assembly process.
- To assist with the cab installation, leave all fasteners loose for later adjustment unless otherwise specified.
- Read and understand all instructions before beginning.
- Apply a silicone sealant to seal any minor gaps that may occur due to vehicle variations.
- Use caution to avoid damaging the factory installed threaded inserts. Begin the thread engagement by hand to avoid or correct potential cross threading.
- Make sure the areas where the supplied self-adhesive hook Velcro will be applied are clean and dry and at room temperature for best adhesion.
- Before installing parts with factory installed rubber, make sure the rubber is fully installed onto the parts for proper fit and sealing.

### **TOOLS REQUIRED:**

- |   |   |
|---|---|
| <ul style="list-style-type: none"> <li>• Set of Standard and Metric Sockets (3/8" Drive)</li> <li>• 3/8" Drive Ratchet</li> <li>• Long Drive Extension</li> <li>• Set of Standard and Metric Open End Wrenches</li> <li>• Set of Standard and Metric Allen Wrenches</li> <li>• #2 and #3 Phillips Head Screwdrivers</li> <li>• Torque Wrench</li> </ul> | <ul style="list-style-type: none"> <li>• Drill/Driver</li> <li>• #2 and #3 Phillips Head Bit</li> <li>• Pair of Scissors</li> <li>• Grease</li> <li>• C-Clamps</li> <li>• Silicone Sealant</li> </ul> |
|---|---|



# CAB INSTALLATION

## STEP 1: (VEHICLE PREP)

1.1 Remove the following items from the vehicle:

- **For Premium Cab Only; if SMV Sign is mounted to the ROPS:**  
(1) Vertical bracket and (1) SMV sign (Slow Moving Vehicle) from the ROPS tubing (Roll-Over Protective Structure) on the left side of the vehicle. Save the SMV sign for reuse and discard the bolts and bracket. See Fig. 1.1a.
- **For Premium Cab Only; if SMV Sign is mounted to back of Seat:**  
(1) SMV sign (Slow Moving Vehicle) mounted to the back of the seat. Save the SMV sign for reuse and discard the bolts. See Fig. 1.1b
- (2) Outboard floorboard bolts and washers shown. Discard the bolts and washers. See Fig. 1.1c. Repeat for right side of vehicle.
- (2) Hex head bolts and nuts found on lower bent flange found behind the seat. See Fig. 1.1d. Save for reuse.

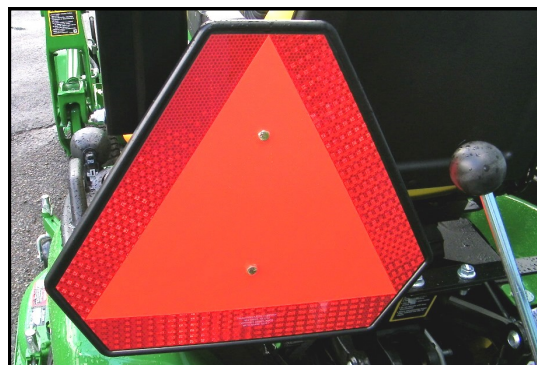

Fig. 1.1a (SMV sign mounted to the ROPS)

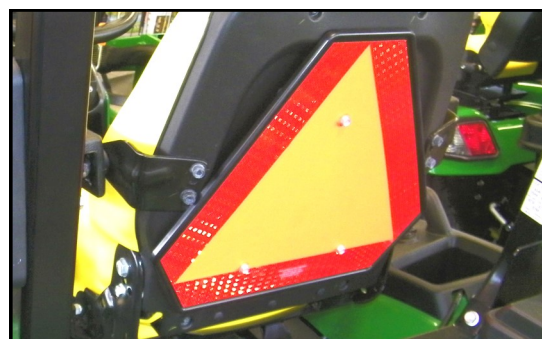

Fig. 1.1b (SMV sign mounted to the Seat)

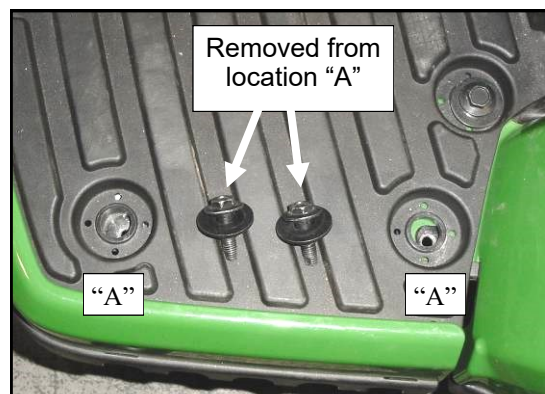

Fig. 1.1c (view from left side of tractor)

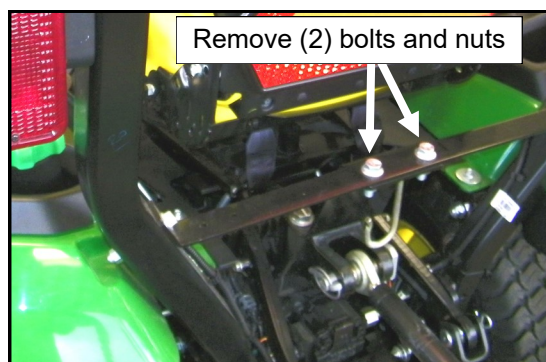

Fig. 1.1d (view from rear of tractor)



# CAB INSTALLATION

## STEP 1: (VEHICLE PREP cont'd.)

1.1 Remove the following items from the vehicle:

- (2) Bolts and Nuts mounting the Toolbox bracket. See Fig. 1.1e. Discard the toolbox, mounting bracket and hardware.
- (2) Fender Lights, if equipped. Save for reuse. Unbolt the lights from the fenders. See Fig. 1.1f. Disconnect wires from the light. Discard the hardware.
- (2) Rear Signal Lights. Remove the lights from the ROPS or bracket mounted to the ROPS depending on the model. Discard hardware. Discard mounting brackets, if provided. Let lights hang down.

**NOTE:** Install the wiring harness at this time before starting cab installation.

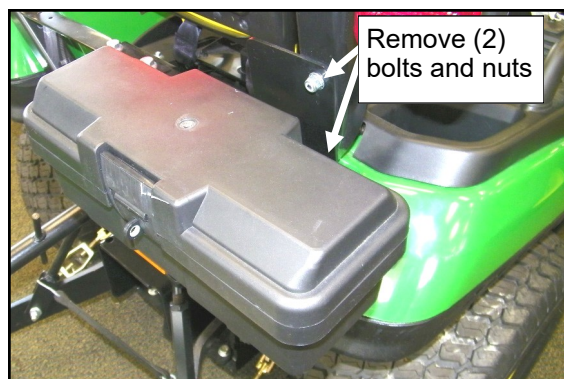

Fig. 1.1e (toolbox and mounting bracket)



Fig. 1.1f (Fender Lights - Both Sides of Vehicle)

# CAB INSTALLATION

## STEP 2: (WIRING HARNESS)

2.1 Start by removing both engine side covers.

2.2 Place the wire harness battery terminal rings near the battery terminal and secure the fuse and relay to factory wire tie mount with wire ties provided as shown. See Fig. 2.2.

2.2 Run the wires onto top of factory wire loom found on the lower left side of engine bay. See Fig. 2.3.

2.4 Loosely attach the wires down the left side of the engine bay and place them inside the left side panel as shown. See Fig. 2.4.

2.5 Run the wires from the left side panel to the right side panel near the fuse panel as shown. Next, run the wires down to the floor board. See Fig. 2.5. Let the remaining loom rest on the floorboard for now.

2.6 Run the purple wire across the vehicle to the fuse block. Per Fig. 2.6, attach to ignition fuse with fuse tap provided.

2.7 Disconnect negative and then positive battery cables. Connect the red wire from the harness to the positive side of the battery and the 2 black wires to the negative side.

2.8 Turn the key on and check for power at the male push on terminals with a test light or volt meter.

2.9 Replace all body panels, being careful not to dislodge the purple wire.

**Note: Accessing the harness after cab installation requires some cab disassembly. Check for power now!**

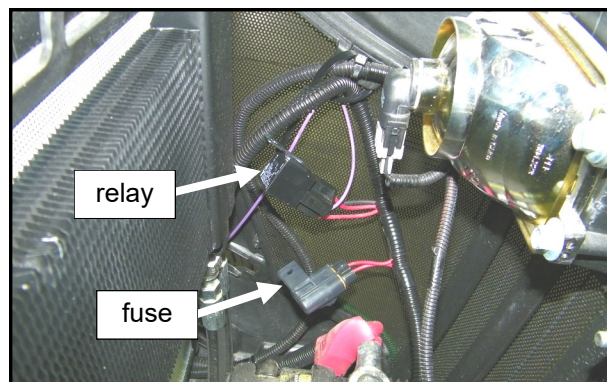

Fig. 2.2 (Wire Harness - Engine Bay of Vehicle)

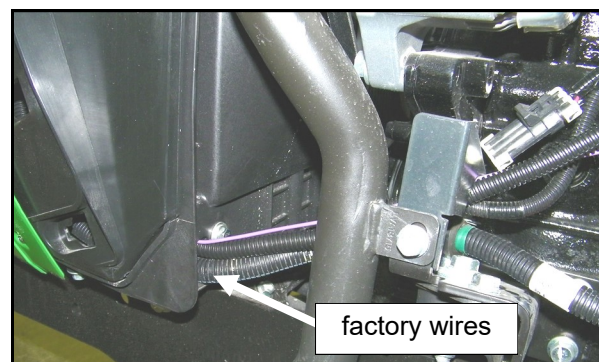

Fig. 2.3 (Wire Harness - Left Side of Engine Bay)

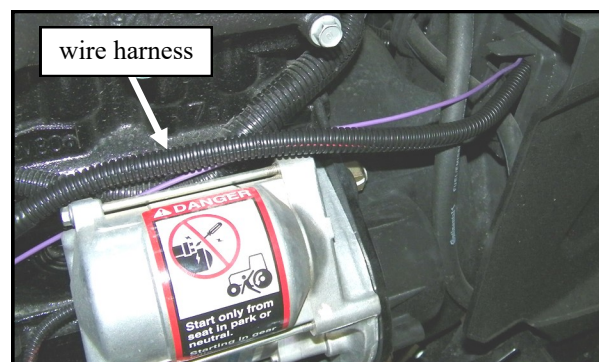

Fig. 2.4 (Wire Harness - Left Side of Engine Bay)

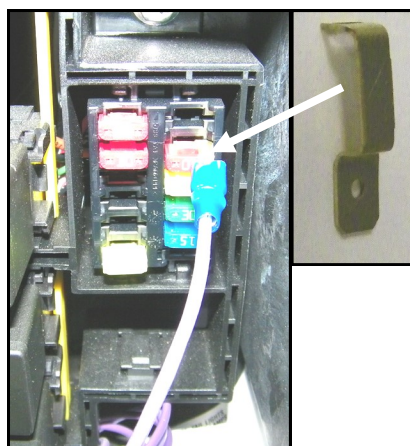

Fig. 2.6 (Wire Harness—Right Side of Vehicle)

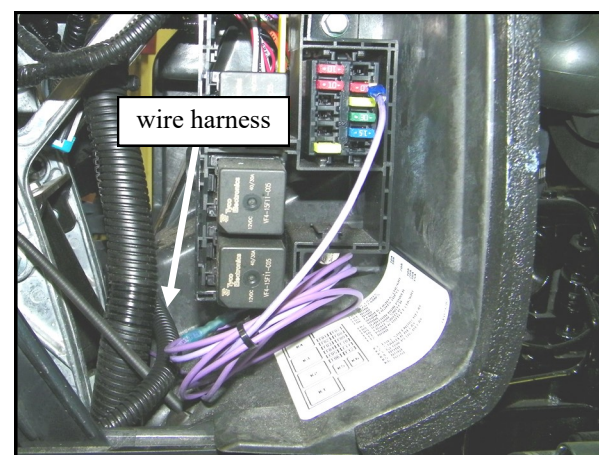

Fig. 2.5 (Wire Harness—Right Side of Vehicle)



# CAB INSTALLATION

## STEP 3: (LOWER REAR PANEL)

**3.1** Fasten the lower rear panel to vehicle lower bent flange using original factory bolts, nuts and mounting location. Making sure that rubber is on the outside of the fenders pointed towards the back of the tractor. See figure 3.1. *Note: there are two slots on the left side that do not get hardware.*

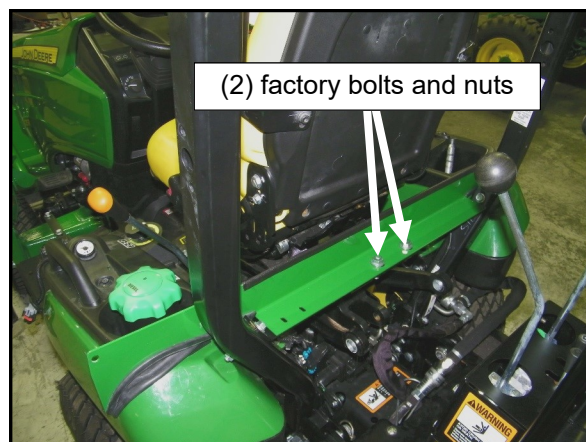

Fig. 3.1 (Lower Rear Panel- Left Side of Vehicle)

## STEP 4: (FRONT MOUNTS)

**4.1** Install the left side front mount. See Fig 4.1. Use bolts listed below. Use caution not to cross thread the bolts. On the bottom side, loosely install the supplied lock nuts. *Note: if it is difficult to install front mounts, loosen the third bolt found on the floorboards to re-align the green plastic fender slots with the floorboard. See fig. 4.1a. Do not forget to re-tighten the bolt once the front mount is installed properly.*

**4.2** Repeat for right side.

<u>Hardware Used</u>	<u>Qty</u>
M10 Flange HCS	4
M10 Nut	4

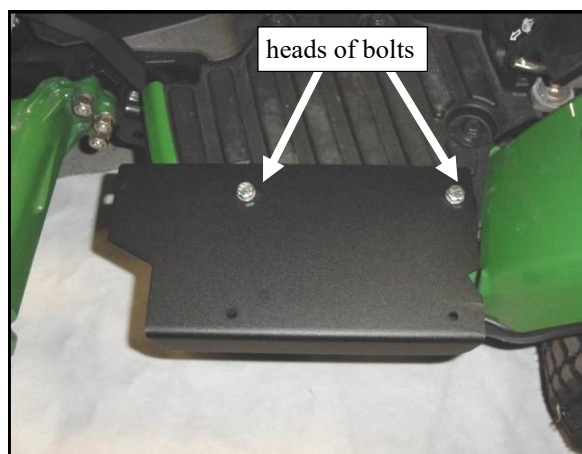

Fig. 4.1 (Front Mount- Left Side of Vehicle)

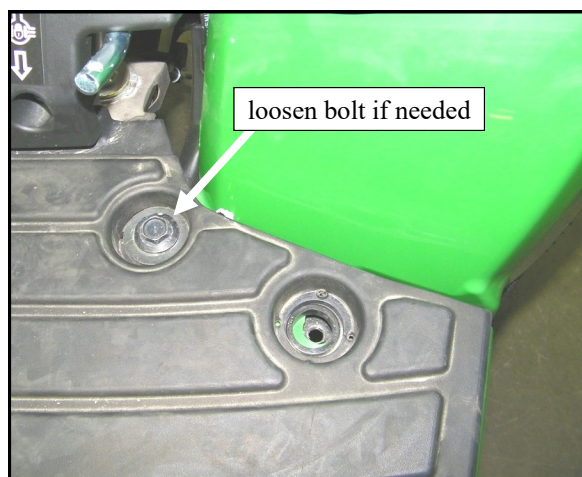

Fig. 4.1a (Front Mount- Left Side of Vehicle)



# CAB INSTALLATION

## STEP 5: (SIDEFAME - LEFT)

*Note: For ease of handling, doors can be temporarily removed from the sideframes.*

### For 1023E Model Tractor.

*If installing onto a 1025R tractor, proceed to step 5.2.*

**5.1** The left side frame requires the temporary removal of the factory installed bulb rubber shown in fig. 5.1a, the installation of a fuel filler seal plate (fig. 5.1b), and then the re-installation of the bulb rubber onto the fuel filler seal plate. Per fig. 5.1c, orient the seal plate so the point is down and closest to the side frame tubing. Note: the outline of the seal plate is highlighted with white lines in the photo for contrast. The heads of the screws are to be closest to the plastic fuel cap. The locknuts are to be towards the front of the vehicle. Leave fasteners finger tight. Install the bulb rubber onto the exposed sheet metal edge as shown in fig. 5.1c. This will seal against the plastic fender.

<u>Hardware Used</u>	<u>Qty</u>
#10-32 Pan Head Screw	2
#10-32 Flange Nut	2

### For 1025R Model Tractor.

*If installing onto a 1023E tractor, proceed to step 5.3 on the next page.*

**5.2** Install and fully tighten (2) Pan Head Screws and Flange Nuts. The heads of the screws are to be closest to the plastic fuel cap. The locknuts are to be towards the front of the vehicle.

<u>Hardware Used</u>	<u>Qty</u>
#10-32 Pan Head Screw	2
#10-32 Flange Nut	2



Fig. 5.1 (Left Fender of 1023E Model)



Fig. 5.1a (Bulb Rubber)



Fig. 5.1b (Fuel Filler Seal Plate)

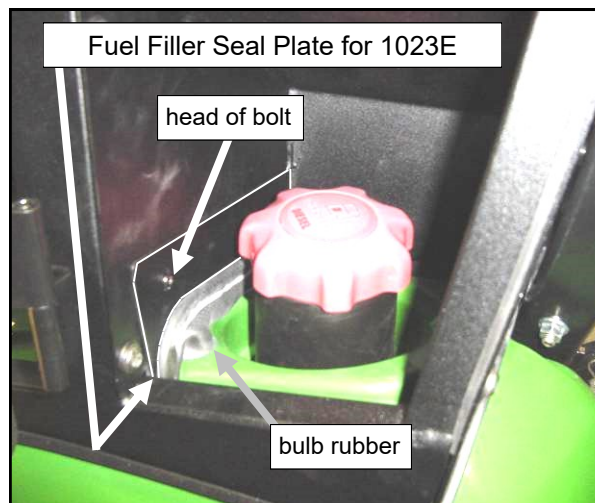

Fig. 5.1c (view from rear left side of tractor)

# CAB INSTALLATION

## STEP 5: (SIDEFAME - LEFT cont'd.)

**5.3** With assistance, place left side frame in place. Fasten the floorboard to the left side front mount with bolts and nuts — no plastic washers. See Fig. 5.3. Ensure sideframe seals against the tractor fender.

<u>Hardware Used</u>	<u>Qty</u>
5/16-18 Flange HCS	2
5/16-18 Flange Nut	2

## STEP 6: (REAR LEG - LEFT)

*For Premium Cab only.*

*If installing a standard cab, proceed to step 7.*

**6.1** With assistance, install the left rear leg oriented as shown. See fig. 6.1. Fasten to Lower Rear Panel and left sideframe. Note: make sure 5/16-18 button head screws are installed inside of fuel filler with flange nuts on the outside—no plastic washers.

<u>Hardware Used</u>	<u>Qty</u>
5/16-18 Flange HCS	3
5/16 Plastic Washer	3
5/16-18 Flange Nut	2
5/16-18 Button Head Screw	2

## STEP 7: (ROPS MOUNT - LEFT)

**7.1** Install Left ROPS mount onto left sideframe (through rear leg if premium cab). Next, install ROPS bracket onto mount—no plastic washer on bracket. See fig. 7.1.

<u>Hardware Used</u>	<u>Qty</u>
5/16-18 Flange HCS	4
5/16 Plastic Washer	2
5/16-18 Flange Nut	2

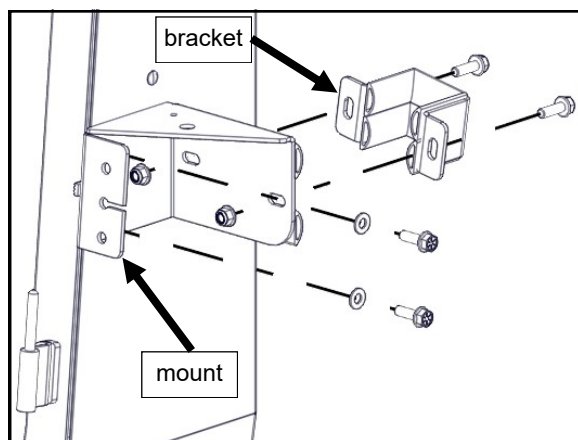

Fig. 7.1 (Left ROPS Bracket Installation)

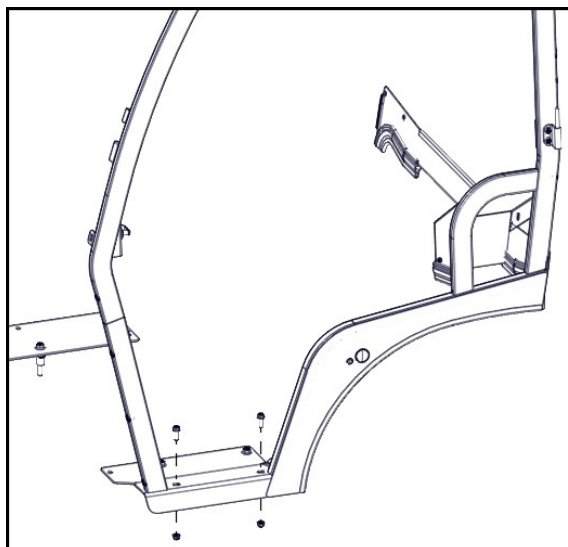

Fig. 5.3 (Left Sideframe Installation)

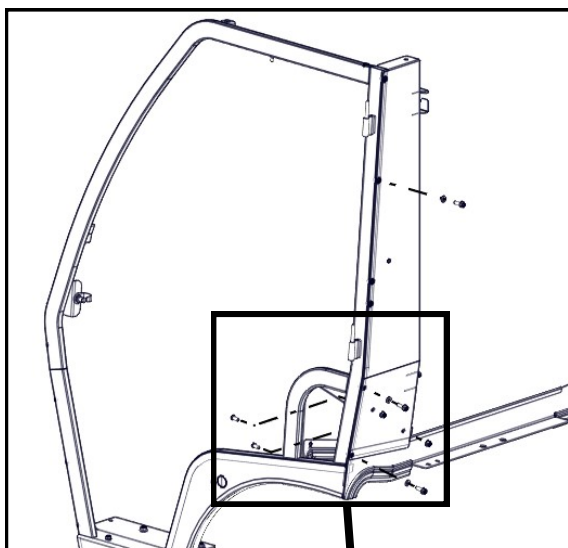

Fig. 6.1 (Left Rear Leg Installation)

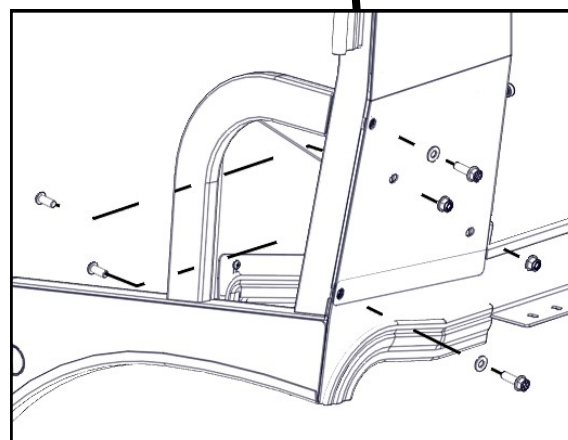

Fig. 6.1a (Left Rear Leg Installation)

# CAB INSTALLATION

## STEP 8: (SIDEFAME - RIGHT)

**8.1** With assistance, place right side frame in place. Fasten the floorboard to the right side front mount with bolts and nuts — no plastic washers. See Fig. 8.1. Ensure sideframe seals against the tractor fender.

<u>Hardware Used</u>	<u>Qty</u>
5/16-18 Flange HCS	2
5/16-18 Flange Nut	2

**For tractor equipped with fender lights.**

*If installing onto a tractor w/o fender lights, proceed to step 9.*

**8.2** Remove and discard the plastic hole plug that came installed on the right sideframe.

**8.3** Cut a slit through half of a large rubber grommet so they can be slid onto the fender light wiring.

**8.4** Thread the right fender wire extension through the large hole in the sideframe, slide on the rubber grommet, and work and secure the grommet and wiring back into the hole, making sure that the slit in the grommet is facing down.

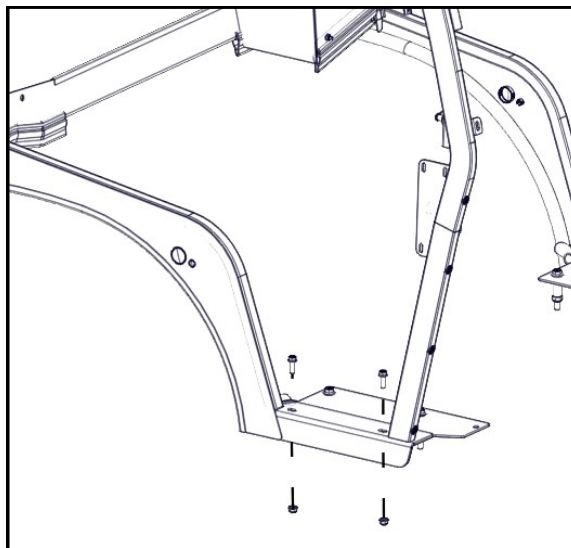

Fig. 8.1 (Right Sideframe Installation)

## STEP 9: (REAR LEG - RIGHT)

**For Premium Cab only.**

*If installing a standard cab, proceed to step 10.*

**9.1** With assistance, install the right rear leg oriented as shown. See fig. 9.1. Fasten to Lower Rear Panel and right sideframe.

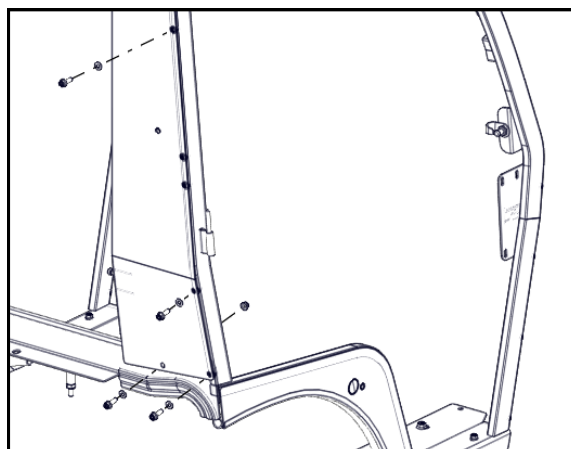

Fig. 9.1 (Right Rear Leg Installation)

<u>Hardware Used</u>	<u>Qty</u>
5/16-18 Flange HCS	4
5/16 Plastic Washer	4
5/16-18 Flange Nut	1

## STEP 10: (ROPS MOUNT - RIGHT)

**10.1** Install Right ROPS mount onto right sideframe (through rear leg if premium cab).. Next, install ROPS bracket onto mount—no plastic washer on bracket. See fig. 10.1.

<u>Hardware Used</u>	<u>Qty</u>
5/16-18 Flange HCS	4
5/16 Plastic Washer	2
5/16-18 Flange Nut	2

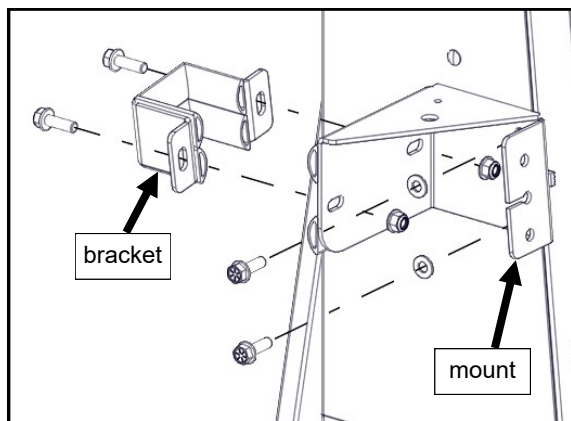

Fig. 10.1 (Right ROPS Bracket Installation)



# CAB INSTALLATION

## STEP 11: (WINDSHIELD SUPPORT)

11.1 Install windshield support. See figures 11.1 & 11.2.

11.2. Install lower bolts only in windshield support. Upper bolts are installed during roof installation at step 15. See Fig 11.2.

<u>Hardware Used</u>	<u>Qty</u>
5/16-18 Flange HCS	2
5/16 Plastic Washer	2
5/16-18 Flange Nut	2

## STEP 12: (COWL)

12.1 Fasten the cowl to the side frames as shown in Figures 12.1 & 12.1a. The bulb rubber in the center should lay across the dashboard and flex outwards away from the steering wheel. Fasten to the sideframes. Starting with the top (2) fasteners, Button Head Screws with Flange Nuts (no plastic washers) and the lower 8 fasteners which are Flange Head Cap Screws with Plastic Washers, install all fasteners finger tight.

*Proceed to the next page to complete Cowl installation.*

<u>Hardware Used</u>	<u>Qty</u>
5/16-18 Flange HCS	10
5/16-18 Button Head Screw	2
5/16 Plastic Washer	8
5/16-18 Flange Nut	4

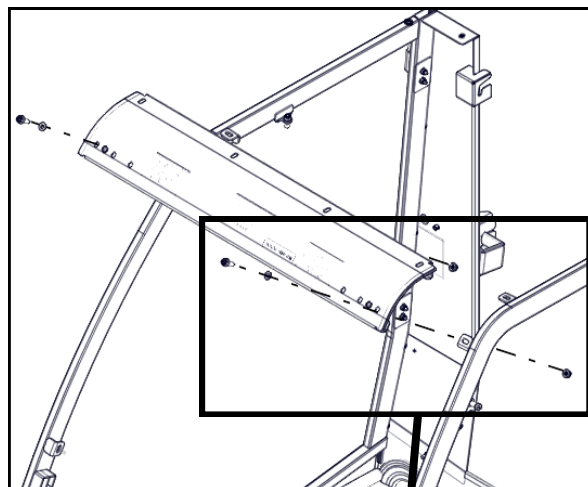

Fig. 11.1 (Windshield Support Installation)

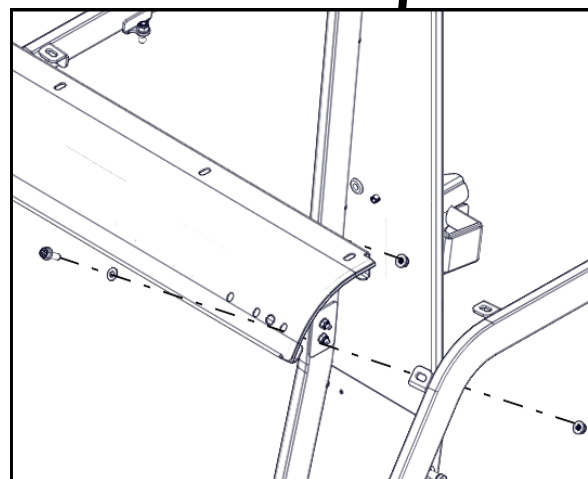

Fig. 11.2 (Windshield Support Installation)

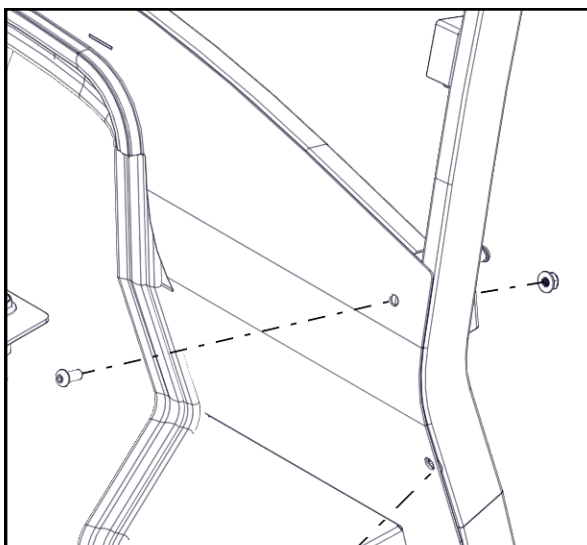

Fig. 12.1a (Cowl Installation)

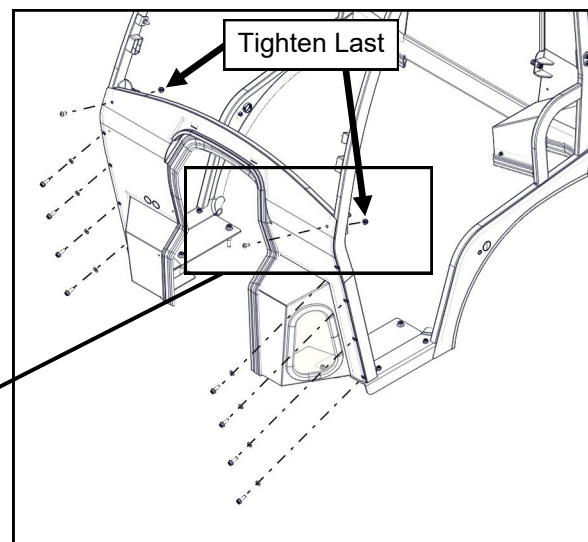

Fig. 12.1 (Cowl Installation)

# CAB INSTALLATION

## STEP 12: (COWL cont'd.)

**12.2** Next, fasten the cowl to the (2) front mounts with bolts and nuts — no plastic washers. See figures 12.2 & 12.2a.

**12.3** Tighten lower (8) screws first and then tighten upper (2) screws found on the front of the cowl. Next, tighten the (2) screws found on the front mounts.

## STEP 13: (REAR PANEL—HEADER)

**13.1** Set the rear panel header in place and start two bolts with plastic washers in the rear panel header. See Fig. 13.1 for Premium Cab and Fig 13.1a for Standard Cab.

<u>Hardware Used</u>	<u>Qty</u>
5/16-18 Flange HCS	2
5/16 Plastic Washer	2

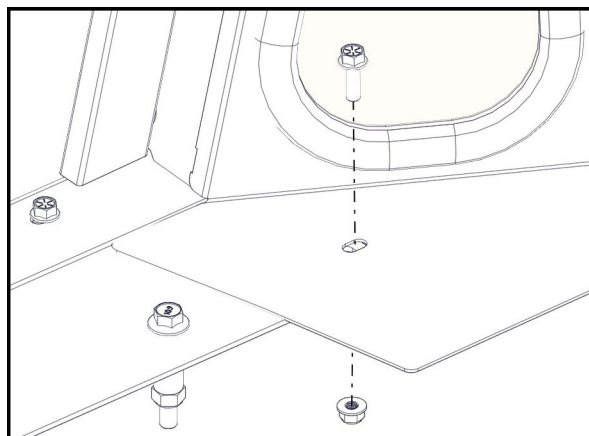

Fig. 12.2 (Cowl – Left Side Inside View)

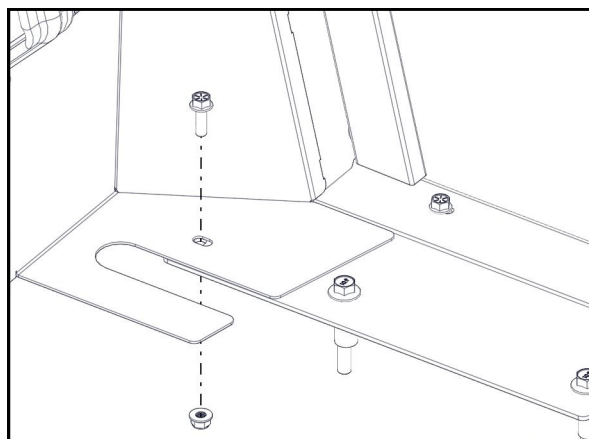

Fig. 12.2a (Cowl – Right Side Inside View)

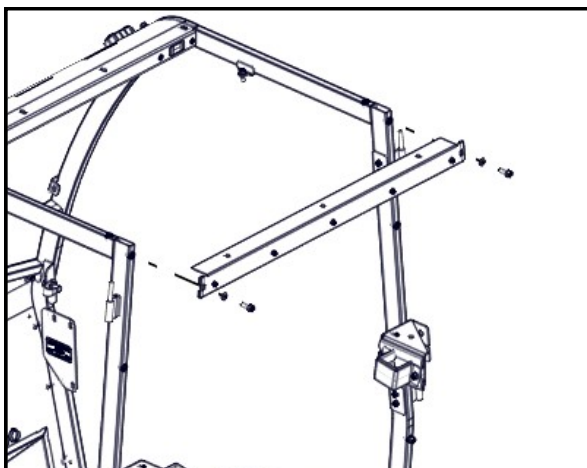

Fig. 13.1a (Rear Panel Header Installation - ST)

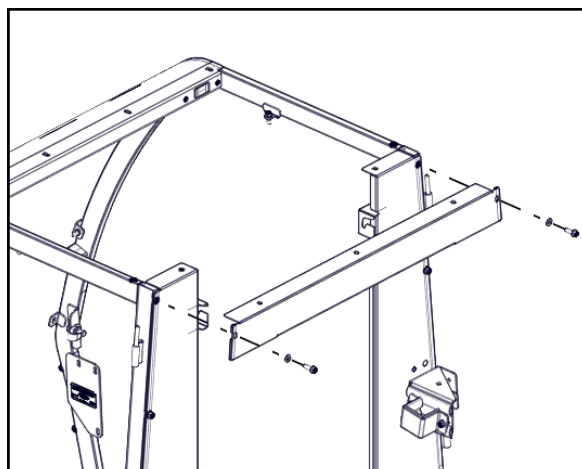

Fig. 13.1 (Rear Panel Header Installation - PR)

# CAB INSTALLATION

## STEP 14: (WINDSHIELD)

**14.1** Install the windshield to the windshield support using (1) plastic spacer block underneath each upper plastic hinge to space it off the windshield support. Snug fasteners, but **do not tighten fully**. See Fig. 14.1.

### Hardware Used

	Qty
5/16-18 X 1-1/2" Long Flat Head Screws	4
5/16-18 Flange Nut	4
Plastic Spacer Blocks	2

**14.2** With assistance, push up on the windshield and close twist latches. Tighten windshield hinge fasteners.

**Caution:** The windshield hinges are plastic components. Do not over tighten the 5/16-18 flat head screws.

**Torque to 7 ft.-lbs. max.**

**14.3** Install (2) Long Gas Shocks in place making sure the piston rods are pointed down. See Fig. 14.3. Ensure windshield opens and closes properly.

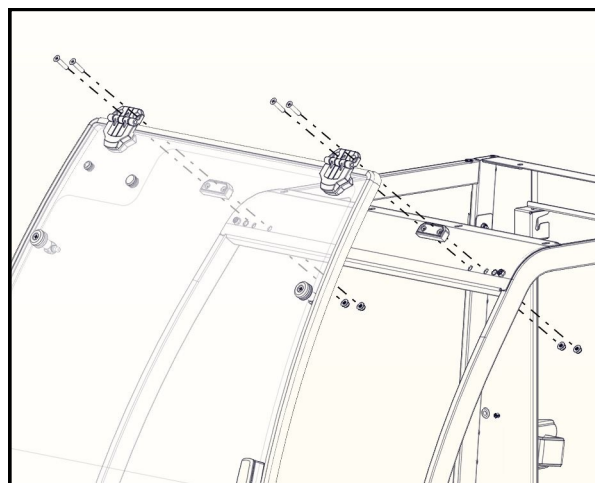

Fig. 14.1 (Windshield Installation)

## STEP 15: (ROOF)

**15.1** With assistance, lift the roof onto the side frames and rear panel header. See Fig.15.1. Move the roof into position, and fasten with bolts, plastic washers, and nuts. Clamp rear legs to rear panel header before tightening hardware fully.

### Hardware Used

	Qty
5/16-18 Flange HCS	9
5/16 Plastic Washer	9
5/16-18 Flange Nut	7

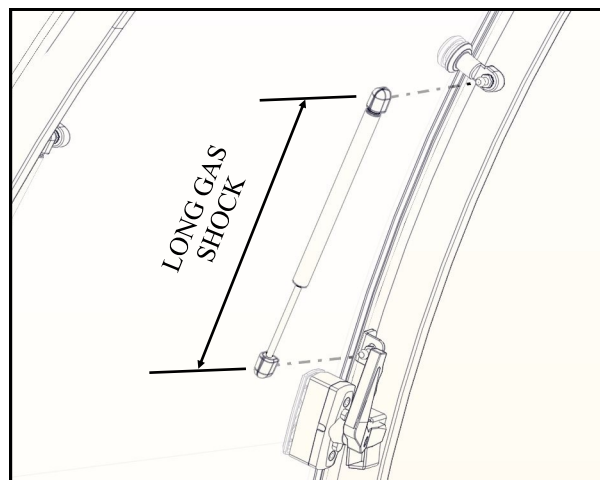

Fig. 14.3 (Gas Shock Installation)

## STEP 16: (TIGHTEN ALL FASTENERS)

**16.1** Re-check all previously installed fasteners to ensure that they have been properly tightened. Place (2) nut covers on exposed Flange Nuts found on left rear leg installed on step 6.1.

**16.2** On model 1023E only, push the seal plate down for a good seal against the fender and tighten the (2) #10 screws.

### Hardware Used

	Qty
5/16-18 Nut Covers	2

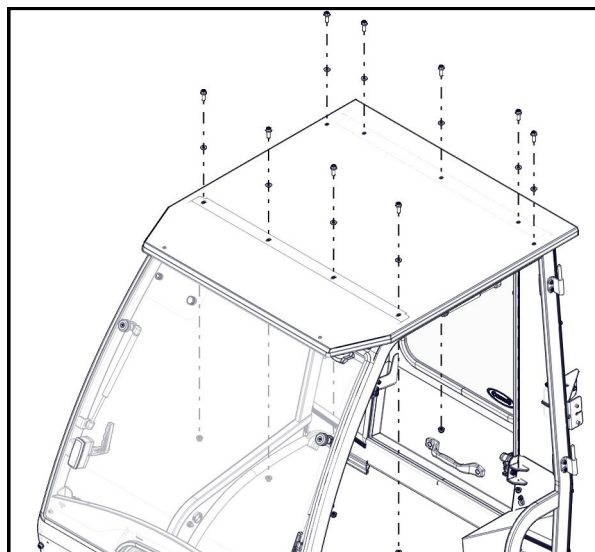

Fig. 15.1 (Roof Installation)



# CAB INSTALLATION

## STEP 17: (SWITCHED POWER HARNESS AND WIPER KIT)

*Wiper is optional on Standard Cab.*

**17.1** Install the front windshield wiper motor arm and blade per the installation instructions included with the wiper kit.

**17.2** Per figure 17.2, secure switched power wiring harnesses (from Step 2) to the cowl using the supplied P-Clips, plastic washers and hardware.

<b>Hardware Used</b>	<b>Qty</b>
#10-32 Pan Head Screw	3
#10 Plastic Washer	3
#10-32 Flange Nut	3
P-Clips	3

**17.3** Per figures 17.3a, 17.3b and 17.3c, secure the switched power harness to the right side frame with P-Clips and self-drilling screws. Note: Wire routing is critical, make sure the wires are placed on the inside of the cowl, and the outside of the twist latch catch found on the right side frame.

<b>Hardware Used</b>	<b>Qty</b>
#10 Self Drilling screws	2
P-Clips	2

**17.4** Connect the wiper wire harness to the wiper motor, trim to length and install female push-on connectors to connect to switched power harness

**17.5** Coil up any excess of the switched power wiring harness near the battery and wire tie in place. Tighten all P clips and wire ties.

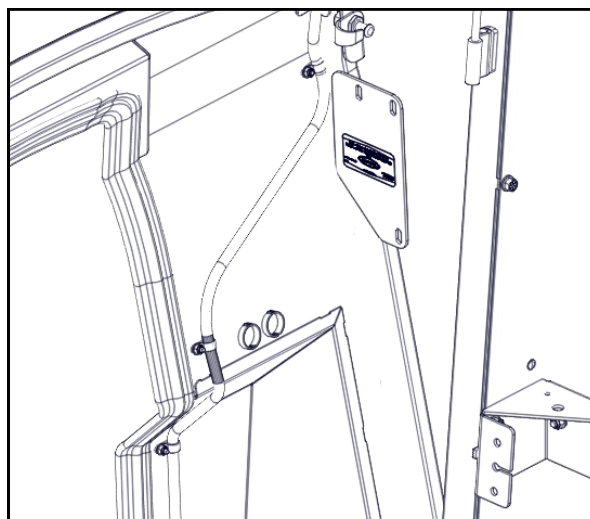

Fig. 17.2 Wire Loom Routing

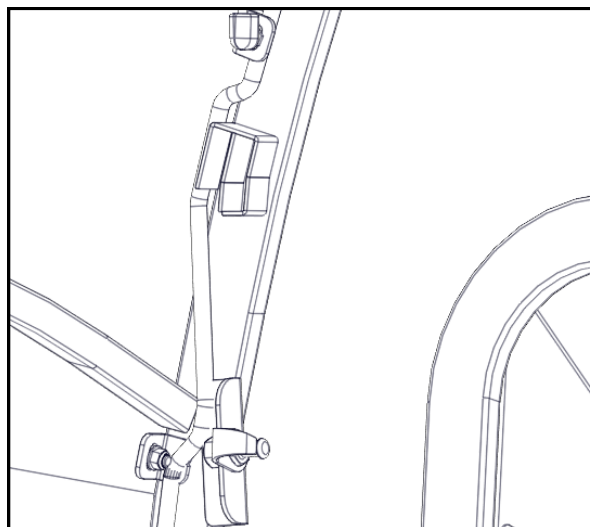

Fig. 17.3a Wire Loom Routing - Side frame

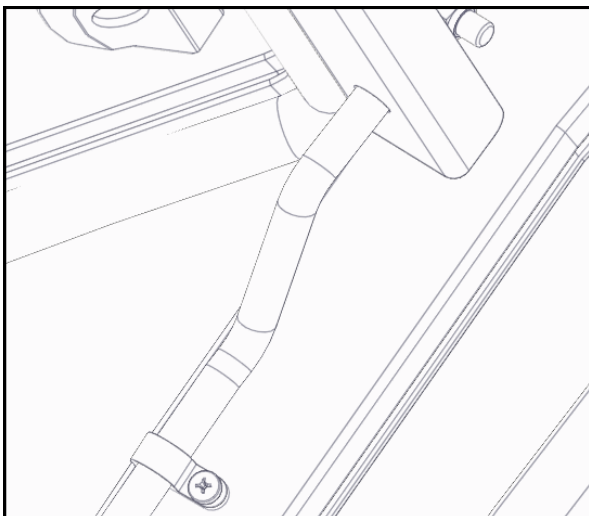

Fig. 17.3b Wire Loom Routing - Windshield Support

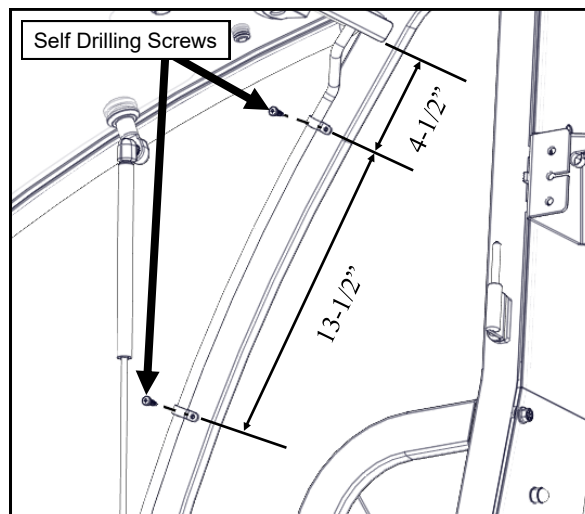

Fig. 17.3c Wire Loom Routing

# CAB INSTALLATION

## STEP 18: (FRONT LEG FILLERS)

**18.1** Per figures 18.1 and 18.1a, the longer of the two vinyl fillers is for the left side as shown. Begin by doing a dry fit to get a feel for where all areas fit best. (Left Filler highlighted in white for clarity). Apply the corresponding Velcro where deemed necessary and to match the Velcro on the vinyl filler.

**18.2** Per fig. 18.2, the shorter of the two vinyl fillers is for the right side as shown. Begin by doing a dry fit to get a feel for where all areas fit best. (Right Filler highlighted in white for clarity). Apply the corresponding Velcro where deemed necessary and to match the Velcro on the vinyl filler.

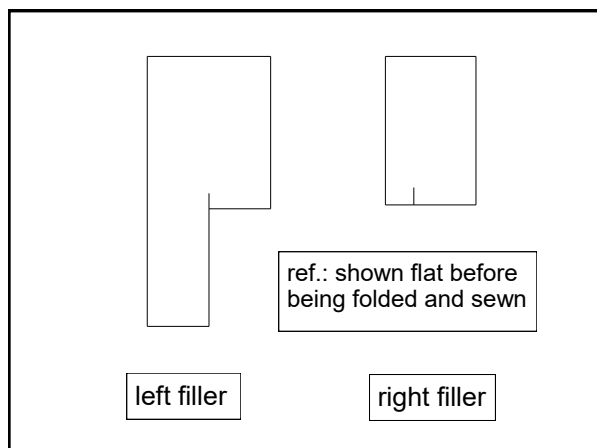

Fig. 18.1 (Left and Right Leg Fillers)



Fig. 18.1a (view from rear left side of tractor)

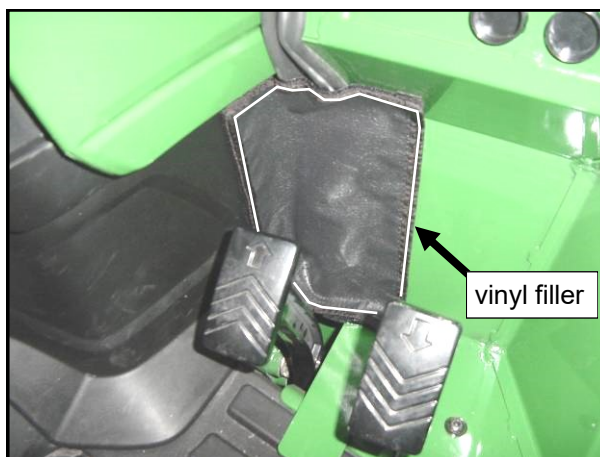

Fig. 18.2 (view from rear right side of tractor)

# CAB INSTALLATION

## STEP 19: (UNDERSEAT FILLERS)

### For 1023E Model Tractor.

*If installing onto a 1025R tractor, proceed to step 19.2 on the next page.*

**19.1** Move and tip the seat forward. Figures 19.1 thru 19.1c show the underseat filler. Begin by doing a dry fit to get a feel for where all areas fit best. (Underseat Filler highlighted in white for clarity). Example: slots are for seat belts to pass through, etc.. Start by lining up straight edge "A" with the lower rear panel. Apply the corresponding velcro where deemed necessary and to match the velcro on the vinyl filler. Do not cover up any factory decals.

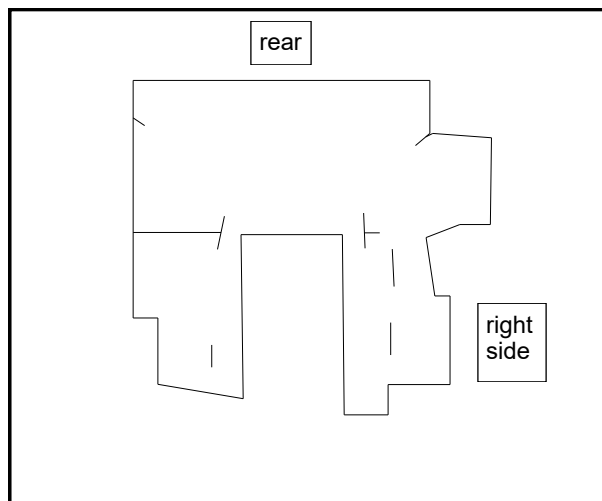

Fig. 19.1 (Underseat Filler)

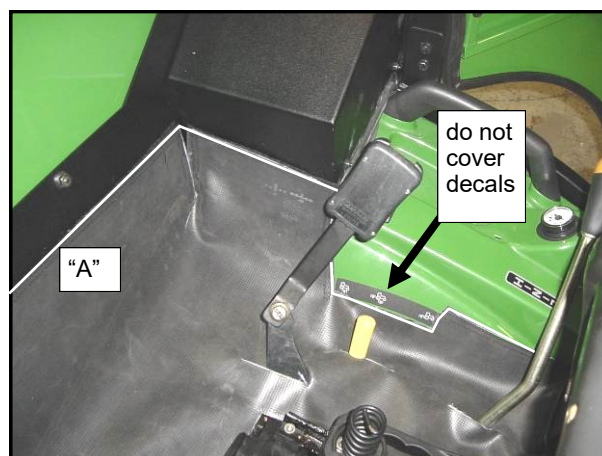

Fig. 19.1a (view of left side of tractor)

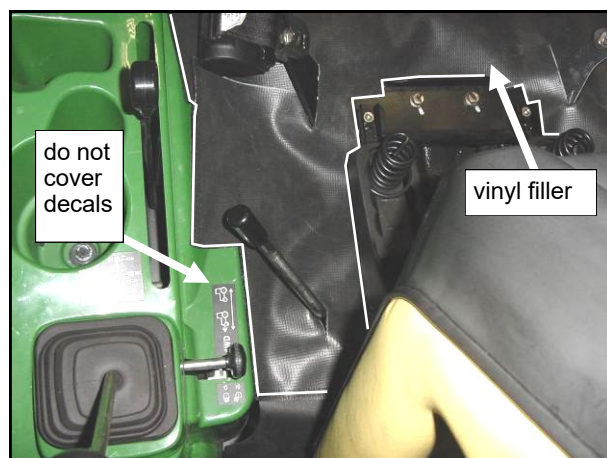

Fig. 19.1c (view from front right side of tractor)

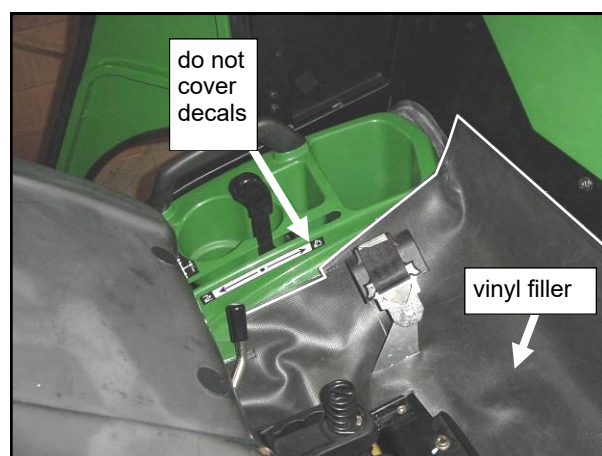

Fig. 19.1b (view from right side of tractor)



# CAB INSTALLATION

## STEP 19: (UNDERSEAT FILLERS)

### For 1025R Model Tractor.

*If installing onto a 1023E tractor, proceed to step 20 on the next page.*

**19.2** Move and tip the seat forward. Figures 19.2 thru 19.2c show the underseat filler. Begin by doing a dry fit to get a feel for where all areas fit best. (Underseat Filler highlighted in white for clarity). Start by lining up straight edge "A" with the lower rear panel. Apply the corresponding velcro where deemed necessary and to match the velcro on the vinyl filler. Do not cover up any factory decals.

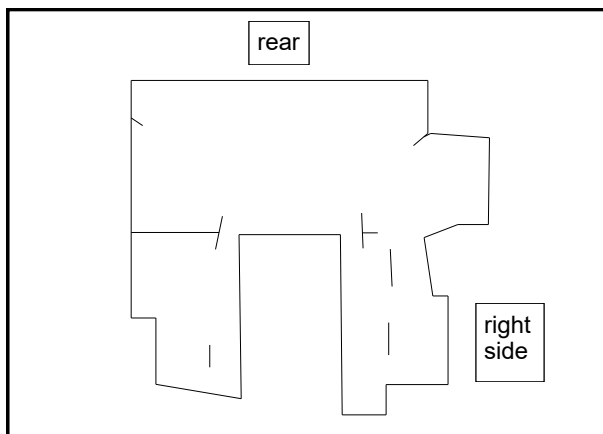

Fig. 19.2 (Underseat Filler)

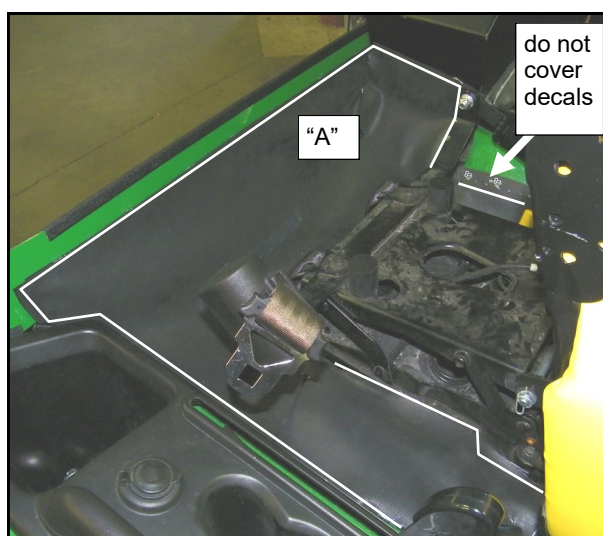

Fig. 19.2a (view of left side of tractor)

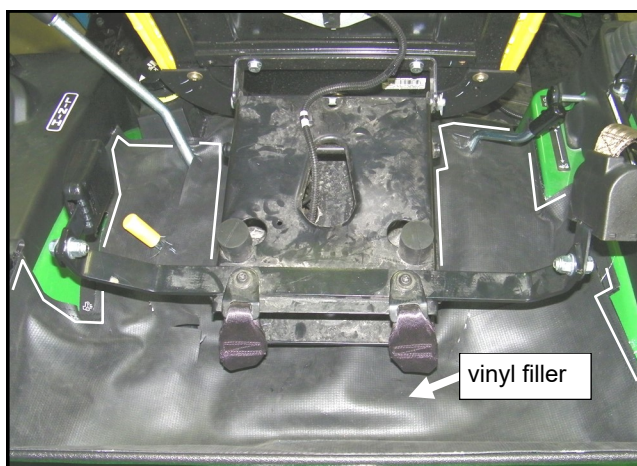

Fig. 19.2c (view from back of tractor)

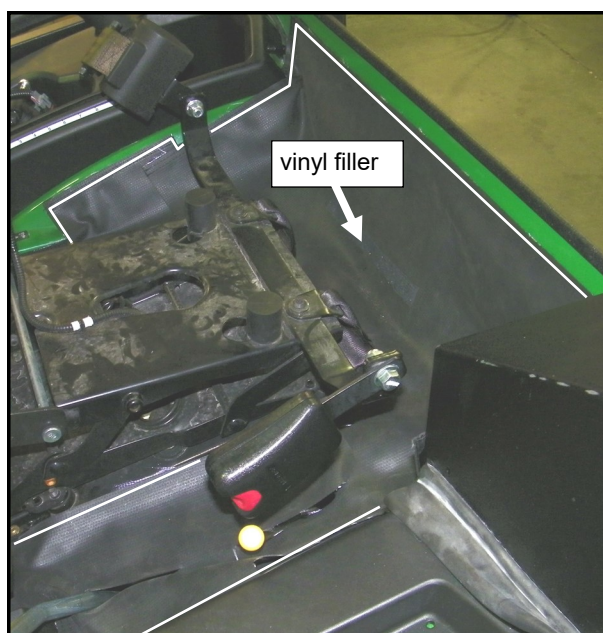

Fig. 19.2b (view from right side of tractor)

# CAB INSTALLATION

## STEP 20: (Rear Curtain)

*For Standard Cab only.*

*If installing a premium cab, proceed to step 21 on the next page.*

**20.1** Snap the supplied rear curtain to the inside of the rear panel header. See Fig. 20.1.

**20.2** Using the supplied velcro, secure the sides of the rear curtain and bottom edge to the sideframes and lower rear panel, respectively. See Fig. 20.2 and 20.2a.

**20.3** Install the hardware listed below into the exposed rivnuts found on the back of the sideframes. See Fig 20.3.

<b>Hardware Used</b>	<b>Qty</b>
5/16-18 Flange HCS	4
5/16 Plastic Washer	4



Fig. 20.1 (rear curtain installed)

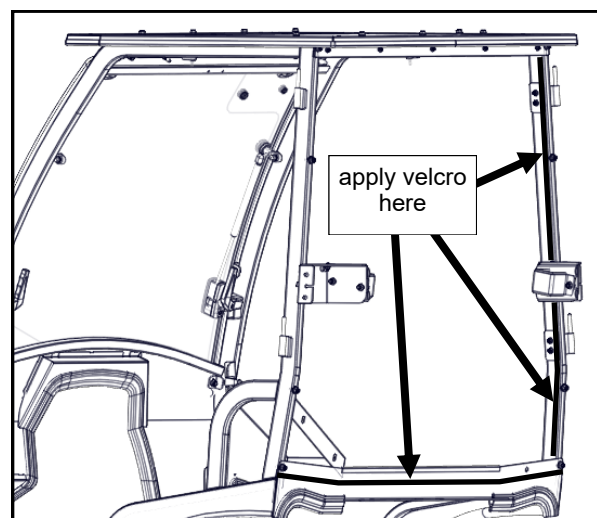

Fig. 20.2 (rear curtain - right side of cab)

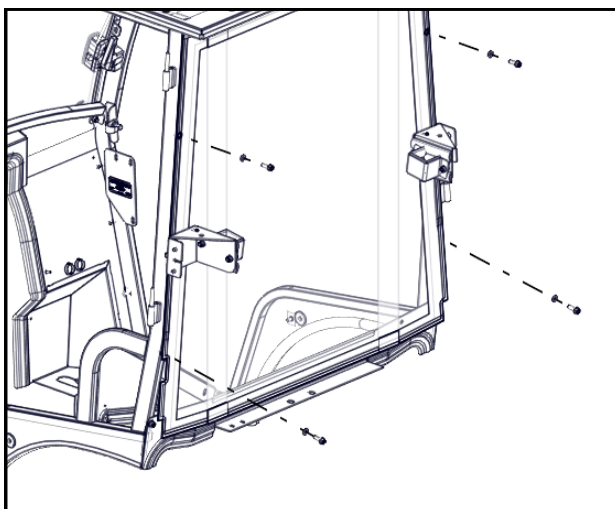

Fig. 20.3 (hardware for sideframes)

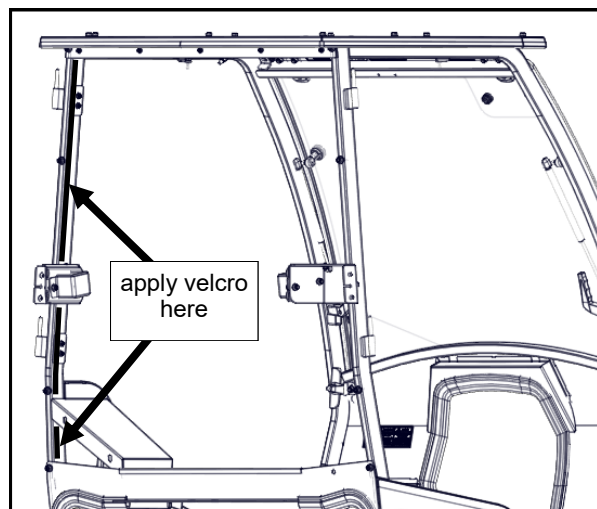

Fig. 20.2a (rear curtain - left side of cab)

# CAB INSTALLATION

## STEP 21: (DOORS)

**21.1** If the doors were removed for ease of handling, grease the hinge pins and re-install the doors into their respective hinge sleeves located on the side frames. See Fig. 21.1

*Note: Holding the door perpendicular to the side frame will ease installation. If hinge pins do not initially bottom out, rotate the door back and forth until hinges are seated properly.*

**21.2** Install the door gas shocks oriented so that the piston rod is pointing downhill (toward door) for best, continuous seal lubrication and longest gas shock life.

**21.3** The doors should “double click” for full engagement and proper closure. If necessary, make the following adjustments in this order:

- Adjust the striker pin on the side frame vertically - See Fig. 21.3a
- Adjust the latch located inside the door horizontally - See Fig. 21.3b
- Adjust the hinges located at the rear of the door - See Fig. 21.3c

*Note: The quickest, most common solution is to adjust the striker pin position on the side frame using two 3/4" open-end wrenches.*

**21.4** Once the doors are properly adjusted, lubrication (preferably grease) can be applied to the door striker pins and door latch assemblies.

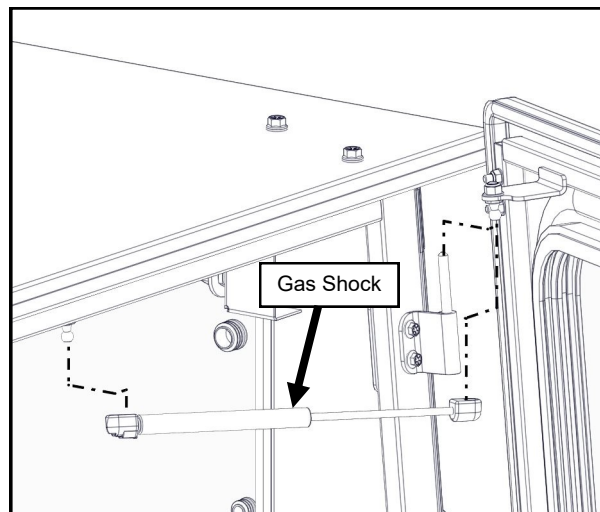

Fig. 21.1 (Door Installation)

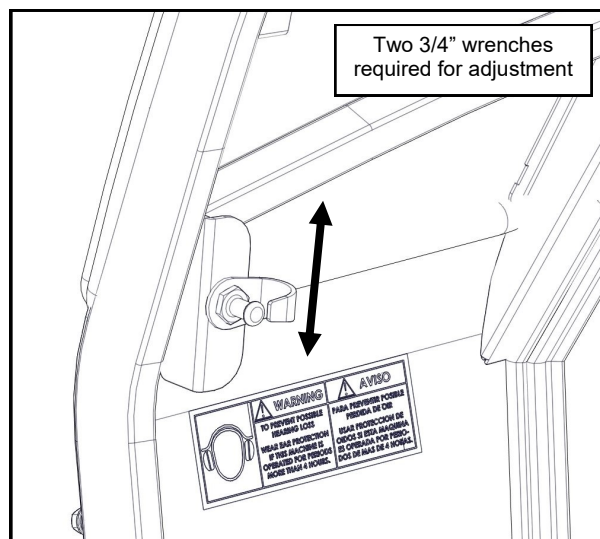

Fig. 21.3a (Door Striker Pin Adjustment)

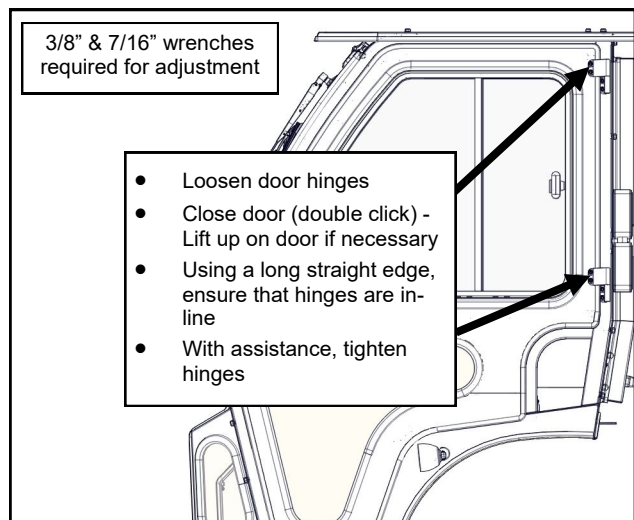

Fig. 21.3c (Door Hinge Adjustment)

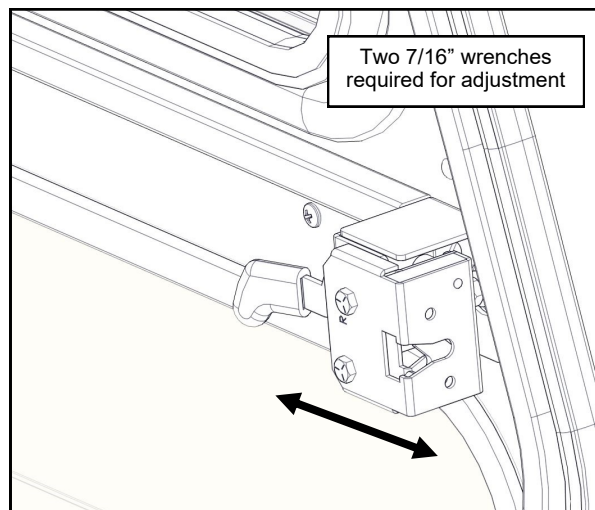

Fig. 21.3b (Door Latch Adjustment)



## CAB INSTALLATION

### STEP 22: (REMOVABLE REAR PANEL)

*For Premium Cab only.*

*If installing a standard cab, proceed to step 23 on the next page.*

**22.1** Lift rear panel and insert the upper pins into the receivers on the rear legs. Engage the lower quick release latches at this time. See Fig. 22.1.

*Note: The quick release latches require (2) clicks to be fully locked. Press the rear panel in from the outside in these locations to double click the latches.*

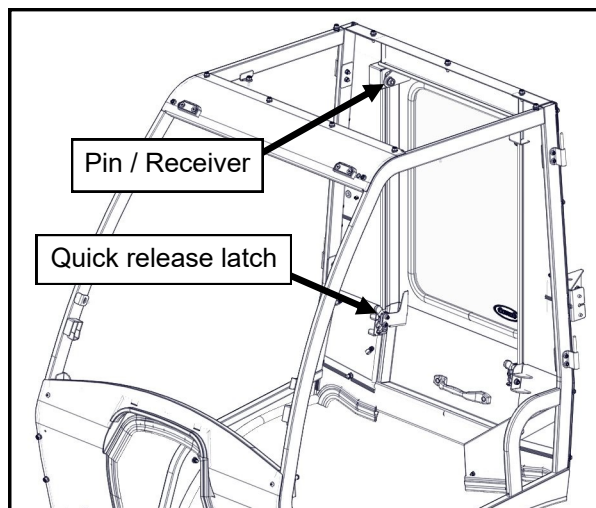

Fig. 22.1 (Rear Panel Installation)



# CAB INSTALLATION

## STEP 23: (REAR SIGNAL LIGHTS)

**23.1** Apply the supplied wire loom to the wires of each rear light, all the way up to each light.

**23.2** Run the light wires above the top mounting holes. Secure the lights to the mounts with the supplied M8 button head screws. See Fig. 23.2

**23.3** Run the wires with loom down the inside of the ROPS bracket and ROPS. Secure using the supplied P-Clips, #10-32 screws, and nuts. The screws go on the outside of the ROPS brackets with the P-Clips and flanged nuts on the inside. Using the (2) 11" long wire ties provided, secure the wire loom to the ROPS. See Fig. 23.3.

<u>Hardware Used</u>	<u>Qty</u>
M8 Button Head Screw	4
#10-32 Pan Head Screw	2
#10-32 Flange Nut	2

## STEP 24: (FENDER LIGHTS, IF EQUIPPED)

**24.1** Remove and discard the plastic hole plug that came installed on the left sideframe.

**24.2** Cut a slit through half of a large rubber grommet so they can be slid onto the fender light wiring.

**24.3** Connect the left fender wire extension to the left factory fender light. Next, thread the plug through the large hole in the sideframe, slide on the rubber grommet, and work and secure the grommet and wiring back into the hole, making sure that the slit in the grommet is facing down.

**24.3** Connect the right fender wire extension already installed in the right sideframe to the right factory fender light.

**24.5** Mount the supplied light brackets to the outside of the side frames. See Fig. 24.5. Do not tighten at this time.

**24.6** Plug the light into the factory wire harness and bolt it to the new bracket using the hardware listed below. Adjust and aim the light and tighten all hardware.

<u>Hardware Used</u>	<u>Qty</u>
5/16-18 Carriage Bolt	2
5/16-18 Flange Nut	4
5/16-18 X 2 LG Flange HCS	2

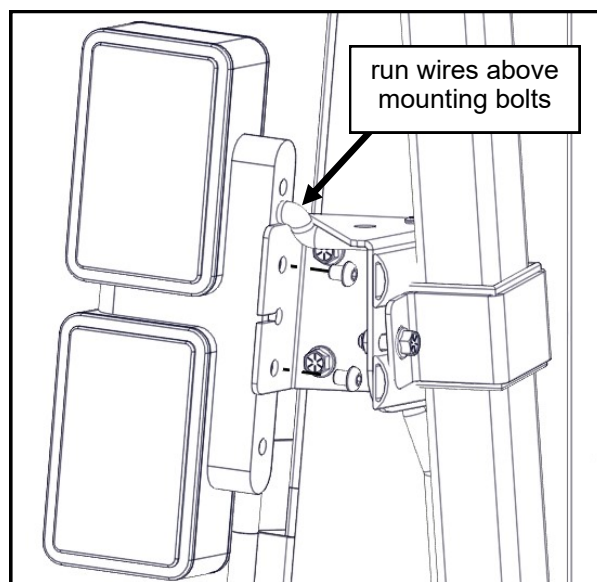

Fig. 23.2 (Rear Signal Light Installation)

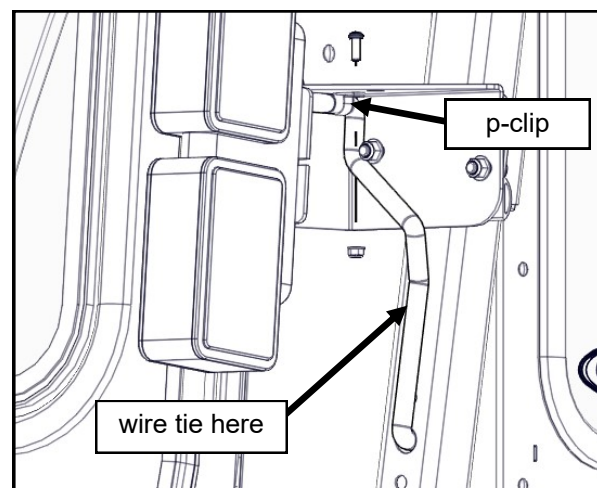

Fig. 23.3 (Rear Signal Light Wire Routing)

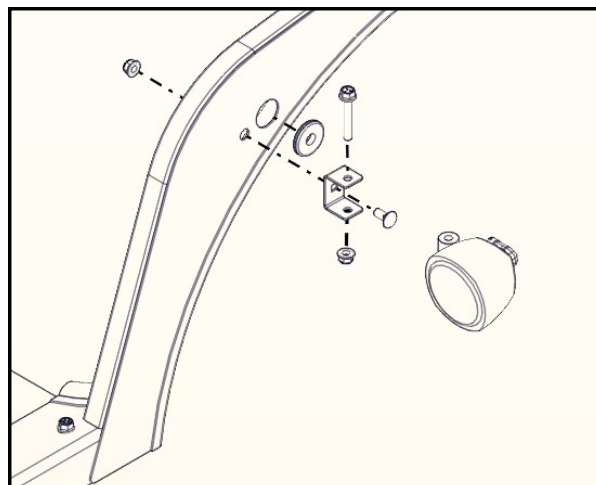

Fig. 24.5 (Fender Light Installation)

# CAB INSTALLATION

## STEP 25: (SMV SIGN)

*For Premium Cab only.*

*If installing a standard cab, proceed to step 26 on the next page.*

**25.1** Start by removing the (2) plastic hole plugs that came installed in the rear panel. Re-install SMV sign onto the removable rear panel using the provided (2) spacers, 1/4-20 bolts and flange nuts. See Fig 25.1.

*Note: Using a nail or other sharp object, pierce the back of the SMV sign at (2) mounting hole locations 6" apart from each other. See Fig 25.1a.*

<u>Hardware Used</u>	<u>Qty</u>
1/4-20 X 2-3/4" FHCS	2
#1/4-20 Flange Nut	2
2" long spacers	2

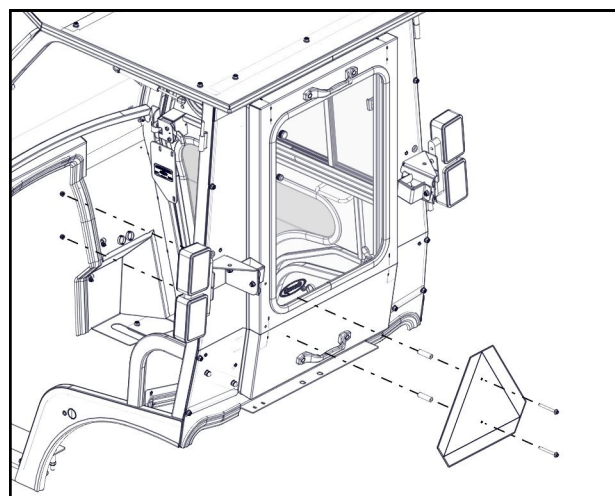

Fig. 25.1 (SMV Sign Installation)

## STEP 26: (AVOID CRUSHING DECAL)

**26.1** Install Avoid Crushing decal on the back of the right ROPS tube just below the previously installed wire tie. See fig. 26.1.

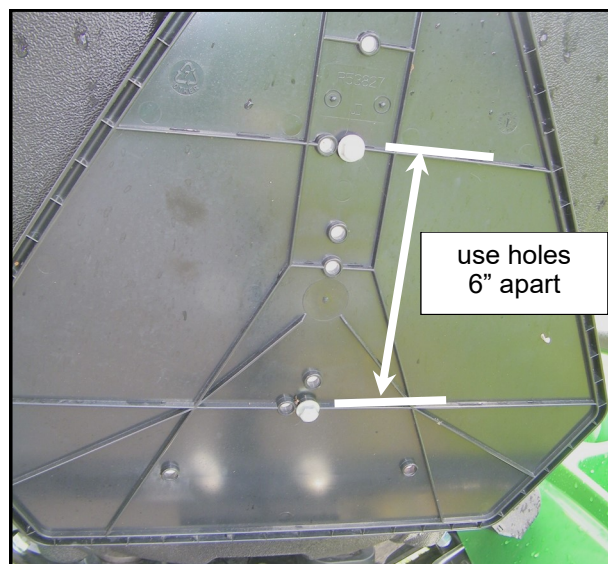

Fig. 25.1a (SMV Sign mounting holes)



Fig. 26.1 (Avoid Crushing Decal on right ROPS Tube)

# CAB FEATURES & OPERATION

## POP-OUT WINDSHIELD

Your 1 Family Premium cab comes equipped with a hinged and gas-shock-supported windshield. This feature allows for front ventilation, as well as allowing for the hood to fully open up.

To open the windshield, simply rotate both twist latches 90° and push the windshield out. The twist latch brackets have a second catch that can be used to lock the windshield slightly open for ventilation, or the windshield can be allowed to raise completely by the gas shocks.

**CAUTION:** to avoid injury or damage, do not operate tractor loader when windshield is fully open.

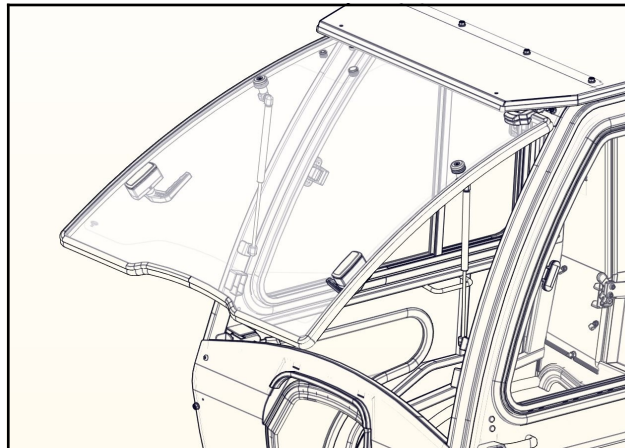

Pop-out Windshield

## LIFT-OFF DOORS

For added ventilation, the doors on the 1 Family Premium cab lift off in seconds without tools.

To lift off:

- 1) Disconnect the gas shock from the side frame by depressing the orange activator.
- 2) Rotate the doors 90° to the side frame and lift. *Store the doors in a safe location to prevent damage.*

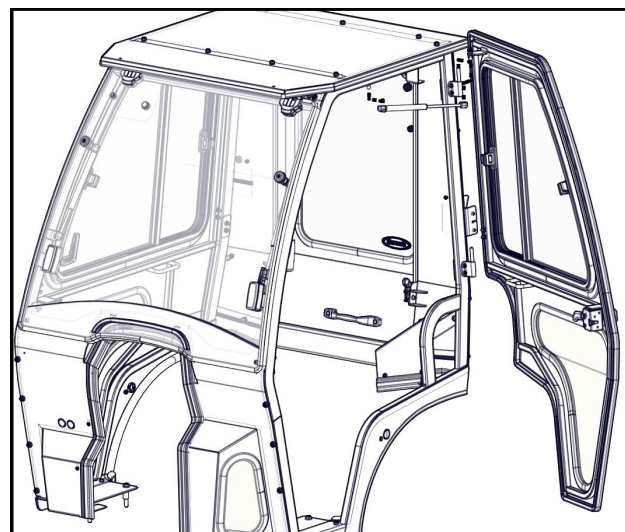

Lift-Off Doors

## REMOVABLE REAR PANEL (Premium Cab)

In order to use the backhoe on 1 Family tractors, the removal of the rear panel is necessary.

To remove the rear panel:

- 1) Release the two latches towards the bottom of the rear panel. It may be necessary to push out on the lower section of the rear panel to prevent the latches from re-engaging.
- 2) From outside of the cab, lift up on the rear panel and pull towards the backhoe. Store the rear panel in a safe location to prevent damage.

To reinstall the rear panel, simply align the pins at the top with the receivers on the rear legs and drop into place. Push in on the lower corners of the rear panel to ensure double latching of the quick release latches.

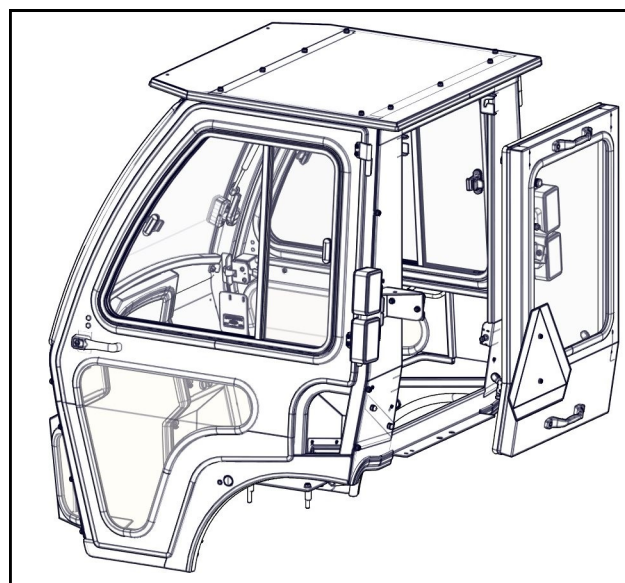

Removable Rear Panel

## OPTIONAL ACCESSORY INSTALLATION NOTES

### ELECTRICAL ACCESSORIES

1. Front LED Work Lights (P/N: 9LEDW4)
2. Rear LED Work Lights (P/N: 9LEDW3)
3. Rear Wiper (P/N: 9PWK65T)
4. Strobe Light (P/N: 9LEDS2)
5. Dome light (P/N 9LEDD14)
6. Heater (P/N: 9PH20S59)
7. Switch Panel (P/N: 9PSF1)

### ALL ELECTRICAL ACCESSORIES

A mounting location for (1) rocker switch and (3) toggle switches are provided in the windshield support.

The switched power harness is set up to run 2 accessories with a maximum 10 amp draw. Use for wiper and one additional accessory. Run all other accessories back to the battery or use optional switch panel.

## CARE AND MAINTENANCE

- Re-apply lubrication (preferably grease) periodically as needed to the door striker pins, door latch assemblies, and the door hinges.
- Check and tighten hardware after 40 hours of operation. Periodically inspect and tighten hardware for the remainder of the unit's life.
- Wash the painted surfaces of the cab with commercial automotive cleaning products.
- Clean windshield, sliders and rear window with glass cleaner. *Note: The cowl window and lower door windows on the cab are acrylic. DO NOT clean acrylic windows with harsh chemicals. It will damage the plastic. Mild soap and water should be used on all acrylic windows.*



# ENGINE COVER REMOVAL

## LOOSEN ENGINE COVER

See fig. 1. Remove the screw securing the top of the cover, then slide the cover toward the rear of the vehicle and slightly up. There are pins on the back side of the cover that fit into slots in the side of the tractor. See fig. 1a to see the slot design.

## PULL BOTH ENDS OF COVER AWAY

See fig. 2. Gently pull the front and rear of the cover away from the mounting slots and start sliding the cover towards the front of the vehicle.

## SLIDE FORWARD AND UP

See fig. 3. Slide the cover forward and up while pulling the front and rear away from the vehicle to clear the mounting slots. There is enough room between the vehicle and the sealing rubber of the cab to slide the engine cover in and out.

## TO RE-INSTALL COVER

Reverse this process to re-install the side engine cover.

For a video of this process, please visit:

<https://youtu.be/vSv4As-J6Y8>

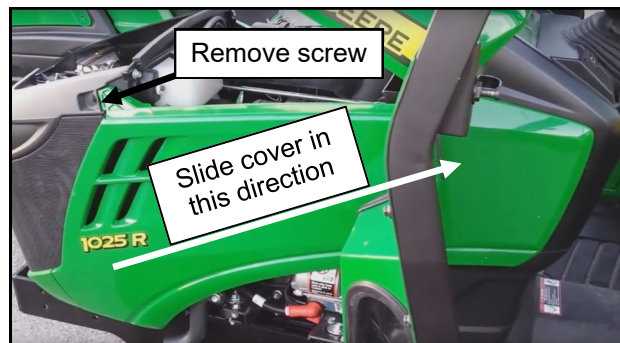

Fig. 1 (Loosen engine cover)

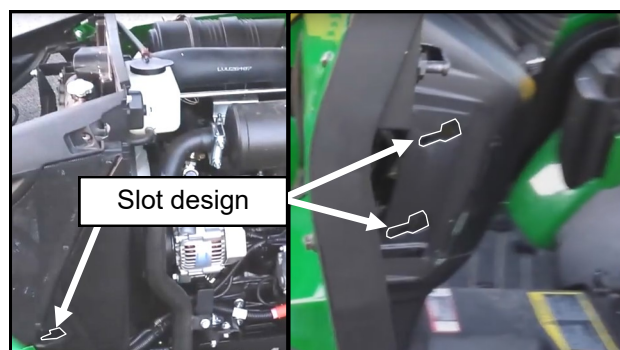

Fig. 1a (Note slot design behind cover)



Fig. 2 (Pull panel away to clear slots)



Fig. 3 (Slide forward and up)

# JOHN DEERE 1 FAMILY PREMIUM & STANDARD CABS (P/N: 1JD1FPR & 1JD1FST)

ROOF ASSEMBLY  
P/N:8SV-101-00004

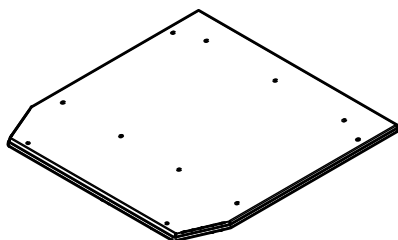

WINDSHIELD ASSEMBLY  
P/N:8SV-BX502

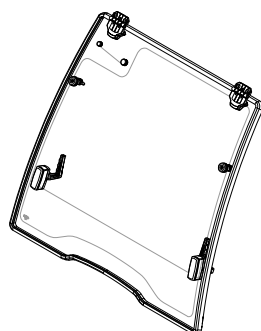

WINDSHIELD SUPPORT ASS'Y  
P/N:8SV-103-00004

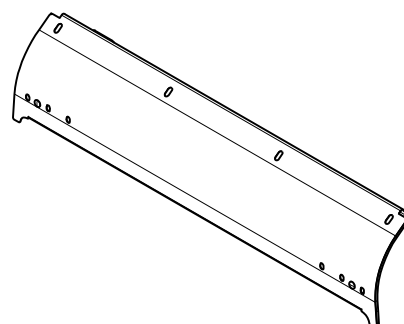

COWL ASSEMBLY  
P/N:8SV-105-00005

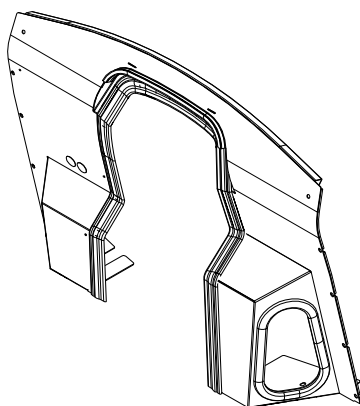

REAR PANEL ASSEMBLY  
P/N:8SV-106-00003

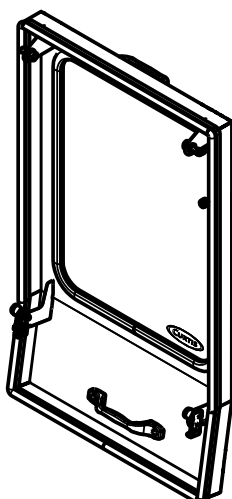

RIGHT DOOR ASSEMBLY  
P/N:8SV-107-00003-R

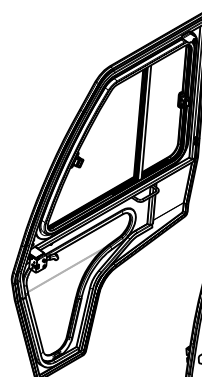

LEFT DOOR ASSEMBLY  
P/N:8SV-107-00003-L

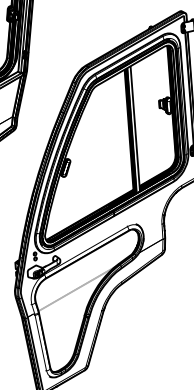

RIGHT SIDEFAME ASS'Y.  
P/N:8SV-109-00001-R

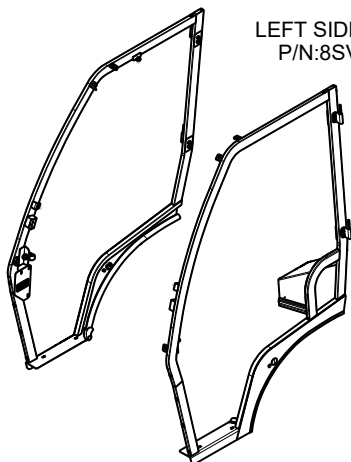

LEFT SIDEFAME ASS'Y.  
P/N:8SV-109-00001-L

ROPS MOUNT W/  
CLAMP, LEFT  
P/N:8SV-JD1RCA-L

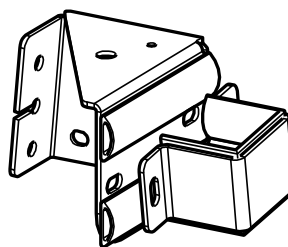

ROPS MOUNT W/  
CLAMP, RIGHT  
P/N:8SV-JD1RCA-L

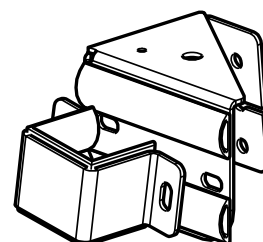

TRIM-LOK	1" FLAT BULB	ARCH PSA	WINDOW RUBBER	1-1/2" DBL SIDE BULB & 1 WIPER	1/2" V-GROOVE	SIDE BULB, 3/4" OFFSET(1/4")	5/8" REG. BULB
9SV-PRO1-20	9SV-PR05-10	9SV-PRO9-10	9SV-PR10-10	9SV-PR41-15	9SV-PR20-10	9SV-PR26-20	9SV-PR02-15

# JOHN DEERE 1 FAMILY PREMIUM & STANDARD CABS (P/N: 1JD1FPR & 1JD1FST)

RIGHT REAR LEG ASS'Y.  
P/N:8SV-108-00001-R

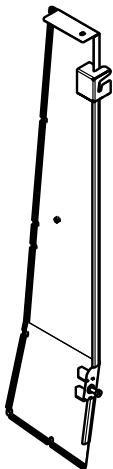

LEFT REAR LEG ASS'Y.  
P/N:8SV-108-00001-L

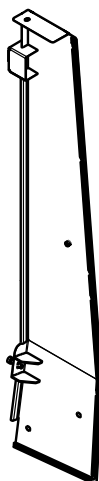

LOWER REAR PANEL ASSEMBLY  
P/N:8SV-113-00005

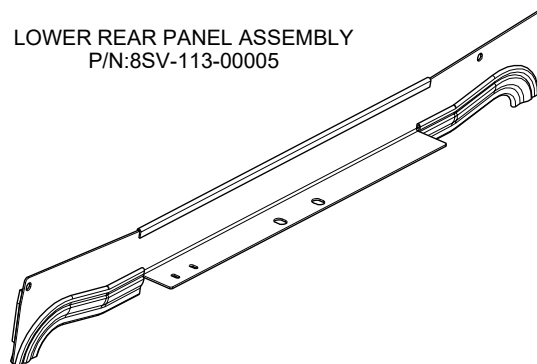

HEADER REAR PANEL ASSEMBLY  
P/N:8SV-113-00004

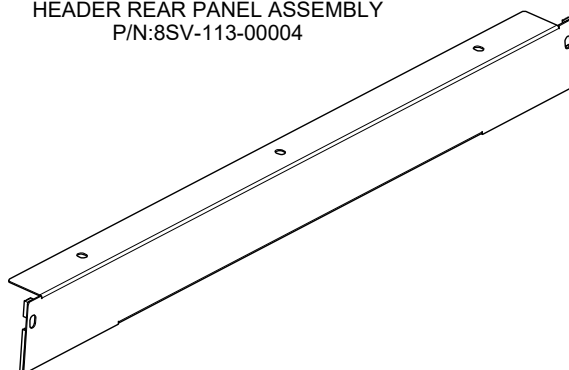

RIGHT FRONT MOUNT  
P/N:8SV-JD110R-B4

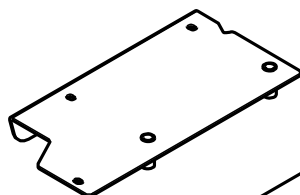

LEFT FRONT MOUNT  
P/N:8SV-JD110L-B4

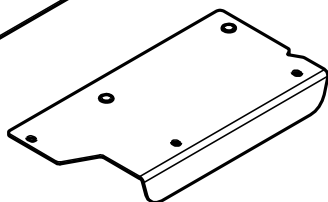

UNDERSEAT FILLER  
P/N:8SV-JD112

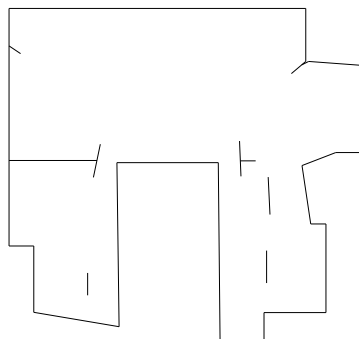

RIGHT LEG FILLER  
P/N:8SV-JD111R-VC



FUEL FILLER SEAL PLATE  
P/N:8SV-JD113-BH

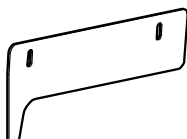

LIGHT BRACKET  
P/N:8SV-SM-00039

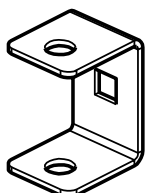

LEFT LEG FILLER  
P/N:8SV-JD111L-VC



1" SIDE BULB	1" ROUND BULB	3/4" SIDE BULB
9SV-PR16-10	9SV-PR19-10	9SV-PR17-5



# JOHN DEERE 1 FAMILY STANDARD CAB (P/N: 1JD1FST)

RIGHT DOOR ASSEMBLY, STANDARD  
P/N:8SV-107-00005-R

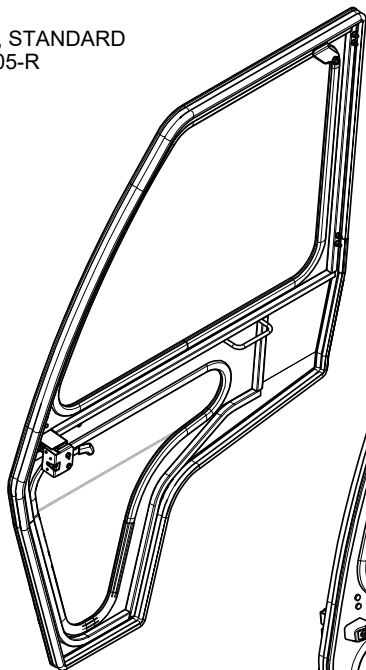

LEFT DOOR ASSEMBLY, STANDARD  
P/N:8SV-107-00005-L

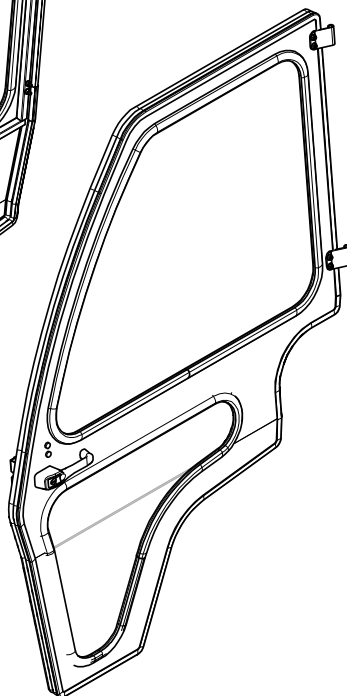

REAR HEADER ASSEMBLY, STANDARD  
P/N:8SV-113-00012

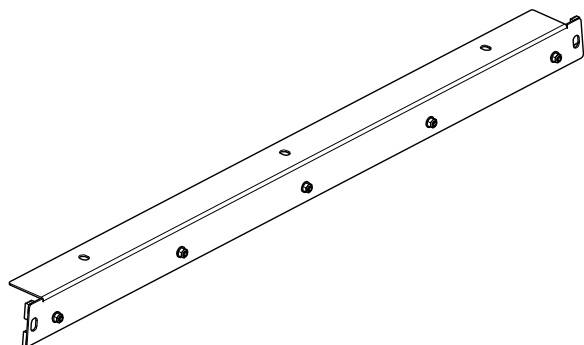

REAR CURTAIN  
P/N:8SV-112-00003

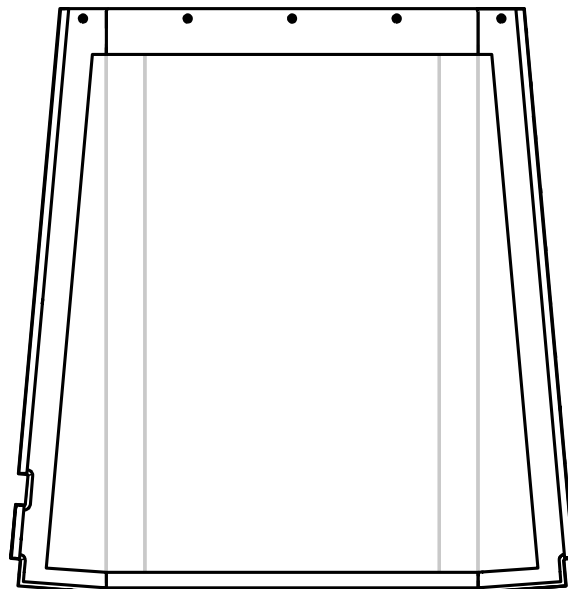

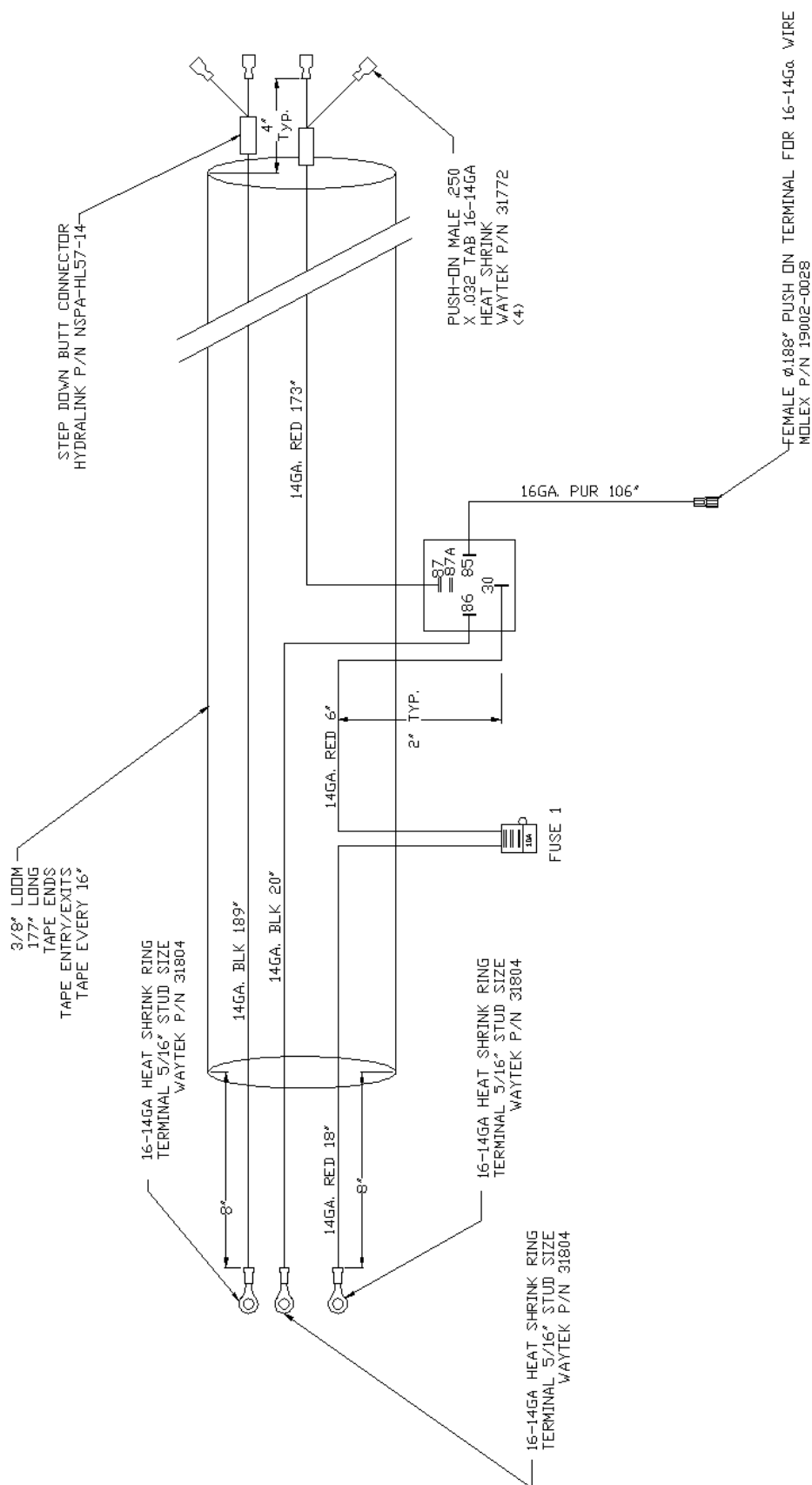

## ADDITIONAL SERVICE PARTS

QTY.	PART NUMBER:	DESCRIPTION:
1	9SV-RFL	ROOF LATCH KIT (INCL. L & R) (REAR PANEL)
1	8SV-9GL-00010	REAR PANEL, GLASS JD1F, 20.06 X 26.38 X 3/16
1	9SV-DSTRH	DOOR STRIKER KIT-INCLUDES CASE HARDENED STRIKER BOLT (SET OF 5)
1	9SV-WL2	WINDSHIELD LATCH KIT 2 - FULLY OPENS W/S
1	9SV-HWS	WINDSHIELD HINGE KIT WITH SPACER
1	9SV-GSM	GAS SPRING MOUNT (SET OF 2)
1	9SV-DP04	DOMES PLUG 1-1/8" (BAG OF 15)
1	8SV-P-00005-L	WINDOW, DOOR, LOWER, LEFT JD1F, 26.22 X 21.94 (ACRYLIC)
1	8SV-P-00005-R	WINDOW, DOOR, LOWER, RIGHT JD1F, 26.22 X 21.94 (ACRYLIC)
1	8SV-9SW-00003-L	SLIDING WINDOW, JOHN DEERE 1 FAMILY, LEFT
1	8SV-9SW-00003-R	SLIDING WINDOW, JOHN DEERE 1 FAMILY, RIGHT
1	9SV-IHRL	INSIDE HANDLE ROTARY LATCH KIT (INCL. L & R)
1	9SV-OHRL	OUTSIDE HANDLE ROTARY LATCH KIT (SET OF 2)
1	9SV-GS02A	BALL STUDS, 10MM (BAG OF 10)
1	8SV-SM-00121	HINGE SPACER, 1/4", TXT BLACK (SET OF 4)
1	8SV-SM-00122	LATCH SPACER, 1/4", TXT BLACK (SET OF 2)
1	HWK-00004	HARDWARE KIT, PREMIUM 1JD1FPR
1	9SV-GS02Q	GAS SPRING - 12" W/QUICK RELEASE END (SET OF 2) (DOORS)
1	9SV-GS07	GAS SPRING - 200N (SET OF 2) (WINDSHIELD)
1	9PWM110	WIPER MOTOR, 110 DEGREE
1	9PWA14-16	WIPER ARM, ADJUSTABLE LENGTH (11" - 16")
1	9PWB20-FB	WIPER BLADE, 20", FLEX
1	9PWK-HB	GLASS MOUNTING KIT FOR WIPER SYSTEMS
1	9SV-WH-00004	WIRING HARNESS, SWITCHED POWER (10 AMPS 2 ACCESSORIES MAX)
1	9SV-WH-00007	WIRING HARNESS, FENDER LIGHT
1	9SV-PWKWIP	STANDARD WIPER WIRING KIT
1	8SV-P-00008	WINDOW, DOOR, UPPER, JD1F, 36.03 X 28.29 (ACRYLIC)
1	8SV-113-00016	HOOD LATCH ADAPTER KIT