



JOHN DEERE GATOR CORNER FLASHERS INSTRUCTIONS

(p/n: 1XUVFLK)

(Note: Only fits with 1GTRXUV2 and 1GTRXUV4 Cabs with the 1GXV2SP Switch Panel installed)

(Note: A separate extension harness kit (1XUV4WHEK) is required for 4 Passenger cabs)

This manual is the property of the owner. Be sure to leave with the owner when installation is complete.

Kit Contents:

Item:	Qty:	Description:	Service Part:
1	2	Front Flasher Bracket	8SV-XUVFFM
2	4	Flasher Unit	8SV-LEDSART
3	1	Momentary Flasher Switch	8SV-XUVFLP1
4	1	Flasher Wire Harness	9SV-XUVFWH
5	15	11" Cable Ties	NA
6	1	Switch Cover (Flasher)	9PCD1N
7	4	6-32 x 3/4" Machine Screw	NA
8	4	6-32 Nylon Locknut	NA
9	2	3/8" Rubber Grommet	NA
10	2	5/16-18 x 3/4" Flange Bolt	NA
11	2	5/16-18 Nylon Flange Nut	NA
12	1	Instructions	9SV-IMXUVFLK

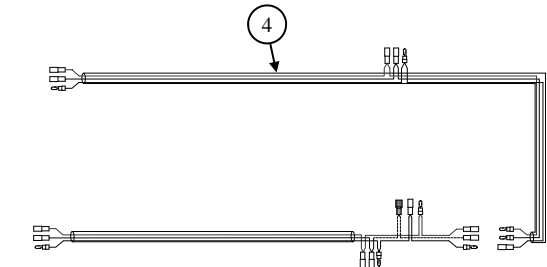
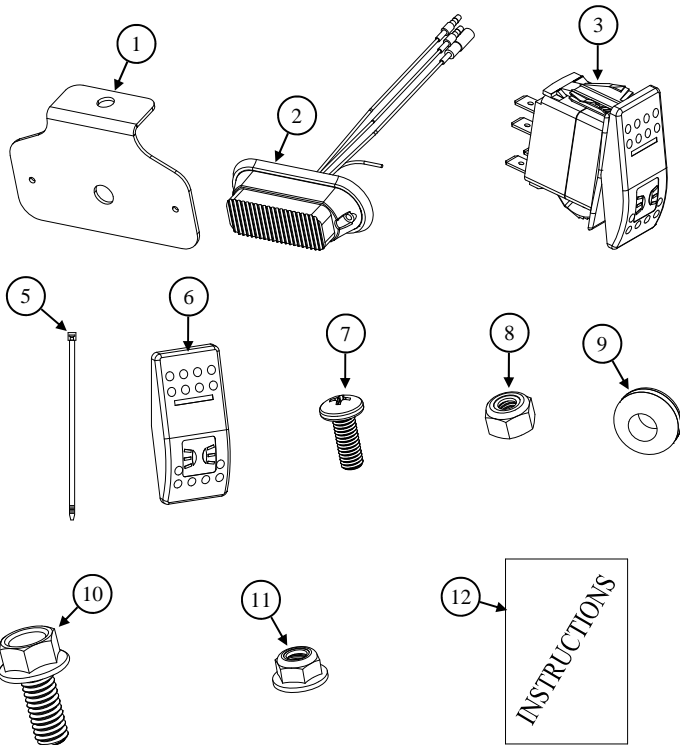

Note: This flasher kit is designed to fit with the optional Switch Panel only. The kit does not include provisions for mounting without the Switch Panel.

1. Install Rear Flashers:

1.1 Remove and discard the four phillips head screws and the two hole plugs from the rear panel above the window as shown in Figure 1.1. If flasher mounting holes do not line up with the small holes in the panel, drill the small holes with a 3/16" bit.

1.2 Push the wires through the larger center holes and fasten the lights to the rear panel with the hardware listed. Note: The holes are already tapped from the removed screws, but it is recommended to add the locknut on the inside to prevent vehicle vibration from backing the screws out.



Figure 1.1 - Install Rear Flashers

Qty	Hardware
4	6-32 x 3/4" Machine Screw
4	6-32 Nylon Lock Nut

2. Install Front Flashers:

2.1 Push the wires through the large center holes on the supplied brackets and fasten the lights to the brackets with the hardware listed as shown in Figure 2.1.

<u>Qty</u>	<u>Hardware</u>
4	6-32 x 3/4" Machine Screw
4	6-32 Nylon Lock Nut

2.2 If it is not already hanging, remove the bolts holding the switch panel and allow it to hang on the cables.

2.3 Remove the outermost hole plugs on the windshield support and feed the four wires from the flasher through the hole.

2.4 Bolt each bracket to the roof using the hardware listed as shown in Figure 2.4. Rotate the flasher to the desired position and tighten.

<u>Qty</u>	<u>Hardware</u>
2	5/16-18 x 3/4" Flange Bolt
2	5/16-18 Nylock Flange Nut

2.5 Install rubber grommets on the wires and push them into the hole in the windshield support. Note: use a silicone sealant to seal between the wires and the grommet to prevent any water from entering the cab.

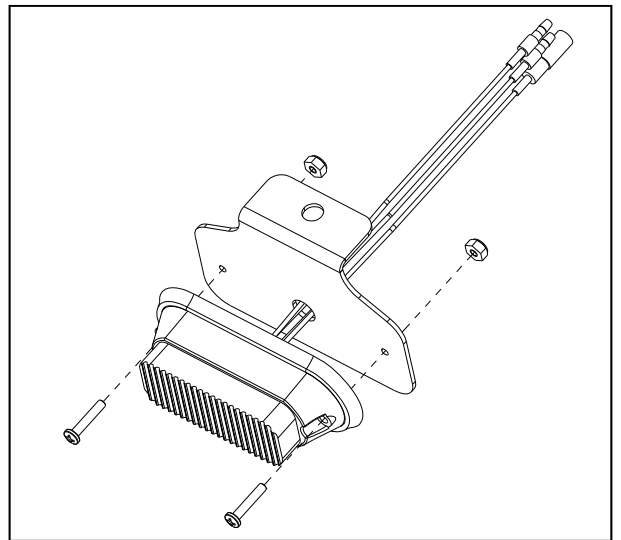

Figure 2.1 - Assemble Front Flashers

3. Connect Wiring

Note: For 4 Passenger, cab a separate harness extension is required.

3.1 Per Figure 3.1, connect the harness to the white and black wires located on the back of the strobe light switch in the switch panel.

3.2 Locate the momentary switch in the kit. This switch will be used to synchronize the flashers and set the flash pattern. Attach the push on terminal shown on the harness in Figure 3.1 to terminal 3 on the switch.

3.3 Connect the additional red power wire with push on terminal that is on the back of the switch panel strobe light switch to terminal 2 on the momentary switch.



Figure 2.4 - Install Front Flashers

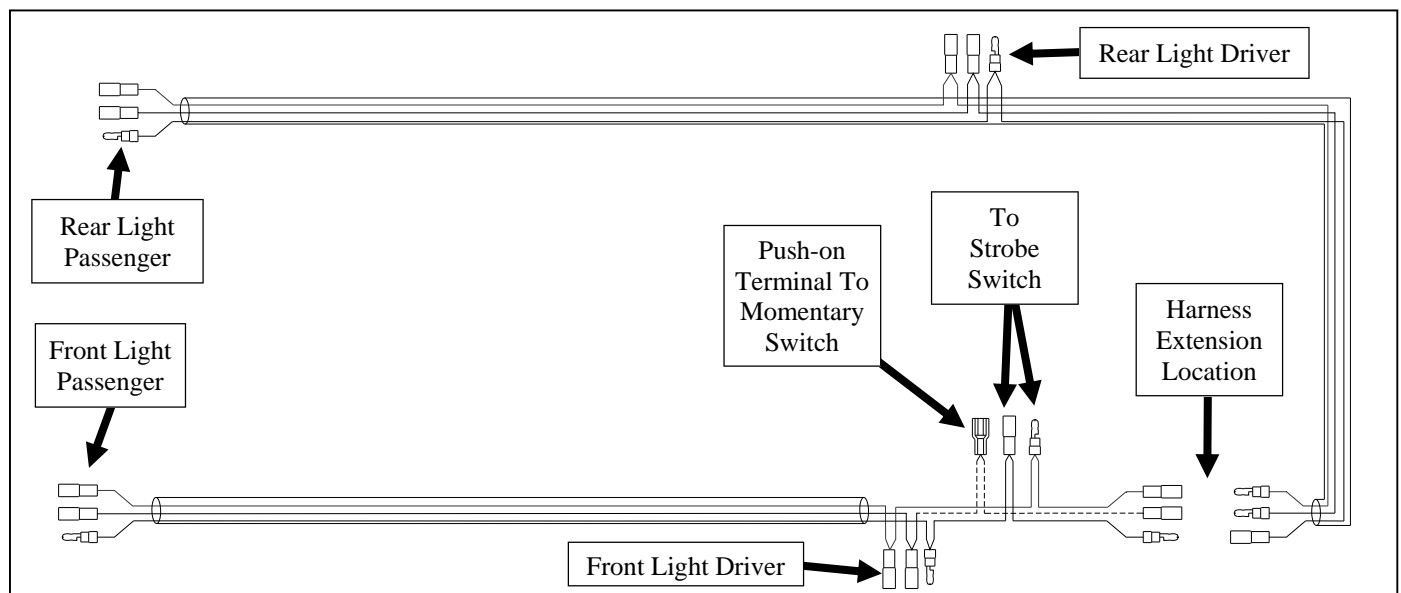

Figure 3.1 - Wire Connections

3. Connect Wiring (continued)

3.4 Route the short side of the supplied harness to each of the front flashers and connect the terminals. Black (Flasher) to Black (Harness), Red (Flasher) to White (Harness), and Yellow (Flasher) to Green (Harness). The white wire on the flasher is not used and can be taped out of the way.

3.5 If installing on a 4 passenger cab, install the extension harness at this time where shown in Figure 3.1.

3.6 Route the rear portion of harness out through the left grommet in the switch panel and back to the rear lights. Be sure to pass through the OPS brackets when routing the wire.

3.7 Connect the rear lights to the harness in the same manner as the front lights.

3.8 Remove the red strobe light switch cover from the front of the switch panel and install the supplied flasher switch cover. It can be removed by hand or with a flat blade screwdriver.

4. Set Flash Pattern

4.1 The flashers have multiple flash patterns built into memory and need to be synchronized.

4.2 Turn the key on and test the operation of the flashers. With the flasher switch turned on, press and hold the momentary switch for approximately 5 seconds. This will synchronize the flashers to be on the same pattern.

4.3 Press the momentary switch once to change the flash pattern. Continue to push the momentary switch until the desired pattern is found.

4.4 Once the desired pattern is set, the flashers will retain this setting in memory.

4.5 After the flashers are all set-up, secure all wiring to the OPS tube with the supplied cable ties. Once the switch panel is put back up into place, push any excess wire into the panel.