

JOHN DEERE GATOR SWITCH PANEL INSTRUCTIONS FITS 1GTRXUV2 AND 1GTRXUV4 CABS (p/n: 1XUVSP)

Note: Harness Extension Kit Required for 4 Passenger (p/n: 1XUV4WHEK)

This manual is the property of the owner. Be sure to leave with the owner when installation is complete.

Kit Contents:

| Item: | Qty: | Description: | Part Number: |
|-------|------|-------------------------------|---------------|
| 1 | 1 | Switch Panel Assembly | NA |
| 2 | 1 | Vehicle Wire Harness | 9SV-XUVVWH |
| 3 | 10 | 11" Cable Ties | NA |
| 4 | 2 | 10-32 x 5/8" Pan Head Screw | NA |
| 5 | 2 | 10-32 Nylock Nut | NA |
| 6 | 8 | 1/4-20 x 3/4" Flange Bolt | NA |
| 7 | 1 | Instructions | 9SV-IM1GXV2SP |
| 8 | 1 | Switches and Switch Covers | 9SV-CSXUV |
| 9 | 1 | Circuit Breaker with Nut | 9SV-CB-10A |
| 10 | 1 | Switch Panel Harness (Hidden) | 9SV-XUVSPWH |
| 11 | 1 | Dome Light | 8SV-LEDDL |

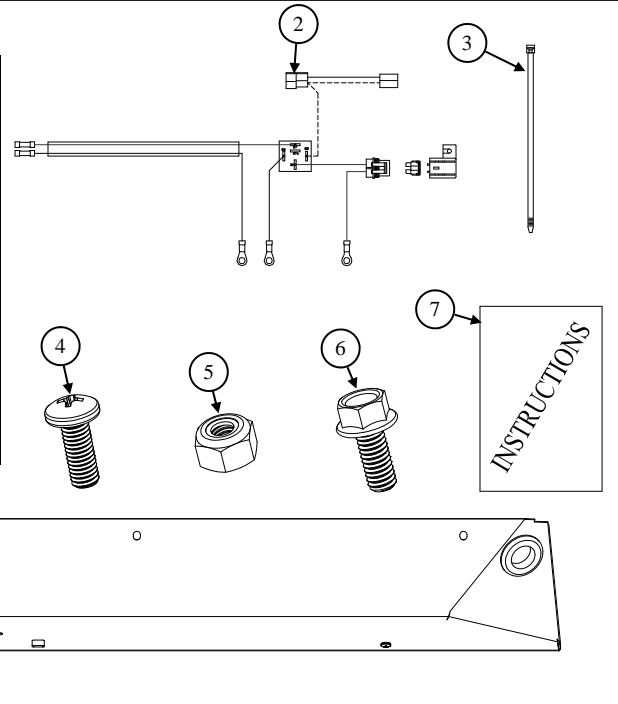

Parking Safety

1. Stop machine on level surface
2. Set parking brake
3. Remove key
4. Wait for engine and all moving parts to stop before leaving the vehicle.

CAUTION: Avoid Injury! Touching hot surfaces can burn skin. The engine, components, and fluids will be hot if the engine has been running. Allow engine to completely cool before servicing or working near the engine or components.

1. Switch Panel Installation:

1.1 Orient the switch panel so that the switches are in front of the driver's face. Using the hardware listed below, attach the two cables to the windshield support panel as shown in Figure 1.1. The cables allow the panel to hang while wire connections are made. Note: The cable should be installed on the inside of the windshield support panel as shown to prevent interference when the switch panel is installed.

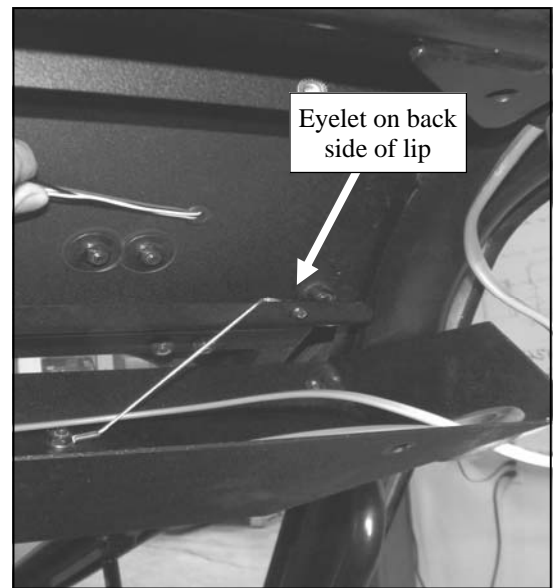

Figure 1.1 - Hang Panel (Pass. Side Shown)

| <u>Qty</u> | <u>Hardware</u> |
|------------|----------------------------|
| 2 | 10-32 x 5/8" Machine Screw |
| 2 | 10-32 Nylon Lock Nut |

Switch Panel Installation: (continued)

1.2 Route the cut end of the large jacketed wire (contains white and black wires) out through the grommet on the passenger's side and feed the end into the hole in the OPS (operator protective structure) that is located beneath the front OPS cross tube bracket. For easier wire installation, removal of the roof bolt that is fastened through the OPS is suggested.

1.3 Feed the wire into the OPS until it emerges from the tube behind the seat.

1.4 Route the wire under the front seat as shown in Figure 1.4.

2. Connect Wiring:

2 Passenger only: (Use Figure 2.1 as a reference)

2.1 Locate the supplied vehicle tie-in harness and connect the ring terminal on the red wire to the positive battery lug and the ring terminals on the black wires to the negative battery lug or ground screw.

2.2 Cut back the jacketing on the end of the wire coming from the switch panel and strip the ends of the two wires. Crimp the wires into the butt connectors at the end of the tie-in harness as shown in Figure 2.1. The wires should be connected white to red and black to black. Be sure the wires are routed under the seat base when crimped so they will not be pinched.

2.3 Connect the plugs on the end of the yellow relay wire to the mating plug on the vehicle harness located in the battery compartment.

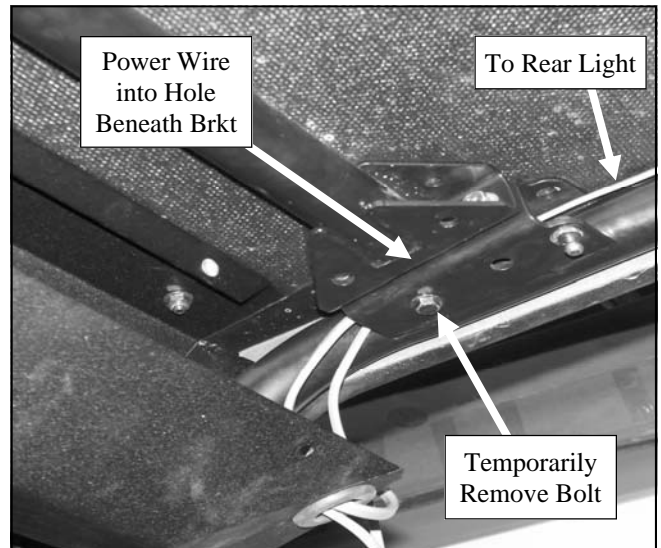

Figure 1.2 - Route Wire (Pass. Side Shown)

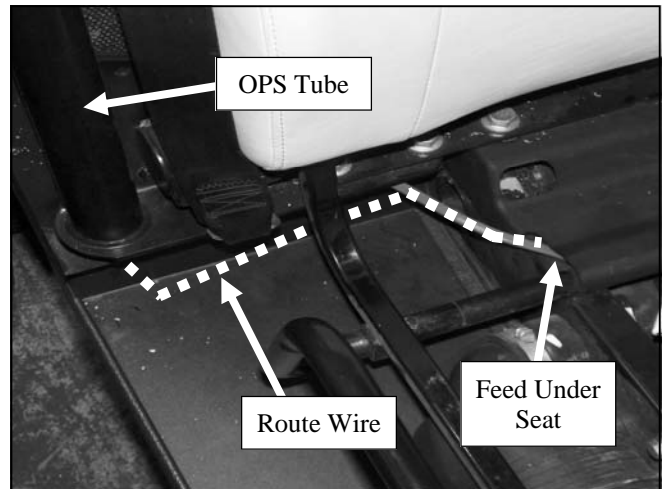

Figure 1.4 - Route Wire (Pass. Side Shown)

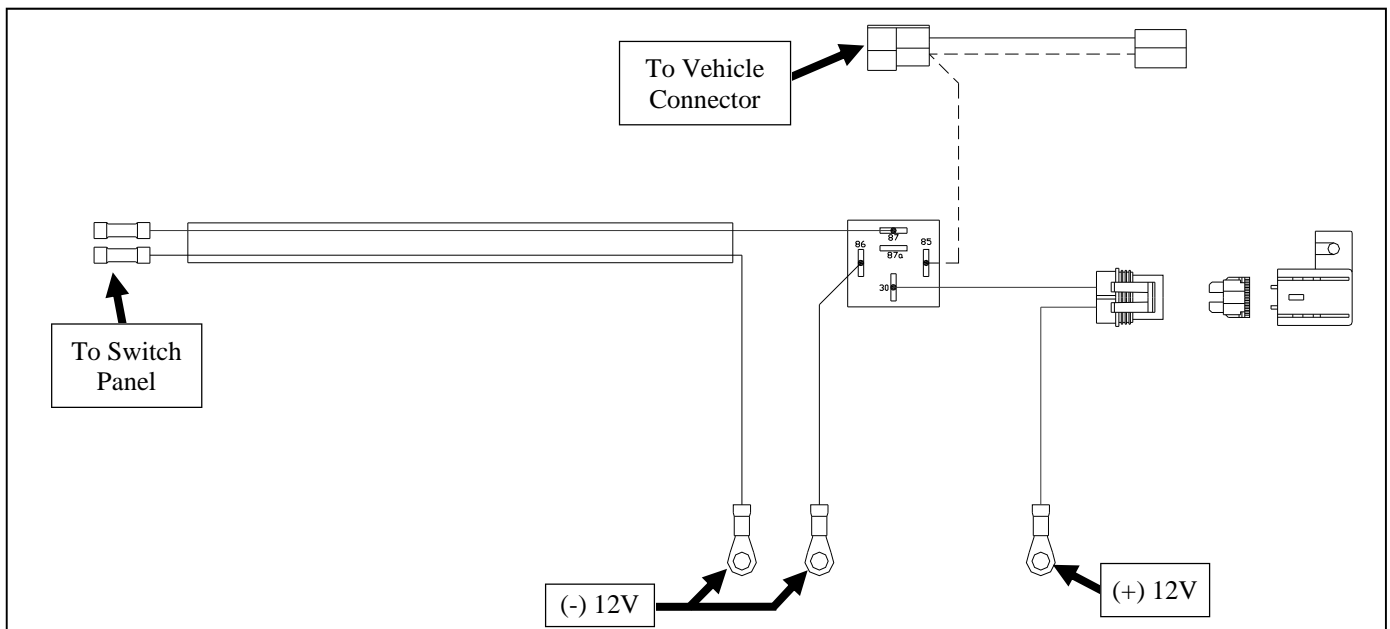

Figure 2.1 - Wire Connections (2 Passenger)

2. Connect Wiring: (continued)

4 Passenger only: (Use Figure 2.4 as a reference)

Note: The 4 passenger switch panel requires extension wires. These are available separately. (Curtis P/N: 1XUV4WHEK)

2.4 Locate the vehicle tie in harness. Cut the yellow wire coming from the relay approximately 5" from the relay. (save the plugs for reuse) Connect the long end of the yellow extension wire to the cut yellow relay wire. Crimp the free ends of the extension harness to the butt connectors on the matching color wires on the vehicle tie in harness.

2.5 Connect the ring terminal on the fused red wire to the positive battery lug and the ring terminals on the black wires to the negative battery lug or ground screw.

2.6 Remove the plastic center cover on the rear floorboard and route the extension harness forward in the wire chase way and under the front passenger seat.

2.7 Cut back the jacketing on the end of the wire coming from the switch panel and strip the ends of the two wires. Crimp the wires into the butt connectors at the end of the tie-in harness as shown in Figure 2.4. The wires should be connected white to red and black to black. Be sure the wires are routed under the seat base when crimped so they will not be pinched.

2.8 Connect the removed plugs to the end of the yellow wire in the extension harness and plug in the connector to the mating plug on the vehicle harness located under the front passenger seat.

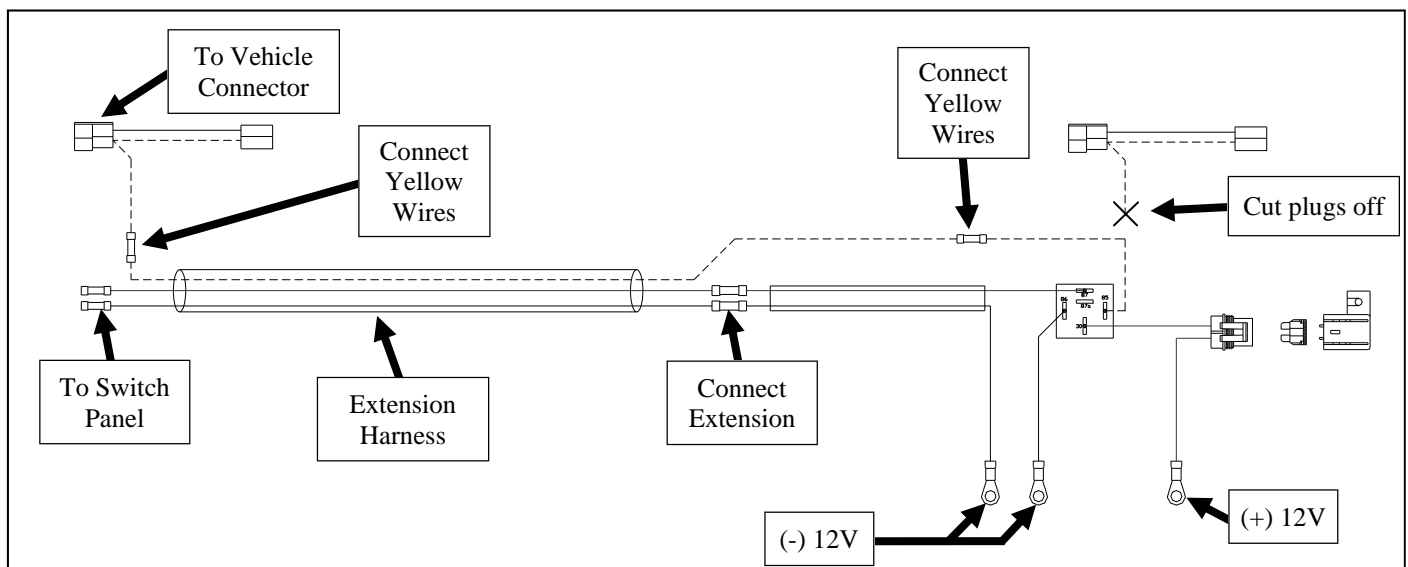

Figure 2.4 - Wire Connections (4 Passenger)

2. Connect Wiring: (continued)

(Both Vehicles)

2.9 Turn the key on and test the switch panel to be sure that the switches are illuminated and the dome light works properly. If the switch panel is not working, first check the fuse located on the tie-in harness and then check wiring connections. When the key is turned on or off, the relay on the tie-in harness will click.

2.10 Secure the wire harness with cable ties so that it cannot contact any moving parts and replace the plastic center cover (4-Passenger)

3. Attach Accessories:

Interior Mirror: If installing an interior mirror, fasten the bracket to the switch panel as shown in Figure 3a at this time. Once the panel is secured in place, install the mirror to the bracket.

Front Lights: If installing front lights, remove the hole plugs in the windshield support panel. Install the lights per the instructions supplied with the lights and route the wires through the hole. An example of an installed light can be seen in Figure 3b. Install a rubber grommet on the wire and secure the grommet in the hole through the windshield support panel. Connect the light to the switch panel harness. The front lights should connect to the blue wires coming from the left switch. The blue wire is +12V and the black wire is ground. Note: use a silicone sealant to seal between the wire and the grommet to prevent any water from entering the cab.

Rear Lights: If installing rear lights, remove the hole plugs in the rear panel. Install the lights per the instructions supplied with the lights and route the wires through the hole. An example can be seen in Figure 3c. Install a rubber grommet on the wire and secure the grommet in the hole through the rear panel. Locate the rear light wires coming from the back of the switch. Route the shorter of the two wires out the driver's side grommet in the switch panel and back to the light in the rear panel. Be sure to route the wires through the cross tube bracket on the OPS. Route the longer length of wire out the passenger side grommet and back to the right rear light. Connect the lights to the harnesses. The white wire is +12V and the black wire is ground.

Strobe Light: If installing a strobe light, install the light in the roof per the installation instructions. Route the wiring either to the rear OPS cross tube and around to the switch panel or route the wiring to the front OPS cross tube and forward to the switch panel. Pass the wiring through the grommet and connect to the white and black wire from the strobe light switch. The white wire is +12V and the black wire is ground.

Corner Flashers: If installing the flasher kit, install the lights per the installation instructions. Connect the harness to the white and black wire from the strobe light switch. The white wire is +12V and the black wire is ground.

3.1 Route the black wiper plug (with gray and black wires) out through the rectangular slot in the center of the switch panel and connect to the wiper motor.

3.2 Once all lights and accessories are connected, turn the key on and check for proper function of each.

3.3 After testing is complete, use the supplied cable ties to secure the wiring to the OPS tubes and also to bundle the wiring inside the switch panel together to prevent it from interfering when installing the panel.

3.4 Move the panel into its proper location and fasten to the windshield support panel with the following hardware. Be sure to start the bolts by hand to avoid cross threading the inserts.

| <u>Qty</u> | <u>Hardware</u> |
|------------|---------------------------|
| 8 | 1/4-20 x 3/4" Flange Bolt |

3.5 Push the excess wire into the switch panel through the grommets on either side and secure with cable ties if necessary.

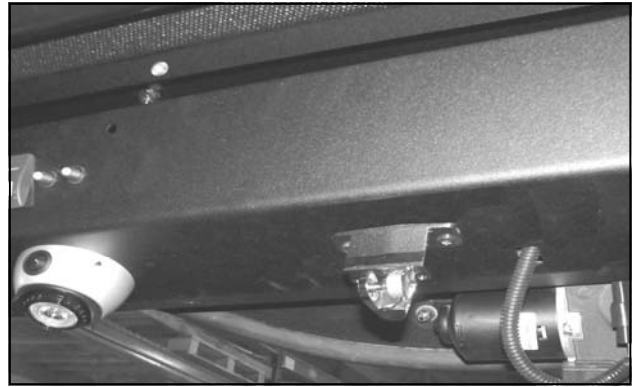

Figure 3a - Attach Mirror Bracket



Figure 3b - Front Lights + Corner Flasher

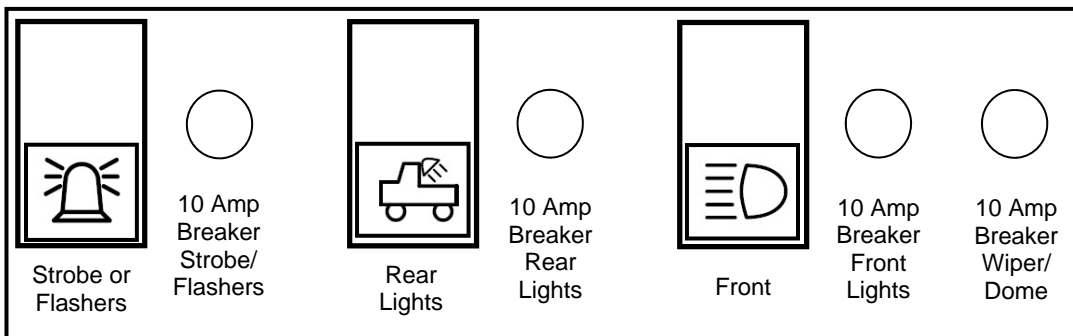

Figure 3c - Rear Lights



Figure 3.1 - Wiper Plug

Switch Panel Descriptions:



4. Operation:

- 4.1 Each switch operates OFF - ON and the icon should be illuminated when the ignition switch is on.
- 4.2 Each switch has a push button reset circuit breaker attached to it that if it is tripped will pop the white button 1/4" out of the housing. There is an additional breaker that protects the wiper and dome light.
- 4.3 The entire panel is fused at the battery with a 25 Amp ATO/ATC fuse.
- 4.4 Refer to the following wire diagram for any additional wiring issues.

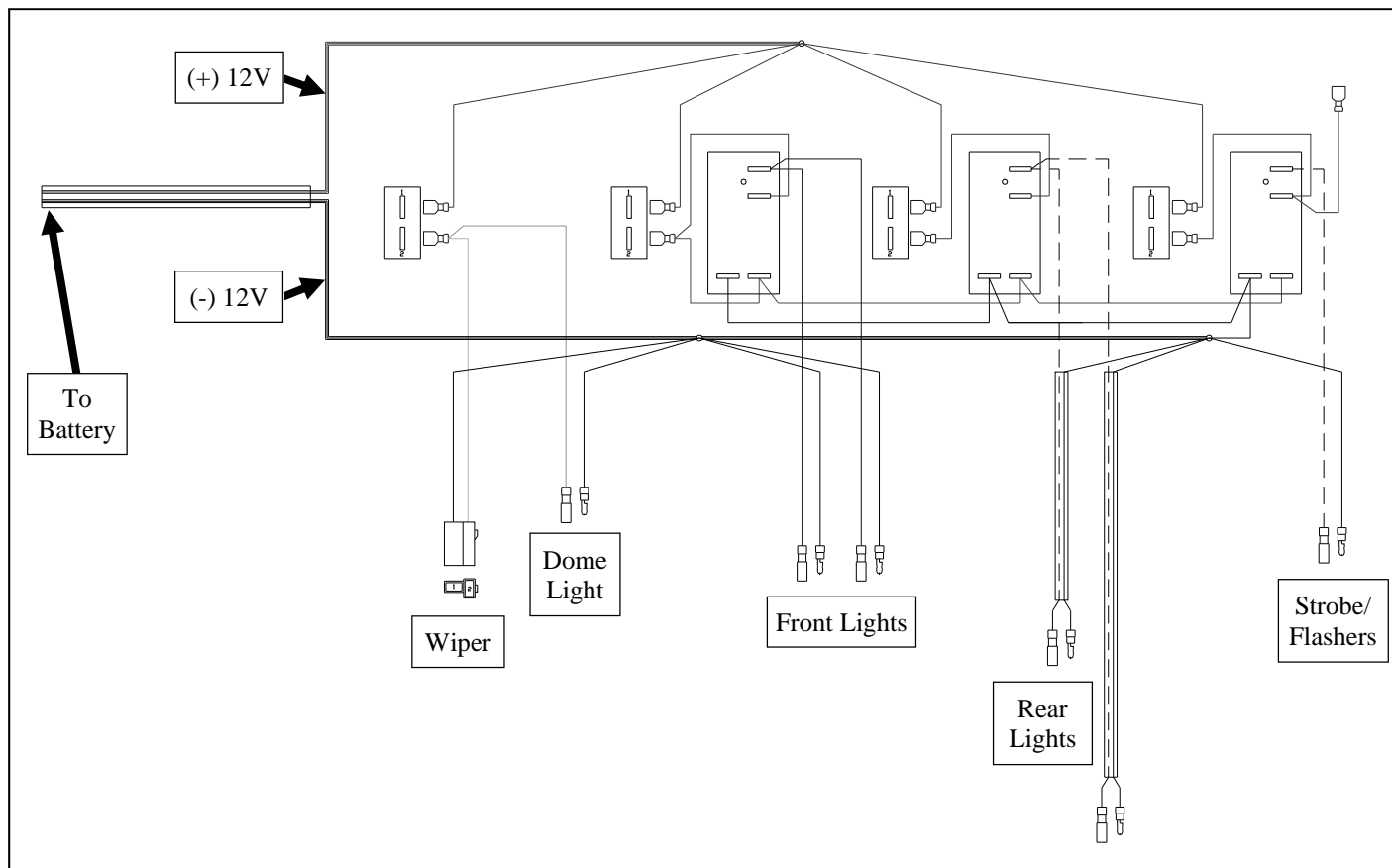

Figure 4 - Wire Diagram (Back of Switches)