



## KAWASAKI TERYX CAB

(fits models 2010-2012)

This cab has been modularly designed so that components may be quickly detached and attached depending upon conditions. The roof, windshield, or rear panel may be used independently with the installed mount kit.

Black Cab Complete w/ Doors (p/n: 1KWTX75B)    Black Cab (No Doors) (p/n: 1KWTX75BND)

**IMPORTANT: THIS ACCESSORY WEIGHS 160 POUNDS.  
PLEASE ADJUST THE VEHICLE PAYLOAD ACCORDINGLY.**

The contents of this manual are the property of the owner.  
Be sure to leave with the owner when installation is complete.



*Multiple U.S. and Foreign Patents Pending*

## GENERAL INFORMATION

### Helpful Reminders:

- Refer to parts diagram to help identify parts during assembly process.
- Leave all bolts loose for later adjustment unless otherwise specified.
- Read and understand all instructions before beginning.
- Apply a clear silicone sealant to seal any minor gaps that may occur due to vehicle variations.
- Use caution to avoid damaging the factory installed threaded inserts or weldnuts. Begin bolt engagement by hand to guard against potential cross threading.

### WARNING!

Gasoline—Flammable! Explosive! Do not operate gasoline vehicle in an enclosed area without proper ventilation. The engine produces carbon monoxide, which is an odorless, deadly poison.

This vehicle and enclosure will not provide protection from rollover, flying objects, lightening, or other hazards. If caught in a storm, exit the vehicle and seek shelter in accordance with applicable safety guidelines for your location.

Only trained technicians should service or repair the enclosure. Anyone doing repairs or service should have knowledge and experience in electrical and mechanical repair. The appropriate instructions must be used when performing maintenance, service, or installation.

Follow the procedures exactly as stated in these instructions, and heed all DANGER, WARNING, and CAUTION statements both in this instruction manual as well as those posted on the vehicle.

Prior to servicing the vehicle, turn the key switch to OFF and set the parking brake.

Always wear safety glasses or approved eye protection when servicing the vehicle.

Moving parts! Do not attempt to service the vehicle while it is running.



Hot! Do not attempt to service while engine, exhaust system, or motor are hot. Failure to heed this warning could result in severe burns.

### NOTICE

Cabs, blades, and general accessories add additional weight to the base vehicle. Deduct the accessory's total weight from the vehicle's rated capacity including driver and passenger.



**WARNING** *Exposure to Carbon Monoxide can Cause illness, serious injury or death. Never operate vehicle if suspicious of Carbon Monoxide. Inspect exhaust system for leaks monthly. Leaks can result from loose connections, corrosion, cracks or other damage to the exhaust manifold. If leaks are found, repair or replace exhaust system. Do not use vehicle until repair or replacement is complete.*

<b>⚠ WARNING</b>	
<b>Serious Injury or Death</b>	
	This cab enclosure does not provide protection from rollover or other accidents.
	This cab enclosure does not provide protection from flying objects including golf balls.
	This cab enclosure does not provide protection from lightning. When lightning threatens take cover and do not operate vehicle.

## TOOLS REQUIRED:

3/8" DRIVE RATCHET  
SET OF METRIC DEEP SOCKETS  
SET OF ENGLISH DEEP SOCKETS  
SET OF METRIC WRENCHES  
SET OF ENGLISH WRENCHES

#2 and #3 PHILLIPS HEAD SCREWDRIVERS  
UTILITY KNIFE OR SCISSORS  
SET OF ENGLISH ALLEN WRENCHES  
TORQUE WRENCH  
STRAIGHT EDGE (MIN 2' LONG)

## 1. INSTALL TOP MOUNTS

1.1 Orient the driver's side top mount as shown in Figure 1.1 with the rubber on the top. Cut a piece of expand-a-foam to match the length of rubber. Adhere the foam to the rubber grip on the underside of the mount. Align the foam so that it is even with the outer edge of the rubber. Clean the rubber to remove any oils that may be on it before applying the foam. Apply the foam at room temperature.

1.2 Using a 14mm socket, remove and discard the four bolts that hold one side of the upper cross members of the roll cage in place. Install the top mount as shown in Figure 1.1. Be careful not to peel the expanding foam off of the rubber when installing. The foam should be tightly compressed along the top of the roll cage.

1.3 Install four new bolts provided in the hardware bag and tighten to 35 ft-lbs (47 N-m).

1.4 Repeat for opposite side.

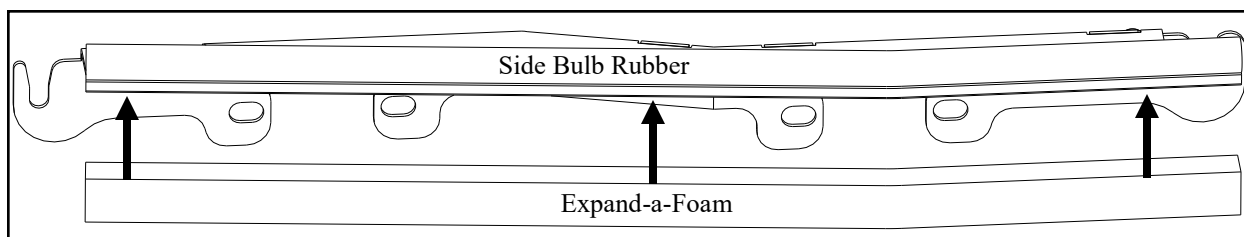

Figure 1.1 Install Expand-a-foam

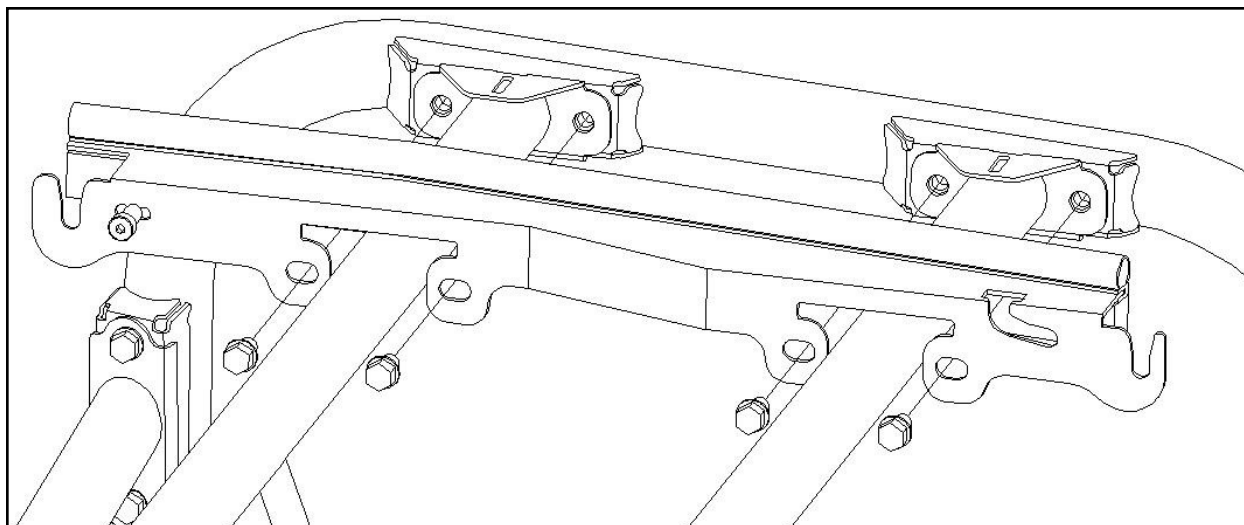

Figure 1.2 View of driver's side

## 2. INSTALL FRONT MOUNTS

2.1 Using a 19mm socket, remove and save the two front bolts that fasten the roll cage. Install the front mounts according to Figure 2.1. Be sure to install the flat washers in between the front mount and the roll cage. The foam should seal tight against the vehicle hood.

2.2 Reinstall the two bolts and tighten to 72 ft-lbs (98 N-m).

2.3 Repeat for opposite side.

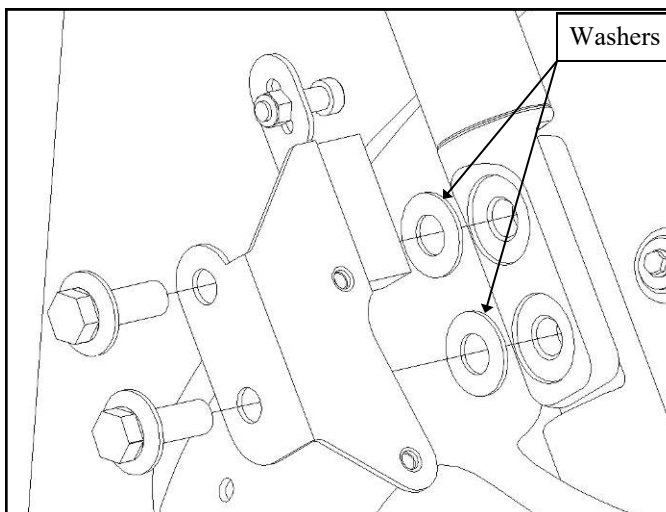

Figure 2.1 View of passenger's side front

### 3. INSTALL WINDSHIELD

3.1 Slide the two pins at the top of the windshield into the slots at the front of the top mounts. (Figures 3.1a and 3.1b) Fasten the bottom latches onto the pins on the front mount as in figure 3.1c. You should hear the latch make two clicks as it is fastened. Adjust the pins in the slots using a 3/16" allen and a 1/2" wrench so that the two pins at the top of the windshield are sitting all the way down in the slots on the top mount. The latches can also be adjusted forward and backwards to achieve a tighter seal to the hood. Use a 7/16" wrench to adjust the latch bolts.

3.2 Once the windshield is fully adjusted it can be installed or removed by releasing the lower latches and lifting the pins out of the top slots. During vehicle operation the windshield can be opened completely or can be put in a vent position using the twist latches on the windshield.

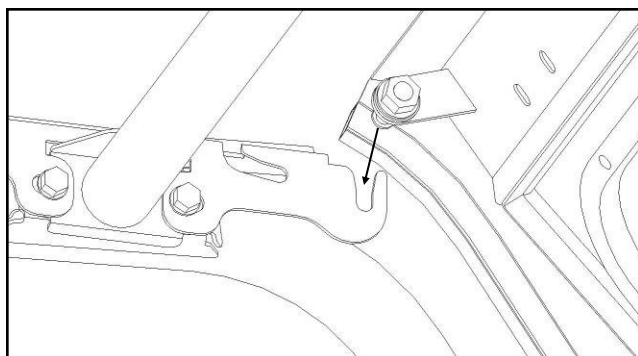

Figure 3.1a View of driver's side top uninstalled

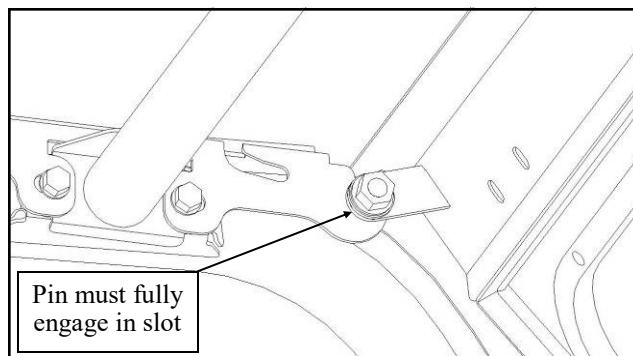

Figure 3.1b View of driver's side top installed

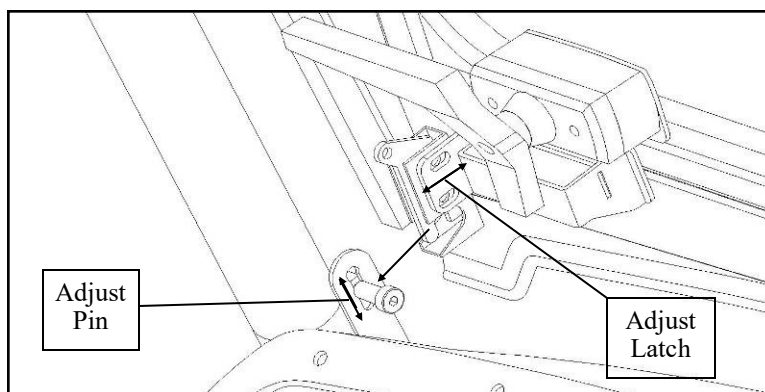

Figure 3.1c View of driver's side bottom uninstalled  
Windshield is in fully closed position

#### 4. INSTALL REAR PANEL

4.1 Remove the seats. Remove and discard the two bolts shown in Figure 4.1 using a 14mm wrench. Install new bolts provided and install the bracket as shown so that the slots are fully engaged on the bolts. Tighten to 35 ft-lbs (47 N-m). Repeat for opposite side.

4.2 Slide the two pins at the top of the rear panel into the slots at the rear of the top mounts as shown in Figures 4.2 and 4.3. Fasten the bottom latches onto the pins on the rear panel mounts. You should hear the latch make two clicks as it is fastened. Adjust the rear panel mount pins in the slots using a 3/16 Allen and 1/2" wrenches so that the two pins at the top of the rear panel are sitting all the way down in the slots on the top mount.

4.3 Once the rear panel is fully adjusted it can be installed or removed by releasing the lower latches and lifting the pins out of the top slots.

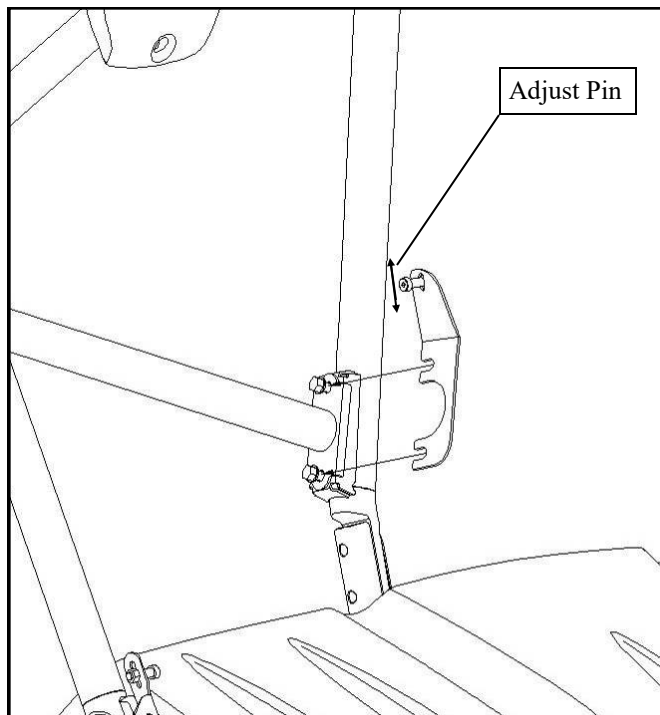

Figure 4.1 View of driver's side rear

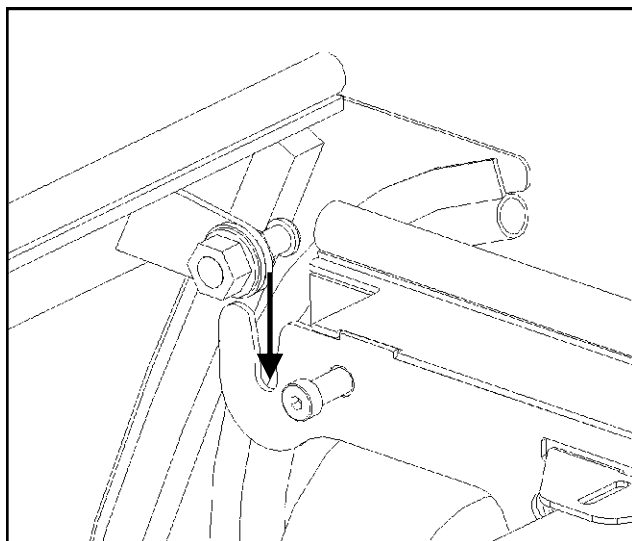

Figure 4.2 View of driver's side rear

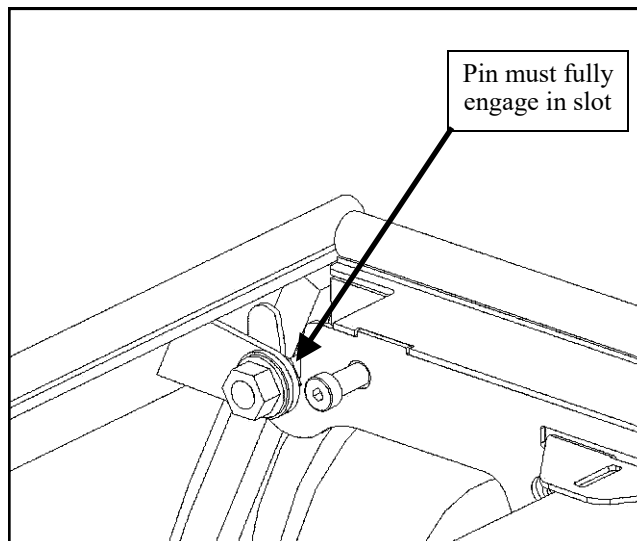

Figure 4.3 View of driver's side rear



#### 4. INSTALL VINYL PANELS

Note: If installing doors, skip this step until the doors are fully installed. Ref: Step 14 will direct you back here.

4.4 Slide the vinyl curtain between the dump bed and the ROPS (Roll Over Protective Structure) and snap it to the bottom of the rear panel. Pull it down tight to keep it from wrinkling. Attach the supplied 5/8" self-adhesive Velcro to the vehicle frame and ROPS structure where necessary to keep the panel tight. Use Figure 4.1, as well as the rear curtain, as guides for proper alignment. Velcro should also be attached to the plastic engine cover between the seats. The vinyl must fold forward and stay on top of the engine cover. Be sure to also install a piece of 1" wide loop Velcro along the rear of the ROPS tube as well to prevent vinyl from falling down when rear panel is removed. (Note: self-adhesive Velcro should be applied to a clean, dry surface at room temperature)

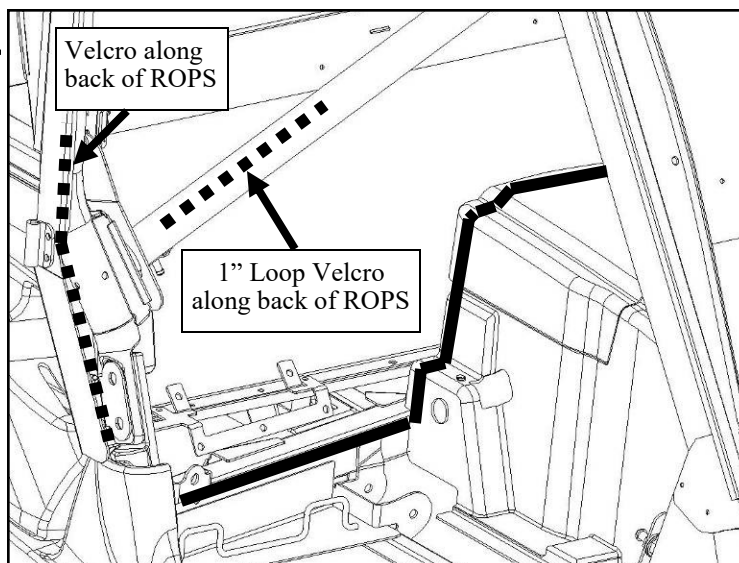

Figure 4.4 View of passenger's side rear

4.5 The two other vinyl panels are dust barriers for under the seats. Use the vinyl barriers as a guide for proper positioning of the Velcro. See Figures 4.5 and 4.6. The seat latching pin should protrude through the hole in the vinyl. The passenger barrier has a half round cutout for around the fuel cap as seen in figure 4.6.

Velcro should be affixed along the underside of the steel plate along the back of the dust barrier.

(Note: self-adhesive Velcro should be applied to a clean, dry surface at room temperature)

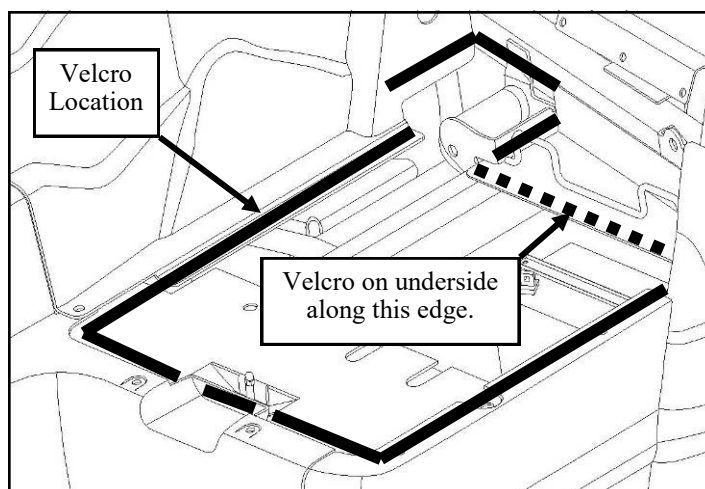

Figure 4.5 Driver's Side Vinyl Dust Barrier

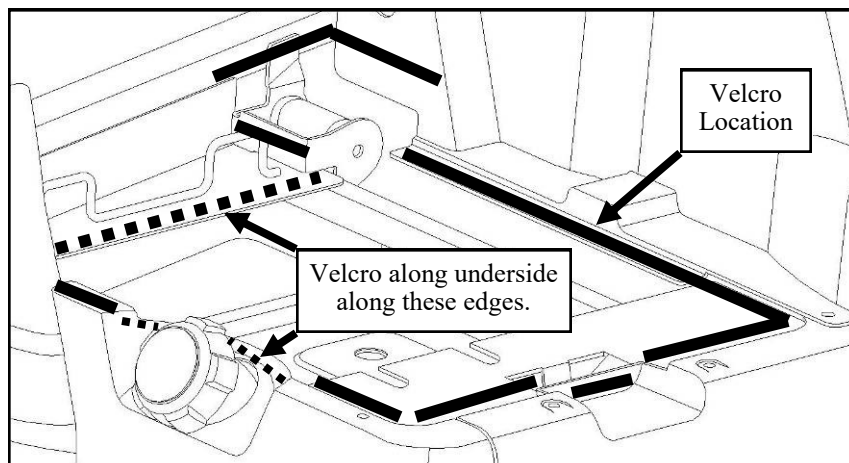

Figure 4.6 Passenger Side Vinyl Dust Barrier

## 5. INSTALL ROOF

5.1 Orient the roof so that the quick attach pins are facing forward. Place the roof on top of the roll cage. While lifting the back of the roof up approximately 2", slide the two front pins into the angled slots that are in the top mounts. You may need to tap the back of the roof with your hand to get it to slide forward. Bring the rear of the roof down and secure the latches to the latch pins.

5.2 The roof installs easier if the rubber on the top of the windshield, rear panel, and top mounts is lubricated with Armor-All Protectant or other lubricating product that is safe on vinyl and rubber.

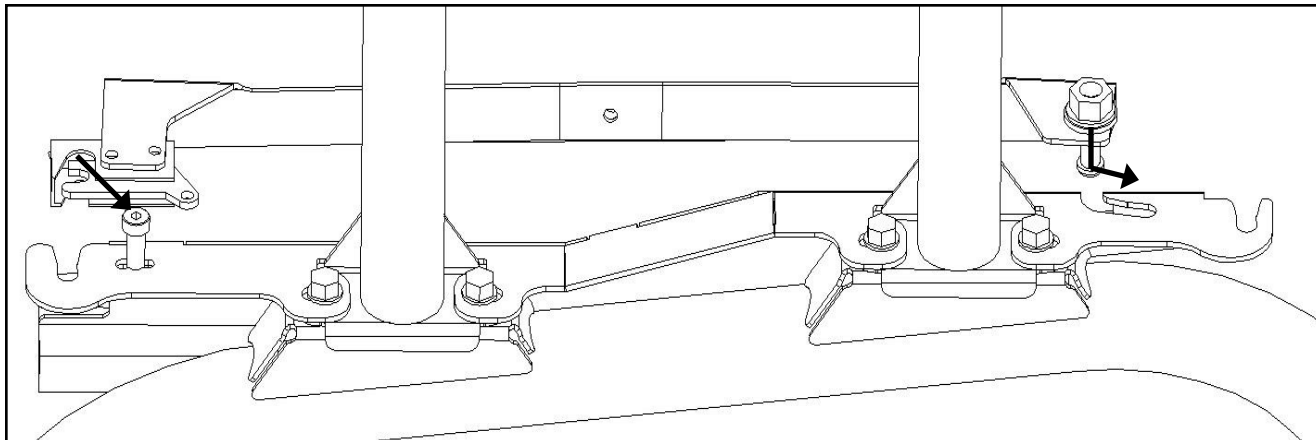

Figure 5.1 View of driver's side roof mount

## 6. INSTALL UPPER SIDEFAME MOUNTS

6.1 Remove and discard the two bolts shown in Figure 6.1 using a 14mm wrench. Install new bolts provided and install the bracket as shown so that the slots are fully engaged on the bolts. Tighten to 35 ft-lbs (47 N-m). Repeat for opposite side.

## 7. INSTALL LOWER REAR MOUNTS

7.1 Using a 19mm socket, remove the two lower rear bolts that fasten the roll cage. Install the mounts according to Figure 7.1. Be sure to re-install the seat belt under the head of the bolt as previously installed. Tighten to 72 ft-lbs (98 N-m). Repeat for opposite side.

## 8. INSTALL DOOR HINGE PANEL

8.1 Install the door hinge panel as shown in Figure 8.1. Use four 1/4-20 hex head bolts with 1/4" flat washers. The top two bolts are installed into the weldnuts. The lower two bolts should be fastened with a washer and nut on the inside of the part. Adjust the part so that the bolts are in the center of the slots to start.

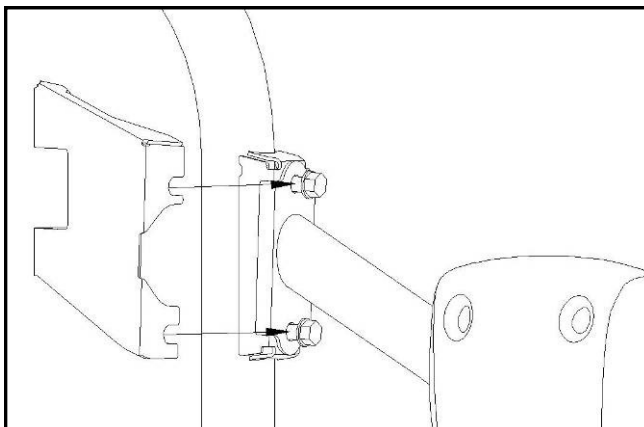

Figure 6.1 View of passenger's side

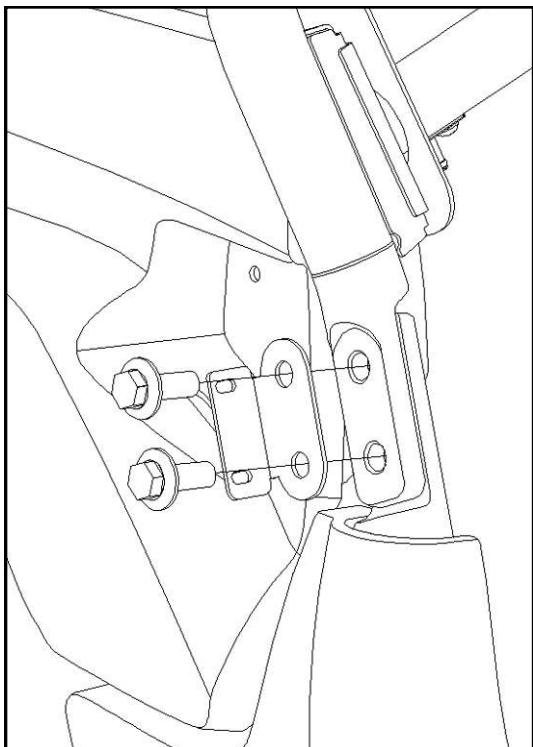

Figure 7.1 View of passenger's side lower rear

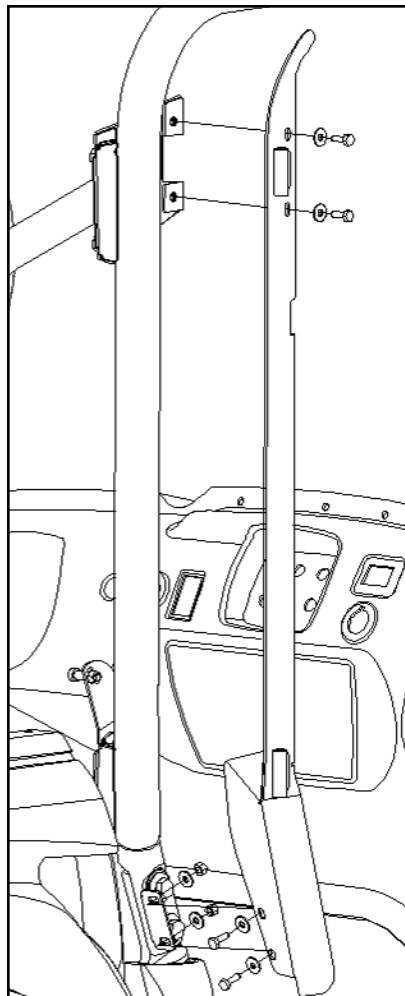

Figure 8.1 View of driver's side rear



## 9. INSTALL FRONT LEG

9.1 Remove the foot restraint and reinsert the factory installed bolts back into the threaded holes. The removed foot restraints must be given to customer along with Teryx. Remove the two floorboard bolts as shown in Figure 9.1. Keep the metal washers in place on the plastic. Install the front leg being sure that the washers stay centered in the hole in the floorboard underneath the front leg. Re-install the screws back into the floorboard. Use two 1/4-20 hex head bolts and washers to fasten the top of the front leg to the front mount.

(WARNING: If front leg is removed from the Teryx, the factory foot guard **MUST** be re-installed)

## 10. INSTALL DOOR TETHER MOUNTS

10.1 Remove the clips that hold the plastic body panels on each side of the vehicle at the location shown in Figure 10.1. Pull the plastic out and install the cage nut onto the steel edge so that the threaded side of the cage nut lines up directly underneath the hole. Push plastic back into place and install the door tether mount using a 1/4-20 Phillips head bolt. The detent pin should install from the top, pass through the door tether, and then the detent ball should pass through the second hole.

## 11. HANG DOORS

11.1 Hang each of the doors by inserting the hinge pins at the back of the door into the sleeves located on the door hinge panel. Adjust the front latch pin on the front leg to the center of the slots and latch the door closed. Tighten the hinges on the door at this point and make sure that the pins are in line vertically with each other using a straight edge. For proper door operation it is crucial that the pins be in line with each other. Re-adjust the front door latch pin so that the latch is centered on the pin and is not dragging. (Figure 11.1) If the door is dragging on the floorboard, loosen the hinge sleeves on the rear hinge panel and lift the front of the door. If it is still dragging, shift the rear hinge panel higher in the slots.



Figure 9.1 Passenger Front Leg

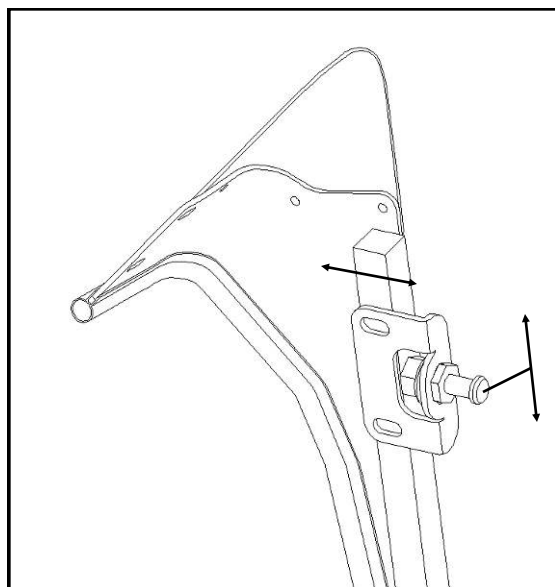

Figure 11.1 Adjust Front Door Latch Pin

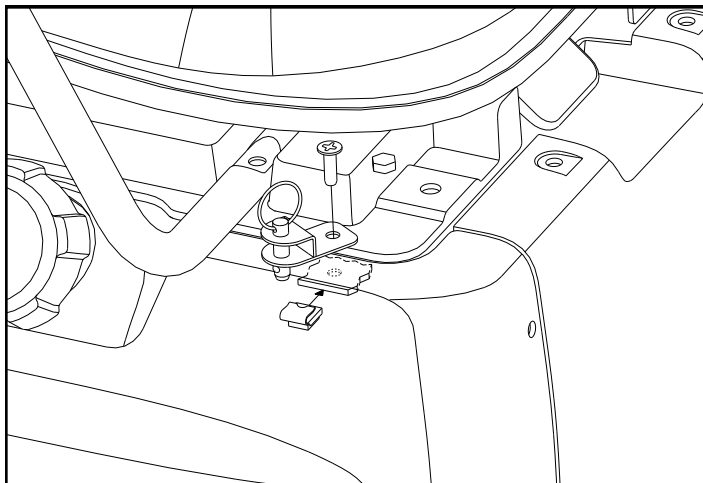

Figure 10.1 Install Door Tether Mounts

## 12. INSTALL FUEL FILLER SEAL

12.1 Remove and save the four bolts (A) holding the passenger seat to the plastic base. See Figure 12.1. Remove one of the two nuts (B) from the outer bolts. The other can be loosened so that the fuel filler slides underneath it. Install the fuel filler seal on the bottom of the plastic and loosely re-install the nut that was removed. Place the plastic seat base onto the vehicle and adjust the fuel filler seal front to back to be sure it is centered on the cutout in the door skin. Tighten the two outer bolts (B) and re-install the four seat bolts (A). The fuel filler can also be adjusted up and down by altering the two bolts located inside the filler next to the gas cap.

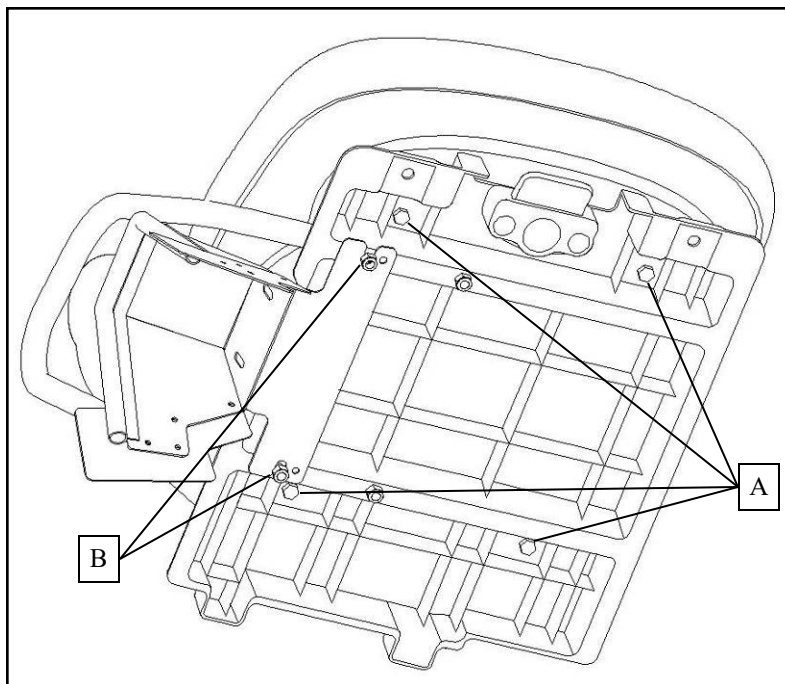

Figure 12.1 Fuel Filler Installation

## 13. INSTALL VINYL PANELS

13.1 Return now to step 4.4 and install the vinyl dust barriers beneath the seat and along the bottom of the rear panel.

## CARE AND MAINTENANCE

*(IMPORTANT: Be sure to leave this page with the owner once installation is complete)*

Check and tighten hardware after 20 hours of operation.

Periodically inspect and tighten hardware for the remainder of the unit's service life.

### IMPORTANT CLEANING INFORMATION

Keep the enclosure components clean in order to prevent dust and dirt from forming an unattractive film. The life of your windows, doors, and roof panels depends upon following these care procedures:

#### **WINDOWS:**

- 1) **NEVER USE** AN ALCOHOL-BASED PRODUCT FOR CLEANING. Do not use **WIN-DEX, GLASS PLUS, FANTASTIC**, etc. Use of these products will result in deterioration of the windows.
- 2) Wash with a mild soap or detergent using your bare hands to free or dislodge any caked-on dirt or other foreign particles.
- 3) A soft, grit-free cloth, sponge, or chamois may be used but only as a means of carrying water to the windows.
- 4) The interior should be lightly dusted (NOT WIPED) with a clean soft cloth or chamois. The cloth or chamois should be kept free of grit by frequent rinsing in clean water.
- 5) Grease and oil may be removed with kerosene.
- 6) Novus I and Novus II are recommended plastic cleaners and can be used to remove light scratches.

#### **DOORS AND ROOF PANELS:**

- 1) **NEVER USE** AN ABRASIVE DETERGENT/VEHICLE CLEANER OR A WIRE BRISTLED BRUSH. Do not use any **CITRUS BASED CLEANERS** such as orange or lemon. Use of these products will cause the plastic to become permanently damaged.
- 2) Clean the plastic enclosure surfaces thoroughly with warm soapy water and a COTTON cloth or chamois. Be sure to use mild soap, specifically a dish liquid or equivalent. Clean in a light circular motion for best results.
- 3) Use EXTRA CAUTION when cleaning the interior of the enclosure. The interior is more sensitive than the exterior because the exterior has an extra coating for U.V. stability.
- 4) Remove grease and oil with mineral spirits and a COTTON cloth or chamois.



The contents of this manual are the property of the owner.  
Be sure to leave with the owner when installation is complete.

**KAWASAKI TERYX (2010-)**  
**PARTS LIST**

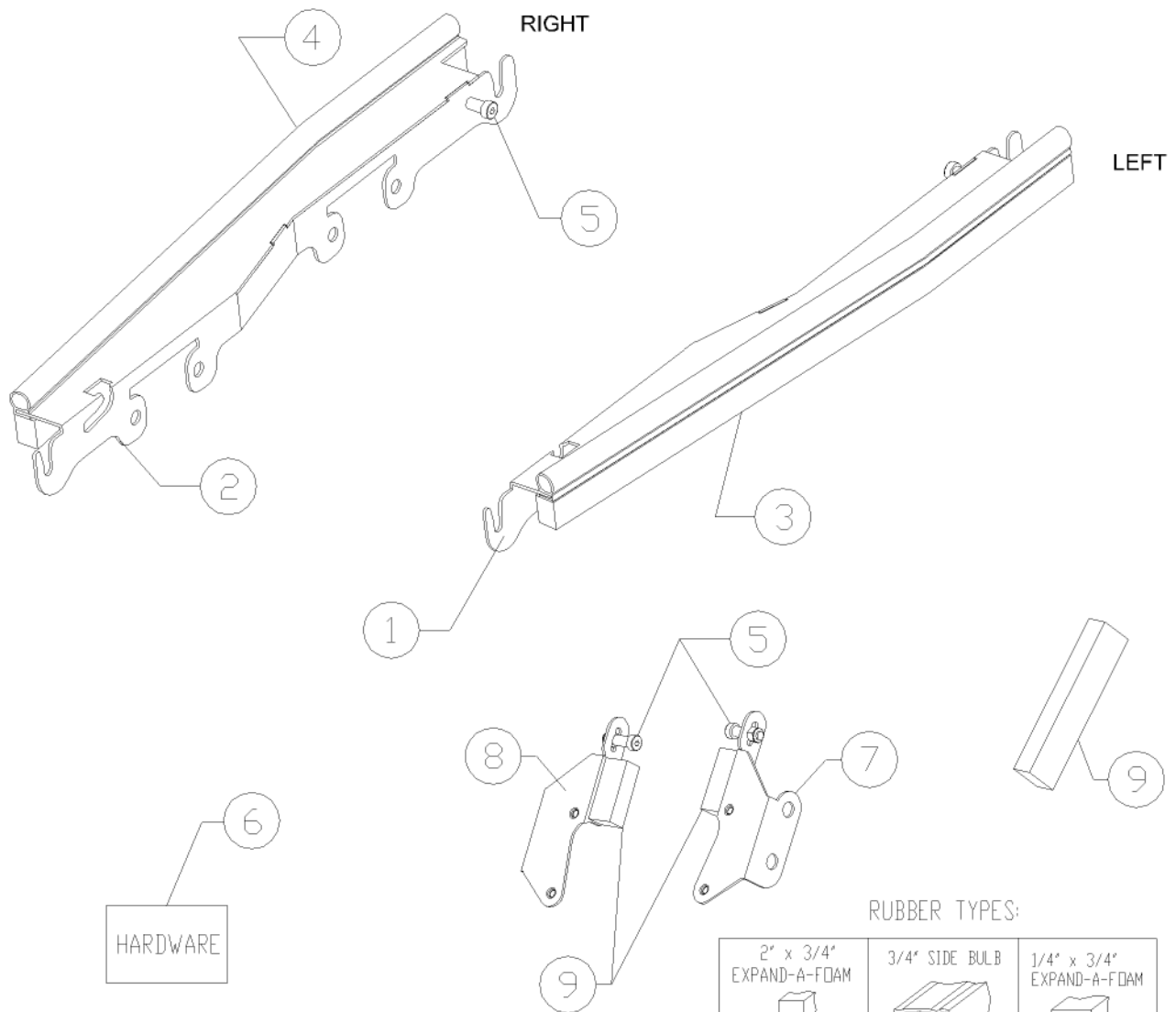
REF. NO.	CODE NO.	QTY.	DESCRIPTION
1	8SV-TX15-B4	1	ROPS UPPER MOUNT LEFT
2	8SV-TX15-B4	1	ROPS UPPER MOUNT RIGHT
3	9SV-PR30-5	2	1" EXPAND-A-FOAM (25")
4	9SV-PR17-5	2	3/4" SIDE BULB RUBBER (25")
5	9SV-SP	2	LATCH PIN
6	TX10-HWK	1	HARDWARE KIT - CAB
7	8SV-TX1004-B4	2	FRONT MOUNT LEFT
8	8SV-TX1004-B4	2	FRONT MOUNT RIGHT
9	9SV-PR40-5	1	2" EXPAND-A-FOAM (10")



RUBBER TYPES:

2' x 3/4' EXPAND-A-FOAM  9PR40	3/4' SIDE BULB  9PR17	1/4' x 3/4' EXPAND-A-FOAM  9PR30
MFG-022-W1		

# **KAWASAKI TERYX (2010-)** **PARTS LIST**

REF. NO.	CODE NO.	QTY.	DESCRIPTION
1	8SV-TX1002	1	WINDSHIELD (FULL ASSEMBLY)
2	8SV-TX1002B-B4	1	WINDSHIELD BASE ASSEMBLY (INCLUDES FRAME, PINS, RUBBER, LATCHES)
3	9SV-PR17-20	2	3/4" SIDEBULB RUBBER (122")
4	9SV-DSTR	2	STRIKER PIN
5	9SV-RFL	1	LATCH LEFT
6	9SV-RFL	1	LATCH RIGHT
7	9SV-PR02-15	1	5/8" BULB RUBBER (209") (FRAME BASE)
8	9SV-HWS	2	WINDSHIELD HINGE
9	8SV-TX1002A-B4	1	WINDSHIELD STIFFENER ASSEMBLY (INCL: FRAME, W/S, LATCHES, HINGES)
10	PCQ-33X48	1	WINDSHIELD (HARD COATED POLYCARBONATE ONLY)
11	9SV-WL2	1	TWIST STYLE LATCH LEFT
12	9SV-WL2	1	TWIST STYLE LATCH RIGHT
13	9SV-GS05	2	GAS SPRING

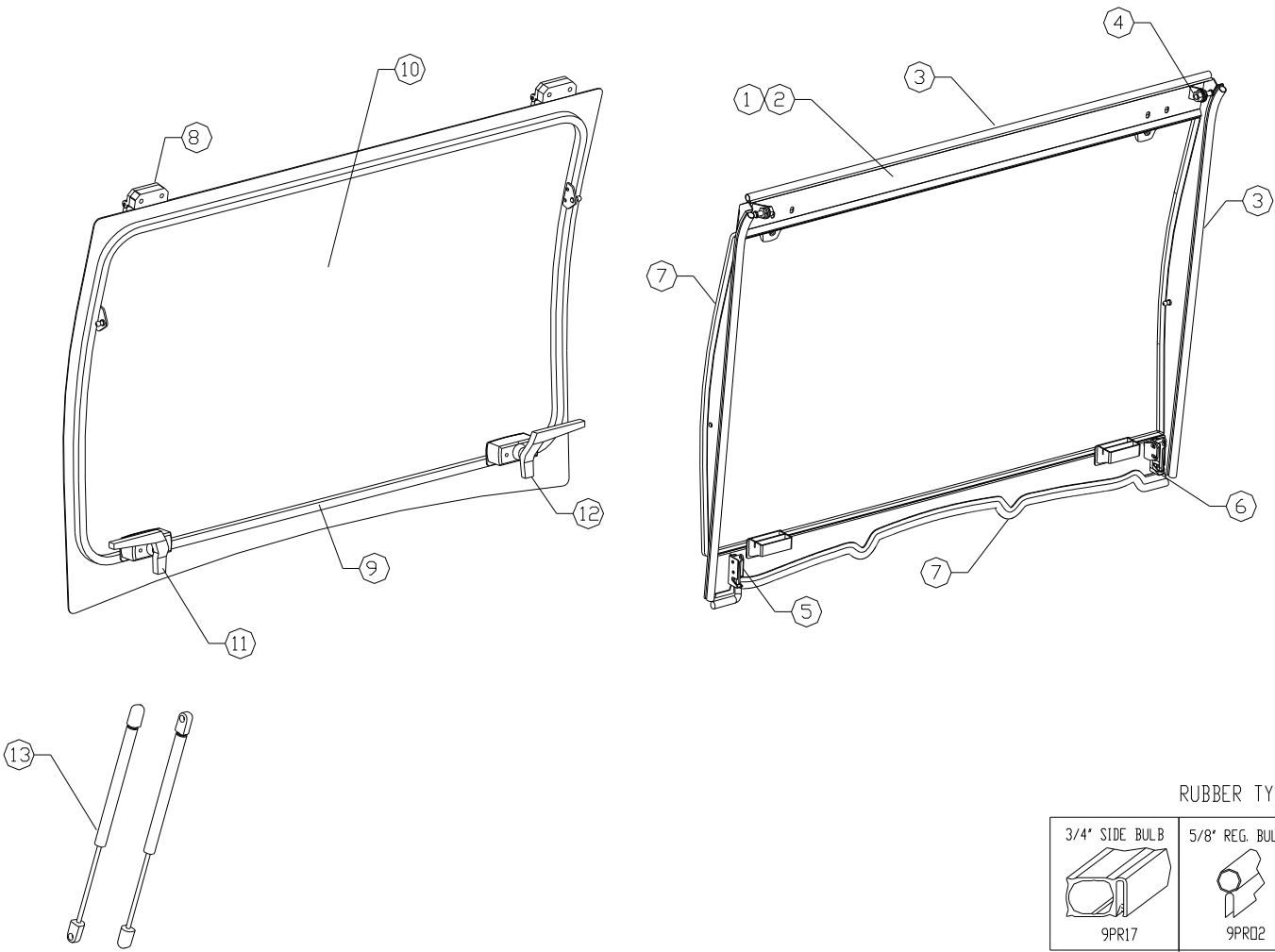

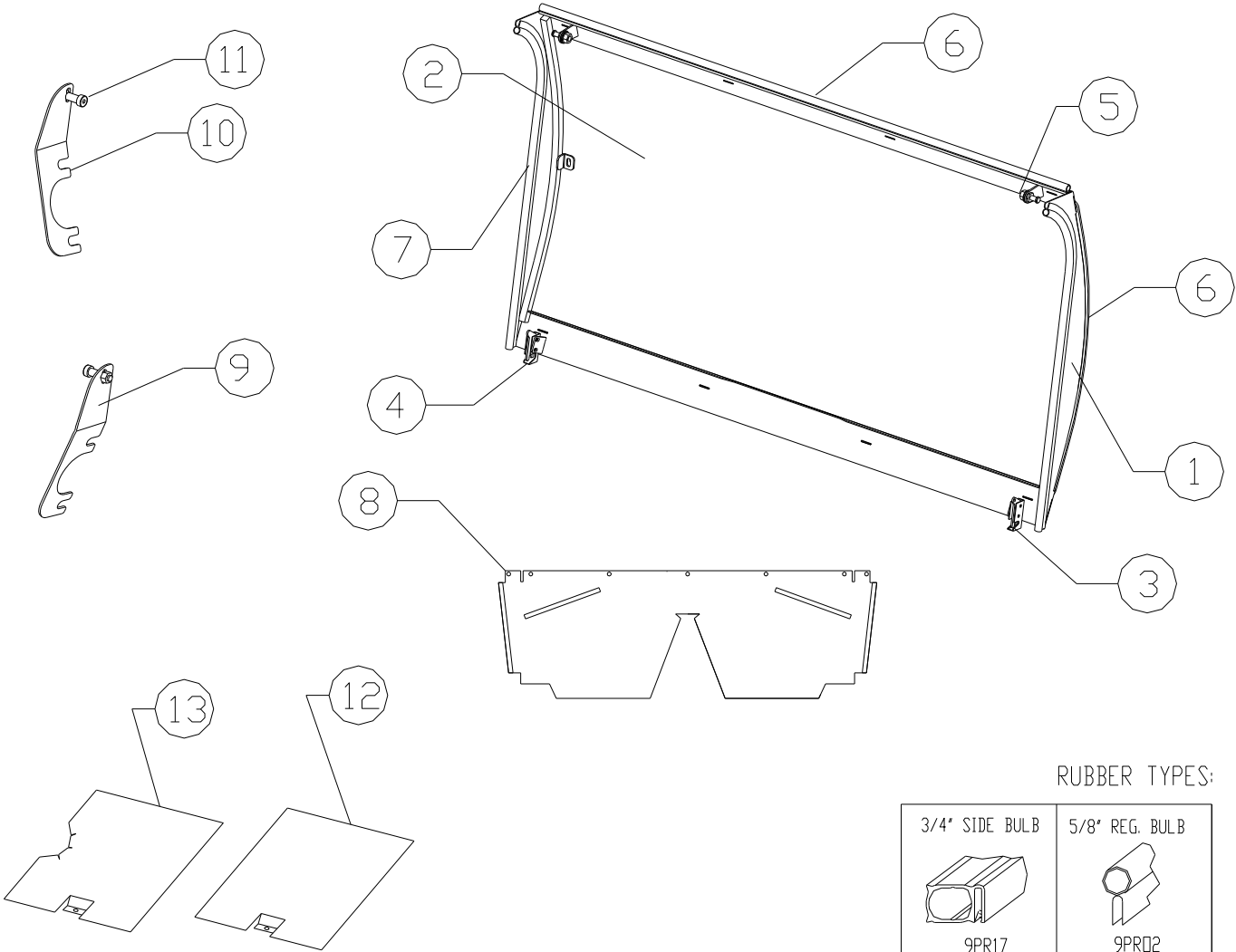

# **KAWASAKI TERYX (2010-)** **PARTS LIST**

REF. NO.	CODE NO.	QTY.	DESCRIPTION
1	8SV-TX1006-B4	1	REAR PANEL (COMPLETE ASSEMBLY)
2	8SV-PC28X5310	1	REAR WINDOW (INCLUDES RUBBER)
3	9SV-RFL	1	LATCH LEFT
4	9SV-RFL	1	LATCH RIGHT
5	9SV-DSTR	2	STRIKER PIN
6	9SV-PR17-20	1	3/4" SIDE BULB RUBBER (166")
7	9SV-PR02-15	1	5/8" BULB RUBBER (65")
8	8SV-TXRCA-VC	1	REAR PANEL VINYL CURTAIN W/ SNAPS
9	8SV-TX1011-B4	1	REAR PANEL LATCH MOUNT LEFT (INCLUDES LEFT + RIGHT)
10	8SV-TX1011-B4	1	REAR PANEL LATCH MOUNT RIGHT (INCLUDES LEFT + RIGHT)
11	9SV-SP	2	STRIKER PIN (INCLUDES 10 PINS)
12	8SV-USDB-VC	1	VINYL FILLER - LEFT
13	8SV-USDB-VC	1	VINYL FILLER - RIGHT

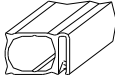

RUBBER TYPES:

3/4" SIDE BULB	5/8" REG. BULB
	
9PR17	9PR02
	MFG-021-WI



**KAWASAKI TERYX (2010-)**  
**PARTS LIST**

REF. NO.	CODE NO.	QTY.	DESCRIPTION
1	8SV-TX01B	1	ROOF (BLACK, COMPLETE W/ ALL MOUNTS)
2	8SV-TXRfmt-B4	1	ROOF MOUNT LEFT
3	8SV-TXRfmt-B4	1	ROOF MOUNT RIGHT
4	9SV-RFL	1	LATCH LEFT
5	9SV-RFL	1	LATCH RIGHT
6	8SV-TXRfmt-B4	1	FRONT ROOF MOUNT
7	9SV-DSTR	2	STRIKER PIN

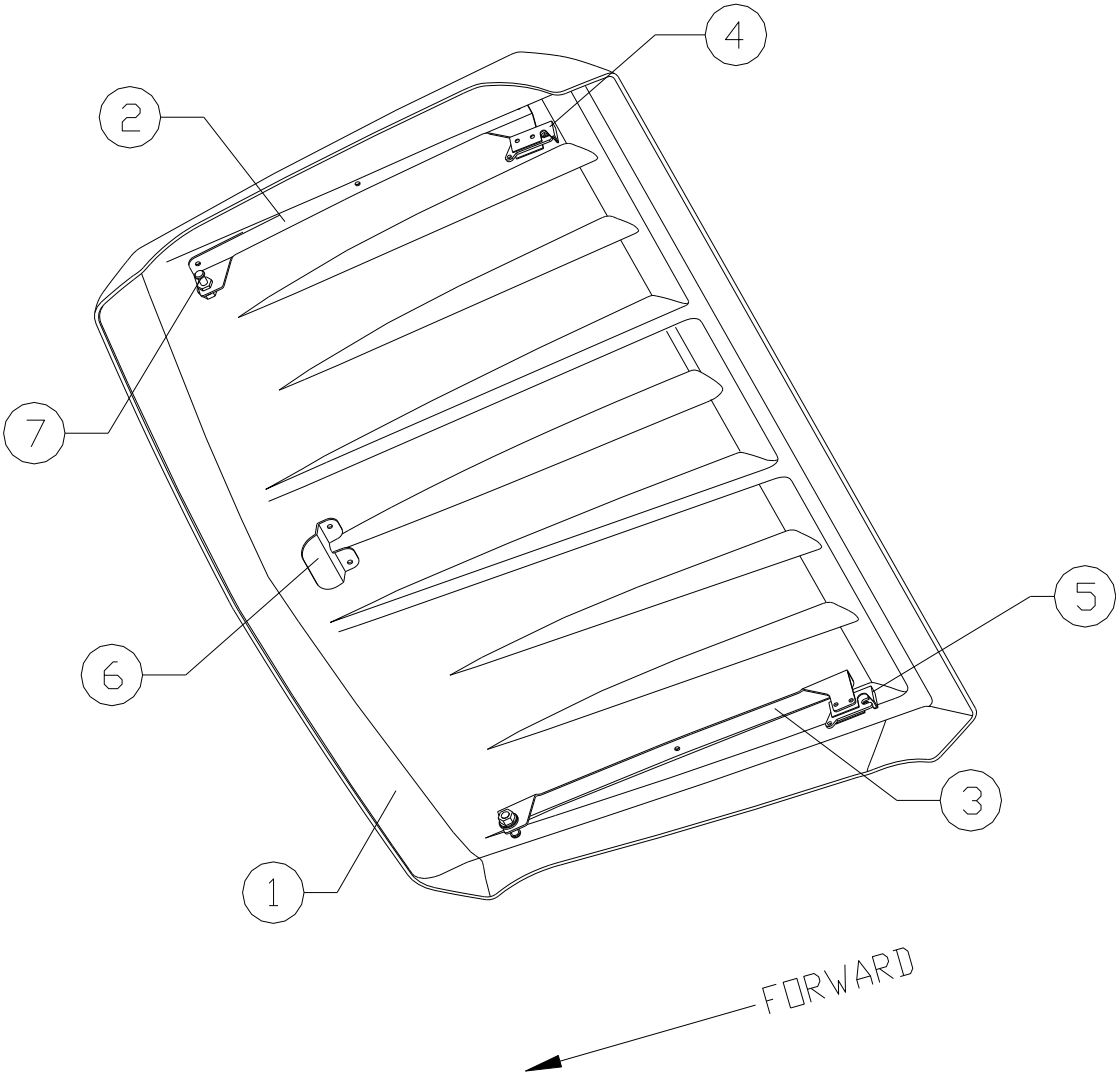

# **KAWASAKI TERYX (2010-)** **PARTS LIST**

REF.	CODE NO.	QTY.	DESCRIPTION	REF.	CODE NO.	QTY.	DESCRIPTION
1	8SV-TX107LB	1	DOOR (UPPER AND LOWER) LEFT	18	8SV-TX1005L-B4	1	HINGE PANEL LEFT
2	8SV-TX107RB	1	DOOR (UPPER AND LOWER) RIGHT	19	8SV-TX1005R-B4	1	HINGE PANEL RIGHT
3	8SV-TX10LDALB	1	LOWER DOOR FRAME - LEFT	20	9SV-HSLP	4	HINGE SLEEVE
4	8SV-TX10LDARB	1	LOWER DOOR FRAME - RIGHT	21	8SV-TX1013-B4	2	SIDEFRAME BOTTOM MOUNTS
5	8SV-KAFT7LB	1	PLASTIC DOOR SKIN LEFT	22	8SV-TX1012-B4	1	SIDEFRAME REAR MOUNT - LEFT
6	8SV-KAFT7RB	1	PLASTIC DOOR SKIN RIGHT	23	8SV-TX1012-B4	1	SIDEFRAME REAR MOUNT - RIGHT
7	9SV-DL06S	1	LATCH LEFT (not shown)	24	8SV-TX1016L-B4	1	FRONT LEG - LEFT
8	9SV-DL06S	1	LATCH RIGHT	25	8SV-TX1016R-B4	1	FRONT LEG - RIGHT
9	9SV-HSLP	2	HINGE PIN LEFT	26	8SV-TX1014-B4	2	STRIKER PIN MOUNT
10	9SV-HSLP	2	HINGE PIN RIGHT	27	9SV-DSTR	2	STRIKER PIN
11	8SV-PC30X4310	2	DOOR WINDOW W/ RUBBER	28	8SV-TX08-B4	1	FUEL FILLER SEAL
12	8SV-TX10UDAL-B4	1	WINDOW FRAME - LEFT (not shown)	29	8SV-TX08-B4	1	FUEL FILLER MOUNT
13	8SV-TX10UDAR-B4	1	WINDOW FRAME - RIGHT	30	TXDR-TETHER	2	TETHER MOUNT
14	9SV-OHRL	2	LOCKING DOOR HANDLE	31	9SV-PR20-10	2	1/2" WEATHERSEAL (40")
15	9SV-DSTX18	2	18" TETHER	32	9SV-PR02-15	2	5/8" BULB RUBBER (20")
16	9SV-PR17-20	2	3/4" SIDEBULB (113")	33	9SV-PR30-5	1	1" EXPAND-A-FOAM (20")
17	9SV-PR41-15	2	1 1/2" SIDE BULB (56")	34	TX-DRHWK	1	HARDWARE KIT - DOOR KIT

