



A/C ROOF KIT: 1ACBX70TLRFK (Fits BX2370-1)

Must be installed with Curtis Cab: 1KBX70AS
Must be installed with Curtis Air Conditioner 1ACUNIT-G1
Must be installed with Curtis A/C Drive Kit 1ACBX2380DRK



Approximate Installation Time *

Experienced Dealer Technician – 45 Minutes

Average Dealer Technician – 1 Hour

Do-It-Yourself – 1.5 Hours

(* = Not including cab & other accessories)

Approximate Product Specifications

Ground to Top of Air Conditioner: 83 inches

Weight: 20 lbs. (not including 1ACUNIT-G1)

The contents of this envelope are the property of the owner. Leave with the owner when installation is complete.

Rev. B, 05/18/2018

p/n: IM-1ACBX70TLRFK

TABLE OF CONTENTS

WARNINGS, TIPS, & REQUIRED TOOLS3

REQUIRED ACCESSORIES.....3

VEHICLE PREPARATION4

INSTALLATION..... 5-8

FINISHING TOUCHES9

CARE AND MAINTENANCE.....9

SERVICE PARTS10





WARNINGS, TIPS, & REQUIRED TOOLS

Curtis accessories feature an assembly of parts designed for your vehicle which require adjustment and alignment of components to accommodate vehicle variations and provide proper weather protection. For accurate installation, proper operation, and years of satisfaction, please read and understand the installation and owner's manual fully prior to installing the A/C Roof Kit.

From all of us at Curtis, we thank you for choosing our product.

 NOTICE
<p>Curtis Cabs, blades and general accessories add additional weight to the base vehicle. All Curtis accessory weights are listed in product brochures. Deduct the accessory's total weight from the vehicle's rated capacity and never exceed the vehicle's rated capacity including driver and passenger.</p>

⚠ WARNING Exposure to Carbon Monoxide can Cause illness, serious injury or death. Never operate vehicle if suspicious of Carbon Monoxide. Inspect exhaust system for leaks monthly. Leaks can result from loose connections, corrosion, cracks or other damage to the exhaust manifold. If leaks are found, repair or replace exhaust system. Do not use vehicle until repair or

 WARNING	
Serious Injury or Death	
	This cab enclosure does not provide protection from rollover or other accidents.
	This cab enclosure does not provide protection from flying objects including golf balls.
	This cab enclosure does not provide protection from lightning. When lightning threatens take cover and do not operate vehicle.

California Health and Safety Proposition 65 Warning: This product may contain chemicals known to the state of California to cause cancer and birth defects or other reproductive harm.

GENERAL INFORMATION BEFORE YOU START

HELPFUL HINTS:

- To assist with installation, leave all fasteners loose for later adjustment unless otherwise specified.
- Read and understand all instructions before beginning.
- Apply a silicone sealant to seal any minor gaps that may occur due to vehicle variations.

TOOLS REQUIRED

- Set of standard sockets (3/8" drive)
- 3/8" drive ratchet and extension
- #2 and #3 Phillips head screwdriver
- Set of standard open-end wrenches
- Silicone sealant
- Cordless drill
- #2 Phillips head driver bit
- Scissors
- Anti seize
- Scribe
- Jig saw
- Touch up paint

ACCESSORIES REQUIRED

- Cab 1KBX70AS
- Ballast of at least 100 lbs.
(refer to Section 1.4 for additional details)
- Air Conditioner Drive Kit 1ACBX2380DRK
- Air Conditioner Unit 1ACUNIT-G1

A/C ROOF KIT INSTALLATION

STEP 1: (VEHICLE PREP)

- 1.1** Remove the clevis pins from the ROPS and fold down. Save these components.

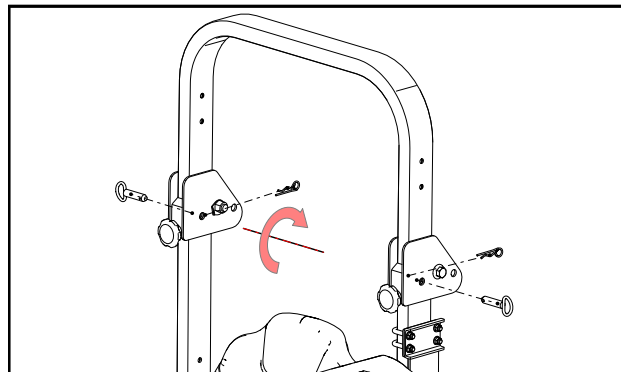

Fig. 1.1 (Fold ROPS)

- 1.2** Disconnect all accessories that are attached to the roof, such as LED lights. Save all hardware from this step for re-installation at the end of this procedure.

If the vehicle is not equipped with these accessories, skip this step.

If installation of the air conditioner is being installed at the same time as the cab, do not install accessories until this procedure is complete.

- 1.3** Remove roof.

If installation of the air conditioner is being installed at the same time as the cab, do not install the roof to complete the cab.

The roof will not be reused and new roof hardware is provided in this kit.

Tools

1/2" wrench
1/2" socket

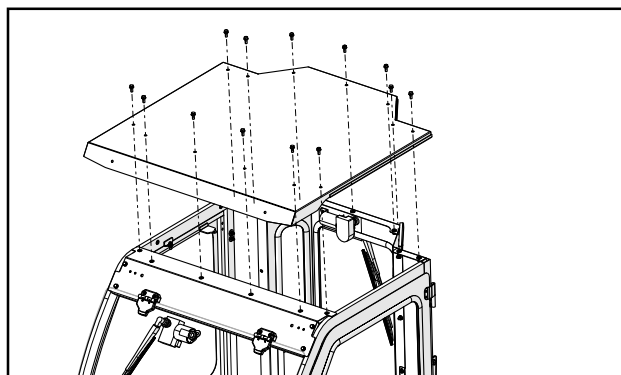

Fig. 1.3 (Remove Roof)

- 1.4** For vehicle stability, add a minimum of 100 lbs. (45 kgs) of weight as close to the ground as possible. Wheel ballast, such as liquid filled tires, is the recommended method of adding this weight.

A/C ROOF KIT INSTALLATION

STEP 2: (INSTALLATION)

CAUTION: Never turn the air conditioner upside down or on its side. Doing so will drain the compressor of its oil and will void the warranty .

- 2.1** With assistance, lower the roof assembly onto the top of the installed cab. Figure 2.1.

There is a rectangular cut out in the new roof for the air conditioner to fit through. **If this cut out is free from obstruction with the windshield support**, proceed to fasten the roof down as shown, hand tighten only then proceed to Step 2.5.

If the rectangular cut out for the air conditioner is not free from obstruction with the windshield support, a portion of the windshield support must be cut away and bolt holes must be drilled. Proceed to Step 2.2

Note: If the bolt holes do not line up well, loosen all of the bolts around the side frame of the cab. This will allow the cab to shift or move as necessary.

<u>Hardware Used</u>	<u>Qty</u>
5/16-18 x 3/4" flange bolt	9
5/16" plastic washer	9

- 2.2** Loosely install roof fasteners (as in section 2.1) to locate the roof, then mark the windshield support by tracing the perimeter of the rectangular cut out in the roof. Figure 2.2a.

Per Figure 2.2b, transfer the hole location of the circled bolt holes onto the windshield support.

Remove the fasteners and the roof.

Tools

5/16" center punch
Marker or scribe

- 2.3** Drill the new fastener holes with a 5/16" drill bit.

Cut the windshield support with a jig saw, or similar.

Apply touch up paint to all raw metal edges to prevent rust.

Tools

Drill
5/16" drill bit
Jigsaw
Touch up paint

- 2.4** Install the roof as per Step 2.1.

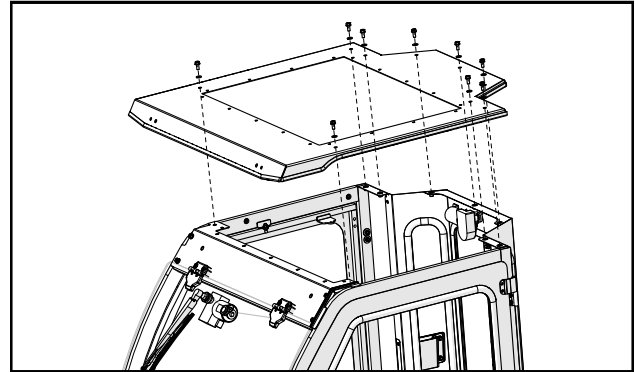

Fig. 2.1 (Install New Roof)

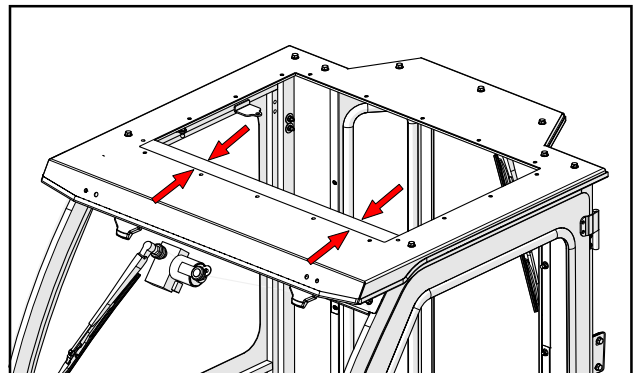

Fig. 2.2a (Cut Windshield Support)

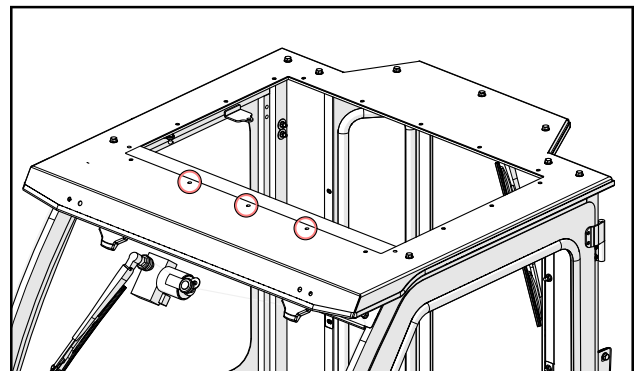

Fig. 2.2b (Drill Windshield Support)

A/C ROOF KIT INSTALLATION

STEP 2: (INSTALLATION)

- 2.5** Apply a bead of silicone along the perimeter of the opening in the roof (the top, exterior surface). The bead shall be inside of the fastener holes as illustrated with the dashed lines in the enlarged view of Figure 2.5.

Tools

Silicone

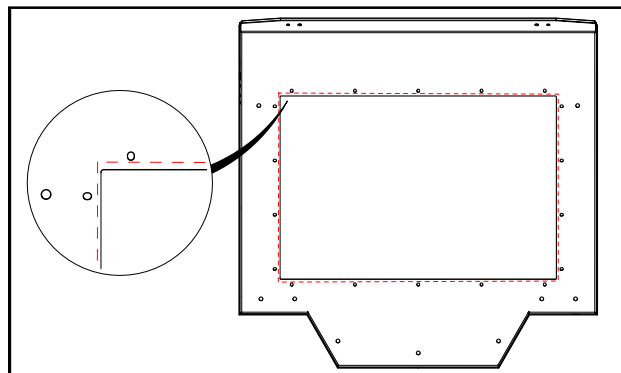

Fig. 2.5 (Apply Silicone)

- 2.6** Place the air conditioner unit onto the roof, center it inside of the roof's rectangular opening. Wipe away any excess silicone from inside and outside of the roof assembly.

Note: Orient the unit as shown when installing. The power cables will enter from the rear of the air conditioner.

Install fasteners to the roof and air conditioner along the perimeter of the air conditioner. After all of these fasteners are in place, fully tighten.

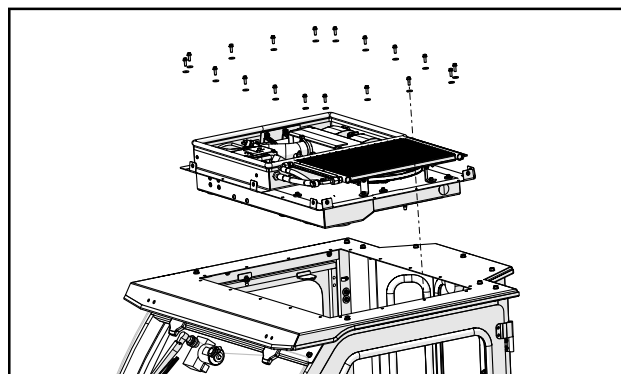

Fig. 2.6 (Insert A/C Unit)

Hardware Used

	<u>Qty</u>
1/4-20 x 3/4" flange bolt	18
1/4-20 flanged lock nut	18
1/4" plastic washer	18

Tools

3/8" wrench or socket
7/16" wrench or socket

- 2.7** Fully tighten all fasteners.
- 2.8** Attach drain tube to the side of the air conditioner on the passenger's side of the vehicle. Rotate the nipples to keep the drain tubing away from the doorway, this will also reduce the risk of kinking the drain tubes.

The passenger's side of the vehicle is shown in Figure 2.8, with the door removed for clarity.

Repeat this step for the opposite side of the vehicle.

Tip: Apply a little water to the nipple to lubricate and ease the installation of the drain tube.

Hardware Used

	<u>Qty</u>
PVC Tube, 3/8" Inside Dia., 90"	2

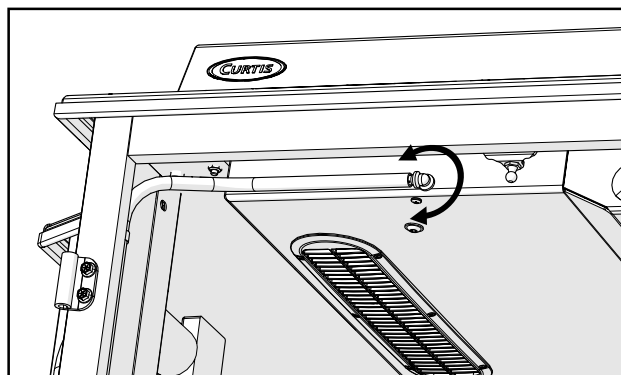

Fig. 2.8 (Attach Drain Tubes)

A/C ROOF KIT INSTALLATION

STEP 2: (INSTALLATION)

- 2.9 Route the Air Conditioner's drain tube along the door frame. Fasten to the door frame with 1/2" tube clamps and self drilling screws. Space the tube clamps approximately 16 inches apart.

Route the drain between the cab's frame and the vehicle's fender panel at the floor.

Trim the drain tube so that it hangs just to the bottom of the vehicle. Take care that it is well away from the tire.

Repeat this step for the opposite side of the vehicle.

Figure 2.9 shows the vehicle from the driver's side of the vehicle with the door, side frame, and windshield hidden for clarity.

Hardware Used

#10 self drilling screw

Qty

8

1/2" tube clamp

8

1/4" plastic washer

8

Tools

Cordless drill

#2 Phillip's screw driver bit

Scissors

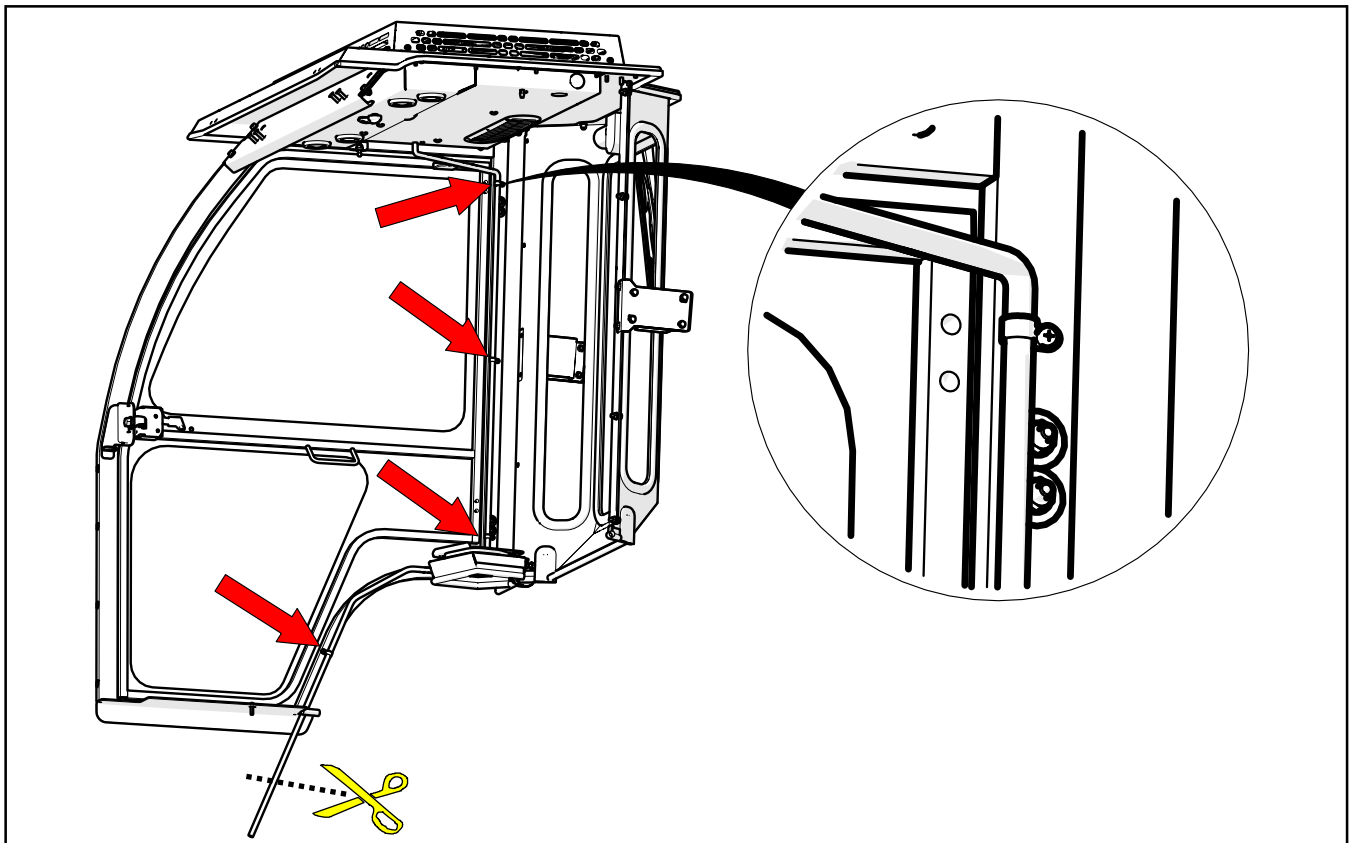

Fig. 2.9 (Routing Drain Tubes)

A/C ROOF KIT INSTALLATION

STEP 2: (INSTALLATION)

- 2.10** Remove the 12-volt power outlet from underneath the seat of the vehicle. Disconnect the plug that is connected to the outlet.



Fig. 2.10 (Remove Power Outlet)

- 2.11** Connect the wiring harness from this kit in between the outlet and the plug.



Fig. 2.11 (Connect Power Outlet to Wire Harness)

- 2.12** Pass the end of the wire harness with a single bullet terminal through the outlet's hole, then install the outlet back into place.



Fig. 2.12 (Wire Routing to Power Harness)

- 2.13** Route the harness under the vehicle and towards the front of the vehicle. Zip tie the harness to the bottom of the vehicle. Alternately, zip tie the harness to the main power harness (from the alternator kit).

Still underneath the vehicle's floor, turn the harness towards the battery compartment. Pull the harness up through the battery compartment. Be sure to zip tie the harness securely away from all moving components.

The bullet terminal at the end of this wire will be used to connect to the corresponding male bullet terminal of the power harness (from the alternator kit).



Fig. 2.13 (Wire Routing Into Battery Compartment)

A/C ROOF KIT INSTALLATION

STEP 3: FINISHING TOUCHES

- 3.1 Refer to the A/C Drive Kit Installation Manual specific to this vehicle. Follow those instructions to electrically connect the air conditioner, and test its operation.
- 3.2 Install cover to air conditioner. Install the M6 screw first, then install the 1/4-20 bolts. Tighten all fasteners in this step.

Hardware Used

	<u>Qty</u>
1/4-20 x 3/4" flange bolt	10
M6X1 X 16mm truss head screw	1
M6 Rubber Washer	1

Tools

3/8" wrench or socket
 #2 Phillips Head Screwdriver
 Apply anti seize to bolt threads

- 3.3 Return ROPS to its upright position (Refer to step 1.1).
- 3.4 Re-install any other accessories that were removed during this procedure.
- 3.5 Inspect for loose fasteners or wires.

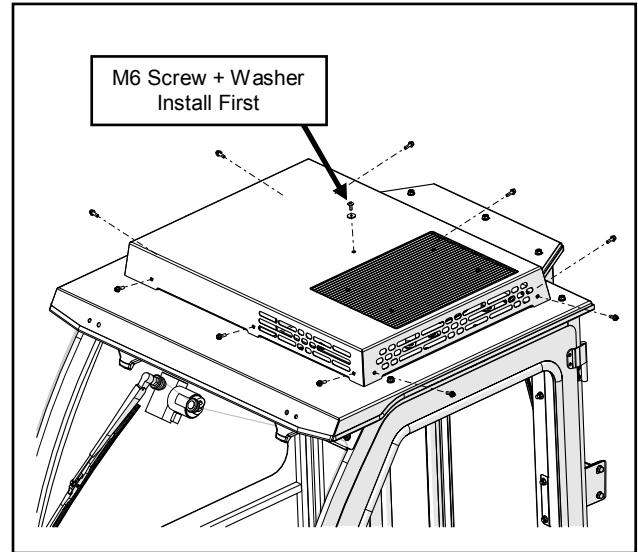

Fig. 3.2 (A/C Cover Fasteners)

CARE AND MAINTENANCE

- Check and tighten hardware after 40 hours of operation. Periodically inspect and tighten hardware for the remainder of the unit's life.
- Wash the painted surfaces of the cab with commercial automotive cleaning products.

SERVICE PARTS

ROOF ASSEMBLY
P/N: 8SV-101-00022

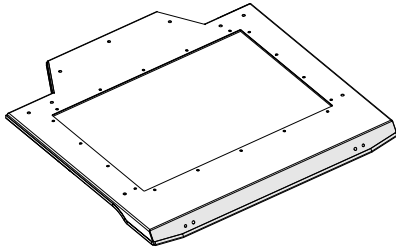

COVER ASSEMBLY, A/C, W/ CUT-OUTS,
DARK GRAY; P/N: 8SV-303-00001KG

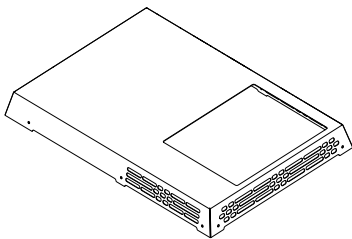

DRAIN HOSE
9SV-AC-00019-15

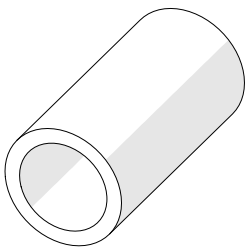

TRIM LOK, STD, 1/16" - 1/8" GRIP
P/N: 9SV-PRO1-20

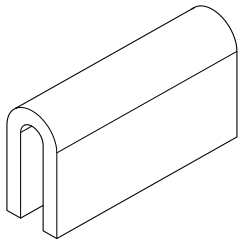

1/2" WEATHERSEAL
9SV-PR20-10

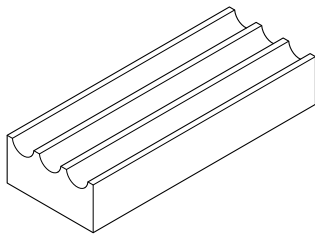

WIRE HARNESS, 12V OUTLET JUMPER
9SV-WH-00070

< NOT PICTURED >