



**INSTALLATION MANUAL
LED FRONT WORK LIGHT KIT
(77700-VC5050, VC5050)
KUBOTA RTV-X900, RTV-X1120D, RTV-X1140, RTV-XG850**

CALIFORNIA PROPOSITION 65



WARNING:

Cancer and reproductive harm - www.P65Warnings.ca.gov

This kit requires either: VC5080 Switch Panel Kit or VC5081 Single Accessory Harness Kit.

Also requires one of these canopies: VC5000, VC5001, VC5011, VC5043, or VC5044.

Not compatible with: V5221 Canopy.

BEFORE INSTALLING REAR WORK LIGHT

- Read all instructions and safety instructions in this manual.
- Refer to your machine's operator's manual and safety instructions on your machine's safety decals.
- Wear appropriate personal protective equipment (PPE) when performing work.
- Disconnect negative (-) terminal on battery before performing work.
- Hang a **"DO NOT OPERATE"** tag in operator station.



WARNING

To avoid personal injury or death:

- Work lights are for off-road use only. Do not use if operating vehicle on a public way.

Estimated assembly time: 30 minutes

■ AVAILABLE REPLACEMENT PARTS

Ref. No.	Part No.	Part Name	QTY	REMARKS
1	77700-05166	LED Work Light, Flat 5	1	Code No.: 9LEDFWL-A (contains one light)
2	70000-01086	3/8" Rubber Grommet	1	Code No.: AC1028 (contains one grommet)
3	77700-05167	Wire Harness, Front Work Light Kit	1	Code No.: KX9FWLWH (contains one harness)
4	70000-01156	Lighted 2-Position Switch, Carling (Off-On)	1	Code No.: OHC-5 (contains one switch)
5	77700-01220	Switch Actuator Cover (Lights)	1	Code No.: 9PCD1-C (contains one switch cover)

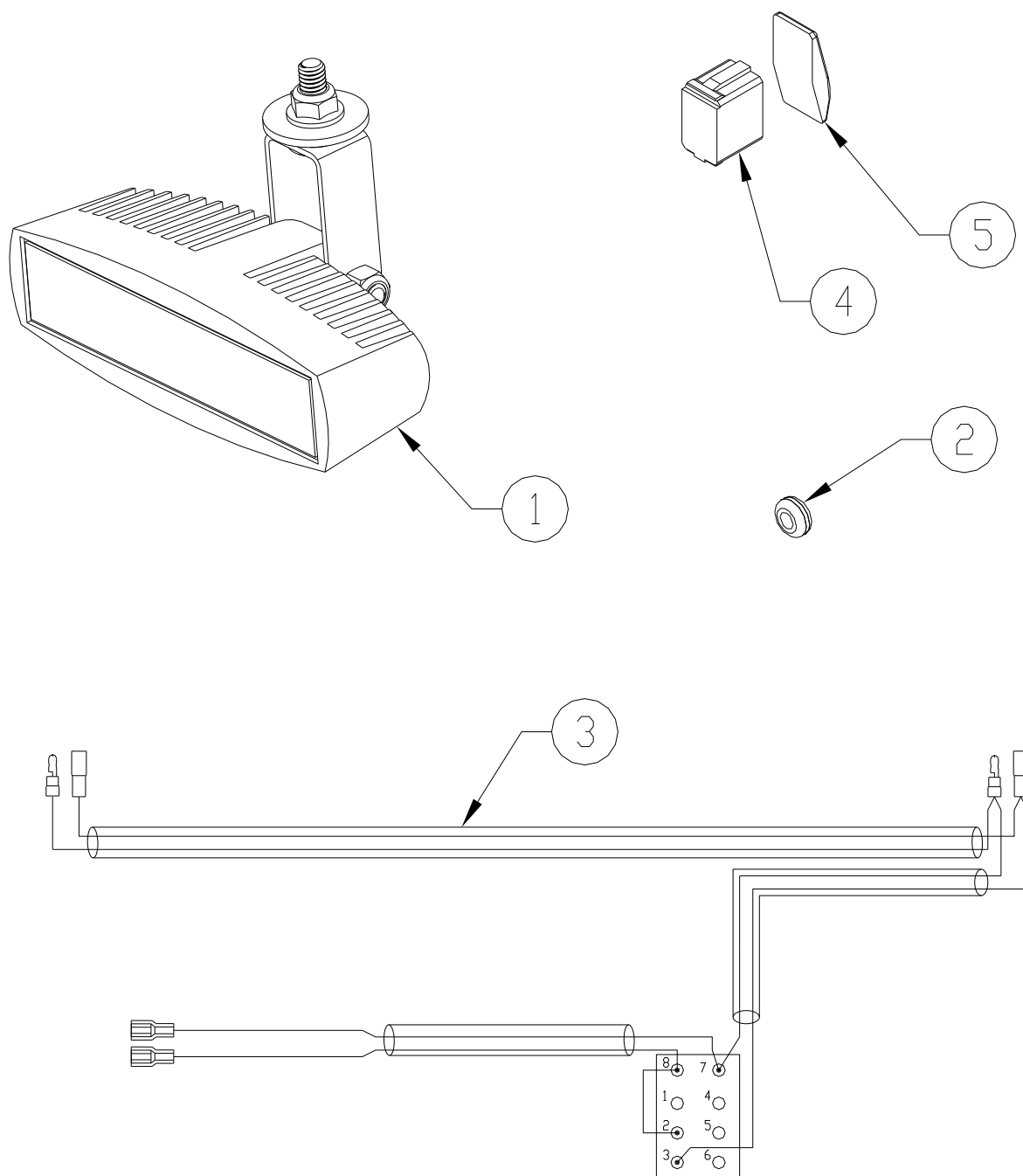



CAUTION

To avoid personal injury:

- Park the machine on a firm and level surface.
- Apply the parking brake if applicable.
- Stop the engine and remove the key from the machine if applicable.
- Disconnect negative (-) terminal on battery before performing work.

■ ASSEMBLY PROCEDURE

NOTE:

- **All assembly procedures listed within this manual are generally representative of the machine model for which the manual is written.** Your machine may be configured differently, but the outline for the procedure should still be followed. For further support for any issues not covered within the pages of this manual, please contact your local Kubota representative.

STEP 1: Install Work Light

1. Turn vehicle off and disconnect the battery.
2. Install the work light through the hole in the roof using the hardware shown in figure 1.2. **IMPORTANT: orient the light with the wire on the underside so that any condensation that forms in the light can drain correctly.**
3. Remove and discard the plastic hole plug from the windshield frame.
4. Install a rubber grommet onto the work light wire and insert the terminals through the hole in the windshield frame. Then push the rubber grommet into place in the hole.

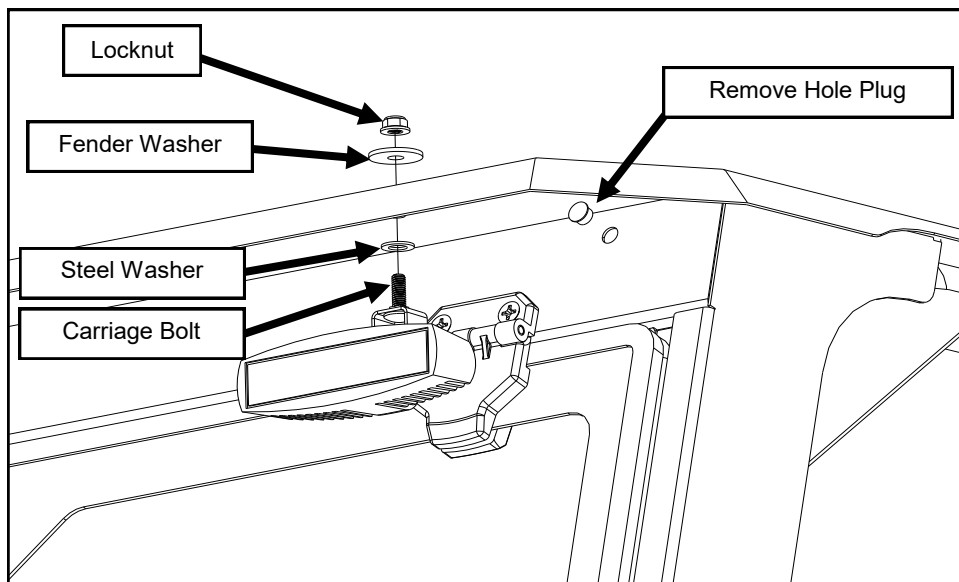

Fig. 1.2

STEP 2: Installing Switch / Wiring

A. If installing with wire harness kit / single accessory:

1. Install the VC5081 wire harness kit for single accessory.
2. Remove one of the rectangular switch plugs from the vehicle dashboard.
3. Open vehicle hood. From under the hood, route the Carling 8-pin connector (on provided wiring harness) through the rectangular cut-out in the vehicle dashboard. Plug the Carling connector into the back of the switch. Snap switch into dashboard. (See Figure 2.A).
4. Plug the two push-on connectors (short section of harness) into the terminals at the end of the VC5081 harness. Connect red to positive and black to negative.
5. Route long section of harness up through the hole in the dash at the driver's side front ROPS tube (See Figure 2.A).

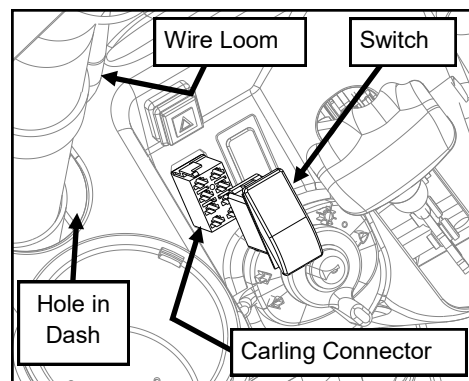

Fig. 2.A

B. If installing with switch panel / wire harness kit:

1. Install the VC5080 Switch Panel Kit, but do not install the switch panel to the windshield.
2. Remove one of the rectangular switch plugs from the switch panel.
3. Route the Carling 8-pin connector (on provided wiring harness) through one of the rectangular cut-outs in the switch panel. Plug the Carling connector into the back of the switch. Snap the switch into the switch panel. (See Figure 3.B). Install any additional accessories and then fasten the switch panel to the windshield.
4. Feed the short section of harness down through the hole in the dash at the driver's side front ROPS tube (See Figure 2.A) and connect to the fuse block. See switch panel installation instructions for proper wiring locations.

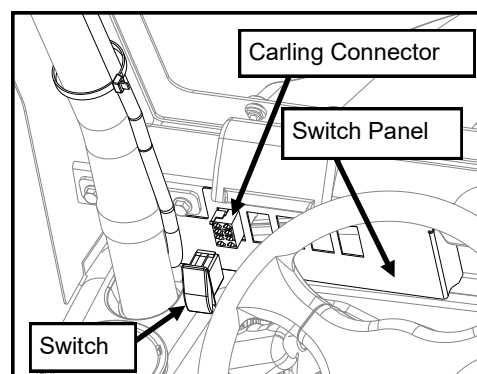

Fig. 3.B

STEP 3: Wiring

1. Pull the long section of harness up to the driver's side light and connect the terminals. The harness will fit to the left of the ROPS tube. Once connected to the driver's side light, route the remainder of the harness across to the passenger side light and connect the terminals.
2. Starting at the driver's side light, secure the wire harness to the ROPS tube using the provided zip-ties. First secure across to the passenger side light then secure down the vertical ROPS tube to the switch.
3. Any extra wire should be fed down through the hole in the dashboard and secured or pushed behind the switch panel.
4. Install the supplied fuse into either the fuse holder near the battery (if using VC5081 kit) or into the fuse block under the hood (if using VC5080 kit).

CARE AND MAINTENANCE

IMPORTANT CLEANING INFORMATION

Clean plastic lens and outer housing with mild soap and water. Avoid use of harsh chemicals on plastic, as they may damage the plastic.