



**INSTALLATION MANUAL
PLASTIC CANOPY
(77700-VC5011, VC5011) (color: black)
KUBOTA RTV-X900, RTV-X1120D, RTV-XG850**

CALIFORNIA PROPOSITION 65



WARNING:
Cancer and reproductive harm - www.P65Warnings.ca.gov

IMPORTANT!

CAB COMPONENT ORDER OF INSTALLATION:

1. Canopy Mounts (Canopy Kit)
2. Windshield Assembly
3. Door Strikers & Hinge Mounts (Door Kit)
4. Rear Panel Assembly
5. Canopy Assembly
6. Door Assemblies

NOTE: Front Heavy Duty Springs (V5218) or Heavy Duty Spring Damper Assembly (V5219) is required if complete cab is installed (RTV-X900, RTV-X1120D, RTV-XG850).

BEFORE INSTALLING CANOPY

- Read all instructions and safety instructions in this manual.
- Refer to your machine's operator's manual and safety instructions on your machine's safety decals.
- Wear appropriate personal protective equipment (PPE) when performing work.
- Hang a **"DO NOT OPERATE"** tag in operator station.
- If installing windshield and/or rear panel, install those components before installing canopy.
- If installing work lights, it will ease assembly if they are installed prior to installing canopy onto vehicle.



WARNING

To avoid personal injury or death:

- Cabs, blades, and general accessories add additional weight to the base vehicle. Deduct the accessory's total weight from the vehicle's rated capacity including passenger and driver. Never operate the vehicle outside of its rated weight capacity.
- Exposure to carbon Monoxide can cause illness, serious injury, or death. Never operate vehicle if suspicious of Carbon Monoxide. Inspect exhaust system for leaks monthly. Leaks can result from loose connections, corrosion, cracks, or other damage to the exhaust manifold. If leaks are found, repair or replace exhaust system. Do not use vehicle until repair or replacement is complete.
- This canopy does not provide protection from: a rollover (or other accidents), from flying objects (including golf balls), or from lightning. When lightning threatens, take cover and do not operate vehicle.

Estimated assembly time: 30 minutes

■ AVAILABLE REPLACEMENT PARTS

Ref. No.	Part No.	Part Name	QTY	REMARKS
1	77700-05136	Canopy, Plastic, Black	1	Code No.: KX9-01B (contains one canopy)
2	77700-06749	Roof Mount, Stamped and Drawn (left)	1	Code No.: SM-00083-L (contains one mount)
3	77700-06932	Roof Mount, Stamped and Drawn (right)	1	Code No.: SM-00083-R (contains one mount)
4	77700-05137	Hardware Kit, Plastic Roof	1	Code No.: KX9HWK-01 (contains all items listed below)
5	77700-05134	1/2" w x 9/16" Rubber Foam Weatherseal (92" long)	1	Code No.: 9PR43-92 (contains one strip)

NOTE: Items in hardware kit not sold separately.

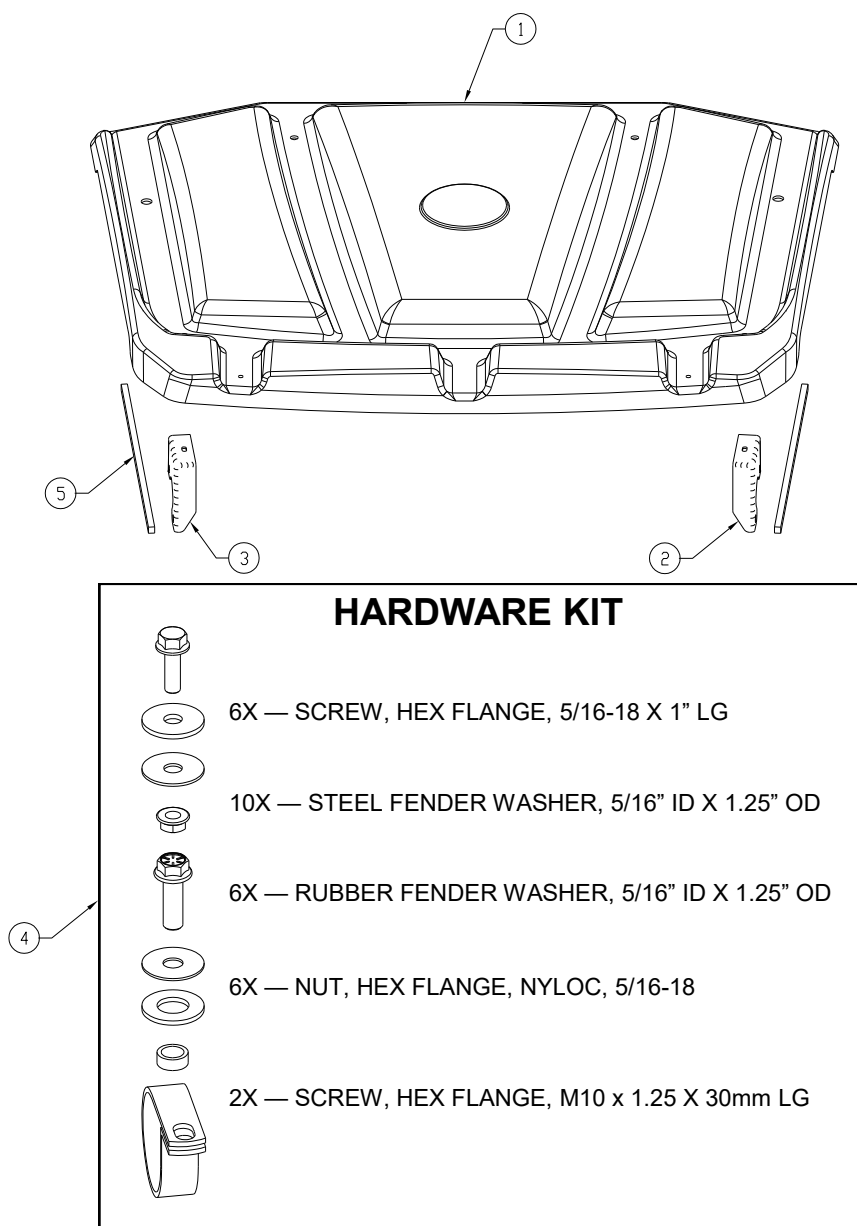



CAUTION

To avoid personal injury:

- Park the machine on a firm and level surface.
- Apply the parking brake if applicable.
- Stop the engine and remove the key from the machine is applicable.

■ ASSEMBLY PROCEDURE

NOTE:

- **All assembly procedures listed within this manual are generally representative of the machine model for which the manual is written.** Your machine may be configured differently, but the outline for the procedure should still be followed. For further support for any issues not covered within the pages of this manual, please contact your local Kubota representative.

1. Remove 2 front right ROPS bolts (M10), and save for re-use.
2. Install right canopy mount, using ROPS bolts removed in step 1. Torque to 38 ft.-lbs. (See fig. 2)
3. Repeat on left side.
4. Cut the provided foam tape in half.
5. Install foam tape to the top of the front-to-rear ROPS tubes on both sides of the vehicle. Foam tape to start approximately 1-1/2" in front of front ROPS bracket edge. (See fig. 5) Note: For best adhesion, apply to a clean, dry surface at room temperature.

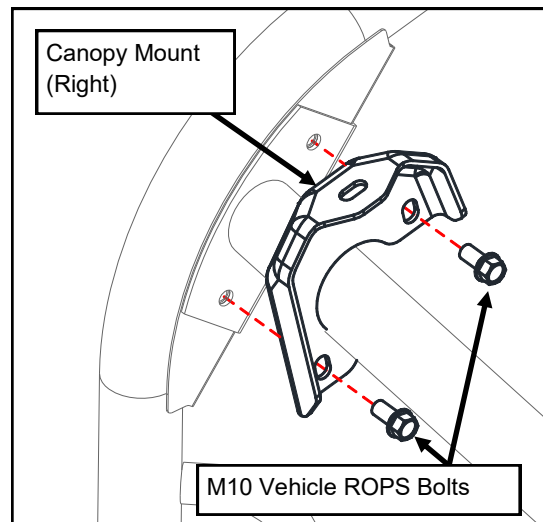

Fig. 2

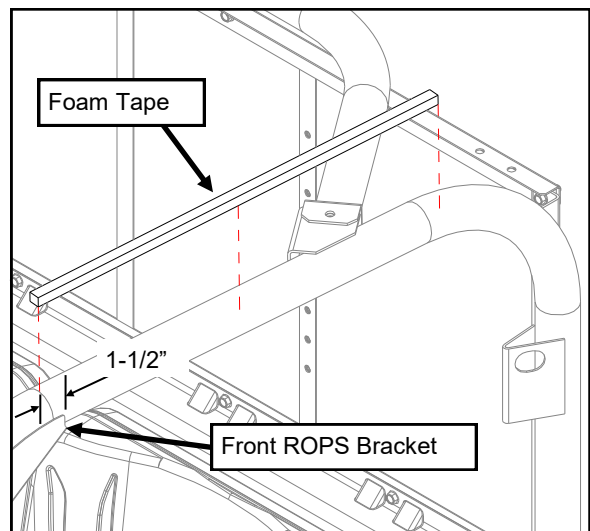

Fig. 5

IMPORTANT! If installing a windshield and/or rear panel, proceed to installing those components prior to completing canopy installation.

6. Remove (2) top rear ROPS bolts (M10). Discard.
 7. Loosely install (2) P-Clamps onto ROPS rear cross member at both bends in approximate location shown. Orient flat section up. Fasteners to be installed later.
 8. Align mounting holes in canopy to rear ROPS mounting holes, P-Clamps, and slots in canopy mounts.
 9. Install M10 x 30mm long screws, with 3/8" ID fender washers, 5/8" ID rubber washers, and steel spacers provided. See Fastener Installation Diagram 1 for fastener installation order. Torque to 38 ft.-lbs.
 10. Install (4) 5/16-18 screws, washers, etc. through front canopy mounting holes. (see fig. 10) See Fastener Installation Diagram 2 for fastener installation order.
- Note: (2) inner front fasteners will be used solely to plug the mounting holes if no windshield is installed.
11. Install (2) 5/16-18 screws and washers through canopy and P-Clamps in rear. Secure with 5/16-18 flange nut. See Fastener Installation Diagram 2 for fastener installation order.

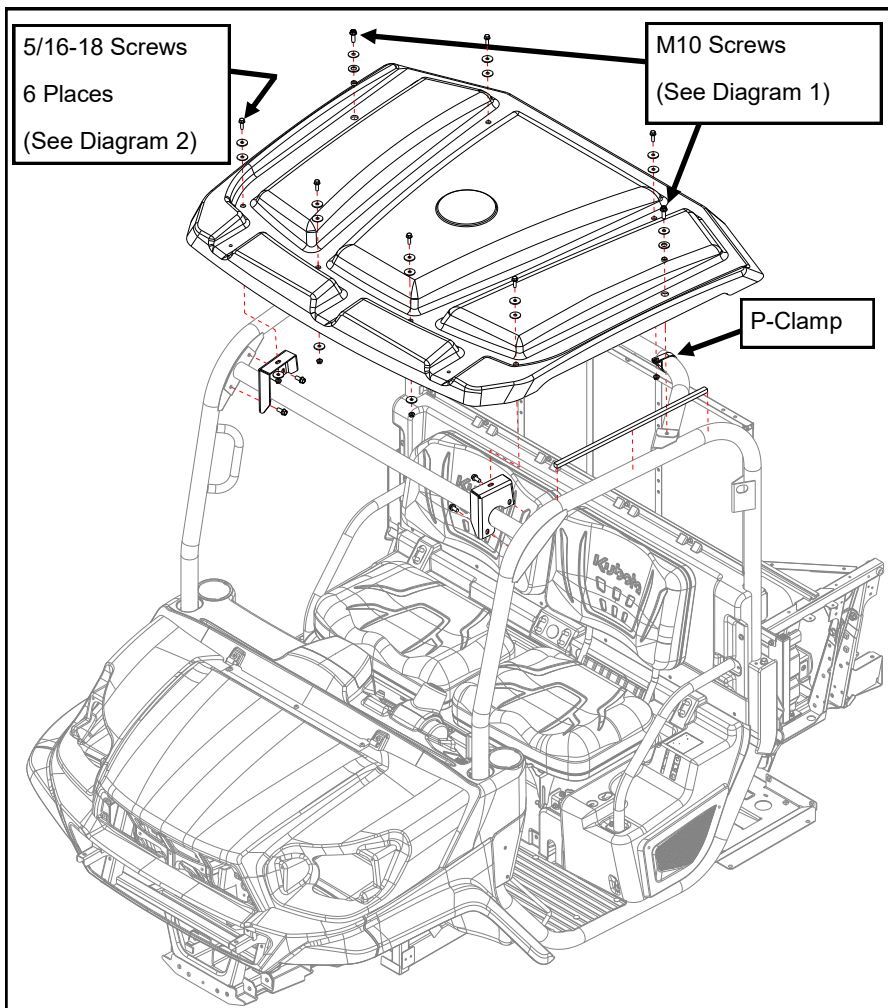
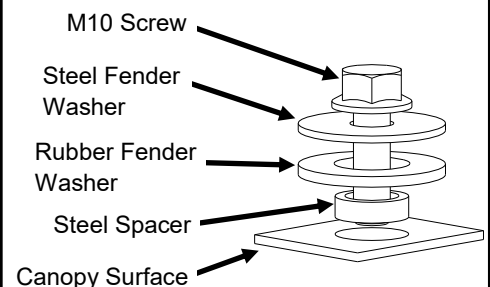

Fig. 10

Fastener Installation Diagram 1



Note: M10 screws thread into factory weld-nuts on vehicle ROPS.

Fastener Installation Diagram 2

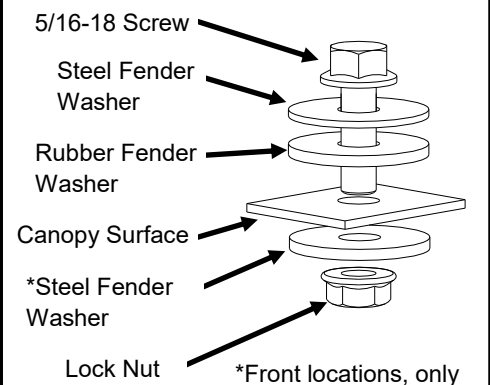

CARE AND MAINTENANCE

Check and tighten hardware after 20 hours of operation.

Periodically inspect and tighten hardware for the remainder of the unit's service life.

IMPORTANT CLEANING INFORMATION

Keep the enclosure components clean in order to prevent dust and dirt from forming an unattractive film. The life of your canopy depends upon following these care procedures:

12. **NEVER USE** AN ABRASIVE DETERGENT / VEHICLE CLEANER OR A WIRE BRISTLED BRUSH. Do not use any **CITRUS BASED CLEANERS** such as orange or lemon. Use of these products will cause the plastic to become permanently damaged.

13. Clean the plastic enclosure surfaces thoroughly with warm soapy water and a COTTON cloth or chamois. Be sure to use mild soap, specifically a dish liquid or equivalent. Clean in a light circular motion for best results.

14. Use EXTRA CAUTION when cleaning the interior of the enclosure. The interior is more sensitive than the exterior because the exterior has an extra coating for U.V. stability.

15. Remove grease and oil with mineral spirits and a COTTON cloth or chamois.