

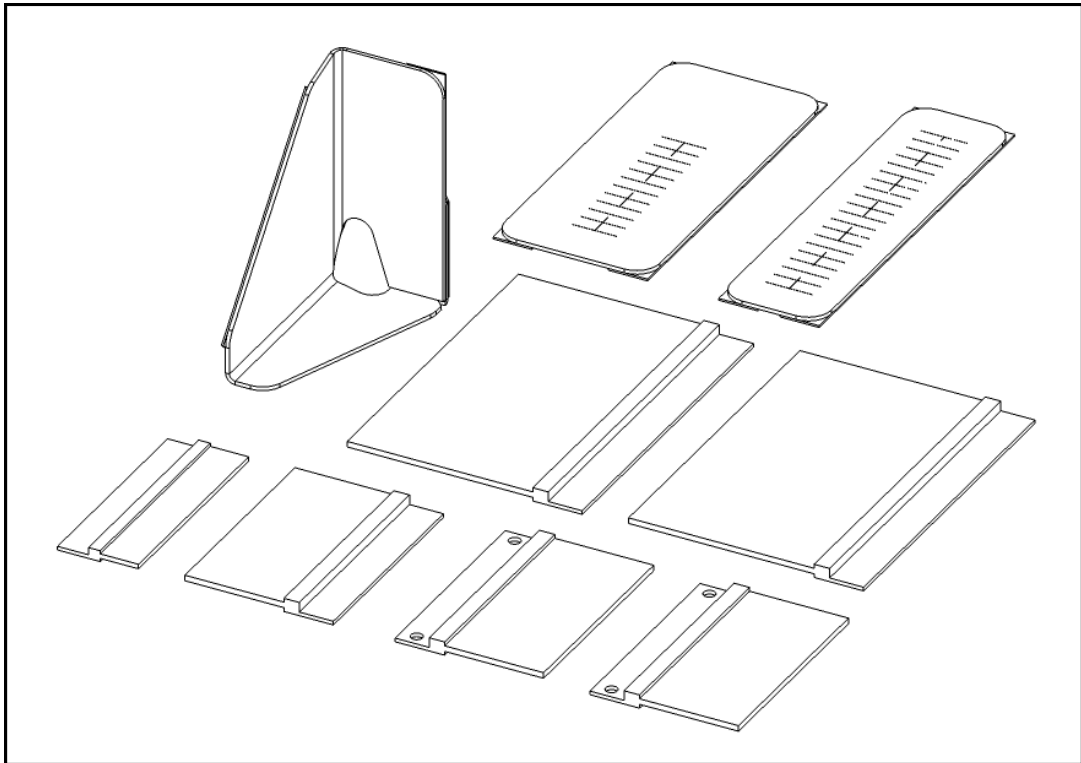

MAHINDRA 1626
Seal Kit (p/n: 9SK4)
Fits Tractor Models: 1626



The contents of this envelope are the property of the owner. Leave with the owner when installation is complete.

Rev. A, 09/16/2019

p/n: IM-9SK4

TABLE OF CONTENTS

WARNINGS, TIPS, & REQUIRED TOOLS	3
SEAL KIT INSTALLATION	4-6

WARNINGS, TIPS, & REQUIRED TOOLS

For accurate installation, proper operation, and years of satisfaction, please read and understand the installation and owner's manual fully prior to installing the seal kit.

From all of us at Curtis, we thank you for choosing our product.

▲ WARNING Exposure to Carbon Monoxide can Cause illness, serious injury or death. Never operate vehicle if suspicious of Carbon Monoxide. Inspect exhaust system for leaks monthly. Leaks can result from loose connections, corrosion, cracks or other damage to the exhaust manifold. If leaks are found, repair or replace exhaust system. Do not use vehicle until repair or replacement is complete.

California Health and Safety Proposition 65 Warning: This product may contain chemicals known to the state of California to cause cancer and birth defects or other reproductive harm.

GENERAL INFORMATION BEFORE YOU START

HELPFUL HINTS:

- Read and understand all instructions before beginning.

TOOLS REQUIRED:

- Drill/Driver
- #2 Philips Bit
- 7/32" Drill Bit
- Set of Standard Sockets (3/8" Drive)
- Set of Standard Open-End Wrenches
- Scissors

SEAL KIT INSTALLATION

Note: Make sure the areas where the supplied Velcro will be applied are clean, dry and at room temperature for best adhesion.

STEP 1: (IDENTIFY THE SEALS)

1.1 See Figure 1.1. Identify each seal and note its proper location.

STEP 2: (PRE-APPLY VELCRO)

2.1 Pre-apply Velcro to the Dif. Lock Seal, Mower Knob Seal, and 4x4 Lever Seal. Leave the backer on until the seals are mostly in place.

Tools Required

Scissors

STEP 3: (VELCRO ON SEALS)

3.1 Slide the Mower Knob Seal over the mower knob and line it up in place. Remove the backing from the stick-on Velcro and secure the seal in place. See Figure 3.1.

3.2 Slide the Dif. Lock Seal over the differential lock lever and line it up in place. Remove the backing from the stick-on Velcro and secure the seal in place, trying to minimize covering the decal. See Figure 3.2.

3.3 Slide the 4x4 Lever Seal over the 4x4 lever and line it up in place. Remove the backing from the stick-on Velcro and secure the seal in place, trying to minimize covering the decal and keeping the filler "fingers" closed. See Figure 3.3.

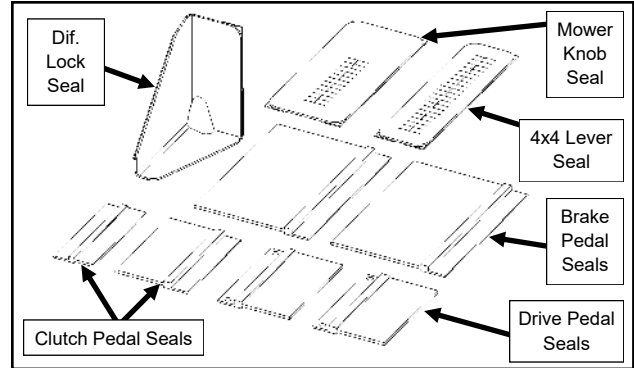

Figure 1.1 (Identify Seals)



Figure 3.1 (Install Mower Knob Seal)



Figure 3.2 (Install Dif. Lock Seal)



Figure 3.3 (Install 4x4 Lever Seal)

SEAL KIT INSTALLATION

STEP 4: (CLUTCH PEDAL SEALS)

- 4.1 Flex the short bristle clutch pedal seal into place in the molded pocket in the floorboard. See Figure 4.1.
- 4.2 Flex the long bristle clutch pedal seal into place in the molded pocket in the floorboard. See Figure 4.2.



Figure 4.1 (Install Short Bristle Clutch Pedal Seal)



Figure 4.2 (Install Long Bristle Clutch Pedal Seal)

STEP 5: (BRAKE PEDAL SEALS)

- 5.1 Flex a brake pedal seal into place in the molded pocket in the floorboard. See Figure 5.1. Keep the plastic edge close to the outer pedal arm.
- 5.2 Flex the second brake pedal seal into place in the molded pocket in the floorboard. See Figure 5.2.



Figure 5.1 (Install a Brake Pedal Seal)



Figure 5.2 (Install Second Brake Pedal Seal)

SEAL KIT INSTALLATION

STEP 6: (DRIVE PEDAL SEALS)

- 6.1 Set a drive pedal seal into place in the molded pocket in the floorboard and secure with self-drill screws through the pre-drilled holes in the brush. See Figure 6.1.

<u>Hardware Used</u>	<u>Qty</u>
#10 x 1/2" Self-Drill Screw	2

Tools required

Drill/Driver
#2 Phillips Bit

- 6.2 Set the second drive pedal seal into place in the other molded pocket in the floorboard and secure with self-drill screws through the pre-drilled holes in the brush. See Figure 6.2.

<u>Hardware Used</u>	<u>Qty</u>
#10 x 1/2" Self-Drill Screw	2

Tools required

Drill/Driver
#2 Phillips Bit



Figure 6.1 (Install a Drive Pedal Seal)



Figure 6.2 (Install Second Drive Pedal Seal)

OPTIONAL STEP 7: (SECURE CLUTCH AND BRAKE PEDAL SEALS)

- 7.1 If the clutch and brake pedal seals do not stay in place sufficiently, hardware has been provided to secure them. Using a 7/32" drill bit, drill through the plastic edge of the brushes and through the rubber floorboard. Secure with the provided hardware.

<u>Hardware Used</u>	<u>Qty</u>
#10-32 x 1/2" Screws	8
#10 Flat Washers	8
#10-32 Nuts	8

Tools required

Drill/Driver
7/32" Drill Bit
#2 Phillips Bit or Screw Driver
3/8" Socket or Wrench