



**MOTOR INSTALLATION AND WIRING INSTRUCTIONS
FOR WEXCO WIPER MOTORS
(p/n's.: 9PWK65T, 9PWK85, and 9PWK110)**

CAUTION: THESE MOUNTING INSTRUCTIONS SUPERSEDE THE ONES PROVIDED WITH THE WIPER KIT. FAILURE TO FOLLOW THESE INSTRUCTIONS COULD RESULT IN WINDSHIELD BREAKAGE.

1. INSTALL WIPER MOTOR THROUGH GLASS WINDSHIELD (option 1 of 2)

- 1.1 If equipped, remove the rubber plugs from the windshield by inserting a screwdriver into the plugs from inside the cab and pushing them out. **WARNING: Avoid damage!** Do not pry against the windshield to remove the plugs from outside the cab.
- 1.2 Remove the large hex nut, steel washer, and two rubber washers from the motor shaft, retain for use in step 1.3 and 1.5. Put the large white nylon bushing with the collar over the shaft as shown on the next page.
- 1.3 From the inside, insert the motor shaft out through the larger hole in the windshield until the white nylon bushing is against the windshield. Install the rubber washer and plastic washer provided, and secure with the hex nut removed in the previous step on the outside end of the shaft. Do not tighten completely at this point. **CAUTION: Make sure that the metal parts of the wiper motor do not contact the glass during installation. Damage could occur.**
- 1.4 Cut Packard connector from the supplied wiring harness or overhead console harness. Install the supplied female push-on connector to the red wire of the harness and connect to the male connector on the wiper motor body.
- 1.5 Crimp the supplied ring connector on to the black wire from the harness or overhead console. From the inside, put the small white nylon bushing with the collar into the small hole in the windshield and pivot the wiper motor so that the small hole aligns with the hole in the bushing. Insert the 1/4-20 bolt through the internal tooth washer, the ring terminal, the hole in the wiper motor bracket, the small bushing, and finally the windshield. Next, install the two rubber washers and steel washer removed from the motor shaft in step 1.2. Secure with cap nut provided.
- 1.6 Tighten the bolts at this time. Tighten the hex nut on the motor shaft to 30 inch-lbs and the 1/4-20 hex head bolt to 75 inch-lbs.. **WARNING: Over tightening wiper mounting hardware can damage windshield and components. Tighten only to specified values.**

2. INSTALL WIPER MOTOR TO SHEET METAL (option 2 of 2)

- 2.1 Install wiper motor shaft with one rubber washer inside and one rubber washer outside the cab. Line up the wiper motor mounting hole and install with 1/4-20 bolt, nylon lock nut, and washers provided.
- 2.2 Cut the Packard connector from the supplied wiring harness or overhead console harness.
- 2.3 Install the supplied female push-on connector to the red wire of the harness and connect to the male connector on the wiper motor body. The black wire is not required for this installation as the motor grounds through the sheet metal cab.

ALL OTHER ASPECTS OF INSTALLATION AND WIRING ARE AS EXPLAINED IN THE OTHER SET OF INSTRUCTIONS.

CABS/BLADES/ SPREADERS/ACCESSORIES

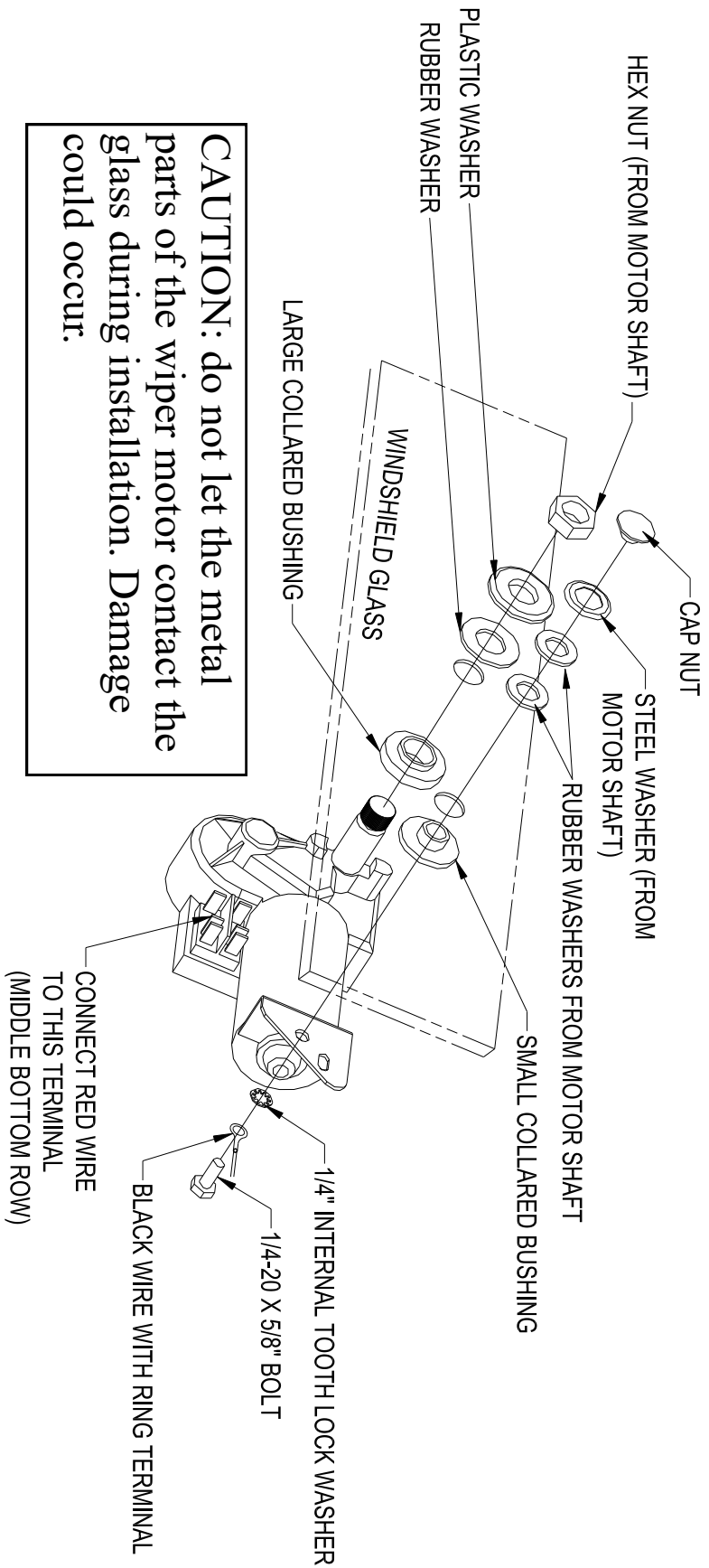

CAUTION: do not let the metal parts of the wiper motor contact the glass during installation. Damage could occur.

KIT CONTENTS FOR WEXCO WIPER MOTOR

- 1 Wexco motor
- 1 Insulated female push-on terminal (1/4")
- 1 Wexco wiper arm with Castells blade mounting bracket
- 1 5/16" ring terminal