

**Club Car
Mount Kit
UTV Universal Plow
ICCUTPMK**

The contents of this envelope are the property of the owner.
Be sure to leave with the owner when installation is complete.

IMPORTANT: Please read the installation instructions thoroughly before beginning. Installation of any item is easier if the vehicle is clean and free of debris.

These instructions are only valid for attachment to 2006 & Newer Club Car XRT 1500

Note: Front Heavy Duty Springs or Heavy Duty Spring Damper Assembly are required if plow is installed



▲ WARNING
Do not attempt to install or operate this plow until you read and understand all warnings and instructions in this manual or on the plow. Failure to read all warnings and instructions could lead to serious injury or death.

ADDED WEIGHT NOTICE
Curtis Cabs, blades and general accessories add additional weight to the base vehicle. All Curtis accessory weights are listed in product brochures. Deduct the accessory's total weight from the vehicle's rated capacity and never exceed the vehicle's rated capacity including driver and passenger.

SAFETY INFORMATION:

⚠ WARNING: Cabs, blades, and general accessories add additional weight to the base vehicle. Deduct the accessory's total weight from the vehicle's rated capacity including driver and passenger. Never operate the vehicle outside of its rated weight capacity.

⚠ WARNING: **Exposure to Carbon Monoxide can cause illness, serious injury or death.** Never operate vehicle if suspicious of Carbon Monoxide. Inspect exhaust system for leaks monthly. Leaks can result from loose connections, corrosion, cracks or other damage to the exhaust manifold. If leaks are found, repair or replace exhaust system. Do not use vehicle until repair or replacement is complete.

⚠ WARNING: **Serious injury or death:**

- Never stand or ride on the plow assembly.
- Never operate the plow near pets or other people.
- Never leave the vehicle running unattended with plow attached.
- Never plow or carry plow at high speeds.
- Never clean or perform maintenance with plow raised.
- Never clean or service with plow in tripped condition.
- Never dislodge an obstruction with any part of the body.
- Warning - This attachment affects the handling performance.
- Warning - Before starting installation park RTV in a flat area, ensure parking brake is engaged, and engine is turned off.

HELPFUL REMINDERS:

- A. Check carton contents prior to beginning installation.
- B. Work in an organized area large enough to fit vehicle and plow.
- C. Have the required tools ready to speed up the installation time.
- D. Have a helper available to help move heavy parts and assemblies.

The Installation should be done by “qualified personnel”.

MAINTAINANCE NOTES:

- **Check and tighten all fasteners in the plow assembly and vehicle mounting after initial use and every 5 hours of use thereafter.**
- **After every 10 hours of use, lubricate all pivot bolts, pins, snap lock latches, and any other moving parts in the plow assembly with all-season grease.**

Tools Required:

Set of standard and metric sockets
Set of standard and metric open end wrenches
One 3/8" Drive Ratchet
Pliers

File or Burr Removal Device
Torque Wrench

1. PRELIMINARY:

- 1.1 **Warning** Disconnect the battery. Disconnect the negative battery terminal first then the positive terminal second.

2. MOUNTING FRAME:

- 2.1 Remove the (4) existing bolts that attach the Front Bumper to the vehicle. Remove the Front Bumper and set aside. Remove the (2) front and the (2) outer most screws that hold the front plastics to the Frame and the front of the vehicle and pull forward slightly to make room for the Mounting Bracket Assembly.
- 2.2 Align (4) top holes in the Mounting Bracket Assembly with the (4) matching holes in the Front Crossmember of the frame. Using M10 x 1.25 –90MM Hex head Bolts and M10 x 1.25 Locknuts attach Mounting Bracket Assembly with Spacer, and Frame Clamp. Leave finger tight.

NOTE: If vehicle is equipped with Front hitch receiver, it must be removed.

- 2.3 Align holes in back of Mounting Bracket Assembly with the two holes in the back of the differential mount plate. Using M12 x 1.25 –60MM Hex Head Bolts 1/2" Washers, 7/8" x 1" Spacer and M12 x 1.25 Locknut attach Mounting Bracket Assembly to Differential Mount Plate. Leave finger tight.
- 2.4 Slip 2" wide Square U-Bolts over the main frame rails near the back of the Mounting Bracket Assembly. Align them with the rear most slots in the Mounting Bracket Assembly. Attach with 3/8" Washer and 3/8-16 nuts. Leave finger tight.
- 2.5 With all undercarriage parts in place, securely fasten all remaining mounting hardware. Retighten all fasteners After two hours of plowing.

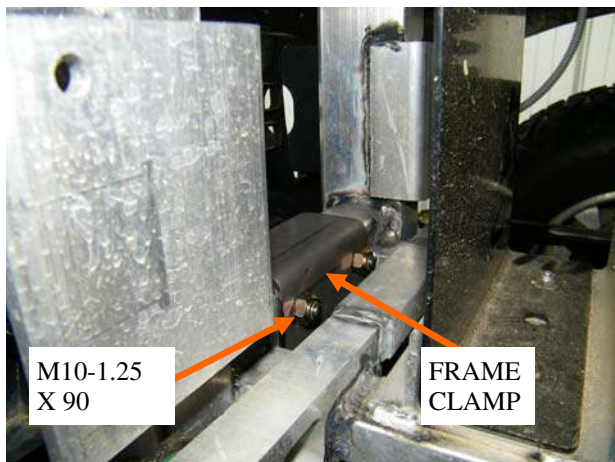

Fig 3.1

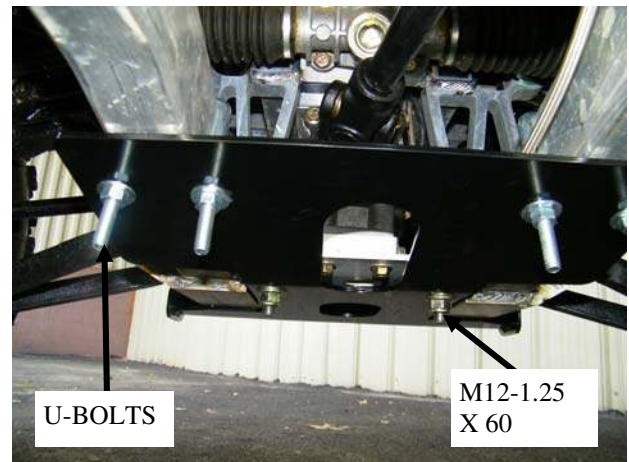

Fig 3.1



Fig 3.1

3. CONTROL SWITCH & WIRING:

- 3.1 From the front of the vehicle route the 10 ga. Black and Red ring terminal wires, the 16 ga. Black male bullet connector and the 16 ga. Brown ring terminal part of the wiring harness under the vehicle along the along the frame and back to the battery compartment.
- 3.2 Position the Solenoid near the battery and attach to vehicle frame and drill a 9/32" hole. Slide the 10 ga. Black ground wire ring terminal from the battery wire harness and the main wire harness over the 1/4-20x1" long hex head cap screw and fasten Solenoid and wires to chassis with 1/4-20x1" long hex head cap screw noted above and 1/4-20 hex nut.
- IMPORTANT NOTE:** The 10 ga. black ground wire must have good electrical contact with the vehicle chassis.
- 3.3 Route the Red 10 ga wire from the Main wire harness to the post on the solenoid as shown in Fig 3.1. Then attach the Red 10 ga. wire from the rear battery wiring harness to the opposite post on the solenoid.
- 3.4 Attach the ring terminal end of the 16 ga. Brown wire onto the smaller stud at the base of the solenoid and tighten with nut supplied.
- 3.5 Route the male bullet terminal end of the 16 ga. black wire to the vehicle wiring harness (This should be a key controlled connection)
- 3.6 From there, route the 9 pin Controller plug just under the dash on the driver's side and cable tie to cross tube under the dash for easy access (NOTE: make sure wires do not interfere with operation of pedals).
- 3.7 Route the 7 pin connector of the wiring harnesses up front and to the passenger's side of the vehicle. Routing it down behind the grill and exiting below it on the passenger's side securing it to the front brush guard with (2)1-1/2" p clamps to the bracket on the 7 pin connector with #10 screws and nuts provided in wire harness kit. Then coat inside of the 7 pin connector pins with dielectric grease.
- 3.8 Check the routing of both the front and rear wiring harnesses to be sure they are away from heat sources and moving parts. Secure harnesses in place using cable ties. Close the vehicle hood.
- 3.9 Plug the controller into the 9 pin connector under the dash. Keep the switch turned to the off position until you are ready to use the plow. Turn the controller on with switch on top of unit before use.

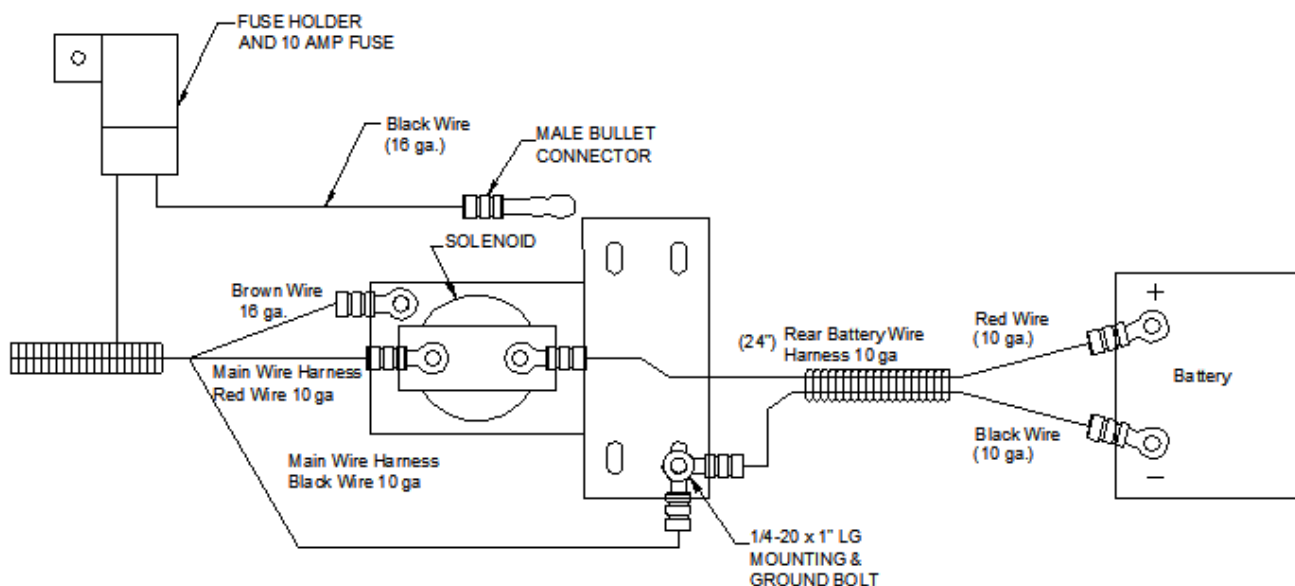
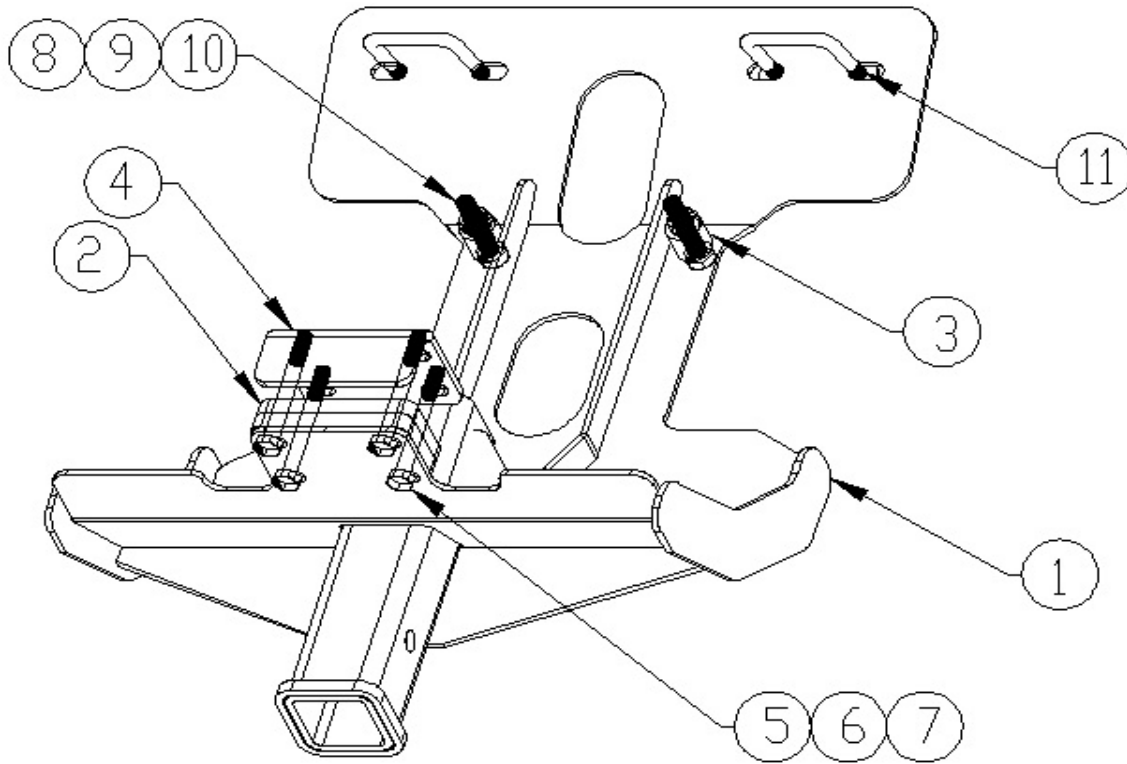

Fig 3.1

Club Car Mount Kit



ITEM #	Part #	PART NAME	QUANTITY
1	WA-UTVCCMK	WELDMENT UNIVERSAL PLOW CLUB CAR MOUNT KIT	1
2	SM-UTVCCMS	MOUNT SPACER	2
3	T-UTVCCRS	REAR SPACER	2
4	SM-UTVCFC	FRAME CLAMP	1
	UTVCCMK-HWK	HARDWARE KIT UTV STD CLUB CAR	1
5	70-00-0105	M10X1.25 X 100LG HEX HEAD CAP SCREW 8.8 ZB	4
6	72-01-0040	M10X1.25 HEX LOCKNUT ZB	4
7	71-01-0020	7/16 FLATWASHER SAE	4
8	70-00-0166	M12X1.25 X 60LG HEX HEAD CAP SCREW 8.8 ZB	2
9	72-01-0041	M12X1.25 HEX LOCKNUT ZB	2
10	71-01-0029	1/2 FLATWASHER SAE	2
11	79-74-0023	2" Wide Square U-Bolt 4 5/8 long 3/8-16 thread zinc clear	2