

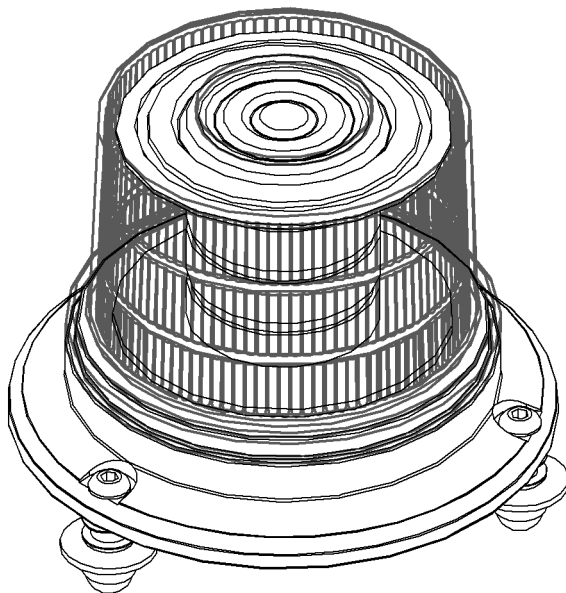

**CLUB CAR CARRYALL  
BEACON LIGHT KIT  
p/n:47587418001**



Requires:

Carryall 4x2 models 300, 500 550 and 700:  
Overhead Console Kit (47587420001)

Carryall 4x4 models 1500, XRT 1550, 1700 and XRT 1550 SE:  
Overhead Console Kit (47617522001)

Approximate Installation Time *
Experienced Dealer Technician – 30 Minutes
Average Dealer Technician – 45 Minutes
Do-It-Yourself – 1 hour

Approximate Product Specifications

(\*=Not including accessories)

The contents of this envelope are the property of the owner. Leave with the owner when installation is complete.

## WARNINGS, TIPS, & REQUIRED TOOLS

*For accurate installation, proper operation, and years of satisfaction, please read and understand the installation and owner's manual fully prior to installing the beacon light.*

*From all of us at Curtis, we thank you for choosing our product.*



### NOTICE

**Curtis Cabs, blades and general accessories add additional weight to the base vehicle. All Curtis accessory weights are listed in product brochures. Deduct the accessory's total weight from the vehicle's rated capacity and never exceed the vehicle's rated capacity including driver and passenger.**



**WARNING** *Exposure to Carbon Monoxide can Cause illness, serious injury or death. Never operate vehicle if suspicious of Carbon Monoxide. Inspect exhaust system for leaks monthly. Leaks can result from loose connections, corrosion, cracks or other damage to the exhaust manifold. If leaks are found, repair or replace exhaust system. Do not use vehicle until repair or replacement is complete.*

### TOOLS REQUIRED:

- 5/32" and 3/16" Allen wrench or driver
- 7/16" open-end wrench or socket
- Silicone sealant
- Wire cutters (for wire ties)
- Electrical tape
- 3/8" and 7/16" drill bits

# INSTALLATION

## CARRYALL 4x2:

### 1. Vehicle Preparation:

- 1.1 Remove the plastic roof from the metal roof pan by removing the 6 button head bolts, metal fender washers and rubber fender washers, keep this hardware for reuse. See figure 1.1.

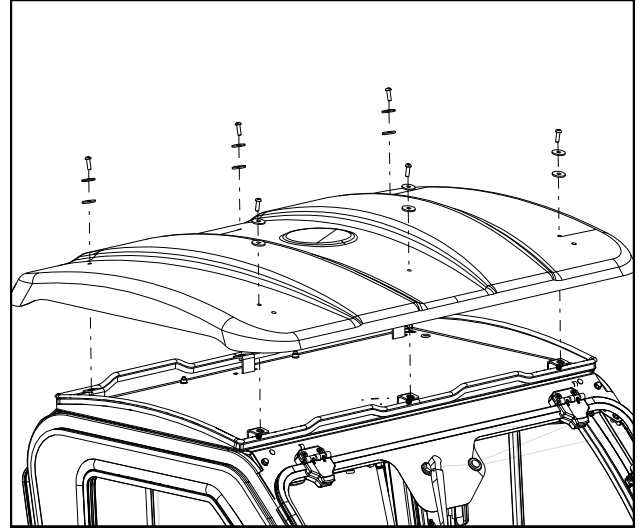

Fig. 1.1

### 2. Beacon Light Installation:

- 2.1 Use the template included with the Beacon Light to locate and drill 4 holes through the raised platform in the center of the plastic roof. As shown in figure 2.1.
- 2.2 Insert the thicker rubber grommets (AC1033) into the holes drilled into the plastic roof. This will create a weather seal. Silicone sealant is recommended for holes drilled through the roof.
- NOTE: The thinner grommets included with this kit are intended for metal roofs and may be discarded.
- 2.3 In the Overhead Console, cut the wire ties securing the coiled yellow/black wires. Be careful not to cut any of the wires. Feed the wires up through the center-left hole in the inner roof above the console.

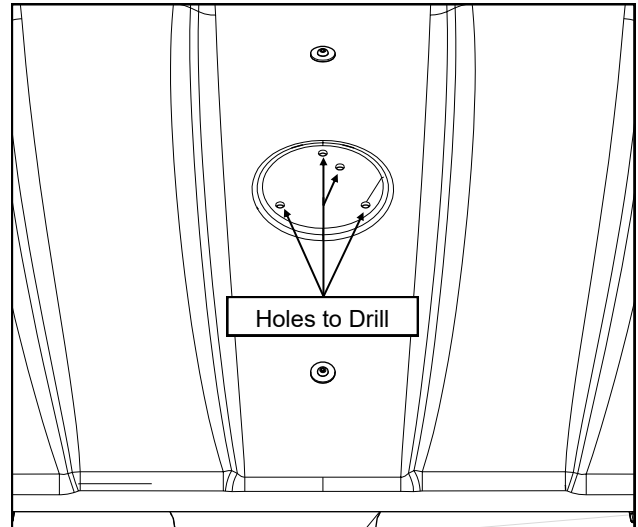

Fig. 2.1

- NOTE: If overhead console is already installed, lower console before proceeding.
- 2.4 Feed the wire from the beacon light into the central of the four holes and secure the light to the roof by feeding 1/4-20 x 1" button head bolts through the light then the rubber grommets in the plastic roof and 1/4" x 1" steel washer and secure using 1/4-20 nylon locknut. Torque bolts to 35±5 in-lbs. See figure 2.4.
- 2.5 Add silicone sealant to wire notch in base of strobe light for maximum weather protection.
- 2.6 Connect the yellow/black wires to the beacon light.
- 2.7 If finished installing accessories, reinstall roof and overhead console at this time. On the roof bolts, use Loctite Threadlocker Blue 242 and tighten until rubber washers begin to compress.

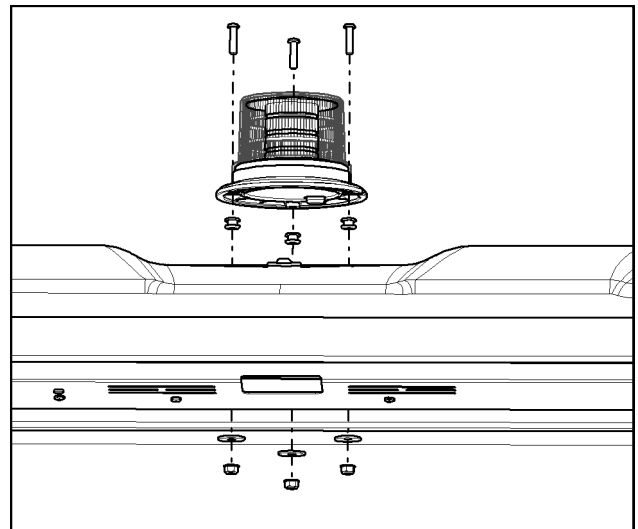

Fig 2.4

# INSTALLATION

## CARRYALL 4x4:

### 1. Beacon Light Installation:

1.1 Use the template included with the Beacon Light to locate and drill 4 holes with the template centered side-to-side, front-to-back as listed below and oriented as shown.

1.1a 2-passenger: 21" from roof front edge.

1.1b 4-Passenger: 7" from front roof rear edge.

NOTE: Starting with smaller pilot holes is recommended to avoid damage to headliner material.

1.2 Insert thinner rubber grommets into the holes drilled into the metal roof. This will create a weather seal. Silicone sealant is recommended for holes drilled through the roof.

NOTE: The thicker grommets included with this kit are intended for plastic roofs and may be discarded.

1.3 Feed the wire from the beacon light into the central of the four holes and secure the light to the roof by feeding 1/4-20 x 1" button head bolts through the light then the rubber grommets in the roof and 1/4" x 1" steel washer and secure using 1/4-20 nylon locknut. See figure 1.3.

1.4 Torque bolts to 35±5 in-lbs. and cap with the plastic nut covers provided.

1.5 Add silicone sealant to wire notch in base of strobe light for maximum weather protection.

### 2. Beacon Light Wiring:

2.1 In the Overhead Console, cut the wire ties securing the coiled yellow/black wires. Be careful not to cut any of the wires.

NOTE: If overhead console is already installed, lower console before proceeding.

2.2 Route the yellow/black wires above the ROPS bar and connect the wires to the beacon light. Cover the beacon light terminals with the section of 1/2" wire loom provided and secure with electrical tape.

2.2 If finished installing accessories, ensure the beacon light wires are routed through the notch in the upper center of the console and install the console to the cab.

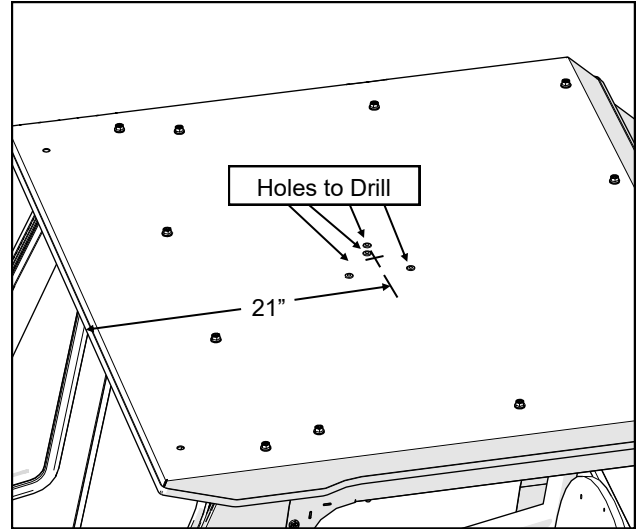

Fig. 1.1a

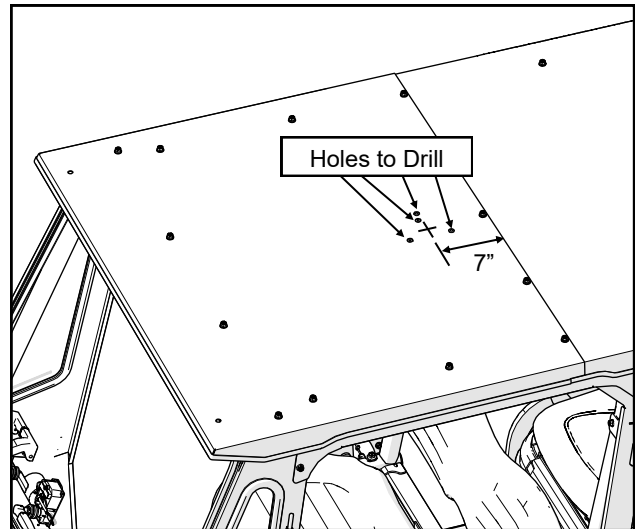

Fig. 1.1b

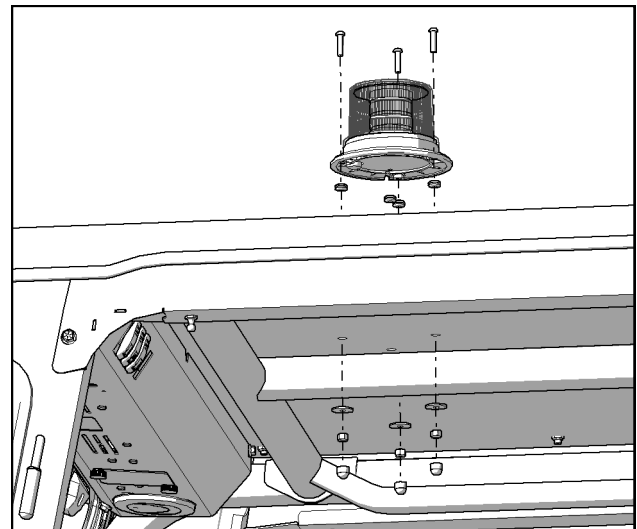
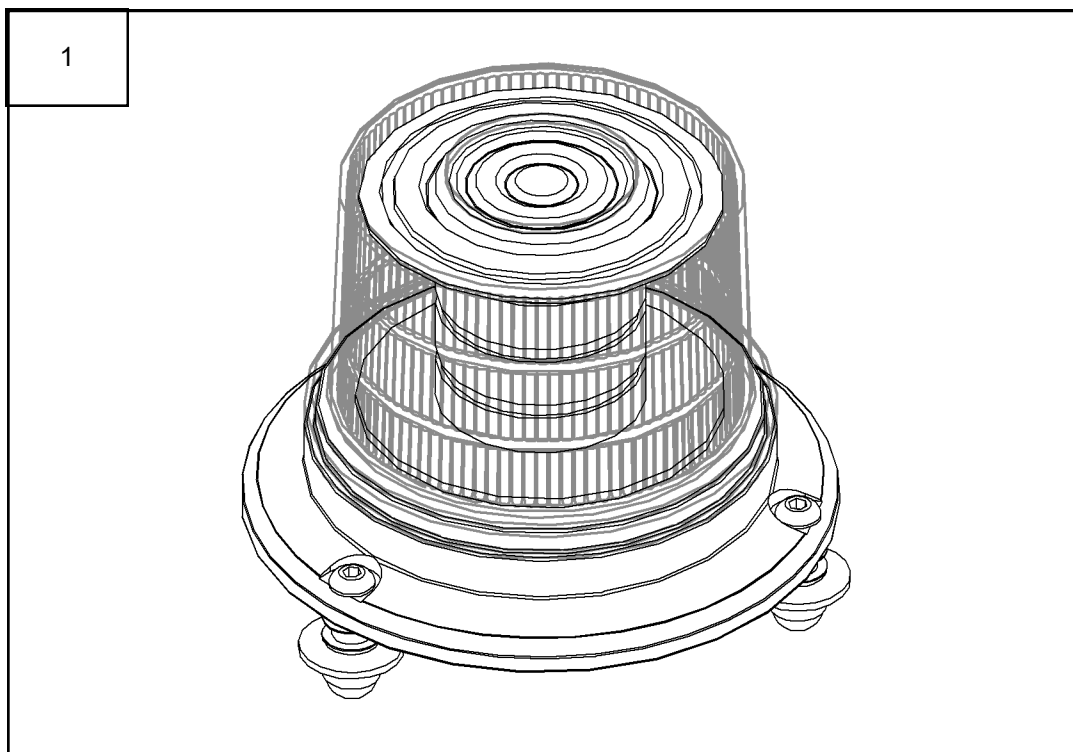

Fig 1.3

# SERVICE PARTS

#	PART NUMBER.	DESCRIPTION	QTY.
1	9LEDS-A	BEACON LIGHT LED (AMBER)	1
NS	HWK-00043	HARDWARE KIT, BEACON LIGHT	1

\* NS=Not Shown



## BEACON LIGHT DRILL TEMPLATE

A: Three  $\frac{7}{16}$ " diameter beacon light mounting holes. Drill at all three marks labeled "A".

B: One  $\frac{3}{8}$ " diameter hole for beacon light wire. Choose one best fit location for the wire and drill one hole there (at only one of the options marked "B").

Print or copy at 100% scale (full, 1:1, actual size). Verify the  $2\frac{15}{16}$ " dim. and/or the  $5\frac{3}{32}$ " dim. to ensure that the template has printed out full scale before using it to drill holes.

