

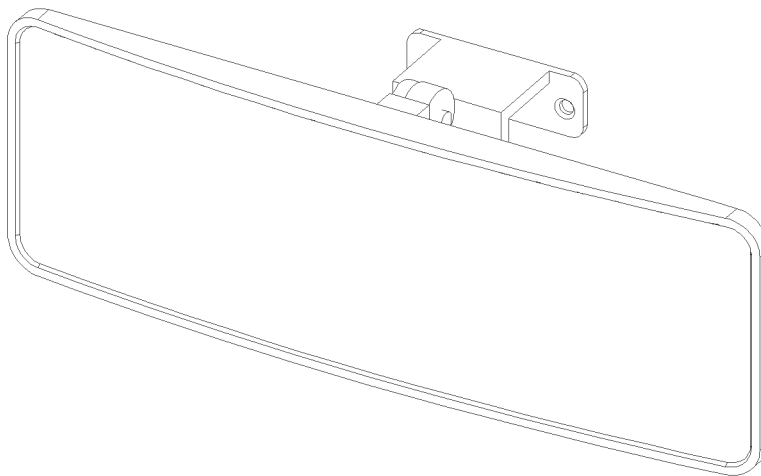

**CLUB CAR CARRYALL
 INTERIOR REAR VIEW MIRROR
 p/n: 47587416001**



Approximate Installation Time *
Experienced Dealer Technician – 15 Minutes
Average Dealer Technician – 30 Minutes
Do-It-Yourself – 30 Minutes

Approximate Product Specifications

(*=Not including accessories)

The contents of this envelope are the property of the owner. Leave with the owner when installation is complete.

WARNINGS, TIPS, & REQUIRED TOOLS

For accurate installation, proper operation, and years of satisfaction, please read and understand the installation and owner's manual fully prior to installing the mirror.

From all of us at Curtis, we thank you for choosing our product.



NOTICE

Curtis Cabs, blades and general accessories add additional weight to the base vehicle. All Curtis accessory weights are listed in product brochures. Deduct the accessory's total weight from the vehicle's rated capacity and never exceed the vehicle's rated capacity including driver and passenger.



WARNING *Exposure to Carbon Monoxide can Cause illness, serious injury or death. Never operate vehicle if suspicious of Carbon Monoxide. Inspect exhaust system for leaks monthly. Leaks can result from loose connections, corrosion, cracks or other damage to the exhaust manifold. If leaks are found, repair or replace exhaust system. Do not use vehicle until repair or replacement is complete.*

TOOLS REQUIRED:

- 5/16" and 3/8" open-ended wrench

INSTALLATION

1. Vehicle Preparation:

NOTE: If overhead console (47587420001 or 47617522001) is installed, it must be removed before installation of interior mirror.

- 1.1 To remove overhead console, remove the 1/4-20 hex head bolts located in the corners of the console. See figure 1.1.
- 1.2 Let console hang down on attached tethers.

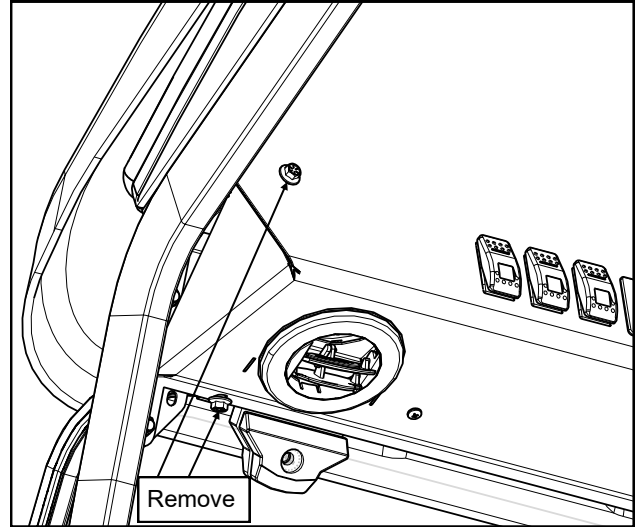

Fig. 1.1

2. Mirror Installation:

- 2.1 Locate mirror mounting holes in the center of the windshield mount.
- 2.2 Take mounting bracket and attach to windshield support through mounting holes using #10-32 x 1/2" hex head bolts, #10 x 1/2" washer, and #10-32 lock nuts. See figure 2.2. Torque to 30 inch-lbs.

NOTE: Reattach the overhead console at this time, it will not be able to be reinstalled once the mirror is attached. Torque 1/4-20 overhead console bolts to 120 inch-lbs.

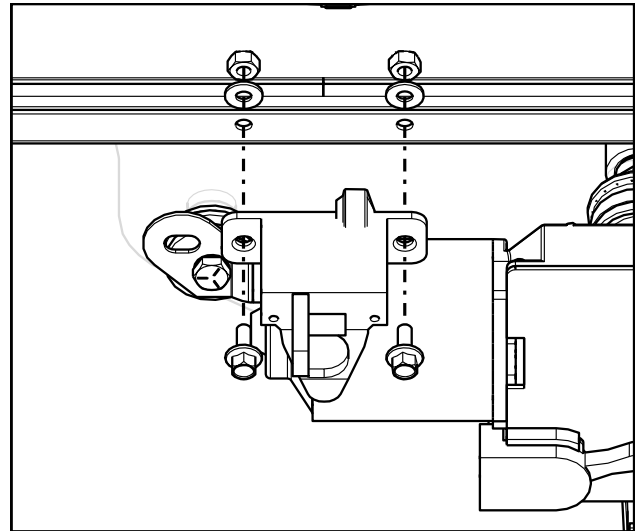

Fig. 2.2

- 2.3 On mirror head, loosen the set screw on the top of the mirror and rotate the mounting head on the mirror 90° clockwise so that the open end is pointed towards the left side of the mirror.
- 2.4 Attach the mirror head to the mounting bracket by removing the knurled knob, placing the mirror head onto the threaded stud of the mounting bracket, then placing the knurled knob to hold the mirror in place. Adjust the viewing angle as much as possible before finger tightening the knob. See figure 2.4.

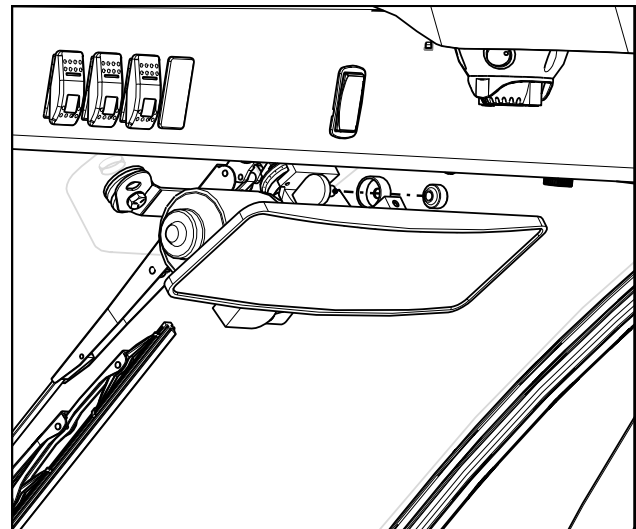

Fig. 2.4