

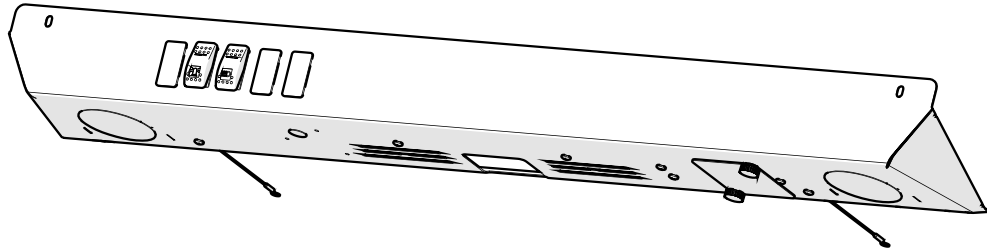

CLUB CAR CARRYALL ROPS CAB OVERHEAD CONSOLE (w/o Fans) p/n: 47587420002



Approximate Installation Time *

| |
|--|
| Experienced Dealer Technician – 30 Minutes |
| Average Dealer Technician – 45 Minutes |
| Do-It-Yourself – 1 Hour |

(* = Not including other accessories)

Approximate Product Specifications

Weight: 9.17 lbs. (4.16 kg)

The contents of this envelope are the property of the owner. Leave with the owner when installation is complete.

Rev. B, 11/24/2020

p/n: IM-47587420002

WARNINGS, TIPS, & REQUIRED TOOLS

For accurate installation, proper operation, and years of satisfaction, please read and understand the installation and owner's manual fully prior to installing the console.

From all of us at Curtis, we thank you for choosing our product.



NOTICE

Curtis Cabs, blades and general accessories add additional weight to the base vehicle. All Curtis accessory weights are listed in product brochures. Deduct the accessory's total weight from the vehicle's rated capacity and never exceed the vehicle's rated capacity including driver and passenger.



WARNING

Exposure to Carbon Monoxide can Cause illness, serious injury or death. Never operate vehicle if suspicious of Carbon Monoxide. Inspect exhaust system for leaks monthly. Leaks can result from loose connections, corrosion, cracks or other damage to the exhaust manifold. If leaks are found, repair or replace exhaust system. Do not use vehicle until repair or replacement is complete.

TOOLS REQUIRED:

- #1 (small) Phillips screwdriver
- 3/8", 7/16", 1/2" open-end wrenches or sockets
- 5/32" and 3/16" Allen wrenches or drivers

INSTALLATION

1. Vehicle Preparation:

- 1.1 Installation of a Dome Light, Strobe Light, or Rear Work Lights requires the removal of the plastic roof. If installing any of these accessories, remove the plastic roof as outlined in the accessory instructions.

Note: If 7.5-amp fuse was installed in vehicle when installing wiper, switch back to 15-amp fuse.

2. Dome Light and/or Strobe Light pre-wiring:

(skip to step 3 if not installing either of these)

- 2.1 Poke up through the headliner with a screwdriver or awl at each of the 2 smaller holes in the windshield support.

Note: Poke the holes from the headliner side up through the hole in the roof to avoid having the headliner pull away from its glued surface.

- 2.2 Install the end of each Tether from the Console into the Windshield Support and allow the Console to hang. See figure 2.2.

Note: If an interior mirror is installed, remove the mirror from the mounting bracket.

- 2.3 Cut the cable tie from each of the two coiled wires inside the console. Be careful to not cut any wires. Feed each wire through the hole in the roof directly above the wire. See figure 2.3.

Note: Leave the corresponding wires coiled if not installing a strobe light or dome light.

- Orange/ black for Dome Light through center right.
- Yellow/black for Strobe Light through center left.

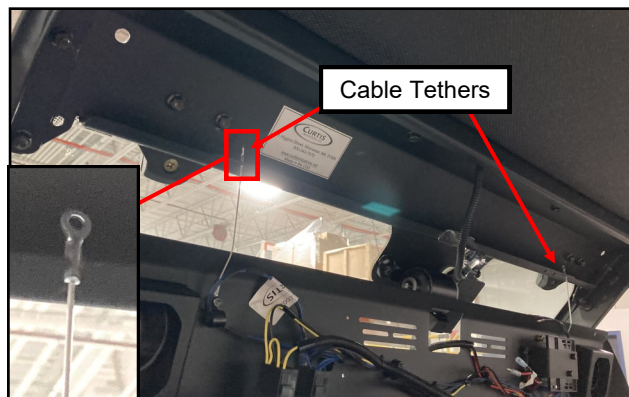

Fig. 2.2

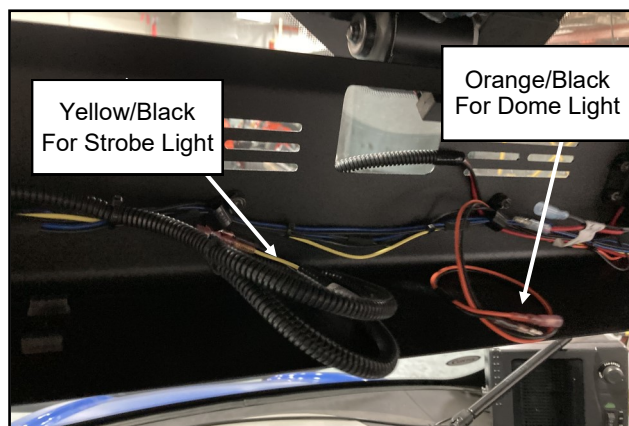

Fig. 2.3

INSTALLATION

3. Console Wiring:

- 3.1 Unplug the cab power wire from the wiper motor. Connect the cab power wire to the short harness (without wire loom) inside console from the fuse block. See figure 3.1.

Note: the wire connections from the console fuse block are polarized to help prevent connecting to the wrong harness.

- 3.2 Make sure the other wire (with wire loom) is routed through the large hole in the center of the console and connect that to the wiper motor.
- 3.2 Install and connect all accessories at this time.

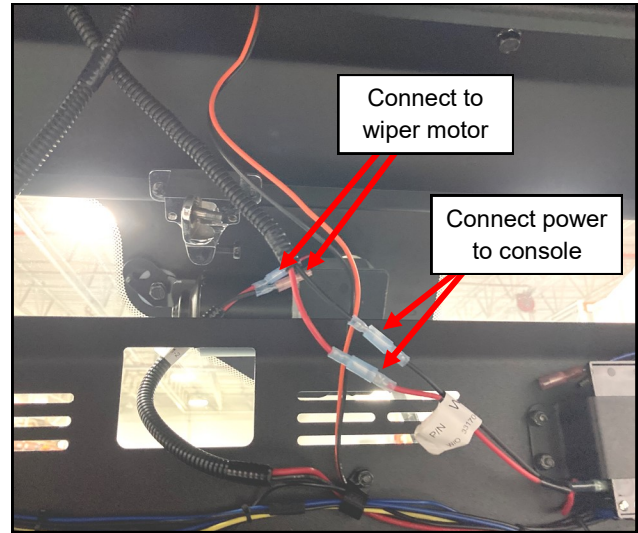

Fig. 3.1

4. Install Console Panel:

- 4.1 Install a 1/4-20 clip nut (4 total) into the slots and holes at the corner of each flange of the windshield support, with the flat side of the nut on the outside. See figure 4.1.

NOTE: Ensure that the wiper wire from the console is routed through the hole in the center of the bottom face of the console.

- 4.2 Place the console up against the windshield support and loosely thread a 1/4-20 x 5/8" bolt into the clip nuts at each corner.
- 4.3 Verify that no wires are visible or pinched between the console and windshield support, and the wiper wire is not pinched by the interior mirror mount.
- 4.4 Connect the wiper wire from the console to the wiper motor.
- 4.5 Turn the ignition switch on. Verify the function of each switch and accessory, then turn the ignition off.
- 4.6 Tighten the 1/4-20 bolts for the console to 120±5 inch-pounds.
- 4.7 If you removed the plastic roof to install a Dome Light, Strobe Light, or Rear Work Lights, re-install the plastic roof per the instructions included with those kits.

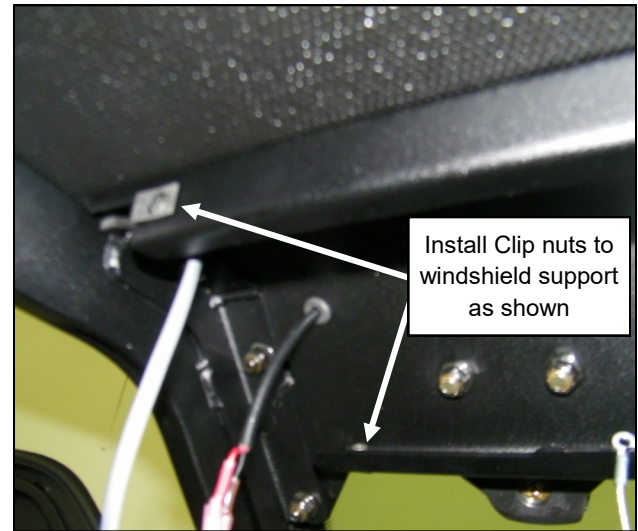

Fig. 4.1

INSTALLATION

5. Changing Fuse (For Gasoline Vehicles Only):

NOTE: If you have the electric vehicle, skip this section and proceed to step 6.

- 5.1 Lift bed or remove seat in order to access electronic component box.
- 5.2 Remove the screw that secures the cover to the electronic component box in the compartment under the driver's seat as shown. Retain the screw and cover for reinstallation. (Figure 5.2).
- 5.3 Replace the 10-amp fuse (or 7.5 if cab is installed) with supplied 15-amp ATO/ATC fuse. (Figure 5.3) Reattach the cover onto the electronic component box. Tighten screw to 17 in-lbs (1.9 Nm).

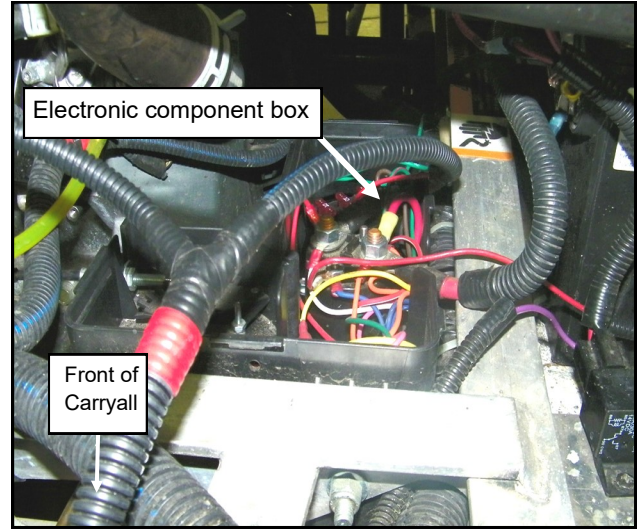

Figure 5.2

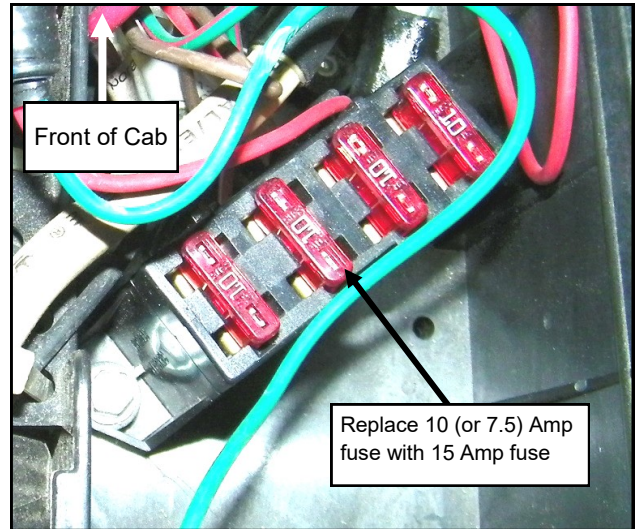

Fig. 5.3

6. Changing Fuse (For Electric Vehicles with cab wiper previously installed):

NOTE: If you have the gasoline vehicle or have not installed the 7.5-amp fuse for the cab wiper, disregard this section.

- 6.1 Locate the fuse block under the front hood. Remove 7.5-amp fuse installed for cab with 15-amp fuse supplied with this kit or removed in Cab installation. (Figure 6.1)

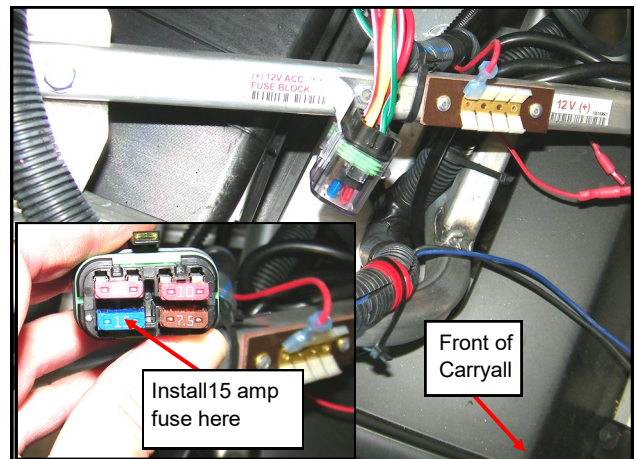
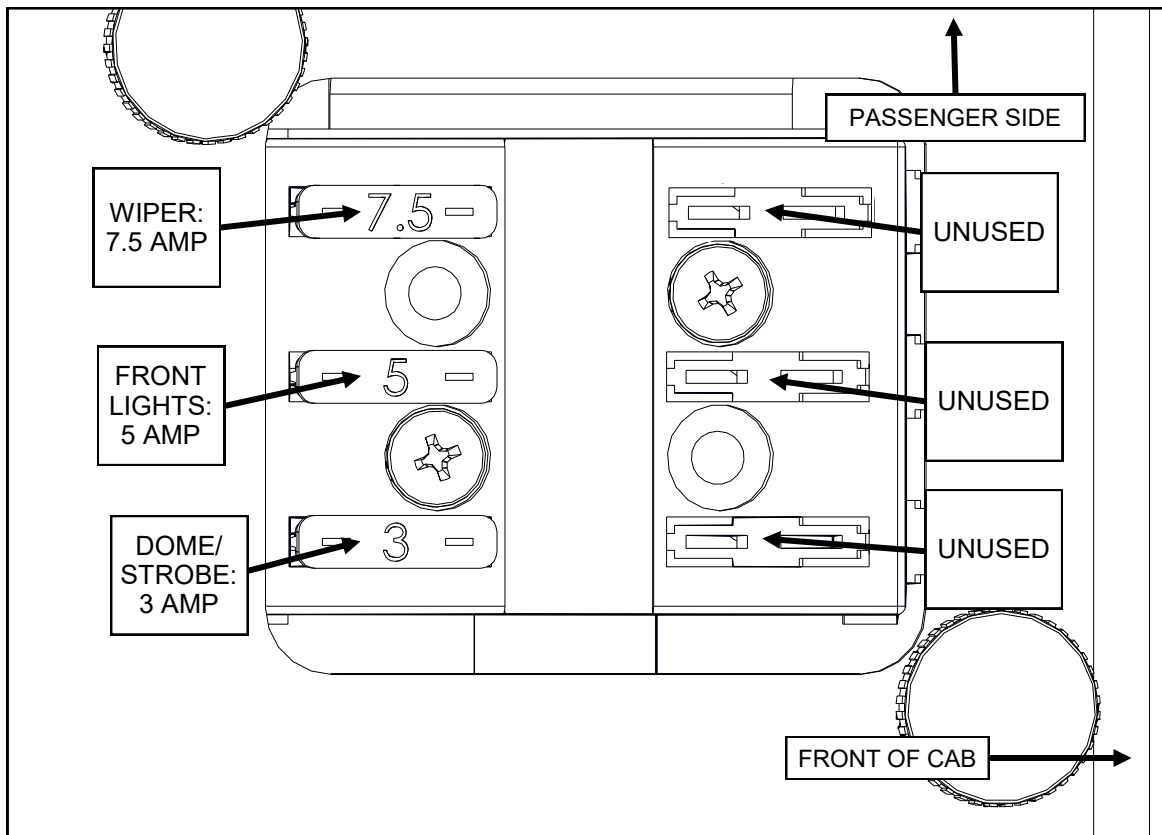

Fig. 6.1

OVERHEAD CONSOLE TROUBLESHOOTING

| Condition | Possible Solution |
|--|---|
| <ul style="list-style-type: none"> All console lights are off | <ul style="list-style-type: none"> Vehicle Ignition Key is off Check 15 Amp fuse |
| <ul style="list-style-type: none"> One switch light is off | <ul style="list-style-type: none"> Check fuse for that device (see below) Switch is not connected to fuse block |
| <ul style="list-style-type: none"> Switch light is on, device does not function | <ul style="list-style-type: none"> Device is not connected to console Connection polarity is reversed Check device to 12V power source |
| <ul style="list-style-type: none"> Console will not turn off | <ul style="list-style-type: none"> Check cab wiring Relay harness is not installed |



SERVICE PARTS

| # | PART NUMBER. | DESCRIPTION | QTY. |
|---|--------------|--|------|
| 1 | 8SV-FP01-B4 | FUSE BLOCK, 6-POSITION WITH MOUNTING BRACKET | 1 |
| 2 | 8SV-OHCFC-B4 | FUSE COVER | 1 |
| 3 | 9SV-OHCSCC | SWITCH SET, (SET OF 3 SWITCHES WITH COVERS) | 1 |
| 4 | 9SV-WHOHC1 | WIRE HARNESS, FUSE BLOCK | 1 |
| 5 | 9SV-WHOHC2 | WIRE HARNESS, WIPER | 1 |
| 6 | 9SV-WH-00030 | WIRE HARNESS, BEACON LIGHT AND DOME LIGHT | 1 |
| 7 | 9SV-WH-00031 | WIRE HARNESS, WORK LIGHTS | 1 |

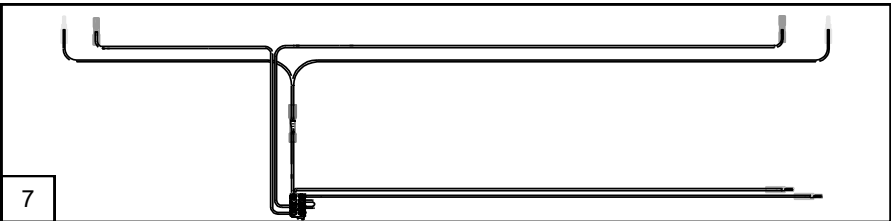
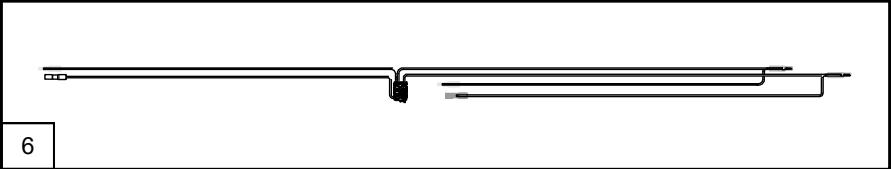
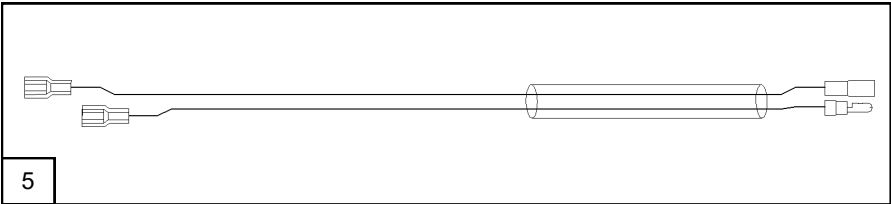
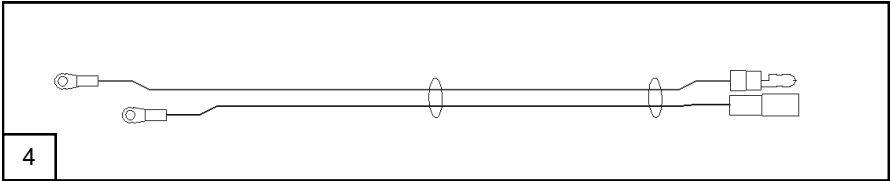
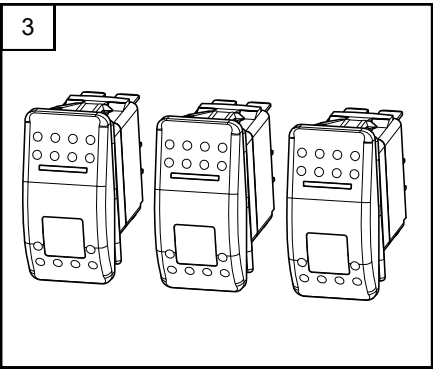
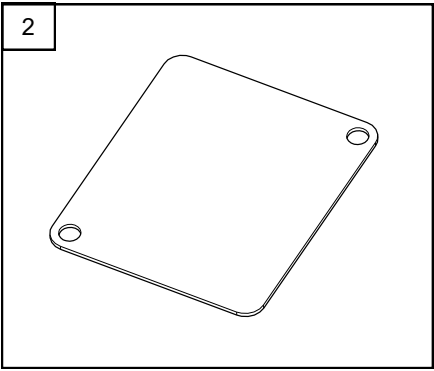
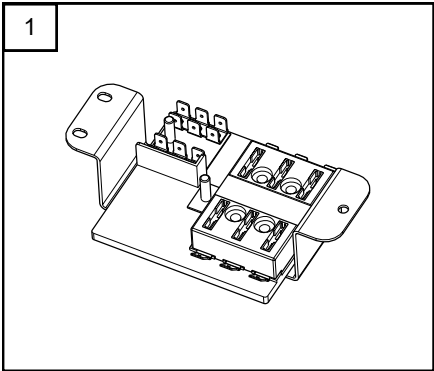

Tightening of Non-Structural Bolts

For light or medium duty fastening, Curtis recommends using a general industry standard of tightening until snug and then giving an additional one quarter turn of the tool as deemed reasonable for the application (i.e.: at the installer's discretion).

If torque values are required, the examples listed below are intended as a reasonable reference for use in the majority of non-structural fastener applications such as: small diameter fasteners; bolts passing thru tubing, glass, plastic, nylon or rubber washers, threaded inserts, etc.

If more than one application below applies, use the lower torque value.

| FASTENER SIZE: | FASTENER TYPE: | WASHER MATERIAL: | APPLICATION: | TORQUE (INCH-POUNDS) (±5) |
|-------------------|-------------------|---------------------|---------------------------------------|---------------------------------|
| #10 | Machine Screws | - | in Nylon P-Clamps | 20 |
| #10 | Machine Screws | - | Strobe Light (plastic base) | 35 |
| M5 | Set Screws | - | Wiper Arm | 20 |
| 1/4" | Cap Nut | - | Windshield Wiper | 20 |
| 1/4" | Bolts | - | Tubing (5/8" to 3/4" wide) | 132 |
| 1/4" | Bolts | Rubber | - | 60 |
| 1/4" | Bolts | Nylon / Plastic | - | 72 |
| 1/4" | Bolts | - | Factory Installed Threaded Inserts | 132 |
| 5/16" | Bolts | - | Tubing (1" or wider) | 60 |
| 5/16" | Flat Head Bolts | - | Plastic Windshield Hinge | 79 |
| 5/16" | Bolts | Rubber | - | 120 |
| 5/16" | Bolts | Nylon / Plastic | - | 150 |
| 5/16" | Ball Studs | - | - | 150 |
| 5/16" | Bolts | - | Factory Installed Threaded Inserts | 240 |
| 3/8" | Bolts | - | Tubing | 120 |
| M12 | Door Striker Pins | - | - | 120 |