



INSTALLATION MANUAL DROP-ON CAB (BX4090A, BX4090CA) KUBOTA BX-80 SERIES TLB (BX23S)

CALIFORNIA PROPOSITION 65



Cancer and reproductive harm - www.P65Warnings.ca.gov

BEFORE INSTALLING CAB

- Read all instructions and safety instructions in this manual.
- Refer to your machine's operator's manual and safety instructions on your machine's safety decals.
- Wear appropriate personal protective equipment (PPE) when performing work.
- Hang a **"DO NOT OPERATE"** tag in operator station.
- Rear ballast on the tractor is required while this cab is in use. Install one set of rear wheel weights OR liquid ballast per the tractor operator manual.



WARNING

To avoid personal injury or death:

- Cabs, blades, and general accessories add additional weight to the base vehicle. Deduct the accessory's total weight from the vehicle's rated capacity including passenger and driver. Never operate the vehicle outside of its rated weight capacity.
- Exposure to carbon Monoxide can cause illness, serious injury, or death. Never operate vehicle if suspicious of Carbon Monoxide. Inspect exhaust system for leaks monthly. Leaks can result from loose connections, corrosion, cracks, or other damage to the exhaust manifold. If leaks are found, repair or replace exhaust system. Do not use vehicle until repair or replacement is complete.
- Prolonged exposure to loud noise can cause impairment or loss of hearing. Wear a suitable hearing protective device such as earmuffs or earplugs to protect against objectionable or uncomfortable noises.

Estimated assembly time: 4 hours

■ AVAILABLE REPLACEMENT PARTS

Ref. No.	Part No.	Part Name	QTY	REMARKS
1	77700-12006	WINDSHIELD ASSEMBLY, WITH WIPER	1	Code No.: 8SV-102-00029
2	70000-01040	HINGE ASSY, STD WINDSHIELD KIT	1	Code No.: 9PH007
3	77700-08560	LATCH, POP-OUT, SINGLE ARM, 3IN OPENING	1	Code No.: 9WL06
4	70000-01252	3/4" SIDE BULB, 1/4" GRIP WITH 2 WIPERS	169"	Code No.: 9PR38
5	70000-01056	WIPER MOTOR, 85 DEGREE	1	Code No.: 9PWM852
6	70000-01054	WIPER ARM, ADJUSTABLE LENGTH (11" - 16")	1	Code No.: 9PWA14-16
7	70000-01055	WIPER BLADE, 20", FLEX	1	Code No.: 9PWB20-FB
8	77700-08630	GLASS MOUNTING KIT FOR WIPER SYSTEMS, O.E.M.	1	Code No.: 9PWK-HBOEM
9	70000-01015	WINDSHIELD HINGE BLOCK SPACER, TALL STYLE, 3/4" THICK	1	Code No.: 9BLK01
10	77700-08538	SEAT TRAVEL LIMITING PLATE	1	Code No.: SM-00447
11	77700-05446	5/16" EYEBOLT	2	Code No.: 79-00-0000
12	77700-08567	SMV BRACKET, BX80	1	Code No.: SM-00443
13	77700-12007	HARDWARE KIT	1	Code No.: 9SV-HWK-00137
N.S.	70000-01216	KEYS, CAB DOOR	2	Code No.: 9DL01H
N.S.	77700-05439	WIRE HARNESS, RELAY, KF2	1	Code No.: KF2-RWH
N.S.	77700-12011	INSTALLATION INSTRUCTIONS, KBX80 TLB	1	Code No.: 9SV-IM-BX4090A

N.S. = Not Shown

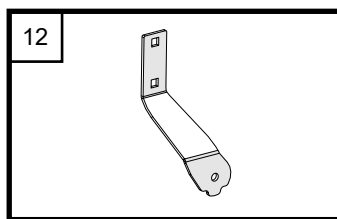
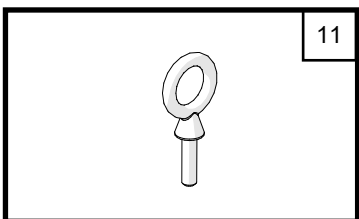
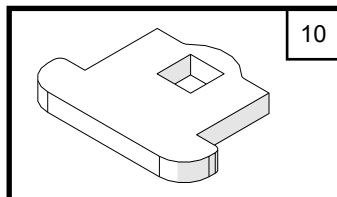
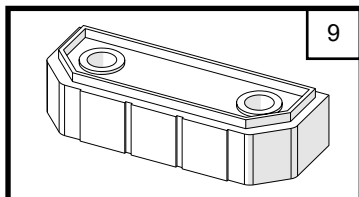
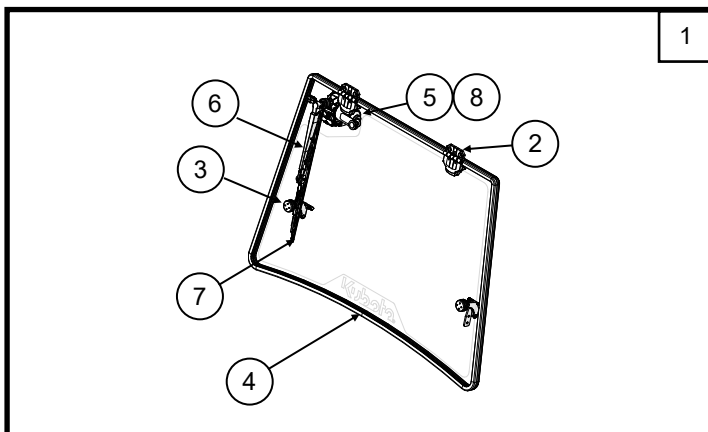

HARDWARE KIT		13
	2X—SCREW, HEX FLANGE, M10X1.25 X 25LG	
	4X—SCREW, HEX FLANGE, 3/8-16 X 2-1/4LG	
	4X—SCREW, HEX FLANGE, 3/8-16 X 3/4LG	
	15X—SCREW, BUTTON HEAD FLANGE, 5/16-18 X 3/4LG	
	5X—SCREW, BUTTON HEAD FLANGE, 1/4-20 X 3/4LG	
	5X—SCREW, PAN HEAD, #10-32 X 5/8LG	
	1X—CARRIAGE BOLT, 5/16-18 X 1LG	
	1X—CARRIAGE BOLT, M8X1.25 X 40LG	
	3X—STEEL WASHER, SAE, 5/16" ID	
	4X—STEEL FENDER WASHER, 5/16" ID X 1-1/4" OD	
	2X—NYLON WASHER, #10 ID X 3/8" OD	
	5X—NUT, HEX FLANGE, NYLON INSERT, 1/4-20	
	7X—NUT, HEX FLANGE, NYLON INSERT, 5/16-18	
	5X—NUT, HEX FLANGE, NYLON INSERT, #10-32	
	8X—NUT, HEX FLANGE, NYLON INSERT, 3/8-16	
	6X—NUT, THUMB, 1/4-20	
	1X—1/2" BLACK NYLON CABLE CLAMP	

■ AVAILABLE REPLACEMENT PARTS

Ref. No.	Part No.	Part Name	QTY	REMARKS
16	77700-12005	WINDSHIELD SUPPORT ASSEMBLY	1	Code No.: 8SV-103-00023
17	77700-08559	DOME PLUG, 3/8"	1	Code No.: 9DP10
18	77700-05150	HOLE PLUG, .75" X 1/8" GRIP	1	Code No.: 9DP16
19	70000-01220	RED SWITCH COVER, LIGHT SYMBOL	1	Code No.: 9PCD1-C
20	77700-05153	HOLE PLUG FOR V-SERIES BK CARLING SWITCH	1	Code No.: 9VH2-01
21	70000-01397	5/8" STD BULB, 1/16" GRIP	37"	Code No.: 9PRO2
22	77700-08541	ARCH PSA RUBBER, .20WDX.15TALL	48"	Code No.: 9PR53
23	77700-08625	5 AMP PUSH BUTTON RESET BREAKER W/ NUT	1	Code No.: 9SV-APBR
24	77700-05438	WIRE HARNESS, DUAL	1	Code No.: KF2-DWH
25	70000-01156	SWITCH, CARLING, (OFF-ON)	1	Code No.: OHC-5
26	77700-08628	WIRE HARNESS, POWER JUMPER, BX80	1	Code No.: WH-00035
27	77700-08631	FRONT WIPER HARNESS, BX80	1	Code No.: WH-00036
28	77700-05166	WORK LIGHTS, LED FLAT-5	1	Code No.: 9LEDFWL-A
29	70000-01086	3/8" RUBBER GROMMET	1	Code No.: AC1028
30	77700-08533	RADIATOR SHROUD, PLASTIC	1	Code No.: 111-00008
31	77700-08540	AUXILIARY RADIATOR INTAKE COVER	1	Code No.: 111-00009
32	77700-09080	DECAL, CAUTION, AUXILIARY RADIATOR INTAKE INFORMATION	1	Code No.: 9DL-209
33	77700-08542	RADIATOR SHROUD WINDOW, LEFT	1	Code No.: 9GL-00026
34	77700-08543	RADIATOR SHROUD WINDOW, RIGHT	1	Code No.: 9GL-00027
35	77700-08544	RADIATOR SHROUD, MOLDED PLASTIC	1	Code No.: P-00026
36	77700-01021	LATCH, LEFT	1	Code No.: 9YR-LL
		LATCH, RIGHT	1	Code No.: 9YR-LR
37	70000-01252	3/4" SIDE BULB, 1/4" GRIP WITH 2 WIPERS	169"	Code No.: 9PR38

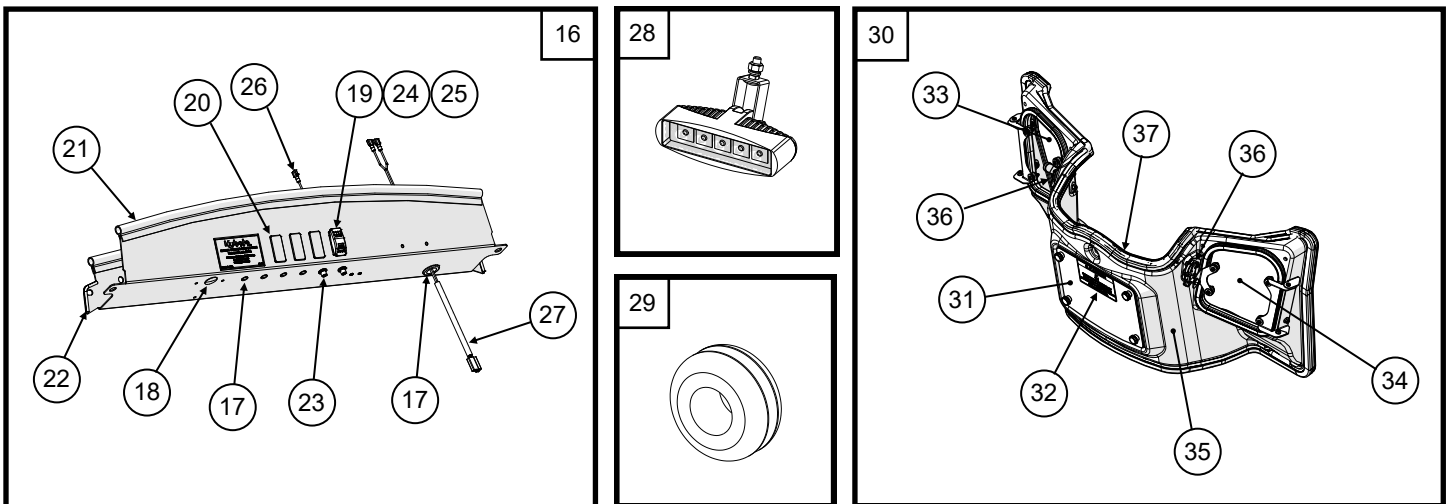

■ AVAILABLE REPLACEMENT PARTS

Ref. No.	Part No.	Part Name	QTY	REMARKS
38	77700-12010	REAR LEG ASSEMBLY, TLB, LEFT	1	Code No.: 8SV-108-00022-L
39	77700-08563	REAR LEG ASSEMBLY, TLB, RIGHT	1	Code No.: 108-00006-R
40	77700-08564	REAR LEG WINDOW, TLB	1	Code No.: 9GL-00023
41	77700-08646	FUEL FILLER SHROUD, TLB, RIGHT, MOLDED PLASTIC, BX80	1	Code No.: P-00024
42	77700-08559	DOME PLUG, 3/8", BLACK	1	Code No.: 9DP10
43	77700-08648	DOME PLUG, 1/2", BLACK	1	Code No.: 9DP11
44	70000-01050	TRIM LOK, STD, 1/16"-1/8" GRIP	220"	Code No.: 9PRO1
45	70000-01397	5/8" STD BULB, 1/16" GRIP	37"	Code No.: 9PRO2
46	77700-00279	WINDOW RUBBER, 14-16GA STEEL, .18-.28 WINDOW THICKNESS	110"	Code No.: 9PR10
47	77700-05144	1" ROUND BULB, 1/16" GRIP	72"	Code No.: 9PR19
48	77700-08541	ARCH PSA RUBBER, .20WDX.15TALL	48"	Code No.: 9PR53
49	77700-08573	RP LOWER FILLER PLATE ASSY,TLB	1	Code No.: 113-00042
50	77700-08570	ROPS BRACKET, TLB	1	Code No.: SM-00390
51	77700-08537	ANCHOR PLATE, ROPS	1	Code No.: SM-00442
52	77700-08645	STORAGE BOX SHROUD, TLB, LEFT, MOLDED PLASTIC, BX80	1	Code No.: P-00023

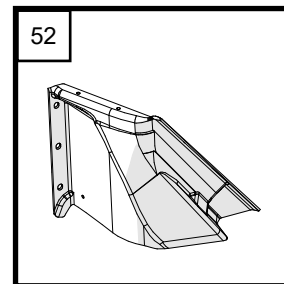
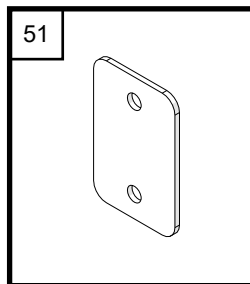
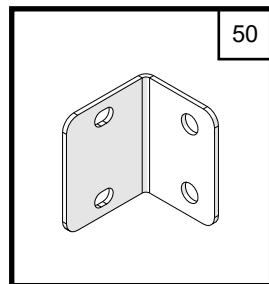
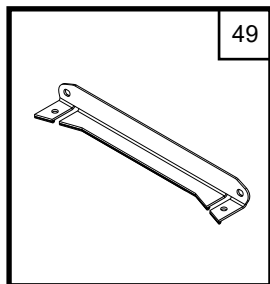
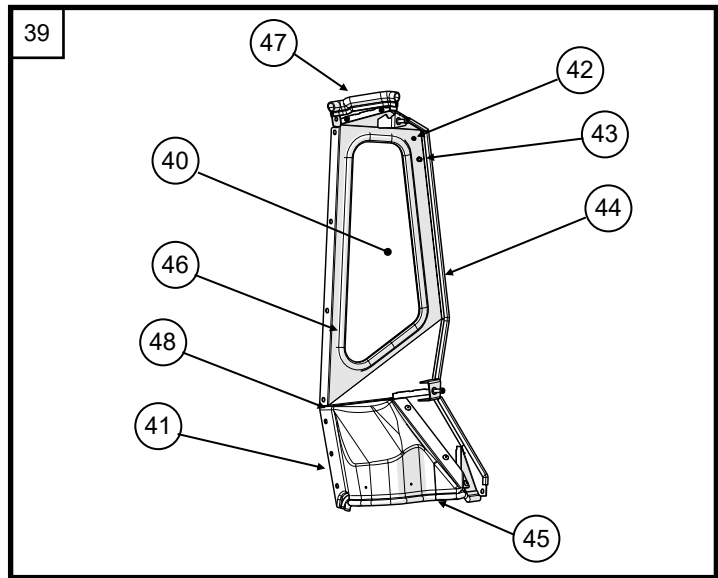
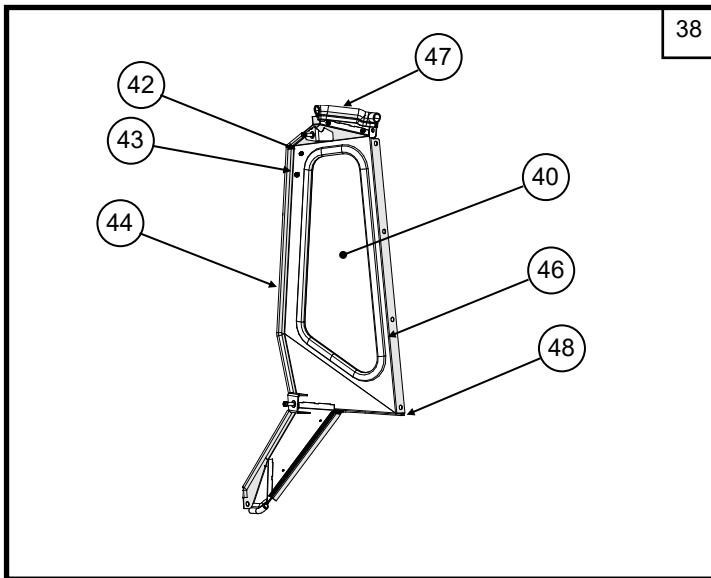

■ AVAILABLE REPLACEMENT PARTS

Ref. No.	Part No.	Part Name	QTY	REMARKS
54	77700-08561	REAR PANEL ASSEMBLY, BX80, TLB	1	Code No.: 106-00012
55	77700-08565	REAR PANEL GLASS, TLB	1	Code No.: 9GL-00024
56	77700-08566	REAR PANEL GLASS, LOWER, TLB	1	Code No.: 9GL-00025
57	70000-01021	GRAB HANDLE (PLASTIC)	1	Code No.: 9GH01
58	77700-01482	POLY INSERT 1", 14-20 GA BLK, MATTE ,INSERT FINS .94/.95	1	Code No.: 9PI01
59	77700-01483	POLY INSERT 3/4", 14-20 GA BLK, MATTE FINISH, INSERT FINS 0.69	1	Code No.: 9PI02
60	77700-01021	LATCH, LEFT	1	Code No.: 9YR-LL
		LATCH, RIGHT	1	Code No.: 9YR-LR
61	70000-01397	5/8" STD BULB, 1/16" GRIP	37"	Code No.: 9PRO2
62	77700-00279	WINDOW RUBBER, 14-16GA STEEL, .18-.28 WINDOW THICKNESS	110"	Code No.: 9PR10
63	77700-08647	5/8" O/S SIDE BULB, 1/16" GRIP (ROUND BULB)	120"	Code No.: 9PR27
64	77700-08525	ROOF ASSEMBLY	1	Code No.: 101-00009
65	77700-08535	ROOF PIVOT BRACKET, LEFT	1	Code No.: SM-00298-L
66	77700-08536	ROOF PIVOT BRACKET, RIGHT	1	Code No.: SM-00298-R
67	77700-08568	ROOF LATCH ASSEMBLY, LEFT, BX80, TLB	1	Code No.: 113-00043-L
68	77700-08569	ROOF LATCH ASSEMBLY, RIGHT, BX80, TLB	1	Code No.: 113-00043-R
69	77700-05202	GAS SPRING, 20 EXT, 12 COMP, 10 LBS, QD ENDS (FOR ROOF)	1	Code No.: 9GS10Q

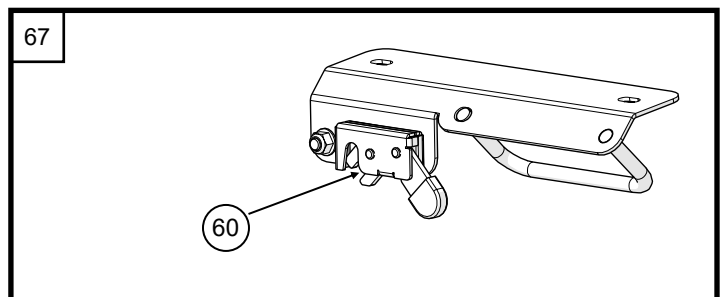
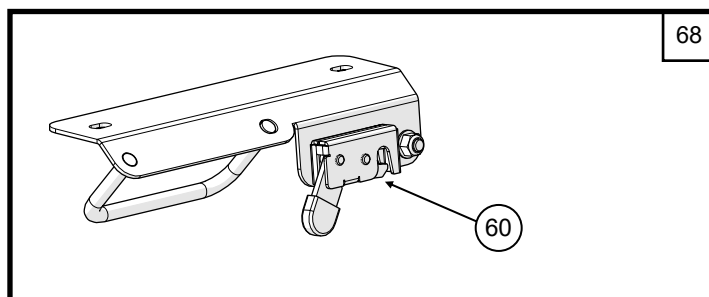
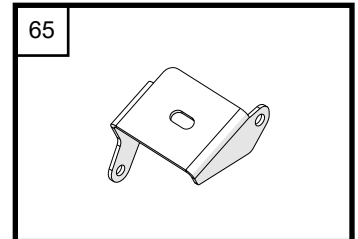
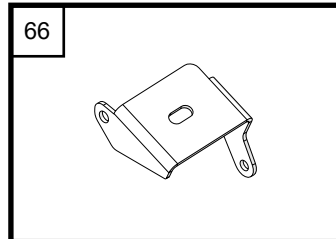
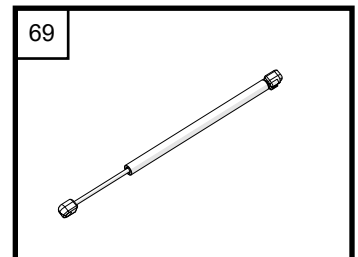
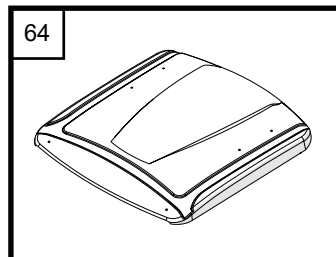
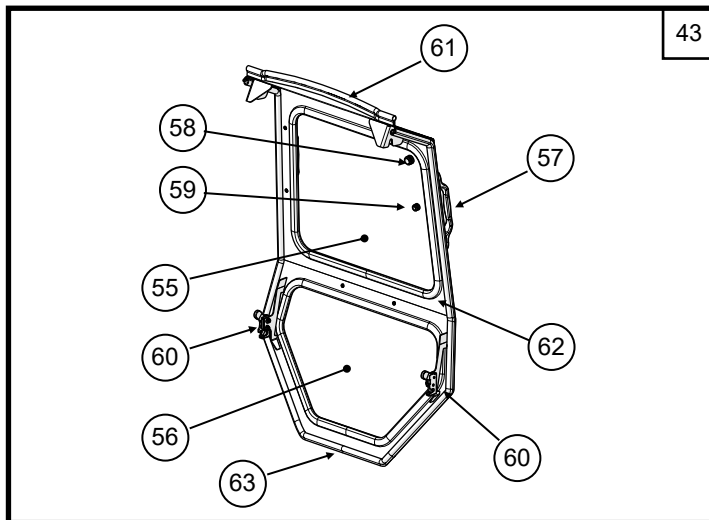

■ AVAILABLE REPLACEMENT PARTS

Ref. No.	Part No.	Part Name	QTY	REMARKS
70	77700-08531	SIDEFRAME ASSEMBLY, LEFT	1	Code No.: 109-00006-L
71	77700-08532	SIDEFRAME ASSEMBLY, RIGHT	1	Code No.: 109-00006-R
72	77700-08547	STRIKER BOLT, HARD, 42MM OAL	1	Code No.: 9DL01D-H
73	77700-08548	DOME PLUG, 11/16"	1	Code No.: 9DP05
74	77700-05457	RUBBER GROMMET, .4375IDx.125GW, x.6875GDx.9375OD	1	Code No.: 9HR03
75	77700-08549	RUBBER GROMMET, .5313IDx.125GW x.6875GDx.8125OD	1	Code No.: 9HR05
76	70000-01024	BALL STUD, 10MM, 5/16-18, HB	1	Code No.: 9GS02A
77	77700-08644	FRONT FLASHER, 4" ROUND, POST MOUNT, AMBER/AMBER	1	Code No.: 114-00006
78	77700-05253	HINGE WASHER, WELD-ON, BRASS, (.635"OD X .41"ID X .08"THK)	1	Code No.: 9PHW010-W
79	70000-01050	TRIM LOK, STD, 1/16"-1/8" GRIP	220"	Code No.: 9PRO1
80	70000-01397	5/8" STD BULB, 1/16" GRIP	37"	Code No.: 9PRO2
81	77700-05144	1" ROUND BULB, 1/16" GRIP	72"	Code No.: 9PR19
82	77700-08541	ARCH PSA RUBBER, .20WDX.15TALL	48"	Code No.: 9PR53
N.S.	77700-05134	1/2" X 9/16" RUBBER FOAM WEATHERSEAL	92"	Code No.: 9PR43
N.S.	77700-08545	WIRING HARNESS, CAB SIDE POWER, KBX80	1	Code No.: WH-00033
N.S.	77700-08546	WIRING HARNESS, FRONT FLASHERS TO REAR LIGHTS, KBX80	1	Code No.: WH-00034

N.S. = Not Shown

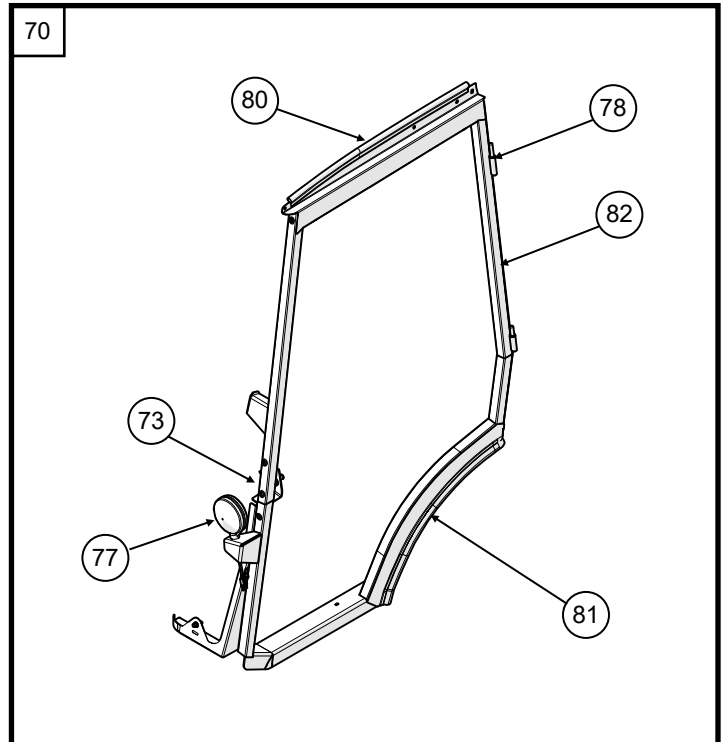
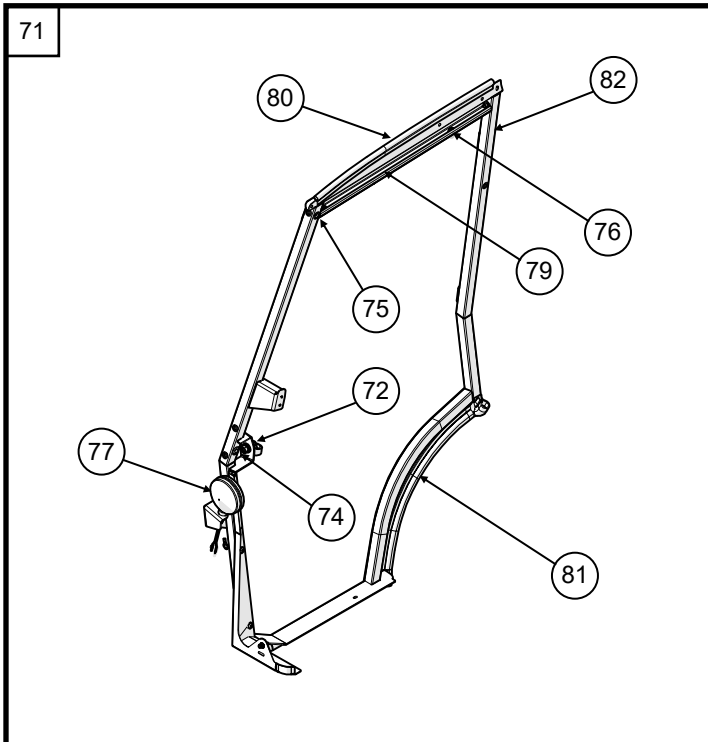

■ AVAILABLE REPLACEMENT PARTS

Ref. No.	Part No.	Part Name	QTY	REMARKS
83	77700-08529	DOOR ASSEMBLY, LEFT	1	Code No.: 107-00013-L
84	77700-08530	DOOR ASSEMBLY, RIGHT	1	Code No.: 107-00013-R
85	77700-08550	DOOR WINDOW, LOWER, GLASS	1	Code No.: 9GL-00028
86	77700-08554	SLIDING WINDOW, FS-105, 29.56 X 24.62 X 22.55 X 28.76	1	Code No.: 9SW-00009-L
87	77700-08551	SLIDING WINDOW, FS-105, 29.56 X 24.62 X 22.55 X 28.76	1	Code No.: 9SW-00009-R
88	77700-08555	HINGE SLEEVE ASSY, W-O, SHORT, KUB-DGRAY, LEFT	1	Code No.: PL-00010-L
89	77700-08552	HINGE SLEEVE ASSY, W-O, SHORT, KUB-DGRAY, RIGHT	1	Code No.: PL-00010-R
90	77700-08556	HINGE SLEEVE ASSY, W-O, LONG, KUB-DGRAY, LEFT	1	Code No.: PL-00011-L
91	77700-08553	HINGE SLEEVE ASSY, W-O, LONG, KUB-DGRAY, RIGHT	1	Code No.: PL-00011-R
92	70000-01016	DOOR LATCH, STD, LEFT (USED ON RIGHT SUICIDE DOORS)	1	Code No.: 9DL01A
93	70000-01017	DOOR LATCH, STD, RIGHT (USED ON LEFT SUICIDE DOORS)	1	Code No.: 9DL01B
94	70000-01018	DOOR HANDLE, OUTSIDE, PLASTIC (ROTARY LATCH)	1	Code No.: 9DL01C
95	70000-01024	BALL STUD, 10MM, 5/16-18, HB	1	Code No.: 9GS02A
96	77700-00279	WINDOW RUBBER, 14-16GA STEEL, .18-.28 WINDOW THICKNESS	110"	Code No.: 9PR10
97	70000-01401	3/4" SIDE BULB, 1/16" GRIP	169"	Code No.: 9PR17
98	77700-08539	GAS SPRING, 20" EXT, 12" COMP, 30 LBS, QD END	1	Code No.: 9GS12Q

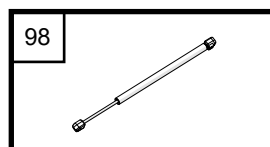
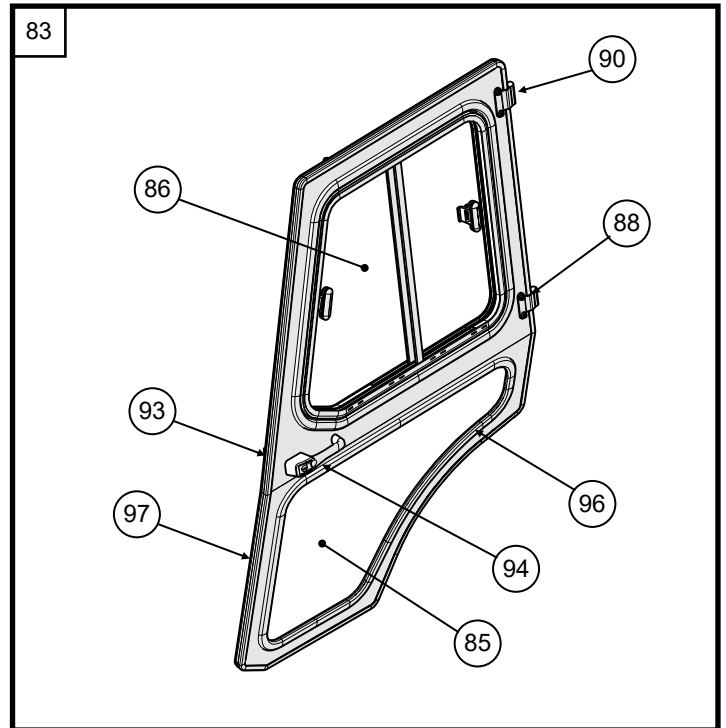
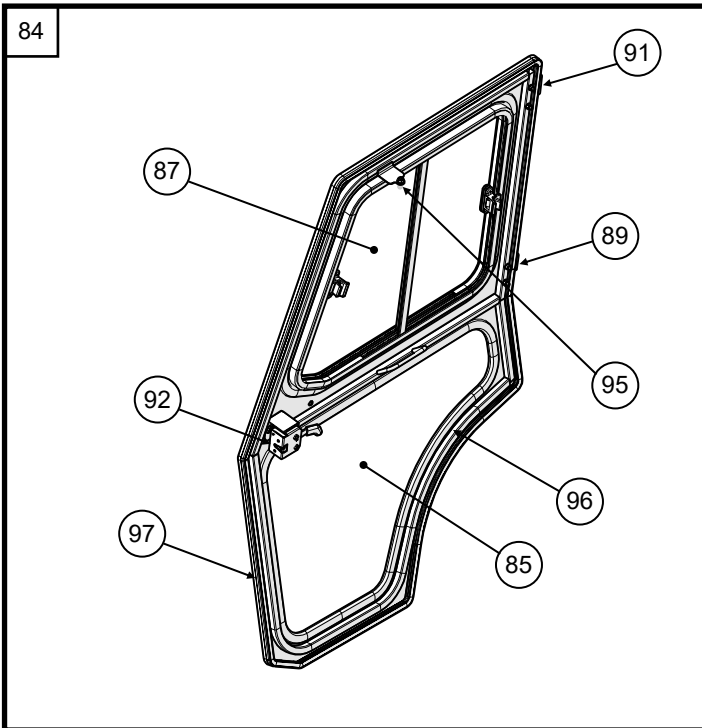

DECALS AND PLACEMENT

IMPORTANT: Keep all decals clean and legible. Replace all missing, illegible, or damaged decals.

IMPORTANT: Decal placement locations shown are approximate; decals should not be placed in a location where the operator's field of view is impeded, and should not cover any portion of other decals installed in the same vicinity.

INSTALLING OR REPLACING DECALS: Thoroughly clean the area where decal is to be placed using mild soap and water. Allow the surface to fully dry. Remove the backing from the decal, exposing the adhesive surface. Apply the decal to the recommended position shown in the diagram below and smooth out any bubbles.

- CAUTION: PREVENT OVERHEATING - 9DL-209. Located on center of Auxiliary Air Intake Panel
- WARNING: ROPS SAFETY - 9DL-204. Located on inside left of ROPS
- WARNING: ROLL OVER WARNING - 9DL-212. Located on inside right of ROPS

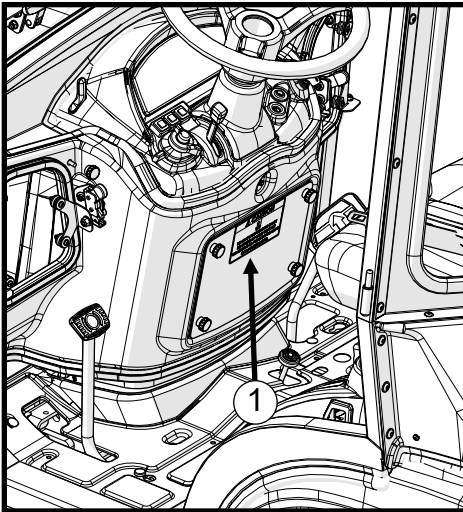

1) CAUTION: 9DL-209

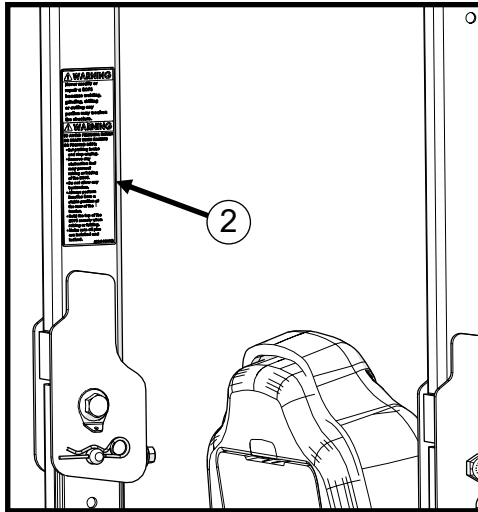
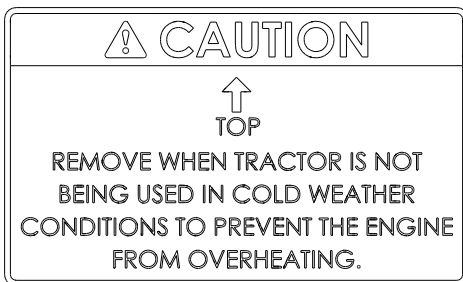

2) WARNING: 9DL-204

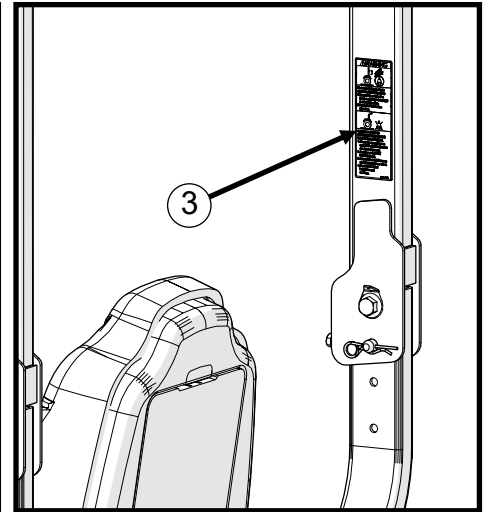
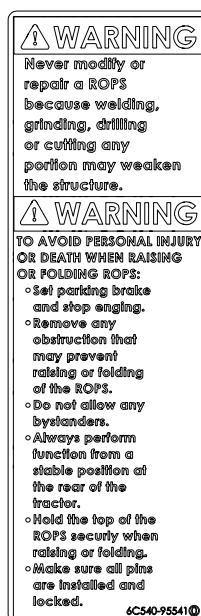

3) WARNING: 9DL-212

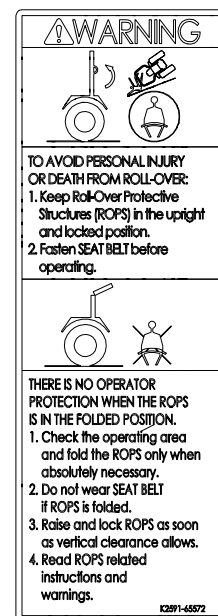



CAUTION

To avoid personal injury:

- Park the machine on a firm and level surface.
- Apply the parking brake.
- Stop the engine and remove the key from the machine.

■ ASSEMBLY PROCEDURE

NOTE:

- **All assembly procedures listed within this manual are generally representative of the machine model for which the manual is written.** Your machine may be configured differently, but the outline for the procedure should still be followed. For further support for any issues not covered within the pages of this manual, please contact your local Kubota representative.

1. Remove and save the SMV Sign. Disassemble the mounting arm and sleeve and save. The mounting arm will be replaced during reassembly.

Tools: 13mm Socket

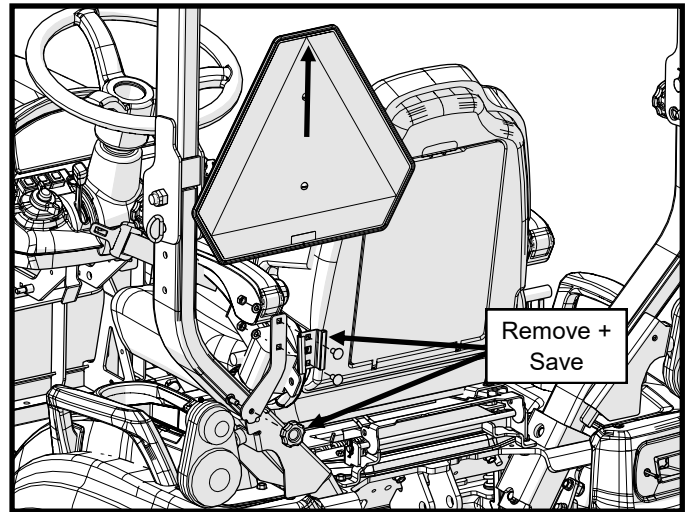

Figure 1: Remove SMV Sign

2. Remove and save the front three screws holding the left lever cover to the fender.

Tools: 10mm Socket

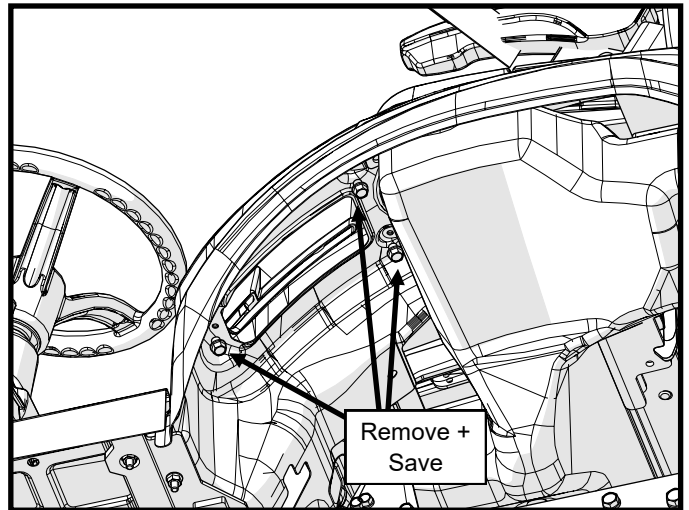

Figure 2: Remove 3 Screws (Left Side)

3. Remove and save the rear two screws holding the right lever cover to the fender.

Tools: 10mm Socket

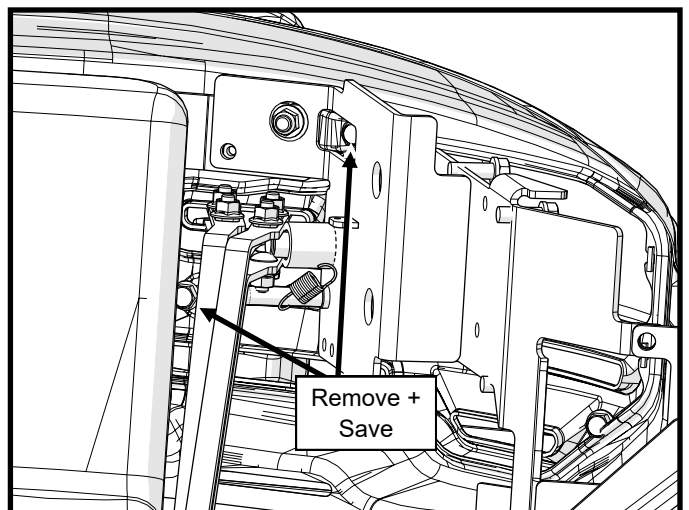

Figure 3: Remove 2 Screws (Right Side)

4. Remove the grab handles from the fenders by removing the two nuts located on the underside of the fenders.

Tools: 14mm Wrench
14mm Socket

5. Install a bolt in each hole to re-secure the tractor fenders.

HW: (4) 3/8-16x3/4 Flange Bolts
(4) 3/8-16 Flange Locknuts

Tools: 9/16" Wrench
9/16" Socket

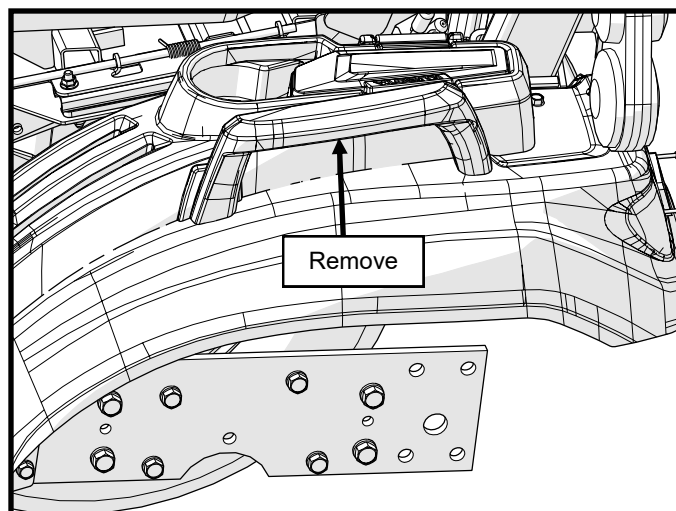

Figure 4: Remove Grab Handles (Left + Right)

6. If installing optional seal kit (BX4077), it should be installed at this time for easiest access. Proceed to Step 7 if no kit is being installed.

7. Re-install the 5 screws removed in steps 2 and 3 that hold the plastic lever covers to the fenders

Tools: 10mm Socket

8. Remove the ROPS tensioning knobs and replace with the following hardware. Leave loose until after cab is fully installed.

HW: (2) M10 x 1.25 x 25mm Flange Bolts

Tools: 15mm Wrench

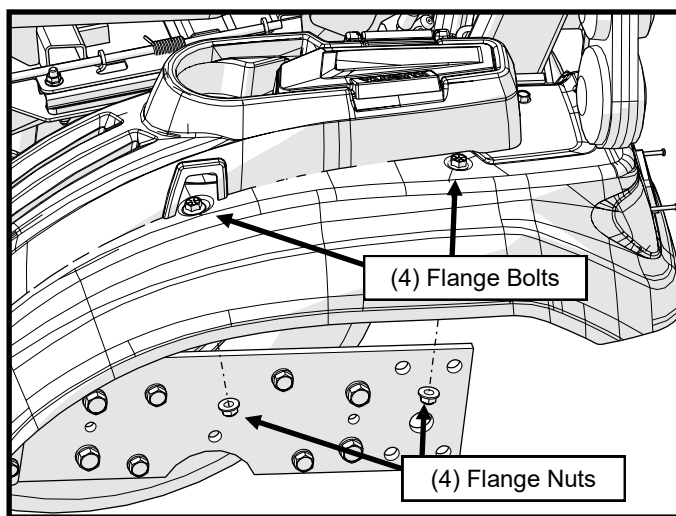

Figure 5: Install Bolts into Holes (Left and Right)

WARNING

To avoid personal injury or death:

DO NOT WELD, DRILL OR OTHERWISE MODIFY
STRUCTURAL INTEGRITY OF THE ROPS.

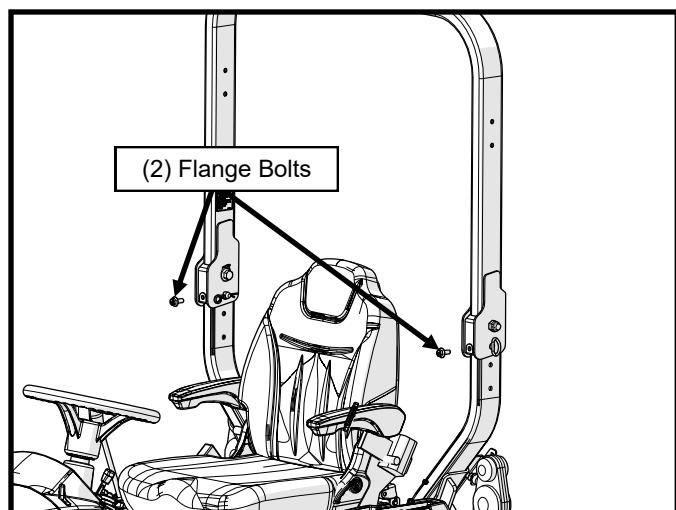

Figure 8: Replace Tensioning Knobs

9. Remove and save the air intake screen and thumbnut.

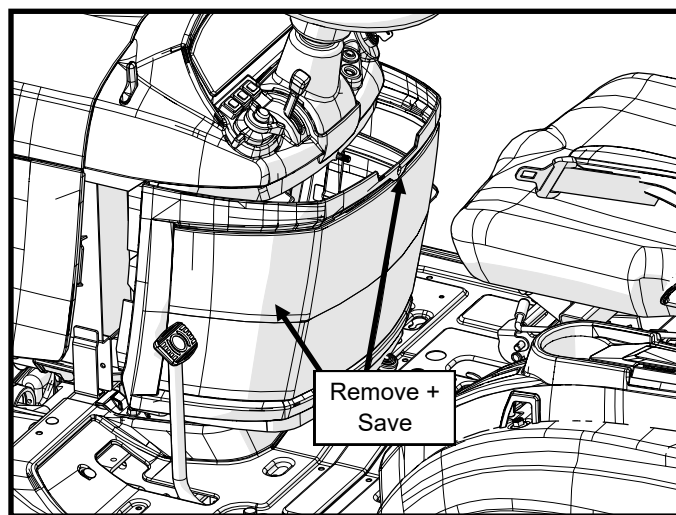

Figure 9: Remove Screen and Thumbnut

10. Remove the carriage bolt that the air intake screen thumbnut was attached to and replace with a longer carriage bolt (supplied). Reuse the nut from the factory bolt. Note: The steering wheel may need to be tilted to allow the bolt to come out of the hole.

HW: (1) M8 x 1.25 x 40mm Carriage Bolt

(1) OEM Nut

Tools: 12mm Wrench

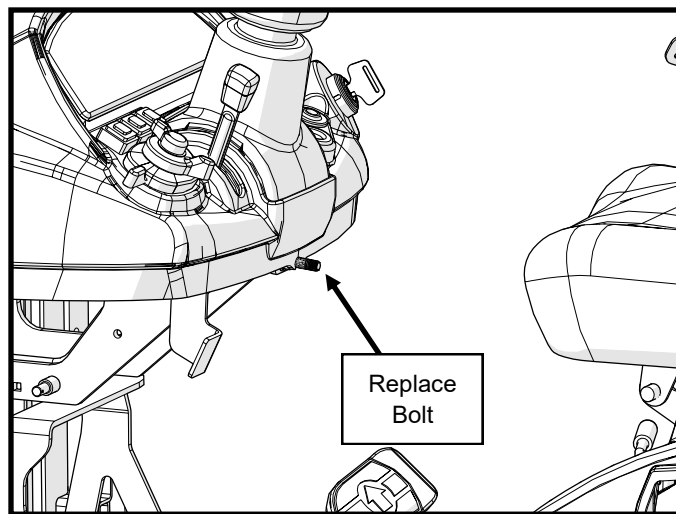

Figure 10: Replace Carriage Bolt

11. Remove and discard the two fir tree clips securing the floormat to the tractor in the locations shown.

Tools: Snips

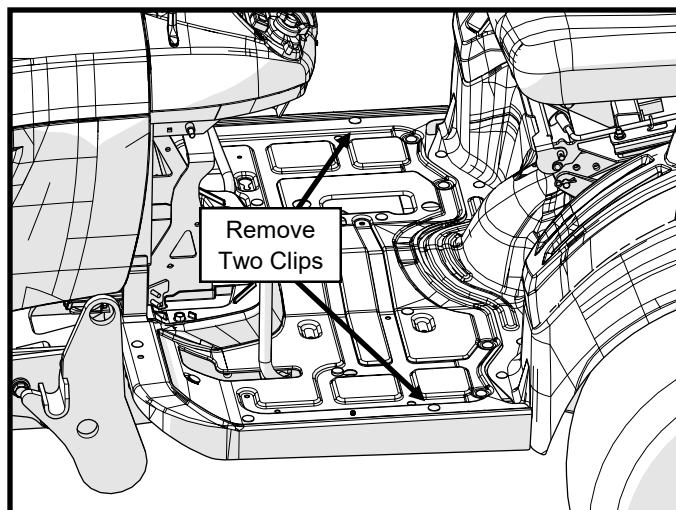

Figure 11: Remove Fir Tree Clips

12. Remove and discard the two carriage bolts on the front of the floorboard on either side of the radiator.

Tools: 12mm Socket or Wrench

13. Disconnect the negative battery terminal.

Tools: 13mm Wrench

14. Remove the nut from the positive battery terminal

Tools: 10mm Wrench

15. Locate the Relay Wire Harness (P/N: 77700-05439) in the hardware box. Connect the ring terminal on the red wire to the stud on the positive battery terminal and reinstall the nut.

Tools: 10mm Wrench

16. Connect the ring terminal on the black wire to the stud on the negative battery terminal and reinstall the nut. Reinstall the battery terminal onto the battery and tighten.

Tools: 13mm Wrench

17. Locate the ignition source on the tractor. It is a female bullet terminal secured to the wire harness above the battery with blue electrical tape. Remove the tape to expose the terminal.

18. Connect the male bullet terminal on the end of the purple wire on the cab power harness to the terminal on the tractor.

19. Turn the key on without starting the tractor and check that the relay on the cab power harness clicks which would indicate power.

20. Route the plug on the end of the harness out along the right side of the radiator and down under the hood. Be sure to route the wire to avoid sharp edges and have clearance from the moving hood panel.

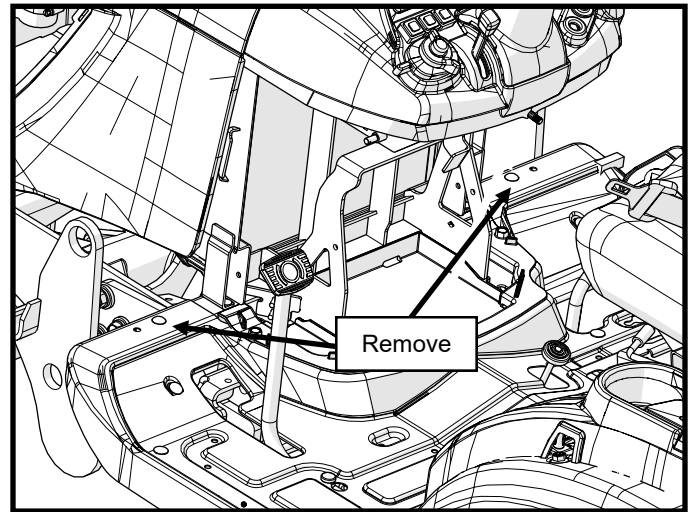

Figure 12: Remove Bolts



Figure 15: Install Red Wire



Figure 16: Install Black Wire

21. Remove and save the OEM bolts securing the rear facing seat bracket. Remove the OEM seat bracket and save for a later step.

Tools: 10mm Socket
12mm Socket

22. Attach the rear mounts and backer plates to the holes in the ROPS structure. Tighten bolts so that the components are still loose enough to move freely.

HW: (4) 3/8-16 x 2.25" Flange Bolts
(4) 3/8-16 Flanged Locknuts

Tools: 9/16" wrench
9/16" socket

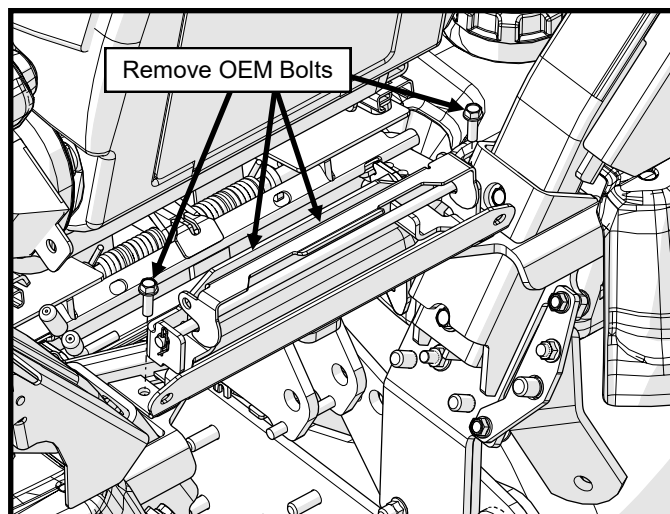

Figure 21: Remove Rear Seat Bracket

23. Fold the tractor ROPS down by removing the pins, lowering it, and securing it via the pins in the lowered position. Move the seat into its forward position.

24. Remove the air intake shroud and doors from the cab for easiest install.

Remove the doors from the cab by disconnecting the quick disconnect end of the gas struts from the side frame, rotating the door fully rearward, and lifting the door off the hinges. Do not lose the brass washers on the hinges.

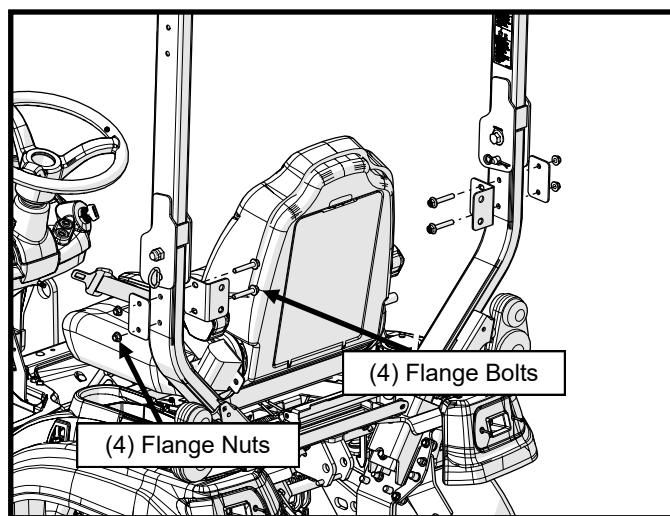

Figure 22: Install Rear Mounts

Remove the air intake shroud by unscrewing the six thumbscrews that secure it to the front of the cab.

25. Remove the bolts securing the cab to the shipping pallet: (1) bolt in each floorboard, (2) bolts in each front leg, (4) bolts in the rear panel, and (2) bolts in the lower rear seat bracket.

26. Lift the cab by the eye hooks in the roof as shown in figure 26. The cab will tip slightly forward as it's lifted via the rings. Suspend the cab in the air temporarily for step 27.

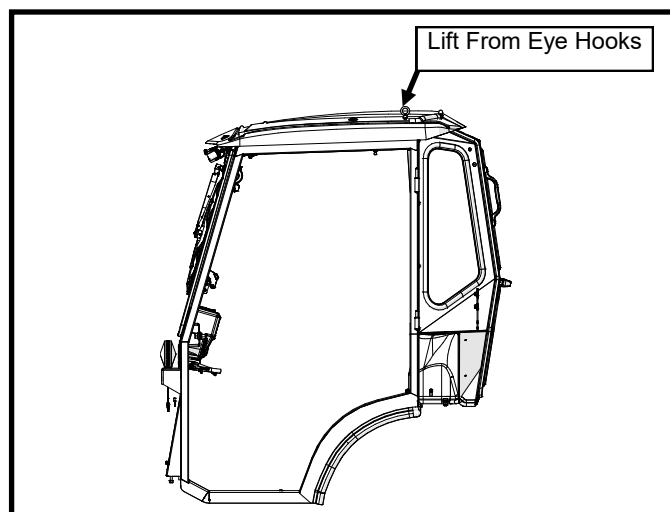

Figure 26: Remove Doors and Lift Cab

27. Locate the left side frame and install the supplied foam gasket along the bottom of the floorboard as shown in figure 27. Repeat on the right side frame.

28. Open hood and then carefully lower the cab over the tractor oriented per figure 28 until the front legs are about 1/4 inch above the front of the tractor floorboard. Ensure that the wiring front and back does not get pinched under the cab as it is lowered into position.

Carefully slip the front cab mount on the right side under the flange on the hydraulics mount and then lower the cab until the lower rear seat cross member on the cab is about 1" above where the rear facing seat mount would be located.

Ensure that the rear of the floorboards do not scrape on the fenders as the cab is lowered into position.

Re-position the OEM rear facing seat mount on the cab so that it aligns with the cutouts in the bracket secured to the cab. Lower the cab fully and loosely re-install the OEM hardware.

29. Align the holes in the front legs with the holes in the tractor floorboard and install 5/16-18 x 3/4" Flange Bolts through the (2) holes in each front leg. Loosely secure with 5/16-18 Flange Nuts.

HW: (4) 5/16-18 x 3/4" Flange Bolt
(4) 5/16-18 Flange Nut

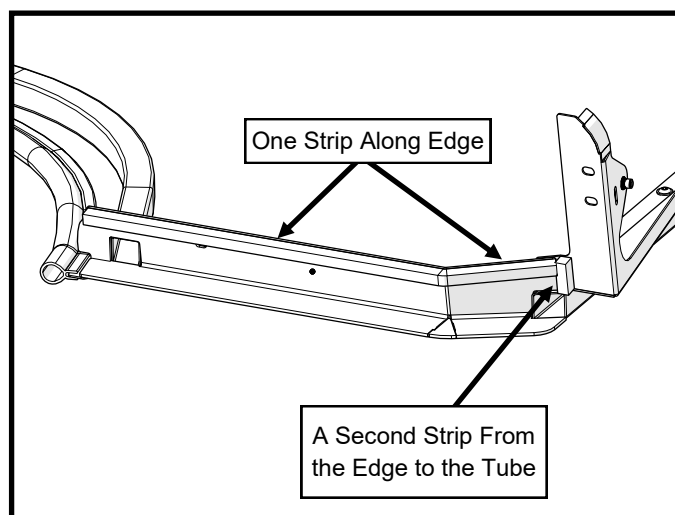

Figure 27: Install Foam Gasket

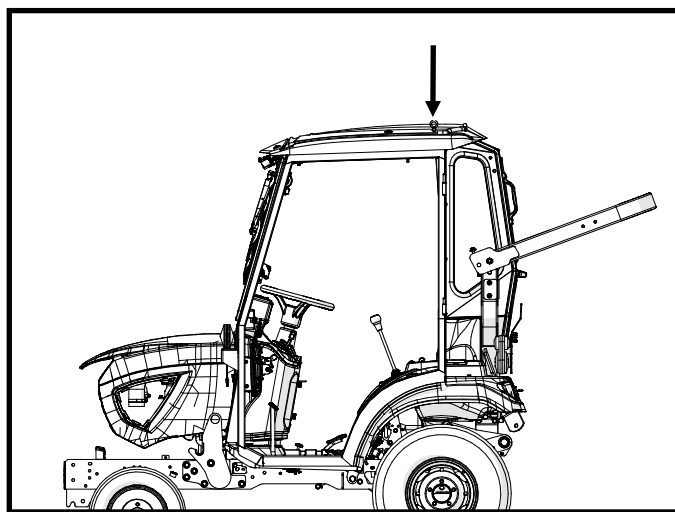

Figure 28: Lower Cab Onto Tractor

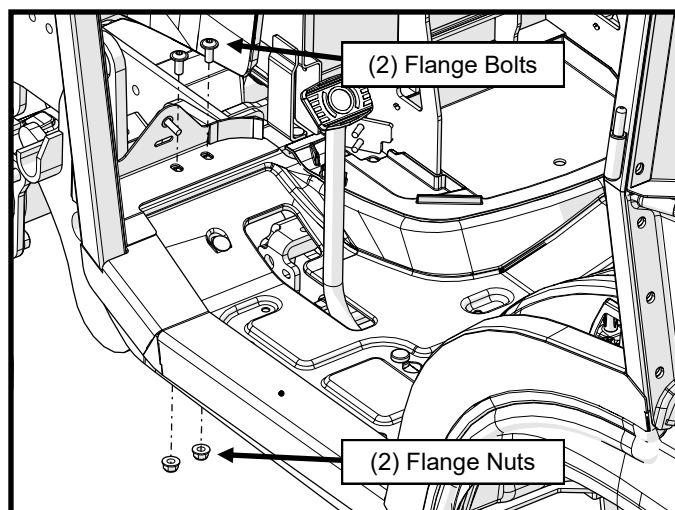

Figure 29: Secure Front of Side frame to Floorboard

30. Align the previously installed ROPS brackets with the rear panel mounting tabs. Secure with 5/16-18 Flange Bolts and Fender Washers.

HW: (4) 5/16-18 x 3/4" flange bolts

(4) 5/16ID x 1.25" OD Steel Fender Washers

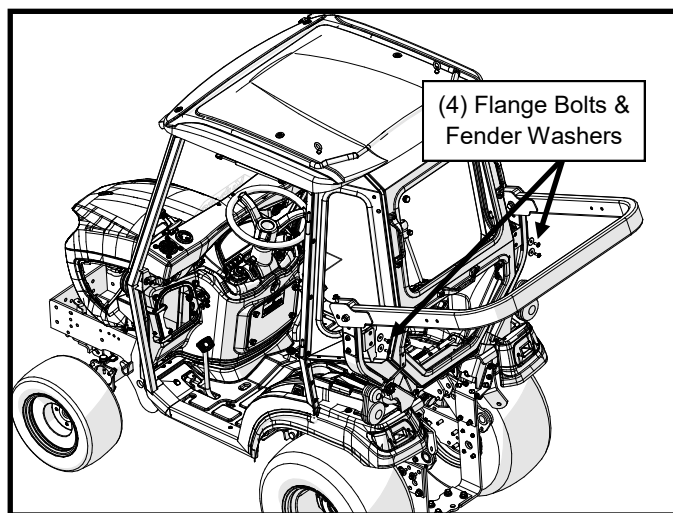

Figure 30: Secure Rear Panel To ROPS Brackets

31. Secure the cab floorboards to the tractor floorboard with 1/4-20 x 3/4" Flange Bolts and 1/4-20" Flange Nuts, one set on each side of tractor. See Figure 31.

HW: (2) 1/4-20 x 3/4" flange bolt

(2) 1/4-20 flange nut

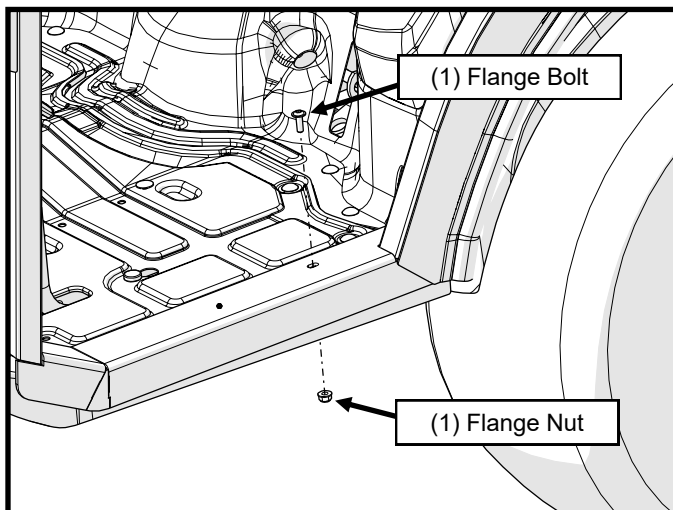

Figure 31: Secure Side frame to Floorboard

32. Install the plastic storage box shroud from the inside of the cab so as not to disturb the rubber seal along the rear panel. Secure in place with the supplied hardware. See figure 32.

HW: (4) #10-32 x 5/8" pan head bolt

(4) #10-32 flange nut

(3) 5/16-18 x 3/4" flange bolt

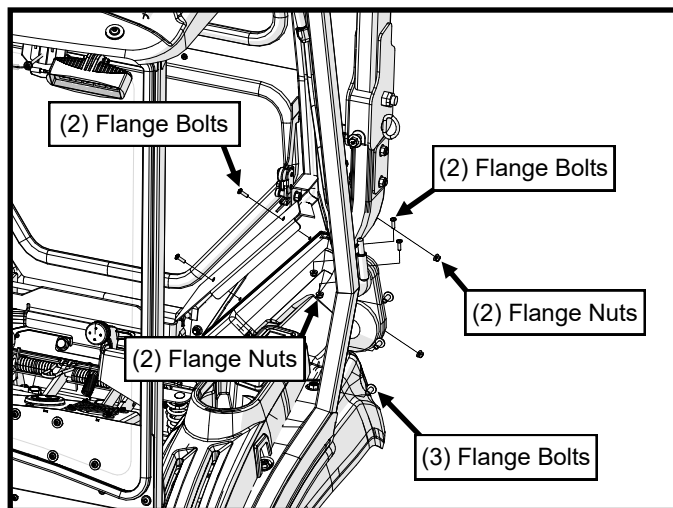

Figure 32: Install Storage Box Shroud

33. Check the fit of the cab, adjust as needed and tighten the cab bolts in the following order:

Qty: (4) - 5/16 bolts through the rear mounts and into rear panel.

Note: Be sure that there is proper clearance between the bottom of the rear panel and the ROPS. If there is little clearance, use assistance to lift the rear of the cab and then tighten.

Tools: 3/16" Allen Wrench

Qty: (4) - Rear mount bolts through ROPS.

Note: Be sure that there is proper clearance between the bottom of the rear panel and the ROPS. If there is little clearance, use assistance to lift the rear of the cab and then tighten.

Tools: 9/16" Wrench

9/16" Socket

Qty: (4) - Front floorboard bolts.

Tools: 3/16" Allen Wrench

1/2" Socket or Wrench

Qty: (2) - Rear floorboard bolts.

Tools: 5/32" Allen Wrench

7/16" Socket

Qty: (4) - Rear Seat Bracket OEM bolts.

Tools: 10mm Socket

12mm Socket

34. Raise and secure the ROPS into its upright position.

Note: The lifting rings may be removed and replaced with bolts if desired. Two 5/16-18 x 3/4" bolts are included in the hardware kit for this purpose.

Note: At this time, refer to the heater installation instructions to finish installing the heater if a heater is installed.

35. Connect the weatherproof connector from the relay wire harness installed in steps 14-17 to the connector on the cab side power harness protruding from the bottom of the right side frame. Be sure to route the harnesses to avoid sagging. Pull any excess wire back into the battery compartment and secure with cable ties.
36. Turn the key to the on position and test the function of the accessories at this time.
37. Install a 7" piece of foam (see the white dashed lines in photo) to the top of the floorboard and route it down under where the air intake screen will sit as in Figure 37, repeat for the right side.

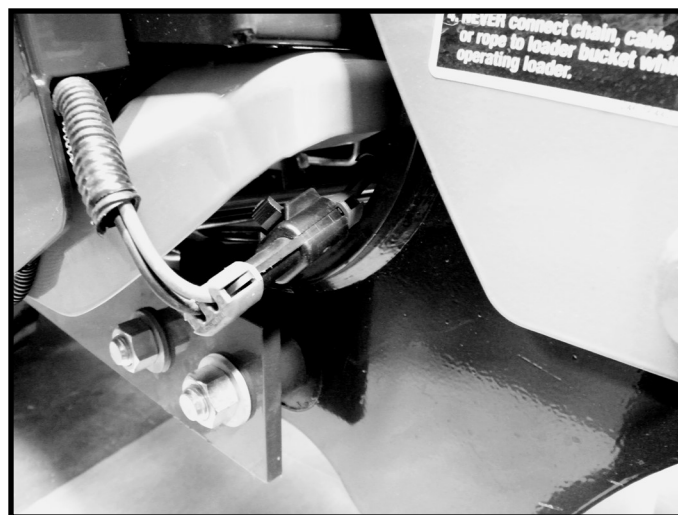

Figure 35: Connect Weatherproof Connector

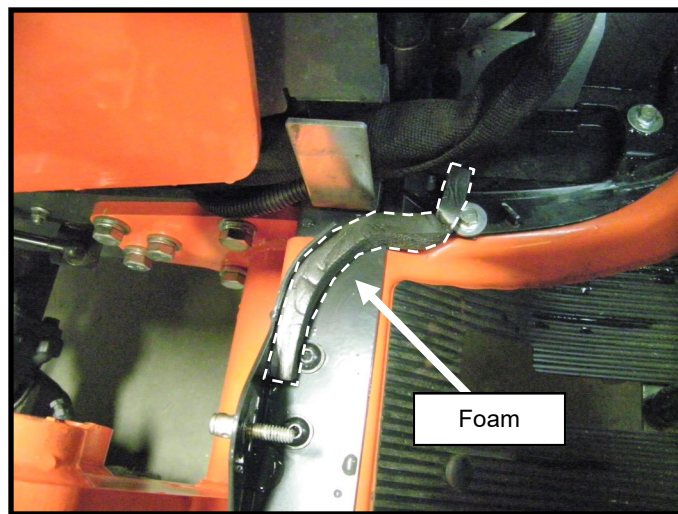

Figure 37: Foam Installation

38. Re-install the air intake screen, but do not use the OEM thumbnut yet.

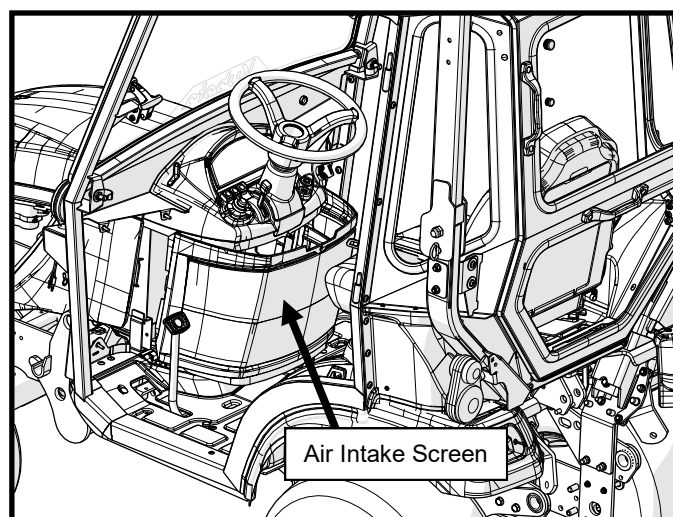

Figure 38: Install Air Intake Screen

39. Install the plastic air intake shroud.

HW: (6) 1/4-20 Thumbnuts
(1) OEM Thumbnut

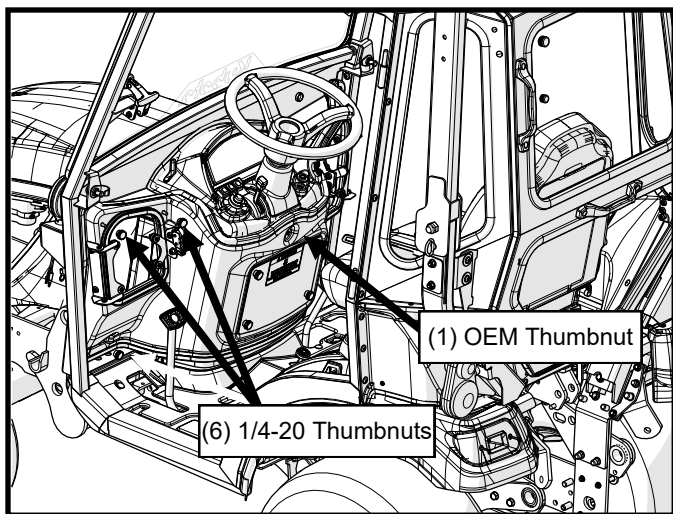

Figure 39: Install Plastic Air Intake Shroud

40. The front flasher light harnesses (P/N: 77700-08546) are factory installed in each cab side frame. Route the harnesses around the plastic panels (see the white dashed lines in photo) using the cable clamp provided. Be sure the wires are close to the fenders as they are routed down and out of the cab so the seat springs clear them easily.

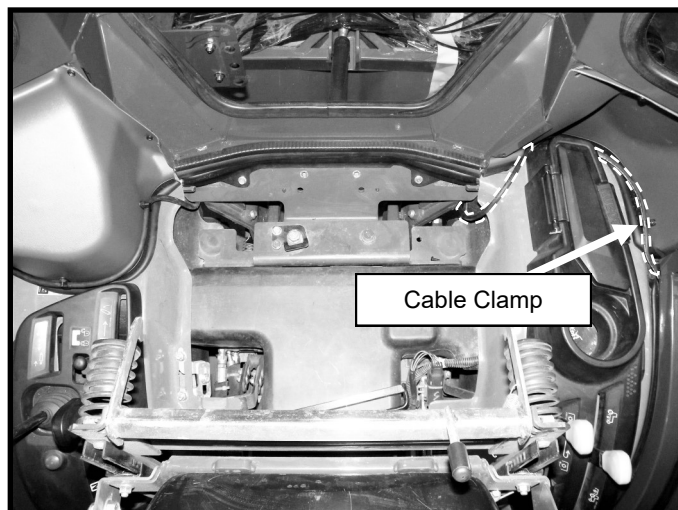

Figure 40: Route Front Flasher Light Harness

41. Connect the front flasher light harnesses to the existing rear lights. Connect Black to Black, Red to Red, and White to Black/White stripe.

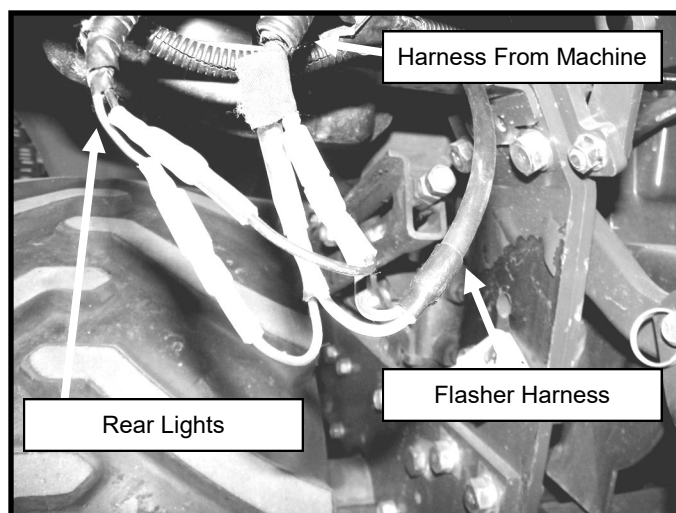

Figure 41: Connect Flasher Light Harness

42. Remove factory carriage bolt and nut from the front left corner of the seat slider and discard. Install the seat limiting plate inside the seat slider track with (3) washers as spacers.

HW: (1) 5/16-18 x 1" Carriage Bolt

(3) 5/16"ID Steel Washers

(1) 5/16-18 Flange Nut

Tools: 1/2" Wrench

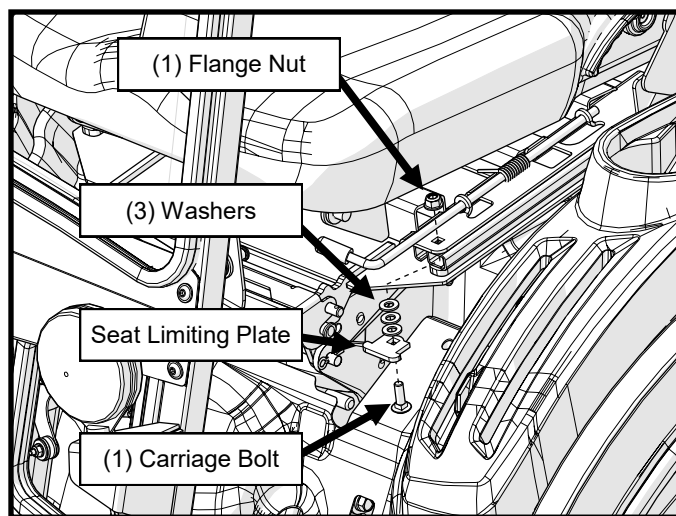

Figure 42: Install The Seat Limiting Plate

43. Install the doors and reconnect the gas shocks. Holding the door 180° from closed will allow it to slide under the roof before aligning the hinge pins.

See door troubleshooting on page 26 for information about adjusting the door latches and hinges.

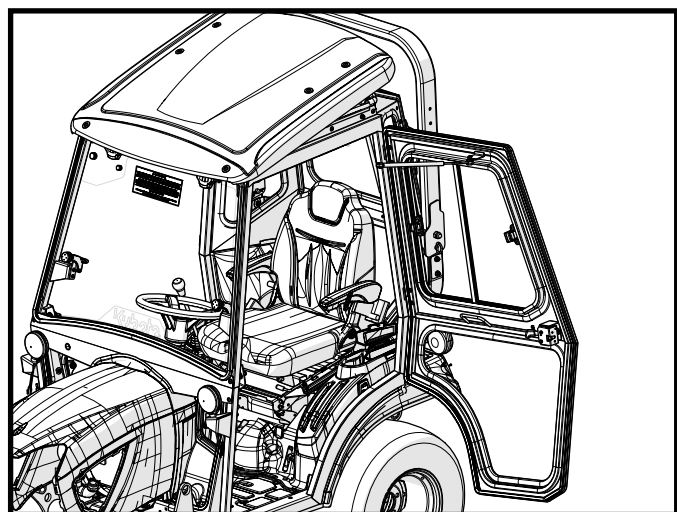

Figure 43: Install The Doors

44. Using the newly supplied arm for the SMV sign, reattach the SMV sign sleeve removed in step 1.

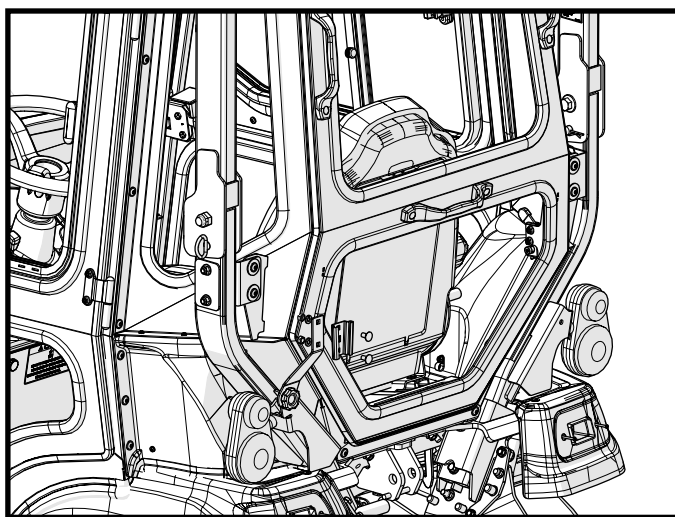

Figure 44: Install New Arm For SMV Sign

45. Replace SMV sign in the original location.

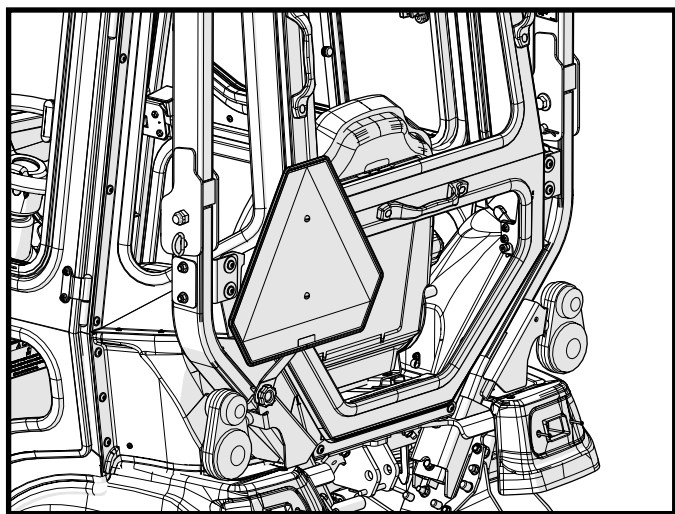

Figure 45: Install SMV Sign

46. If installing a snow blower attachment with a manual chute rotation, replace the plug in the cowl with the supplied plastic split grommet.

HW: (1) Split Grommet

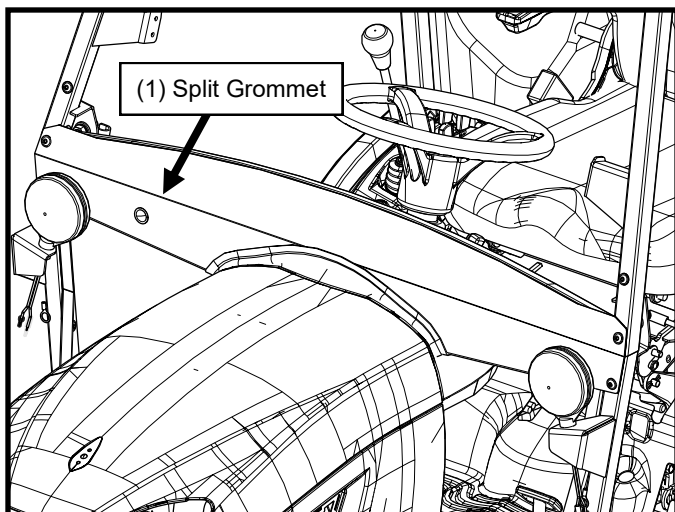

Figure 46: Install Split Grommet

OPERATION



WARNING

REQUIRED BEFORE OPERATION

1. Read and understand this entire manual and any other publications for the equipment being operated.
2. Ensure that the surrounding area is clear and that personnel are positioned away from the area where engagement and disengagement of attachments will occur.
3. Always shut off engine when leaving the operator's area to perform any portion of the listed procedures.

POP-UP ROOF

The cab features a hinged and gas shock supported roof. This feature allows for backhoe operation as well as provides additional ventilation.

To operate the roof, press up on the yellow lever on the quick release latches. It may help to pull down slightly on the grab handles while releasing the latches.

To lock the roof in the down position, simply pull down on the grab handles until each latch has double clicked.

Note: Pull down on each handle at the same time to ensure accurate positioning of the latches.

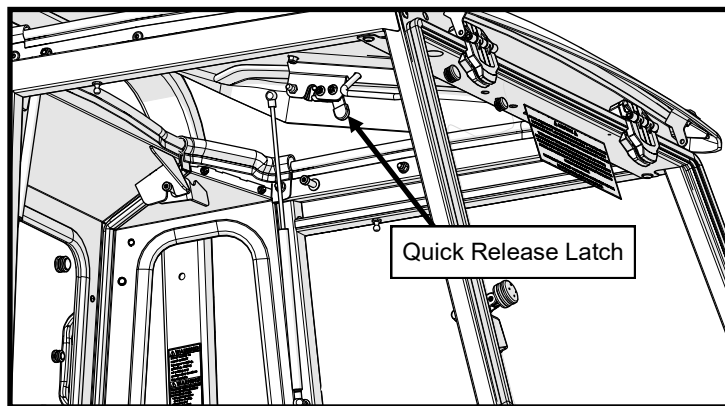

Pop-Up Roof

REMOVABLE REAR PANEL

The cab features a removable rear panel that allows access when using the backhoe.

To remove the rear panel:

1. First raise the hinged roof following the instructions above.
2. Release the two latches towards the bottom of the rear panel. *It may be necessary to push out on the lower section of the rear panel to prevent the latches from re-engaging.*
3. From the outside of the cab, lift up on the rear panel and pull towards the backhoe.

Store the rear panel in a safe location to prevent damage.

To reinstall the rear panel, align the slots at the top with the pins on the rear legs and drop into place. Push in on the lower corners of the rear panel to ensure double latching of the quick release latches.

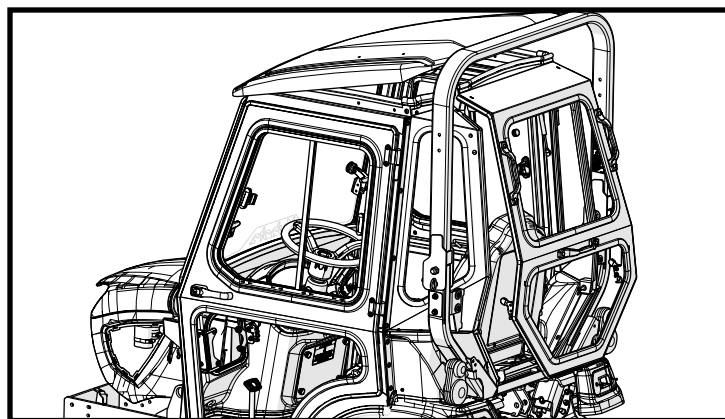

Removable Rear Panel

OPERATION



WARNING

REQUIRED BEFORE OPERATION

1. Read and understand this entire manual and any other publications for the equipment being operated.
2. Ensure that the surrounding area is clear and that personnel are positioned away from the area where engagement and disengagement of attachments will occur.
3. Always shut off engine when leaving the operator's area to perform any portion of the listed procedures.

POP-OUT WINDSHIELD

The cab comes equipped with a pop-out windshield for ventilation. To open the windshield, simply lift up on both of the pop-out latches and rotate until the latches rest in the over-center position.

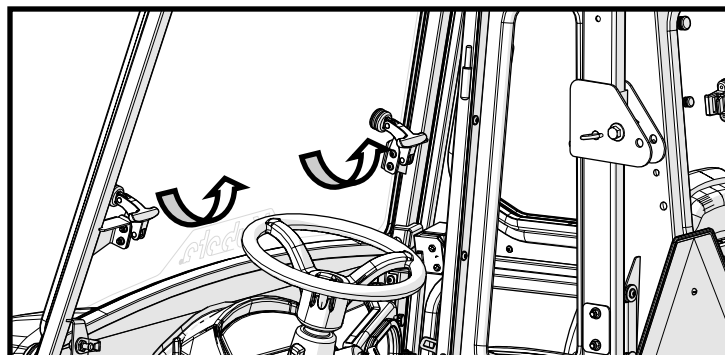

Pop-Out Windshield

LIFT-OFF DOORS

For added ventilation, the doors on the cab lift off in seconds without tools.

To lift off:

1. Stabilize the door and take pressure off the gas shock. Disconnect the gas shock from the sideframe by sliding the red release slide away from the shock body and gently pulling the shock off the ball stud.
2. Rotate the door 180° to the sideframe and lift. Also, remove the hinge washers and store in a plastic bag.
Store the doors in a safe location to prevent damage.

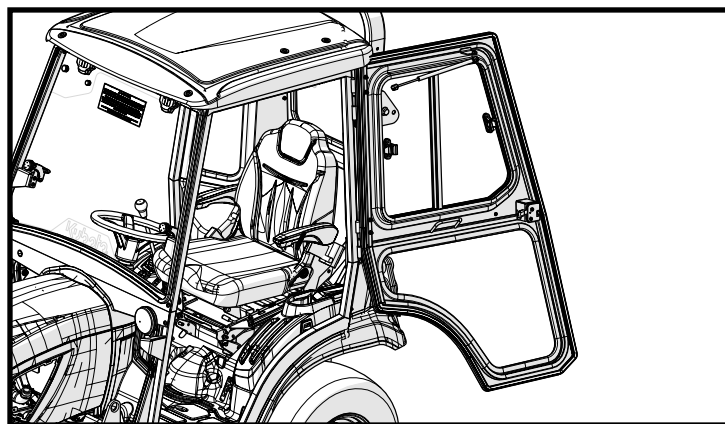

Lift-Off Doors

POP-OPEN FRONT WINDOWS

The cab has front lower windows that open for access to the machine loader attachment levers. To open the windows, release the latches and open. The window hinges are designed to stop the windows from swinging open too far and contacting the doors. When closing, ensure the latches double click to properly seal the windows back to the plastic shroud.

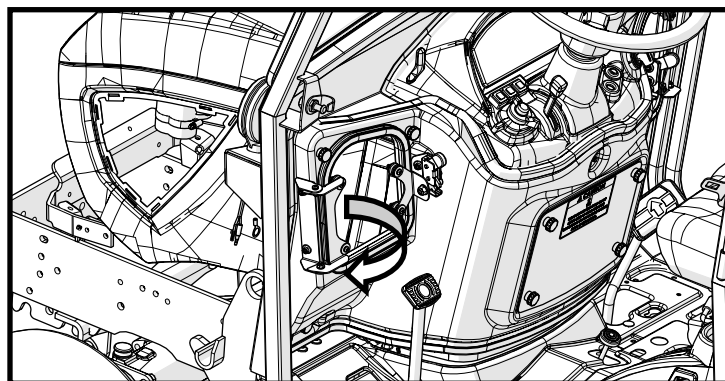

Pop-Open Front Windows

OPERATION

WARNING

REQUIRED BEFORE OPERATION

1. Read and understand this entire manual and any other publications for the equipment being operated.
2. Ensure that the surrounding area is clear and that personnel are positioned away from the area where engagement and disengagement of attachments will occur.
3. Always shut off engine when leaving the operator's area to perform any portion of the listed procedures.

AUXILIARY RADIATOR INTAKE COVER

The cab has a removable auxiliary radiator intake cover that should be removed when not operating the machine in cold weather conditions in order to prevent the machine from potentially overheating. Four thumb nuts hold the cover in place, and the cover can be stored inside the seat-back storage compartment, if equipped.

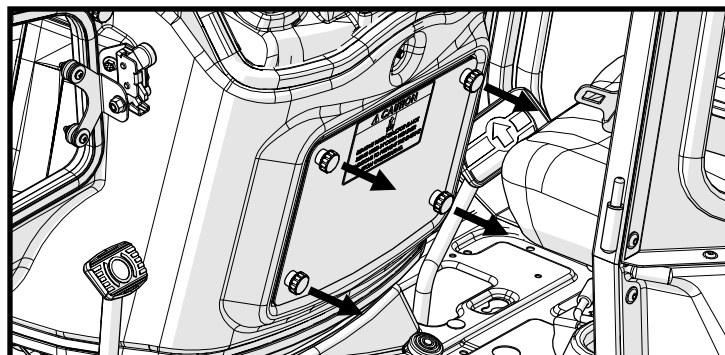

Auxiliary Radiator Intake Cover

REMOVABLE RADIATOR INTAKE SHROUD

The cab has a removable radiator intake shroud that provides access to the under-dash battery area during machine servicing. Remove the six small thumb nuts as well as the one larger OEM knob and gently pull the shroud towards the back. Re-installation is the opposite, and it is easiest to align the lower studs first, then tilt the top of the shroud forward onto the remaining studs.

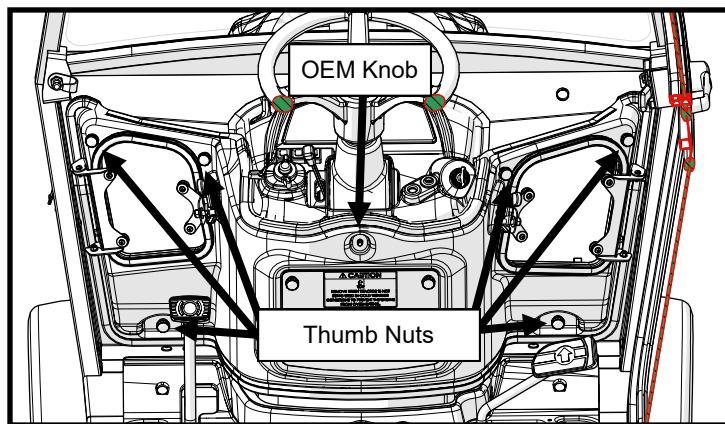

Removable Radiator Intake Shroud

SEAT RECLINING WARNING

The rear panel in the cab is as far back as it could be placed while maintaining clearance for various BX tractor options. A seat travel limiting plate has been installed to prevent the seat bottom from sliding too far back and contacting the rear panel, however it is still possible for the seat back to be reclined into the rear panel. Care must be taken to ensure that the seat is positioned so that it does not contact the cab in order to prevent possible damage.

MAINTENANCE

CARE AND MAINTENANCE:

Check and tighten all hardware after 20 hours of operation. Periodically inspect and tighten hardware for the remainder of the unit's service life. Keep the components clean in order to prevent dust and dirt from forming an unattractive film. The life of your cab components depend upon following these care procedures:

1. **NEVER USE** AN ABRASIVE DETERGENT / VEHICLE CLEANER OR A WIRE BRISTLED BRUSH. Do not use any **CITRUS-BASED CLEANERS** such as orange or lemon.
2. **NEVER USE** AN ALCOHOL-BASED PRODUCT FOR CLEANING THE PLASTICS. Many brand-name glass cleaners contain alcohol that will result in deterioration of the plastics.
3. Clean the enclosure surfaces thoroughly with warm soapy water and a COTTON cloth or chamois. Be sure to use mild soap, specifically a dish liquid or equivalent. Clean in a light circular motion for best results.
4. Remove grease and oil with mineral spirits and a COTTON cloth or chamois.

TROUBLESHOOTING

Condition	Possible Solution
<ul style="list-style-type: none">Door latch and striker pin do not line up vertically.	<ul style="list-style-type: none">Loosen striker pin and move up or down using (2) 3/4" wrenches to adjust.
<ul style="list-style-type: none">Door latch and striker pin do not line up horizontally.	<ul style="list-style-type: none">Loosen (2) 1/4-20 hex flange screws between latch and door. Move interior door latch forward or backward. Retighten.
<ul style="list-style-type: none">Doors do not double click at latch.	<ul style="list-style-type: none">Adjust door striker pin up, down, in, or out depending on need.If striker pin adjustment is not enough, loosen the bolts holding the door hinges, locate door where desired, and re-tighten hinges.
<ul style="list-style-type: none">Flasher lights are not working properly.	<ul style="list-style-type: none">Check electrical connections at rear lights. Note: Be sure that the insulation on the male bullet on the OEM tractor light is cut back enough to provide proper connection.Check to be sure front light wire is properly grounded by loosening the nut on the light and re-tightening. The light grounds through the threaded stud.
<ul style="list-style-type: none">Accessories are not working properly.	<ul style="list-style-type: none">Check to be sure that the relay is turning on/off with the ignition key.Confirm that the main fuse at the battery is good.Check to be sure the plug at the bottom of the right frame is connected to the machine harness.Remove the roof and check the positive and negative connections for the main power harness. Negative should ground to the ground strip and positive should connect to the accessory circuit breaker.





TORQUE SPECIFICATION TABLE

GENERAL SPECIFICATION TABLE

USE THE FOLLOWING TORQUES WHEN SPECIAL TORQUES ARE NOT GIVEN

Note: These values apply fasteners as received from supplier dry, or when lubricated with normal engine oil. They do not apply if special graphited or moly sulphide greases or other extreme pressure lubricants are used. These values apply to dry conditions; under lubricated conditions reduce by 25% the torques in this table.

BOLT HEAD IDENTIFICATION

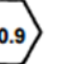
INCHES Bolt Size							METRIC Bolt Size						
	Grade 2		Grade 5		Grade 8			Class 5.8		Class 8.8		Class 10.9	
in-tpi ¹	N-m ²	lbs-ft ³	N-m	lbs-ft	N-m	lbs-ft	mm x pitch ⁴	N-m	lbs-ft	N-m	lbs-ft	N-m	lbs-ft
1/4" – 20NC	7.4	5.6	11	8	16	12	M 5 X 0.8	4	3	6	5	9	7
1/4" – 28NF	8.5	6	13	10	18	14	M 6 X 1	7	5	11	8	15	11
5/16" – 18NC	15	11	24	17	33	25	M 8 X 1.25	17	12	26	19	36	27
5/16" – 24NF	17	13	26	19	37	27	M 8 X 1	18	13	28	21	39	29
3/8" – 16NC	27	20	42	31	59	44	M 10 X 1.5	33	24	52	39	72	53
3/8" – 24NF	31	22	47	35	67	49	M 10 X 0.75	39	29	61	45	85	62
7/16" – 14NC	43	32	67	49	95	70	M 12 X 1.75	58	42	91	67	125	93
7/16" – 20NF	49	36	75	55	105	78	M 12 X 1.5	60	44	95	70	130	97
1/2" – 13NC	66	49	105	76	145	105	M 12 X 1	90	66	105	77	145	105
1/2" – 20NF	75	55	115	85	165	120	M 14 X 2	92	68	145	105	200	150
9/16" – 12NC	95	70	150	110	210	155	M 14 X 1.5	99	73	155	115	215	160
9/16" – 18NF	105	79	165	120	235	170	M 16 X 2	145	105	225	165	315	230
5/8" – 11NC	130	97	205	150	285	210	M 16 X 1.5	155	115	240	180	335	245
5/8" – 18NF	150	110	230	170	325	240	M 18 X 2.5	195	145	310	230	405	300
3/4" – 10NC	235	170	360	265	510	375	M 18 X 1.5	220	165	350	260	485	355
3/4" – 16NF	260	190	405	295	570	420	M 20 X 2.5	280	205	440	325	610	450
7/8" – 9NC	225	165	585	430	820	605	M 20 X 1.5	310	230	650	480	900	665
7/8" – 14NF	250	185	640	475	905	670	M 24 X 3	480	355	760	560	1050	780
1" – 8NC	340	250	875	645	1230	910	M 24 X 2	525	390	830	610	1150	845
1" – 12NF	370	275	955	705	1350	995	M 30 X 3.5	960	705	1510	1120	2100	1550
1 1/8" – 7NC	480	355	1080	795	1750	1290	M 30 X 2	1060	785	1680	1240	2320	1710
1 1/8" – 12NF	540	395	1210	890	1960	1440	M 36 X 3.5	1730	1270	2650	1950	3660	2700
1 1/4" – 7NC	680	500	1520	1120	2460	1820	M 36 X 2	1880	1380	2960	2190	4100	3220
1 1/4" – 12NF	750	555	1680	1240	2730	2010	¹ in-tpi = nominal thread diameter in inches-threads per inch ² N-m = newton-meters ³ lbs-ft= pounds-foot ⁴ mm x pitch = nominal thread diameter in millimeters x thread Pitch						
1 3/8" – 6NC	890	655	1990	1470	3230	2380							
1 3/8" – 12NF	1010	745	2270	1670	3680	2710							
1 1/2" – 6NC	1180	870	2640	1950	4290	3160							
1 1/2" – 12NF	1330	980	2970	2190	4820	3560							

*Torque tolerance +0%, -15% of torquing values. Unless otherwise specified use torque values listed above

*Torque tolerance +0%, -15% of torquing values. Unless otherwise specified use torque values listed above