



INSTALLATION MANUAL COMPLETE SOFT SIDE CAB KIT (77700-12652) KUBOTA RTV520

(Not for use on RTV500)

These instructions are for installation of the complete cab as well as the modular components.

CALIFORNIA PROPOSITION 65



WARNING:

Cancer and reproductive harm - www.P65Warnings.ca.gov

BEFORE INSTALLING CAB

- Read all instructions and safety instructions in this manual.
- Refer to your machine's operator's manual and safety instructions on your machine's safety decals.
- Wear appropriate personal protective equipment (PPE) when performing work.
- Hang a **"DO NOT OPERATE"** tag in operator station.



WARNING

To avoid personal injury or death:

- Cabs, blades, and general accessories add additional weight to the base vehicle. Deduct the accessory's total weight from the vehicle's rated capacity including passenger and driver. Never operate the vehicle outside of its rated weight capacity.
- Exposure to Carbon Monoxide can cause illness, serious injury, or death. Never operate vehicle if suspicious of Carbon Monoxide. Inspect exhaust system for leaks monthly. Leaks can result from loose connections, corrosion, cracks, or other damage to the exhaust manifold. If leaks are found, repair or replace exhaust system. Do not use vehicle until repair or replacement is complete.
- This cab does not provide protection from: a rollover (or other accidents), from flying objects (including golf balls), or from lightning. When lightning threatens, take cover and do not operate vehicle.

Estimated assembly time: 2 hours (excluding any accessories)



■ PARTS LIST

Ref. No.	Part No.	Part Name	QTY	REMARKS
1	77700-02492	ROOF (INCLUDES EDGE TRIM)	1	Code No.: KB5SS-01
2	70000-01050	TRIM-LOK EDGE TRIM	1	Code No.: 9PR01-220 (220")
3	77700-02493	WINDSHIELD SUPPORT	1	Code No.: KB5SS-03
4	77700-01056	EXPAND-A-FOAM	1	Code No.: 9PR30 (29")
5	77700-02494	REAR ROOF SUPPORT	1	Code No.: KB5SS-04
6	77700-02495	WINDSHIELD ASSEMBLY	1	Code No.: KB5SS-02
7	77700-02496	WINDSHIELD (HARD COATED PC ONLY)	1	Code No.: PCQ-47X38
8	70000-01040	WINDSHIELD HINGE	2	Code No.: 9PH007 (1 PC.)
9	77700-02497	WINDSHIELD HINGE SPACER BLOCKS (SHORT)	2	Code No.: 9BLK01-S (SET OF 2)
10	77700-01048	5/8" BULB RUBBER	1	Code No.: 9PR02 (170")
11	70000-01041	3/4" SIDE BULB RUBBER	1	Code No.: 9PR17 (130")
12	77700-01021	LATCHES	1	Code No.: 9RFL (SET OF 2)
13	77700-02498	GAS SPRING	1	Code No.: 9GS01 (SET OF 2)
14	77700-02499	REAR VINYL CURTAIN	1	Code No.: KB5SS-06
15	77700-01059	BUSHINGS	1	Code No.: T-KB5BUSH (SET OF 4)
16	77700-02500	HARDWARE KIT (FOR CAB)	1	Code No.: KB5SS-HWK
17	77700-01052	HARDWARE KIT (NEW HARDWARE FOR WS)	1	Code No.: KU500WS-HWK
18	77700-12811	RTV 520 SS CAB INSTALL INSTRUCTIONS	1	Code No.: 9SV-IM-KUB520SS (NSS)

NSS: Not sold separately

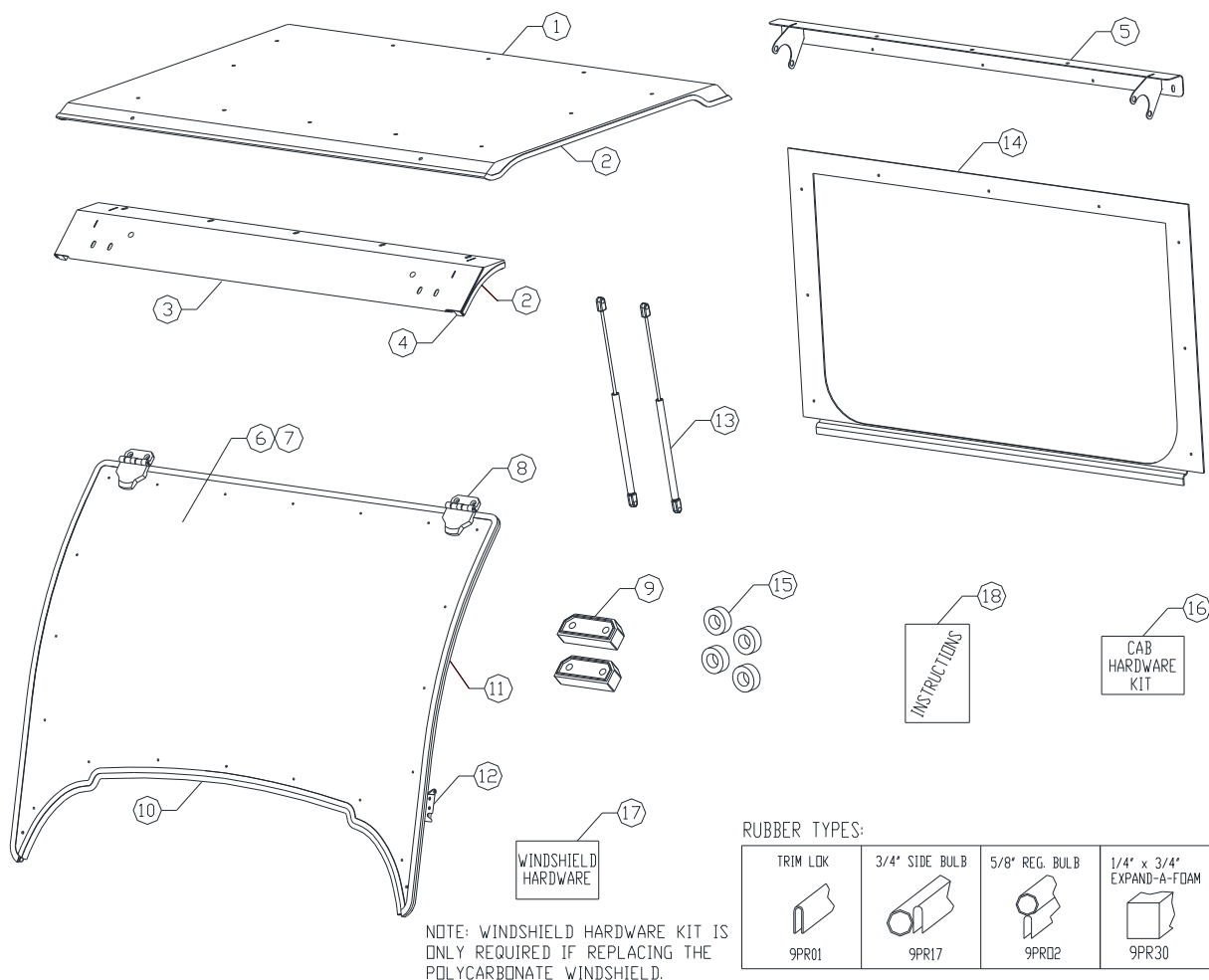

■ PARTS LIST

Ref. No.	Part No.	Part Name	QTY	REMARKS
1	77700-02501	DOOR - DRIVER'S SIDE (FULL ASSEMBLY)	1	Code No.: KB5SS-Q7L
2	77700-02502	DOOR - PASSENGER'S SIDE (FULL ASSEMBLY)	1	Code No.: KB5SS-Q7R
3	77700-02503	DOOR SKIN - DRIVER'S SIDE	1	Code No.: KB5SSDS-L
4	77700-02504	DOOR SKIN - PASSENGER'S SIDE	1	Code No.: KB5SSDS-R
5	70000-01018	OUTSIDE LOCKING DOOR HANDLE W/ KEYS	2	Code No.: 9DL01C (1 PC)
6	77700-02505	3/4" SIDE BULB W/ 1/4" GRIP	2	Code No.: 9PR38 (180")
7	70000-01017	INSIDE ROTARY DOOR LATCH, RIGHT	1	Code No.: 9DL01B (USED ON LEFT DOORS)
8	70000-01016	INSIDE ROTARY DOOR LATCH, LEFT	1	Code No.: 9DL01A (USED ON RIGHT DOORS)
9	77700-02506	DOOR STOP CABLE	2	Code No.: 9DS02 (SET OF 2)
10	77700-01032	LOW PROFILE HINGE SET	1	Code No.: 9HSLP (4 HINGES)
11	77700-12810	HINGE PLATE- DRIVER'S SIDE W/ HINGE SLEEVES	1	Code No.: 8SV-110-00109-L
12	77700-02508	HINGE PLATE- PASSENGER'S SIDE W/ HINGE SLEEVES	1	Code No.: KB5SS-10R
13	77700-02509	FRONT LEG - DRIVER'S SIDE W/ PINS,BALL STUD	1	Code No.: KB5SS-Q8L
14	77700-02510	FRONT LEG - PASSENGER'S SIDE W/ PINS,BALL STUD	1	Code No.: KB5SS-Q8R
15	77700-01033	STRIKER PIN	1	Code No.: 9DL01D-H (SET OF 8)
16	77700-01022	LATCH PIN	1	Code No.: 9YR001-01 (SET OF 5)
17	70000-01024	BALL STUD	2	Code No.: 9GS02A (1 PC.)
18	77700-01048	5/8" BULB RUBBER	1	Code No.: 9PR02 (180")
19	77700-02511	ROPS HIP RESTRAINT U-CLAMPS	1	Code No.: SM-KB5TMT (SET OF 2)
20	K7561-65412	DECAL: RELOCATION OF FACTORY ROPS DECAL	1	Code No.: K7561-65412
21	77700-12001	DECAL: RESTRICTION PLATE	1	Code No.: 9SV-9DL-272

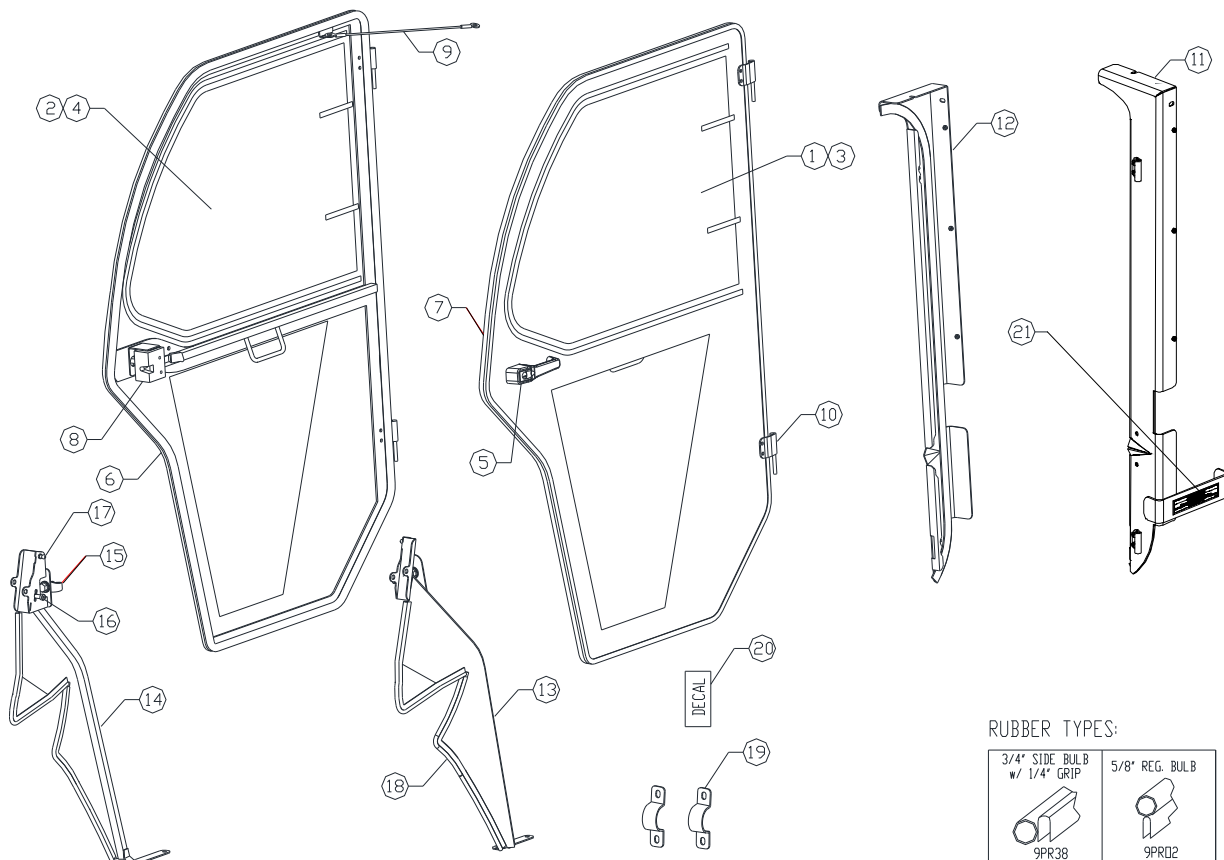

**SAFETY INFORMATION:**

WARNING: Cabs add additional weight to the base vehicle. Deduct the accessory's total weight from the vehicle's rated capacity including driver and passenger. Never operate the vehicle outside of its rated weight capacity.



WARNING: Exposure to Carbon Monoxide can cause illness, serious injury or death. Never operate vehicle if suspicious of Carbon Monoxide. Inspect exhaust system for leaks monthly. Leaks can result from loose connections, corrosion, cracks or other damage to the exhaust manifold. If leaks are found, repair or replace exhaust system. Do not use vehicle until repair or replacement is complete.

**WARNING: Serious injury or death:**

This cab enclosure does not provide protection from rollover or other accidents.

This cab enclosure does not provide protection from flying objects including golf balls.

This cab enclosure does not provide protection from lightning. When lightning threatens, take cover and do not operate vehicle.

SAFETY LABELS:

Safety Label Location:

See the illustrations on the following page for complete text of safety label message:

1) WARNING - K7561-65412

2) Decal: OHSA ROPS serial number

NOTICE: The ROPS (Roll-Over Protective Structure) serial number label is covered by the cab and may be viewed by removing the rear panel.

3) WARNING - 77700-12001

SAFETY LABEL LOCATION:

Note: for best adhesion, apply to a clean, dry surface at room temperature.

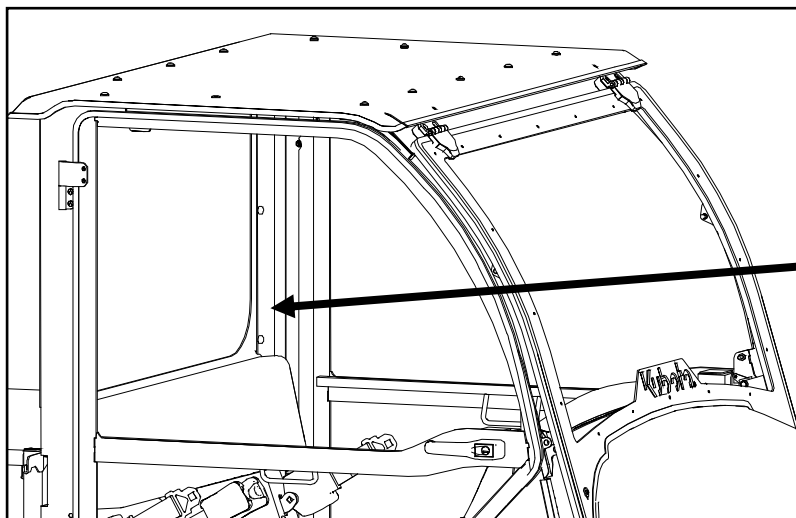

1) WARNING - K7561-65412

SAFETY LABEL LOCATION CONTINUED:

Note: for best adhesion, apply to a clean, dry surface at room temperature.

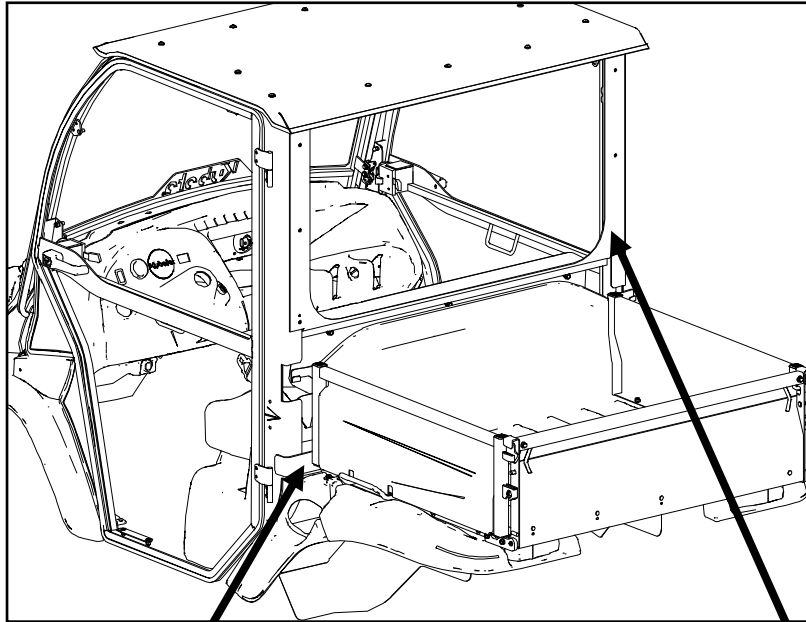

WARNING:

To Prevent Serious Injury or Death.
This cab has been tested and approved for the RTV520 only.
Use of this cab on other models could result in excessive carbon monoxide exposure.
Do not remove or alter this tab.

77700-12001

3) WARNING - 77700-12001

KUBOTA
Manufacturing of
America Corp. Gainesville GA.

Machine Model No.
RTV500 / RTV400ci / RTV520

ROPS MODEL
No.
SFRTV-5

XXXXXX

ROPS Gross Machine Weight
2314 lbs. (1050 kg)

ROPS meets requirements of
*OHSA Part 1928.52
*SAE J1124

2) Kubota ROPS serial number

CAB INSTALLATION BEFORE YOU START

HELPFUL REMINDERS:

- Refer to the parts diagram towards the back of each section to help identify parts during the assembly process.
- To assist with the cab installation, leave all bolts loose for later adjustment unless otherwise specified.
- Read and understand all instructions before beginning.
- Use caution to avoid damaging the factory installed weld nuts or threaded inserts. Begin the bolt engagement by hand to avoid or correct potential cross threading.

TOOLS REQUIRED:

Set of standard and metric sockets
3/8" Drive Ratchet
Set of standard and metric open-end wrenches
Set of allen wrenches
Needle Nose Pliers
Phillips Head Screwdriver

■ ASSEMBLY PROCEDURE



CAUTION

To avoid personal injury:

- Park the machine on a firm and level surface.
- Apply the parking brake.
- Stop the engine and remove the key from the machine.

NOTE:

- **All assembly procedures listed within this manual are generally representative of the machine model for which the manual is written.** Your machine may be configured differently, but the outline for the procedure should still be followed. For further support for any issues not covered within the pages of this manual, please contact your local Kubota representative.

1. Per fig. 1, remove and save the four bolts and washers holding the front cross member. Align the windshield support as shown in figure 1 and re-install the bolts. Start thread engagement by hand to avoid cross threading the weldnuts. Tighten the bolts making sure that the windshield support is pushed down and back so that it is as tight to the ROPS (Roll Over Protective Structure) frame as possible. Torque the four bolts to 48-55 N-m, 36-41 ft-lbs, or 4.9 to 5.7 kgf-m.

2. Per fig. 2, remove and save the four bolts and washers holding the rear cross member. Align the rear roof support as shown in fig. 2 with the rear curtain snaps along the back and re-install the bolts. Start thread engagement by hand to avoid cross threading the weldnuts. Tighten the bolts making sure that the rear roof support is pushed down and forward. Torque the four bolts to 48-55 N-m, 36-41 ft-lbs, or 4.9 to 5.7 kgf-m.

3. Remove and discard the two original equipment bolts and nuts from the front ROPS tubing as well as the two front pine tree clips holding the outer edge of the rubber floor mat. New bolts, nuts, and steel bushings are provided. Have the following hardware ready: two 3/8-16 x 1-3/4" long button head bolts, two steel bushings, and two 3/8" locknuts. Per fig. 3.1, orient and install the front leg on the driver's side as follows: the steel bushings are to be installed in the upper outside cavity and the lower inside cavity. These are to fill voids and support the ears on the front mount. Install the new nuts into the open cavities. Install the new bolts through the ears of the front mount, through the steel bushings, through the ROPS tubing and engage into each of the locknuts as shown in fig. 3.2. Leave the bolts loose at this time.

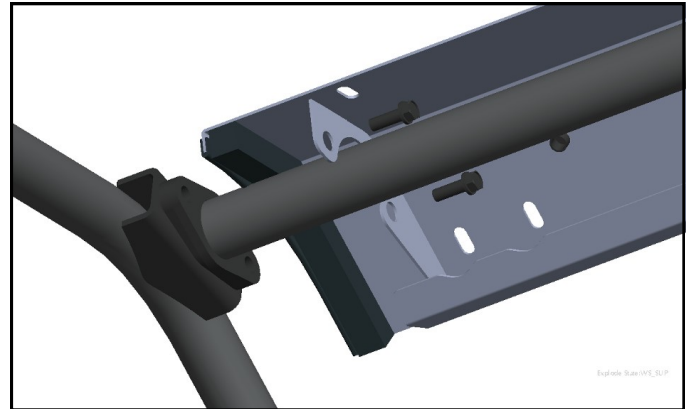

Fig. 1 (install windshield support)

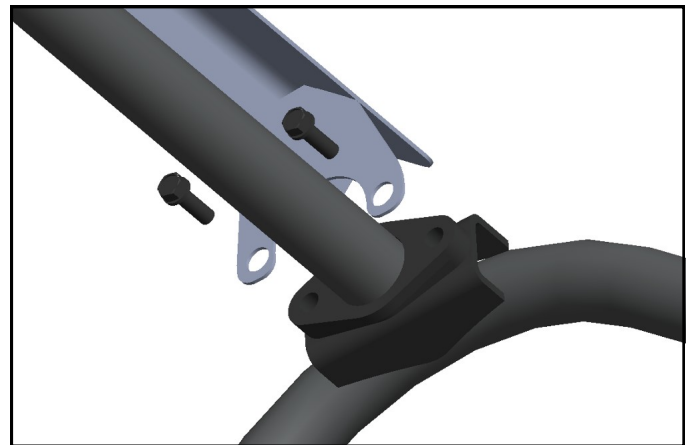

Fig. 2 (install rear roof support)

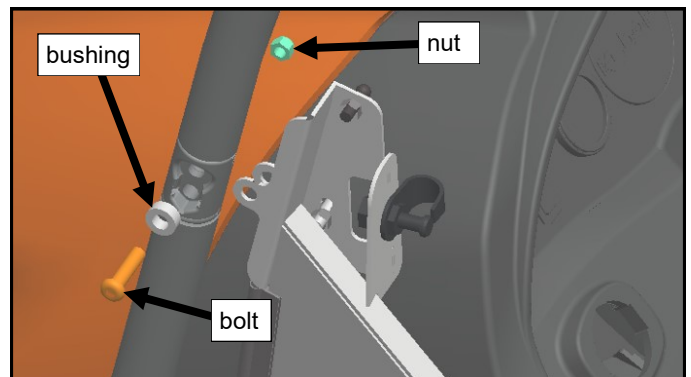

Fig. 3.1 (install front bolts)

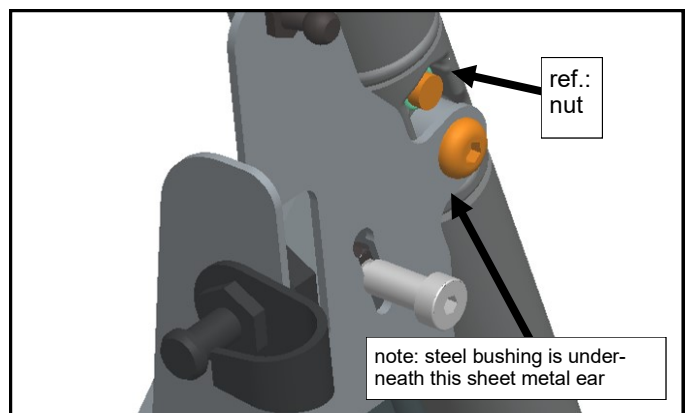

Fig. 3.2 (install front bolts)

■ ASSEMBLY PROCEDURE

4. Per fig. 4, install two 1/4-20 Truss head Phillips bolts through the floorboard where the pine tree clips were removed. Secure using two 1/4" washers and two locknuts and tighten.

5. Repeat steps 3 and 4 for passenger's side. Torque the four (2/side) 3/8" front mount bolts to 48-55 N-m, 36-41 ft-lbs, or 4.9-5.7 kgf-m.

6. Per fig. 6.1, align the rear hinge plate on top of the rear roof support. Attach the top of the rear hinge plate from the back with one 5/16-18 x 1" bolt, one 5/16" nylon washer, two 5/16" steel washers, and a 5/16" nut. Install in the order shown in Figure 6.2. Install the bolt so that the head is on the back side and the nut on the inside. Do not tighten at this time.

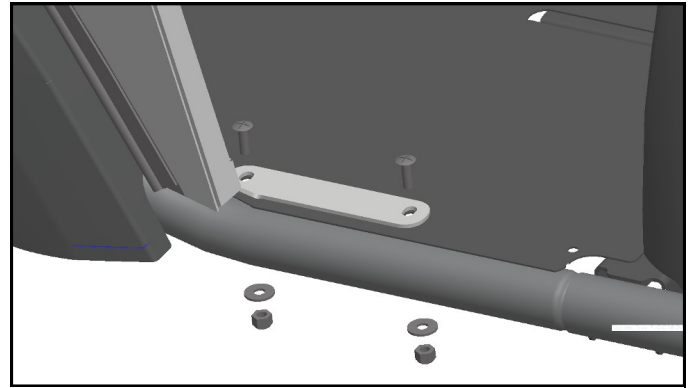

Fig. 4 (install floorboard bolts)

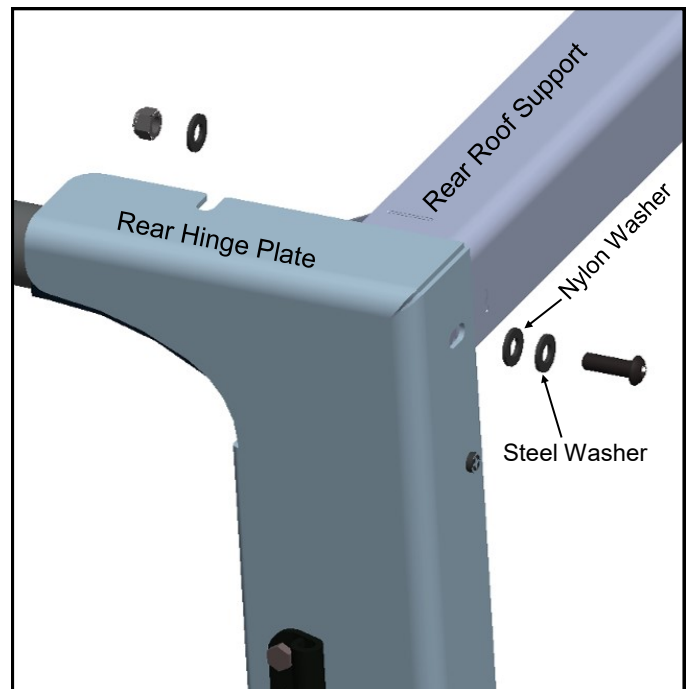

Fig. 6.1 (install upper rear bolt)

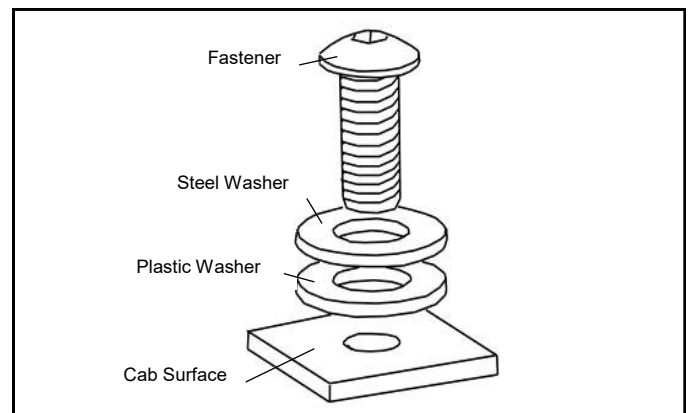

Fig. 6.2 (washer order)

■ ASSEMBLY PROCEDURE

7. Per fig. 7.1, install the U-clamp using two 5/16-18 x 1" bolts, two 5/16" nylon washers, four 5/16" steel washers, and two 5/16" nuts. Be sure to orient the U-clamp so that the angle of the clamp is aligned with the angle of the ROPS hip restraint tube that it fastens to. Install the bolts from the outside. Make sure to push the hinge plate completely forward so that it is touching the rear of the ROPS tube and tighten the two bolts for the U-clamp and the bolt from step 7.1 at this time. Repeat for the passenger side.

NOTICE: The Restriction Plate on the Rear Hinge Plate per fig. 7.2 (Driver's side only) is designed to prevent assembly onto the RTV 500. Do not remove or alter this plate.

8. Per fig. 8.1, loosen the two silver striker pins that are on the front legs so that they can slide up and down in the slot. Per fig. 8.2, loosen the two latches on the windshield so that they can slide forward and backwards in the slots.

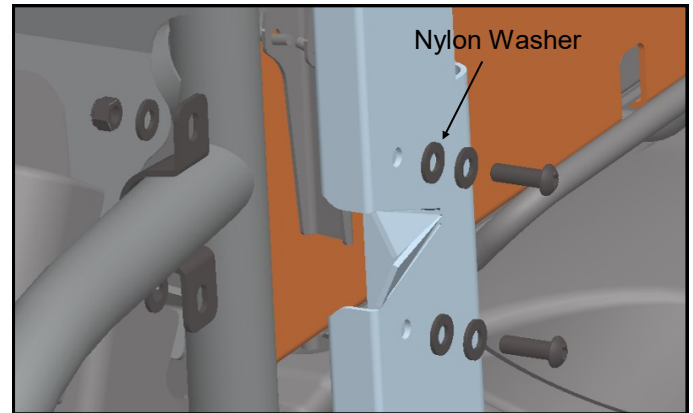

Fig. 7.1 (install u-clamp)

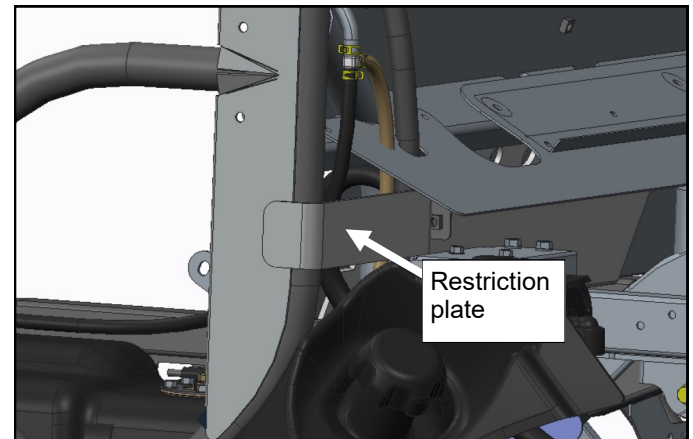

Fig. 7.2 (restriction plate)

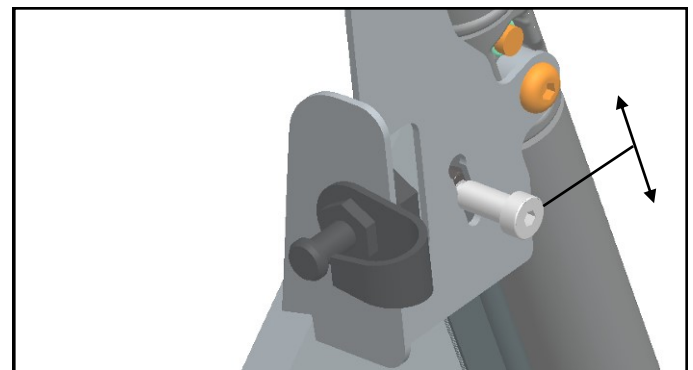

Fig. 8.1 (loosen latch pins)

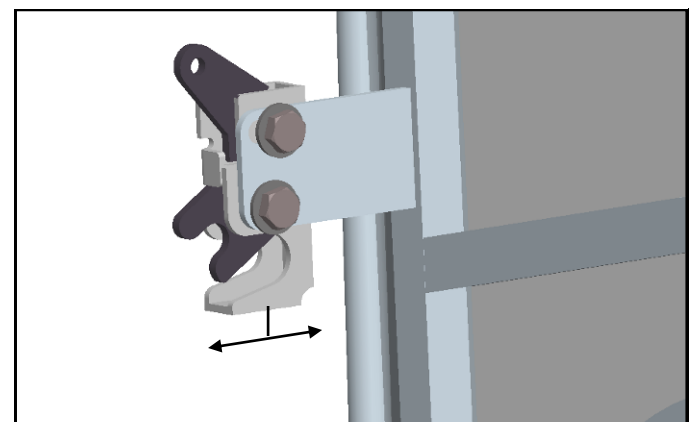

Fig. 8.2 (loosen windshield latches)

■ ASSEMBLY PROCEDURE

9. Per fig. 9, attach the windshield to the windshield support using four 5/16-18 x 1 3/4" long flat head bolts, four 5/16" steel washers, and four 5/16" locknuts. Be sure to sandwich the hinge spacer block under the hinge. Do not tighten the bolts at this time.

10. Engage the two lower latches onto the pins so that two audible clicks can be heard ensuring that the latches are fully seated. Push the windshield down so that it is sealed to the hood. Orient the latch so that it is in line with the windshield tubing similar to what is shown in fig. 8.2, tighten the two bolts making sure that the sides of the windshield are sealed as well as the hood. Tighten the pin at this time. Once the bottom of the windshield is adjusted, tighten the hinge bolts. **Caution:** use care when tightening any flat head screw in countersunk holes in plastic components to avoid cracking. **Torque to 7 ft.-lbs. max.**

11. After the windshield is properly adjusted, release the two bottom latches and open the windshield. Attach the two gas springs so that the thin rod end is fastened to the ball stud on the front leg.

12. Per fig. 12, attach a length of 1/2" weatherseal along the top of the ROPS bar on both sides between the windshield support and the rear roof support. Be sure that the ROPS is clean and dry and at room temperature before adhering the weatherseal.

13. Using a screwdriver, puncture the headliner at each hole location from the inside out to allow the bolt to pass through. Attach the roof to the supports using ten 5/16-18 x 1" button head bolts, twenty 5/16" steel washers, ten 5/16" nylon washers, and ten 5/16" lock nuts. Note: there will be two holes left open at this time that are shown in fig. 14.1.

14. Per figures 14.1 and 14.2, install the bolt for the door stop cable (one per side of roof) as shown. Use the following hardware per side: one 5/16-18 x 1 1/4" long button head bolt, two steel washers, one plastic washer, and two locknuts. With the roof oriented as shown (with the headliner down), install one steel washer and one plastic washer on to the bolt. Feed the bolt through the sheet metal and through the foam headliner. Install the second steel washer and one locknut. Tighten the locknut. Install one end of the door stop cable onto the bolt. Install the second locknut, but do not tighten it up against the door stop cable. There should be a small intentional gap so the cable can rotate freely. Repeat in the last remaining roof hole.

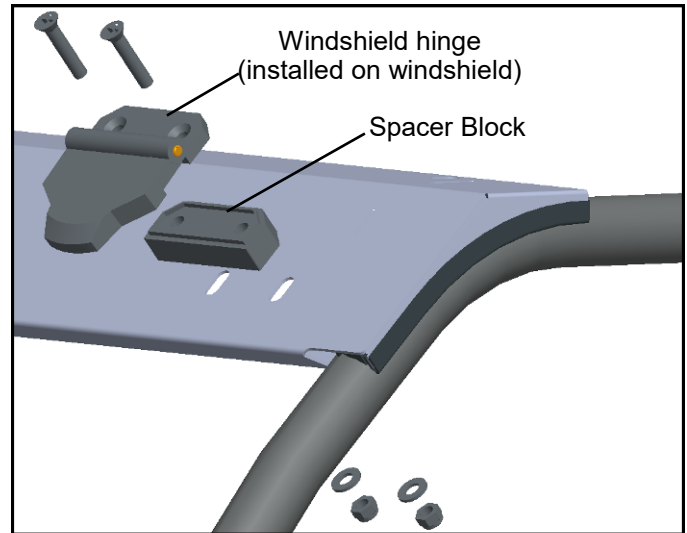

Fig. 9 (attach windshield)

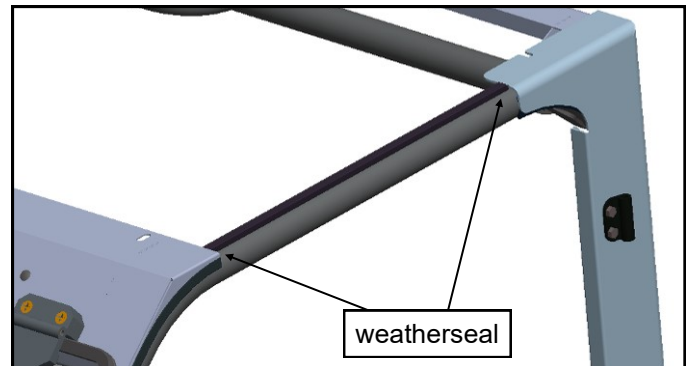

Fig. 12 (apply weatherseal)

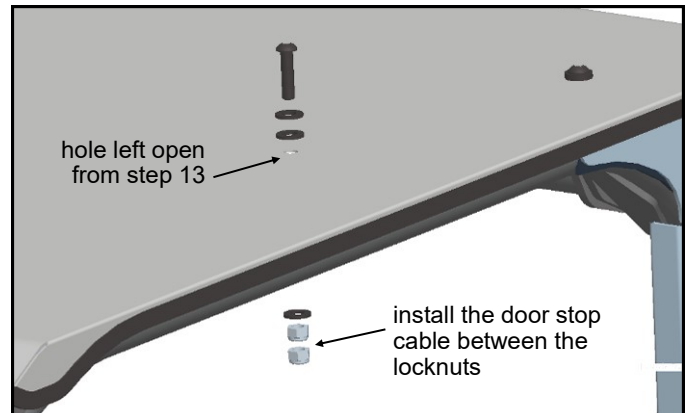

Fig. 14.1 (install door stop cable bolt)

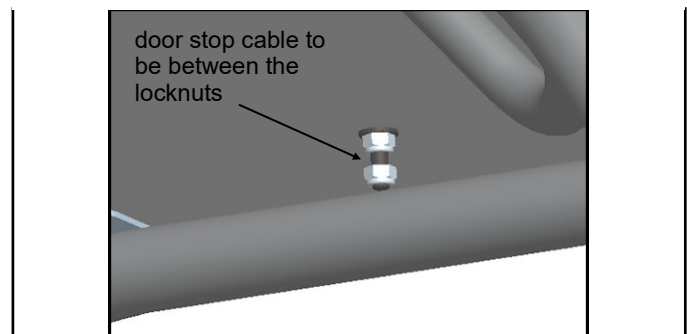

Fig. 14.2 (gap between nuts)

■ ASSEMBLY PROCEDURE

15. Apply Velcro to the rear roof support above the snaps to match the rear panel. Velcro should only be applied to clean dry surfaces at room temperature. Apply Velcro down each rear leg as well to match the rear panel. A strip of Velcro should also be applied along the outside lip across the back of the seat. Snap the rear panel into place and secure the perimeter to the Velcro.

16. Per fig. 16, install the supplied ROPS decal to the inside surface of the rear driver's side ROPS tubing as shown. Apply to a clean, dry surface at room temperature.

17. Apply grease to the door hinge pins.

18. Insert the hinge pins on the doors into the sleeves on the vehicle. Slowly close the door. Adjust the striker pin vertically in the slot if necessary. If contacting the top or bottom of the striker pin, adjust the pin in the slot to avoid excessive pin wear. The latch can also be moved forward and backwards to catch on the center of the pin. Two audible clicks should be heard when the latch is engaged fully. If more adjustment is required, loosen the hinge pins and adjust them as well. The hinge pins should be in-line with each other when a straight edge is placed against the back of them.

19. Connect the free end of the door stop cable to the door. Leave it slightly loose so that the cable may rotate freely.



Fig. 16 (view of driver's side rear ROPS tube)

Troubleshooting the door

<u>Condition:</u>	<u>Explanation/Solution</u>
Latch and pin does not line up (up and down)	Move pin up or down. Loosen hinges and lower or raise the front of the door.
Latch and pin does not line up (front to back)	Move latch forwards or backwards. Loosen hinges and move door forwards or backwards.
Door does not seal	Carefully bend steel frame of door.

CARE AND MAINTENANCE

(IMPORTANT: Be sure to leave this page with the owner once installation is complete)

Check and tighten hardware after 20 hours of operation.

Periodically inspect and tighten hardware for the remainder of the unit's service life.

IMPORTANT CLEANING INFORMATION

Keep the enclosure components clean in order to prevent dust and dirt from forming an unattractive film. The life of your windows, doors, and roof panels depends upon following these care procedures:

WINDSHIELD:

- 1) **NEVER USE** AN ALCOHOL-BASED PRODUCT FOR CLEANING PLASTIC WINDOWS. Many brand-name glass cleaners contain alcohol that will result in deterioration of the windows.
- 2) Wash with a mild soap or detergent using your bare hands to free or dislodge any caked-on dirt or other foreign particles.
- 3) A soft, grit-free cloth, sponge, or chamois may be used but only as a means of carrying water to the windows.
- 4) The interior should be lightly dusted (NOT WIPED) with a clean soft cloth or chamois. The cloth or chamois should be kept free of grit by frequent rinsing in clean water.
- 5) Grease and oil may be removed with kerosene.

DOORS AND REAR PANELS:

- 1) **NEVER USE** AN ABRASIVE DETERGENT/VEHICLE CLEANER OR A WIRE BRISTLED BRUSH. Do not use any **CITRUS BASED CLEANERS** such as orange or lemon. Use of these products will cause the plastic to become permanently damaged.
- 2) Clean the enclosure surfaces thoroughly with warm soapy water and a COTTON cloth or chamois. Be sure to use mild soap, specifically a dish liquid or equivalent. Clean in a light circular motion for best results.

This manual is the property of the owner.
Be sure to leave with the owner when installation is complete.