



John Deere Gator TS Canopy
p/n: 1CT2A

An optional windshield may be purchased for use with the canopy (p/n: 1WS1A)

The contents of this envelope are the property of the owner.
Be sure to leave with the owner when installation is complete.

APPROXIMATE INSTALLATION TIME: 1 HOUR

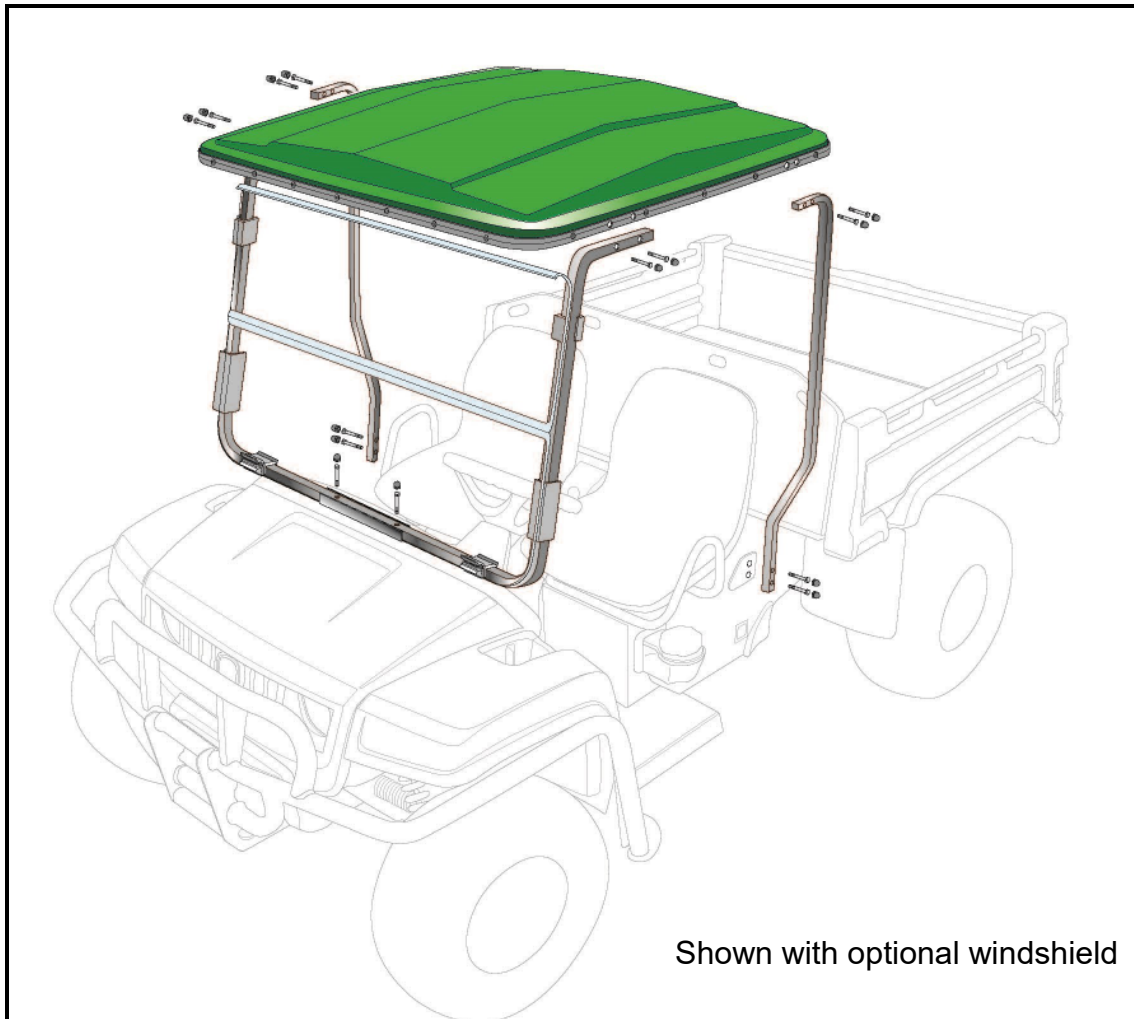

Shown with optional windshield

PARTS IN KIT

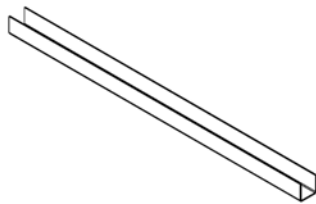

JG21C
Front Support Channel

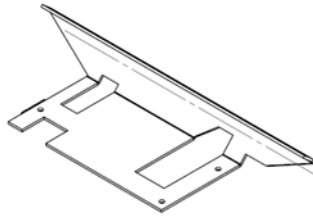

JG21B
Front Bracket

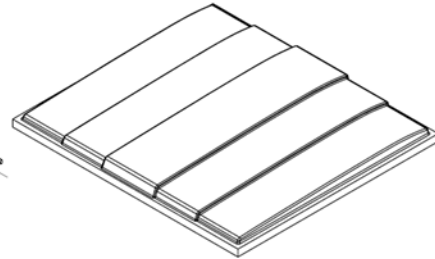

JG21GC
Canopy

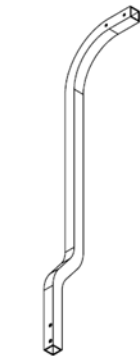

JG21D
Driver's Side
Rear Support

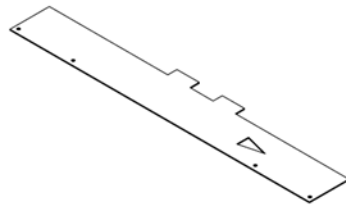

Template

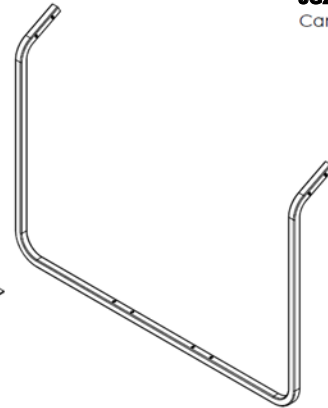

JG21F
Front Support



JG21P
Passenger's Side
Rear Support

JG21H



2 - Rear
Support Gaskets

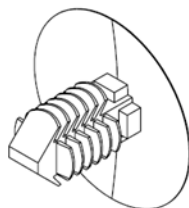

2 - Christmas
Tree Plugs

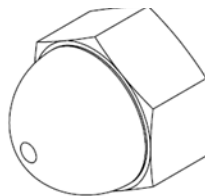

2 - Acorn Nuts

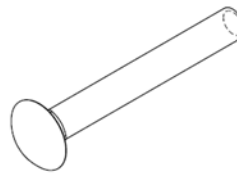

2 - 5/16"-18 x 2.5"
Carriage Bolts

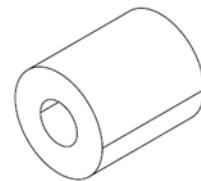

2 - Aluminum Spacers



8 - 1/4" Lock
Washers



11 - 1/4" Flat
Washers



4 - 5/16" Sealing
Washers



8 - 3/8" Sealing
Washers

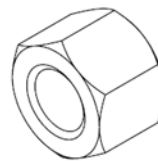

3 - 1/4"-20
Lock Nuts

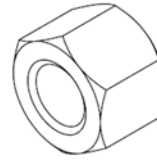

2 - 5/16"-18
Lock Nuts

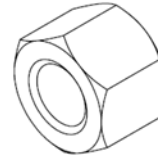

4 - 3/8"-16
Lock Nuts

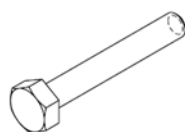

3 - 1/4"-20 x 1.75"
Hex Head Bolts

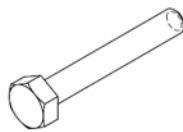

4 - 3/8"-16 x 2.5"
Hex Head Bolts

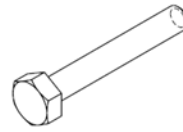

4 - 1/4"-20 x 2" Hex Head
Bolts with Loctite

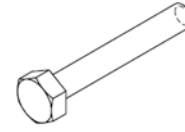

4 - 1/4"-20 x 1.5" Hex Head
Bolts with Loctite