



**Mahindra 1626
Cab with Heater (p/n: 1MA1626CA)
fits tractor models: 1626 (also fits 1526 with adapter)**

While this cab kit was designed to fit on the vehicle(s) listed above, manufacturing tolerances and vehicle assembly may affect cab fitment. It is the responsibility of the cab installer to check all vehicle pedals and levers for full functionality and, as required, adjust the cab fitment to prevent any interference of the cab components with the travel of pedals or levers.

Shown with front windshield wiper
(comes standard with cab)



Available Options:

1. Front LED Work Lights (P/N: 9LEDW4)
2. Rear LED Work Lights (P/N: 9LEDW3)
3. Strobe Light (P/N: 9LEDS2)
4. Dome Light (P/N: 9LEDD14)
5. Side View Mirrors (P/N: 9PM5)
6. Rear View Mirror (P/N: 9PM3)
7. Rear Wiper (P/N: 9PWK8512F9-11A)
8. Seal Kit (P/N: 9SK4)
9. 1526 Adapter Kit (P/N: 1MA1526AK)



**See video
for heater
and wiring
installation
tips.**

Approximate Installation Time *
Experienced Dealer Technician – 7 Hours
Average Dealer Technician – 9 Hours
Do-It-Yourself – 11 Hours

(*Including the heater installation)

Approximate Product Specifications
Floorboard to Roof Height: 59.5 inches
Weight: 315 lbs.
Cab Width: 49.375 inches

The contents of this envelope are the property of the owner. Leave with the owner when installation is complete.

MAHINDRA 1626 CAB SERVICE PARTS

ROOF ASSEMBLY
P/N: 8SV-101-00040

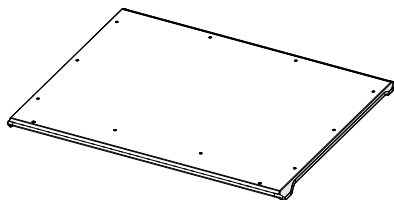

WINDSHIELD ASSEMBLY, 45.75" X 27"
P/N: 8SV-102-00022

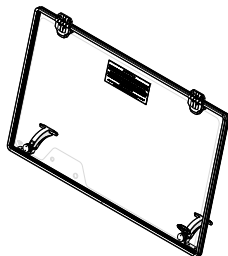

WINDSHIELD SUPPORT
P/N: 8SV-103-00014

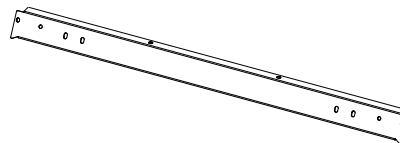

PLASTIC COWL ASSEMBLY
P/N: 8SV-105-00020

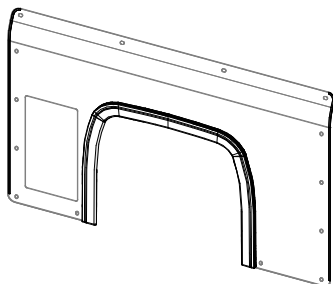

GLASS REAR PANEL LIFT OFF,
26.75 X 23.25, 3/16" THICK
P/N: 8SV-106-00023

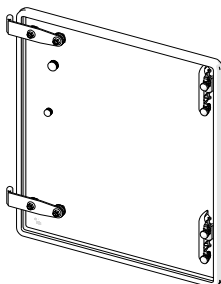

DOOR ASSEMBLY, LEFT
P/N: 8SV-107-00033-L

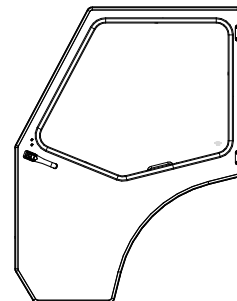

DOOR ASSEMBLY, RIGHT
P/N: 8SV-107-00033-R

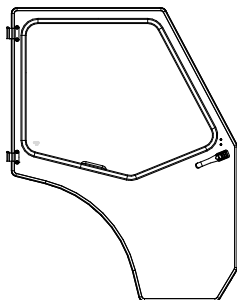

REAR LEG ASSEMBLY, LEFT
P/N: 8SV-108-00017-L

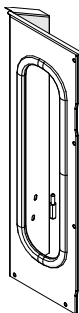

REAR LEG ASSEMBLY, RIGHT
P/N: 8SV-108-00017-R

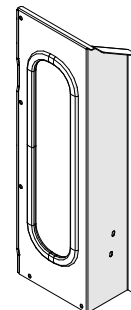

SIDE FRAME ASSEMBLY, LEFT
P/N: 8SV-109-00015-L

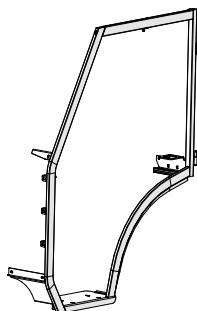

SIDE FRAME ASSEMBLY, RIGHT
P/N: 8SV-109-00015-R

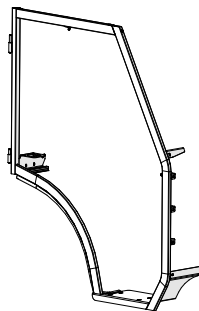

ROPS BRACKET ASSEMBLY
P/N: 8SV-110-00056

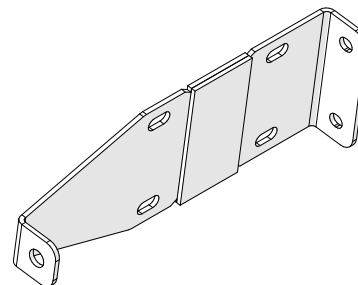

MAHINDRA 1626 CAB SERVICE PARTS

ROPS CLAMP ASSEMBLY
P/N: 8SV-110-00057

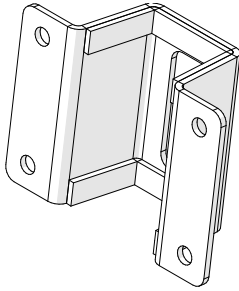

UPPER REAR PANEL
P/N: 8SV-111-00024

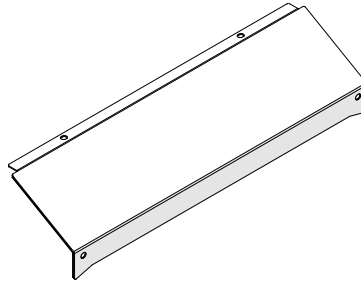

UNDERSEAT FILLER ASSEMBLY
P/N: 8SV-112-00036

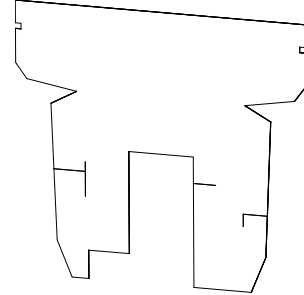

METAL COWL
P/N: 8SV-SM-01285

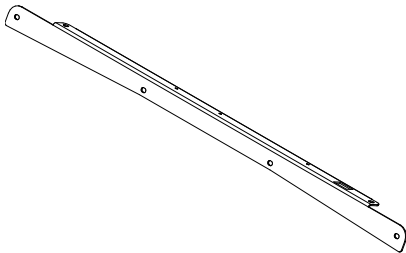

DOOR WINDOW WITH RUBBER
P/N: 8SV-9GL-00054

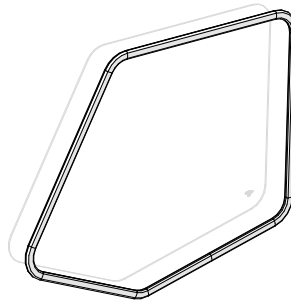

REAR LOWER CROSS
P/N: 8SV-SM-01256

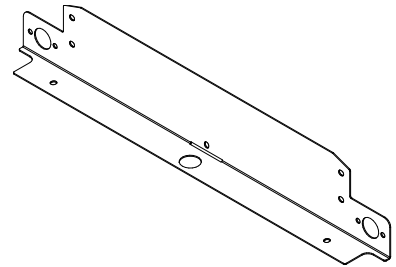

LOWER ROPS BRACKET
P/N: 8SV-SM-01262

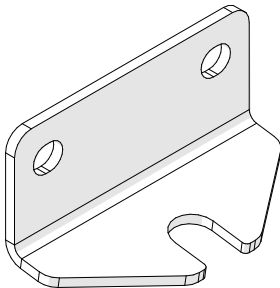

GLASS HINGE SLEEVE WITH
MOUNTING HARDWARE
P/N: 8SV-PL-00021

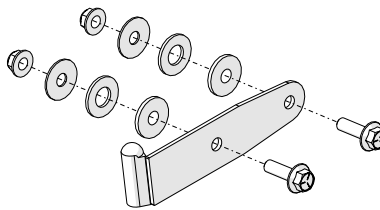

HEATER BRACKET
P/N: 8SV-SM-01275

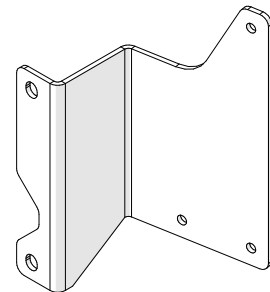

COWL VINYL FILLER
P/N: 8SV-V-00032

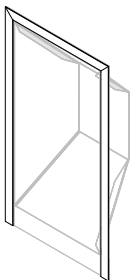

VINYL FILLER MOUNTING
BRACKET
P/N: 8SV-SM-01472

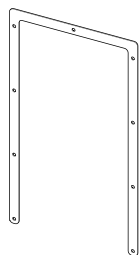

SMV SIGN RELOCATION
BRACKET
P/N: 8SV-110-00064

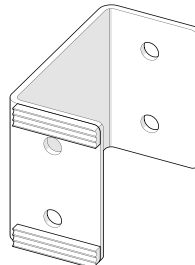



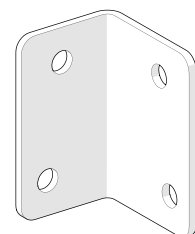

TOOLBOX RELOCATION
BRACKET
P/N: 8SV-SM-01477

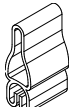

ADDITIONAL SERVICE PARTS

PART NUMBER	DESCRIPTION
8SV-P-00100	REAR LEG WINDOW WITH RUBBER
9SV-DP11	DOME PLUG 1/2" (BAG OF 10)
9SV-DP10	DOME PLUG 3/8" (BAG OF 10)
9SV-HWS	WINDSHIELD HINGE KIT
9BLK01	WINDSHIELD HINGE BLOCK SPACER, TALL STYLE, 3/4" THICK
9PWM110	WIPER MOTOR, 110 DEGREE
9PWB20-FB	WIPER BLADE, 20", FLEX
9PWA14-16	WIPER ARM, ADJUSTABLE LENGTH (11" - 16")
9PWK-HB	GLASS MOUNTING KIT FOR WIPER SYSTEMS
9SV-DSTRH	DOOR STRIKER KIT-INCLUDES CASE HARDENED STRIKER BOLT
9SV-IHRL	INSIDE HANDLE ROTARY LATCH KIT (INCL. L & R)
9SV-OHRL	OUTSIDE HANDLE ROTARY LATCH KIT (SET OF 2)
9SV-9PHW010-W	HINGE WASHER, KIT (SET OF 4) OD .635, ID .41, THK .08
9SV-9CUP02	CUP HOLDER, 3.75" DIAM. X 3.25" TALL
9PI01	POLY INSERT 1", 14-20 GA BLK MATTE, INSERT FINES .94/.95 (QTY.: 1)
9PI02	POLY INSERT 3/4", 14-20 GA BLK MATTE FINISH, INSERT FINES 0.69 (QTY.: 1)
9SV-WL1	WINDSHIELD LATCH KIT 1, POPS OPEN W/S FOR VENTING ONLY
8SV-WL3	WINDSHIELD LATCH & BRKT ASS'Y. SGL POST (SET OF L&R)
9SV-9HR04	THICK PANEL SNAP BUSHINGS, .937ID X 1.093OD (SET OF 2)
9SV-9HR0005	TEE FITTING, 1-1/8" x 1-1/8" x 5/8"
9SV-9HR0099	3/8 X 5/8 HOSE BARB, M16X1.5 THREAD
9SV-9HR00601.0	HOSE CLAMPS #10 (1") (QTY.: 6)
9SV-9HR00601.5	HOSE CLAMPS #16 (1.5") (QTY.: 2)
9SV-UHTRILV	UNIVERSAL HEATER IN-LINE VALVE (SET OF 2)
9SV-9HR0048	ROCKER SWITCH (HI-OFF-LOW)
9SV-9HR-L	REPLACEMENT LOUVER-15,000 & 20,000 BTU HEATER, KL47
8SV-9PH20WG	TUCK-AWAY HEATER WITH WIRED GROUND
9SV-HRH61-20	HEATER HOSE (5/8" I.D.)-20 FT
9PH20-2	FAN 120 x 120 x 38 12VDC 12W 3200 RPM
9SV-WH-00072	WIRING HARNESS POWER
8SV-WH-GF	WIRE HARNESS, GLASS FUSE
9DL01H	KEYS, SET OF 2 ON A RING, FOR HANDLE 1096-1, KEY CODE C40
8SV-HKWTB-L	HINGE KIT, TOP & BOT., LEFT
8SV-HKWTB-R	HINGE KIT, TOP & BOT., RIGHT

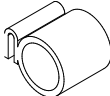
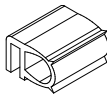
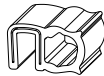
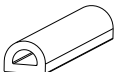
TRIM LOK, STD, 1/16" - 1/8" GRIP	5/8" STD BULB, 1/16" GRIP	1" FLAT BULB, 1/16" GRIP	ARCH PSA RUBBER	WINDOW RUBBER	1" SIDE BULB, 1/16" GRIP	3/4" SIDE BULB, 1/16" GRIP	3/4" SIDE BULB, 1/4" GRIP	ARCH PSA .2 X .15
								
9SV-PRO1-10	9SV-PRO2-15	9SV-PRO5-10	9SV-PRO9-10	9SV-PR10-10	9SV-PR16-10	9SV-PR17-20	9SV-PR38-15	9SV-PR53-15