

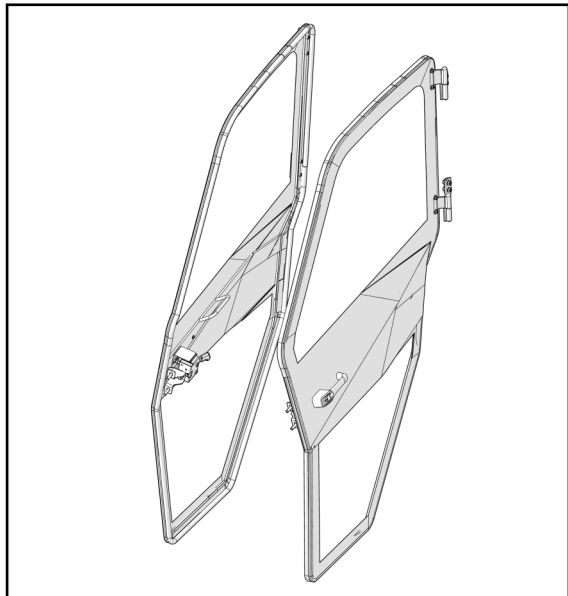

INSTALLATION & OWNER'S MANUAL

Polaris Ranger 1000 Door Kit
Kit p/n:1POLXP1000DR
Fits UTV Models:
POLARIS RANGER 900, XP 900, 1000
& XP 1000



Available Options:

- 1. Roof Kit (P/N: 1POLXP1000RF)
- 2. Windshield Kit (P/N: 1POLXP1000WS)
- 3. Rear Panel Kit (P/N: 1POLXP1000RP)
- 4. Front Wiper Kit (P/N 1POLXP1000WK)
- 5. Side View Mirrors (P/N: 9PM5)
- 6. Door Restraint Kit (P/N: 1POLXP1000GS)

Approximate Installation Time *
Experienced Dealer Technician – 30 minutes
Average Dealer Technician – 45 minutes
Do-It-Yourself – 60 minutes

Approximate Product Specifications
Weight: 56.5 lbs.
Cab Width: 61 inches

(*=Not including accessories)

Register your new product quickly online at Curtiscab.com/product-registration/



Curtis encourages all customers to register their Curtis products. However, failure to do so will not diminish right to warranty. Curtis Industries does not sell or share your information with anyone else.

Download a digital copy of your installation instructions online at Curtiscab.com/literature/



Curtis strives to continuously improve our products, technical documentation, etc. Therefore, the installation manual for this product may have been updated after your product was packaged. The latest revision of the installation manual can always be found at the website above.

The contents of this envelope are the property of the owner. Leave with the owner when installation is complete.

POLARIS RANGER 1000 DOOR KIT SERVICE PARTS

DOOR, LEFT
P/N: 8SV-107-00045-L

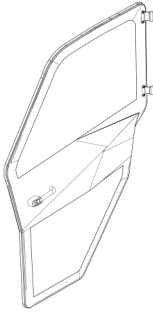

DOOR CURTAIN, LEFT
P/N: 8SV-112-00062-L

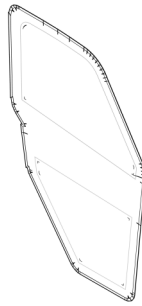

DOOR HINGES (SLEEVE)
P/N: 8SV-WA-00458-L & 8SV-WA-00458-R

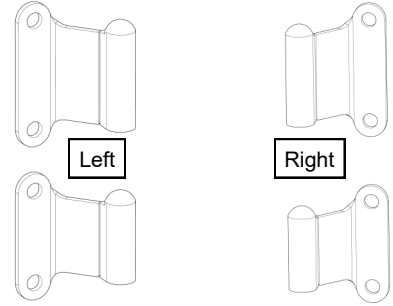

DOOR, RIGHT
P/N: 8SV-107-00045-R

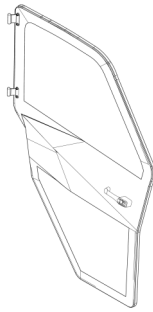

DOOR CURTAIN, RIGHT
P/N: 8SV-112-00062-R

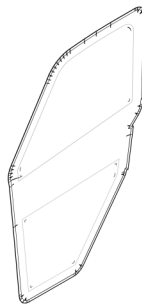

SET OF HINGE PIN MOUNTING PLATES (4)
P/N: 8SV-WA-00462

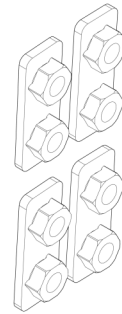

HINGE PIN SET, LEFT
P/N: 8SV-WA-00459-L

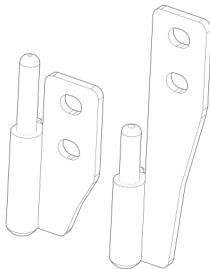

HINGE PIN SET, RIGHT
P/N: 8SV-WA-00459-R

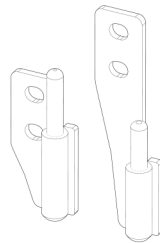

STRIKER PIN ASSEMBLY
P/N: 8SV-113-00250

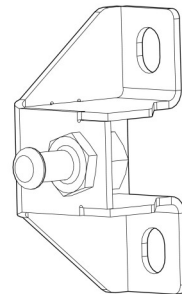

5/8" SIDE BULB
W/ 1/4" GRIP, 15'

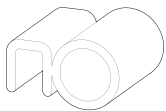

9SV-PR23-15