



YAMAHA DRIVE2 GLIDE & RIDE

Sandstone (p/n: 1VYDR2GR-SS)

Black (p/n: 1VYDR2GR-BK)

White (p/n: 1VYDR2GR-WT)

fits vehicle models:

Yamaha Drive Golf Cart

Yamaha Drive2 Golf Cart



Approximate Installation Time *

Experienced Dealer Technician – 1.0 Hour

Average Dealer Technician – 1.5 Hours

Do-It-Yourself – 2.0 Hours

(*=Not including accessories)

Approximate Product Specifications

Weight: 148 lbs.

Cab Width: 53-3/4 inches

INSTALLATION & OWNER'S MANUAL

The contents of this envelope are the property of the owner. Leave with the owner when installation is complete.

Rev. F, 11/19/2018

P/N: IM-1VYDR2GR

YAMAHA DRIVE2 GLIDE & RIDE CAB SERVICE PARTS

DOOR ASSEMBLY, LEFT
PART NUMBERS:
 8SV-7-00022-LBK (BLACK)
 8SV-7-00022-LSS (STANDSTONE)
 8SV-7-00022-LWT (WHITE)

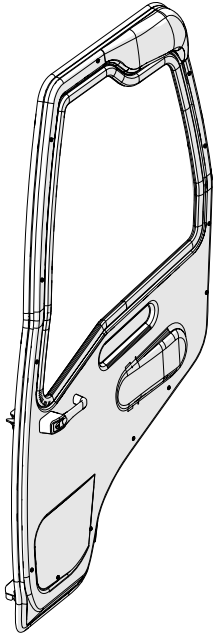

DOOR ASSEMBLY, RIGHT
PART NUMBERS:
 8SV-7-00022-RBK (BLACK)
 8SV-7-00022-RSS (STANDSTONE)
 8SV-7-00022-RWT (WHITE)

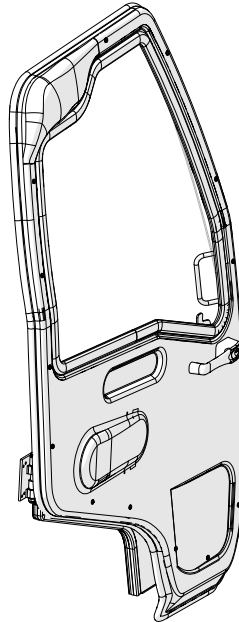

DUAL LATCH, ROTARY & SLAM, LEFT
 P/N: 8SV-9DL08A

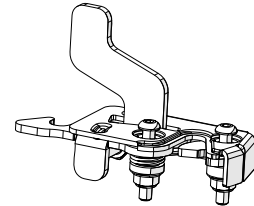

DUAL LATCH, ROTARY & SLAM, RIGHT
 P/N: 8SV-9DL08B

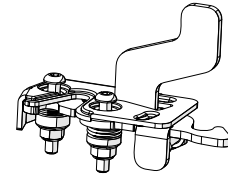

DOOR SKIN W/ WINDOW, LEFT
PART NUMBERS:
 8SV-YDGR-LDS-BK (BLACK)
 8SV-YDGR-LDS-SS (STANDSTONE)
 8SV-YDGR-LDS-WT (WHITE)

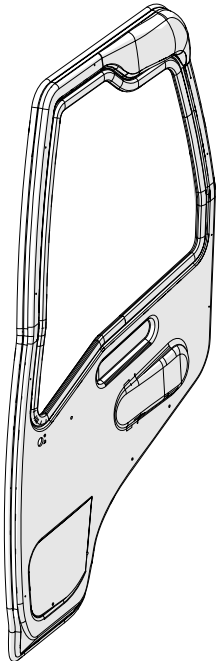

DOOR SKIN W/ WINDOW, RIGHT
PART NUMBERS:
 8SV-YDGR-RDS-BK (BLACK)
 8SV-YDGR-RDS-SS (STANDSTONE)
 8SV-YDGR-RDS-WT (WHITE)

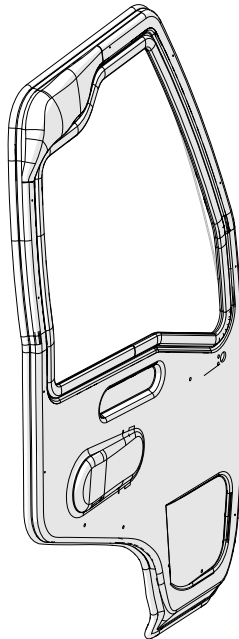

ACRYLIC DOOR WINDOW W/RUBBER-L
 P/N: 8SV-PGCC2L

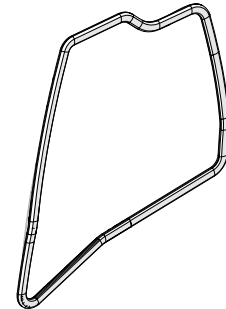

ACRYLIC DOOR WINDOW W/RUBBER-R
 P/N: 8SV-PGCC2R

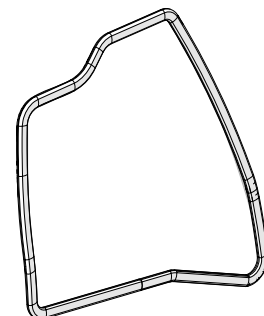

YAMAHA DRIVE2 GLIDE & RIDE CAB SERVICE PARTS

FRONT LEG ASSEMBLY, LEFT
PART NUMBERS:
 8SV-4-00013-LBK (BLACK)
 8SV-4-00013-LSS (STANDSTONE)
 8SV-4-00013-LWT (WHITE)

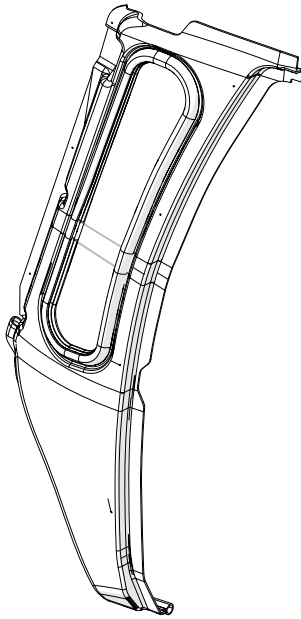

FRONT LEG ASSEMBLY, RIGHT
PART NUMBERS:
 8SV-4-00013-RBK (BLACK)
 8SV-4-00013-RSS (STANDSTONE)
 8SV-4-00013-RWT (WHITE)

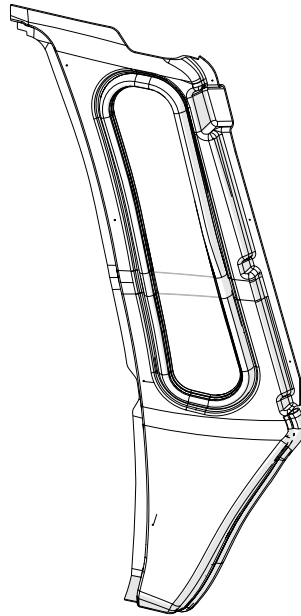

ACRYLIC FRONT WINDOW-L W/RUBBER
 P/N: 8SV-PG7X32L

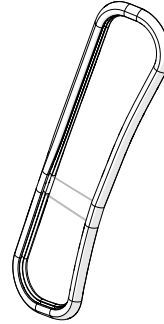

ACRYLIC FRONT WINDOW-R W/RUBBER
 P/N: 8SV-PG7X32R

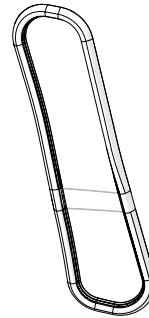

REAR LEG ASSEMBLY, LEFT
PART NUMBERS:
 8SV-8-00011-LBK (BLACK)
 8SV-8-00011-LSS (STANDSTONE)
 8SV-8-00011-LWT (WHITE)

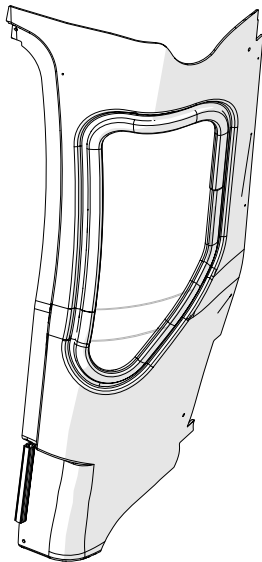

REAR LEG ASSEMBLY, RIGHT
PART NUMBERS:
 8SV-8-00011-RBK (BLACK)
 8SV-8-00011-RSS (STANDSTONE)
 8SV-8-00011-RWT (WHITE)

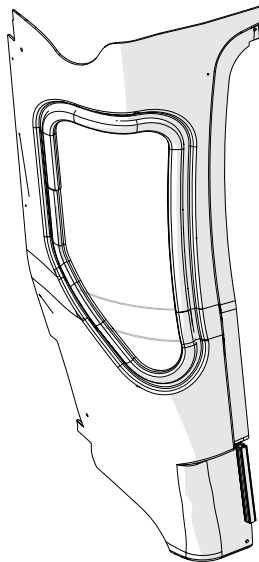

ACRYLIC REAR WINDOW-L, W/RUBBER
 P/N: 8SV-PG9X21L

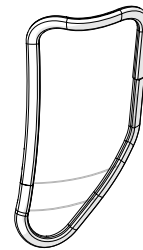

ACRYLIC REAR WINDOW-R, W/RUBBER
 P/N: 8SV-PG9X21R

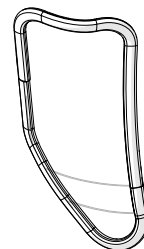

YAMAHA DRIVE2 GLIDE & RIDE CAB SERVICE PARTS

HINGE ASSEMBLY, LEFT
P/N: 8SV-113-00118-L

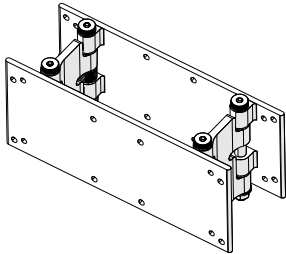

HINGE ASSEMBLY, RIGHT
P/N: 8SV-113-00118-R

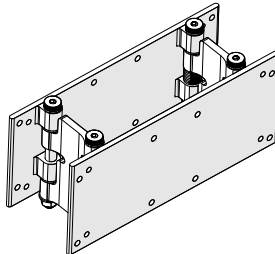

OUTSIDE HANDLE ROTARY LATCH
KIT (SET OF 2); P/N: 9SV-OHRL

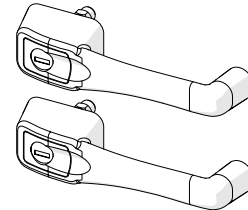

PINCH GUARD
P/N: 8SV-SM-01078

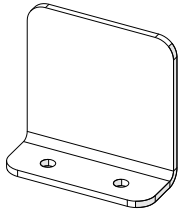

WINDSHIELD HEADER ASSEMBLY
P/N: 8SV-103-00012

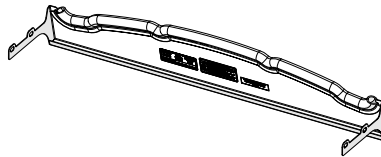

SLIDE RAIL W/ (2) SLIDERS
P/N: 9SV-SR01

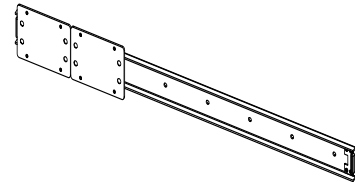

ANCHOR STRIP
P/N: 8SV-113-00119

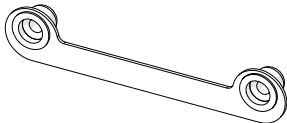

DOOR FRAME ASSY, LEFT, NO SKIN
P/N: 8SV-YDGR-LDF-NS

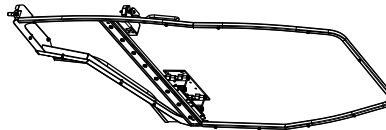



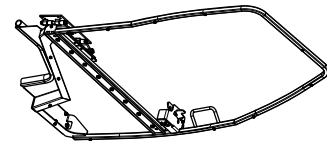



DOOR FRAME ASSY, RIGHT, NO SKIN
P/N: 8SV-YDGR-RDF-NS

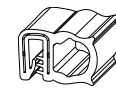

ADDITIONAL SERVICE PARTS

PART NUMBER	DESCRIPTION
9SV-HWK-00081	HARDWARE KIT YAMAHA DRIVE2 GLIDE & RIDE
9SV-9DL01H	KEYS, SET OF 2 ON A RING, FOR HANDLE 1096-1, KEY CODE C40

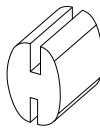
<p>TRIM-LOK, 3/16" GRIP</p>  <p>9SV-PRO1B-10</p>	<p>5/8" STD BULB, 1/16" GRIP</p>  <p>9SV-PRO2-15</p>	<p>5/8" STD BULB, 1/4" GRIP</p>  <p>9SV-PRO7-5</p>	<p>ARCH PSA RUBBER, 3/4" WD X 3/8" TALL</p>  <p>9SV-PRO9-10</p>	<p>BALL CAGE RUBBER</p>  <p>9SV-PR11-10</p>	<p>3/4" SIDE BULB, 1/16" GRIP</p>  <p>9SV-PR17-5</p>	<p>1" ROUND BULB, 1/16" GRIP</p>  <p>9SV-PR19-10</p>
<p>WINDOW RUBBER, ACRYLIC MOUNT</p>  <p>9SV-PR31-10</p>						